





## Step 1: Connecting Your System

**NOTE:** Watch our WNVR Setup Video on YouTube.

1

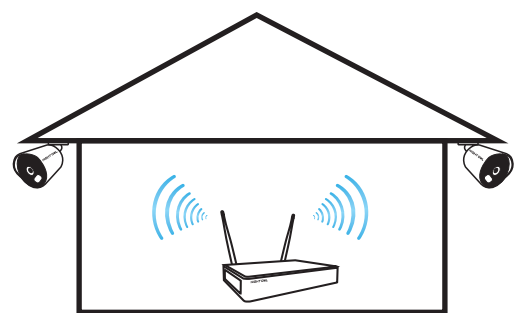

Place the WNVR in a central location. The WNVR must be within the range of all the cameras' final mounting positions.

2

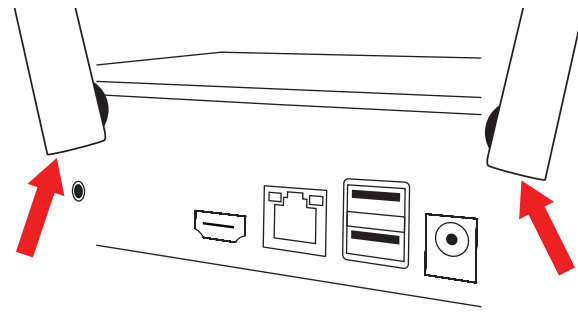

Connect the two included antennas to your WNVR. This will ensure you achieve the maximum wireless range for transmission from your wireless cameras.

3

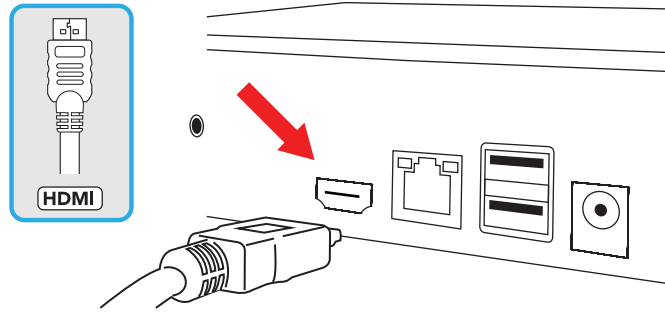

Plug one end of the included HDMI cable into the HDMI port on the back of the WNVR.

4

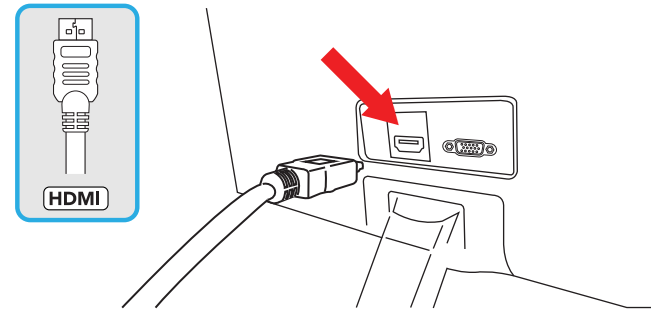

Plug the other end of the HDMI cable into the back of your TV or Monitor.

**NOTE:** To view cameras, TV / Monitor must be tuned to the same input the HDMI is plugged into.

5

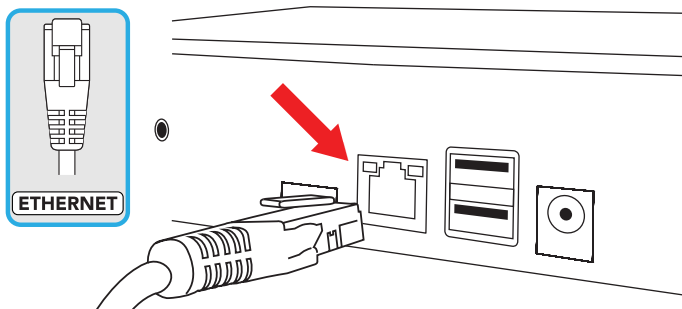

Plug one end of the included Ethernet cable into the LAN port on the back of the WNVR.

6

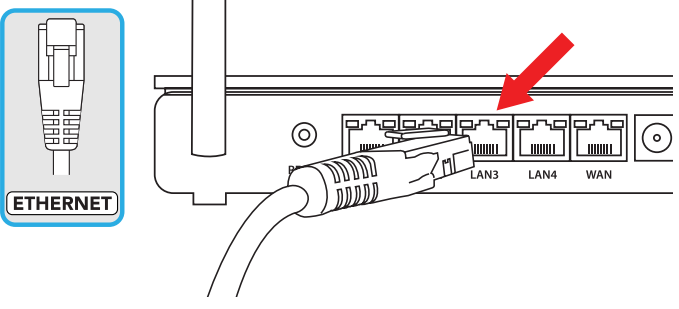

Plug the other end of the Ethernet cable into a port on the back of your router or modem. (Router Not Included)

7

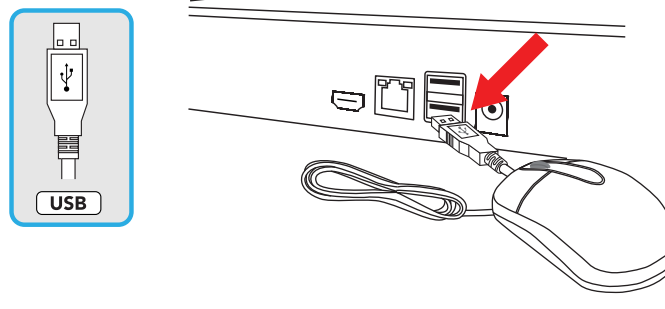

Plug the USB mouse into the USB port on the back of the WNVR.

8

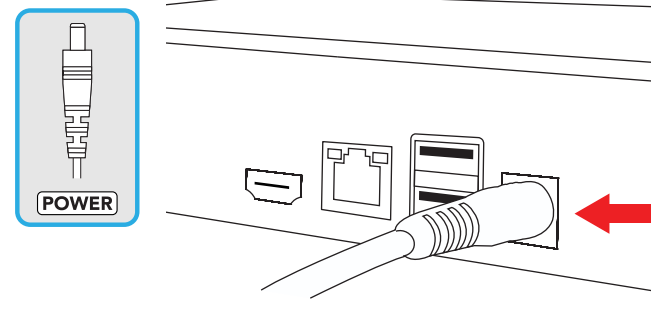

Connect the WNVR power adapter to the Power Input on the rear of the WNVR.

9

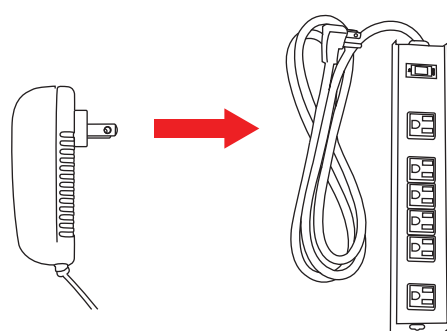

Plug the WNVR power adapter into a surge protector or Uninterruptible Power Supply (UPS). (Surge protector and UPS not included)

10

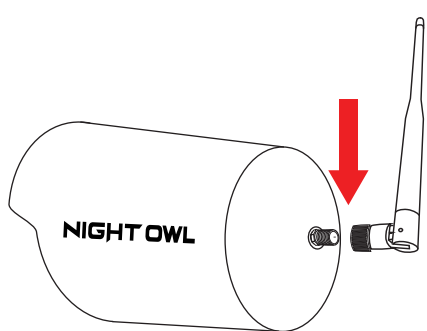

Connect the included camera antenna to the antenna mount on the back of the camera. Repeat with each camera.

11

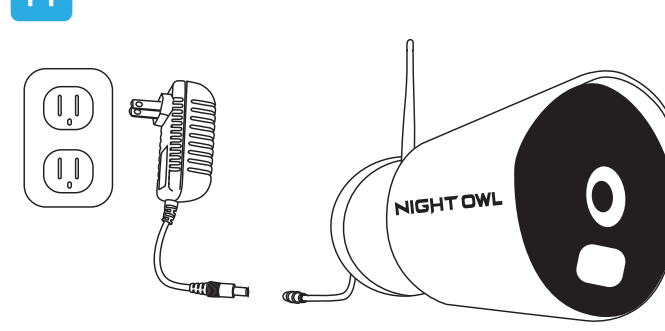

Connect all of the cameras to power adapters and plug them into an outlet within 10 feet of the WNVR.

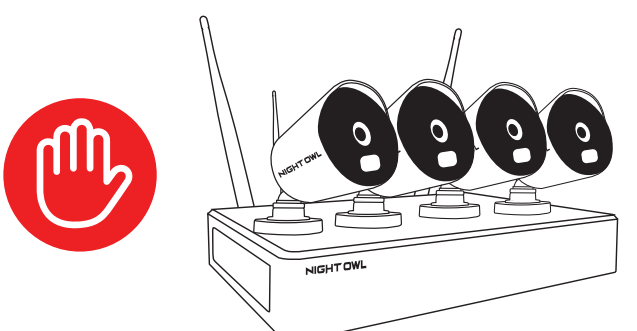

**STOP:** BEFORE installing, the cameras must be paired to the WNVR. Do not mount the cameras until you have completed Step 3: Startup Wizard.

## Step 2: Download Night Owl Protect

**2a** If you're a First Time User, download Night Owl Protect from the App Store or Google Play Store onto your Smart Device. If you already have an account skip to Step 3a.

**2b** Create and verify your Night Owl Protect account. Use the Night Owl Protect login credentials to log into the WNVR in Step 3a.



**NOTE:** Setup is the same for Smartphone and Tablet.

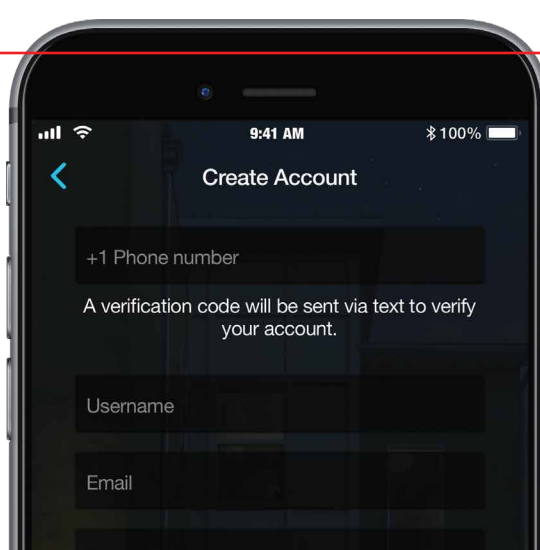

## I Don't Want to Connect the WNVR to the Internet



**Night Owl Strongly Recommends connecting the WNVR to the Internet. If you have decided not to connect:**

- You must manually update the device's firmware to the latest version to receive Technical Phone Support. The latest firmware version is available on the device's support page on the Night Owl Support Site.
- The WNVR must be registered to receive Technical Phone Support.
- You cannot view your system remotely.
- Resetting your password is a much longer process to ensure security.

**A** Go to **NightOwlSP.com/NOPProtect** to register the WNVR. Use the information found on the WNVR's support sticker to complete registration.

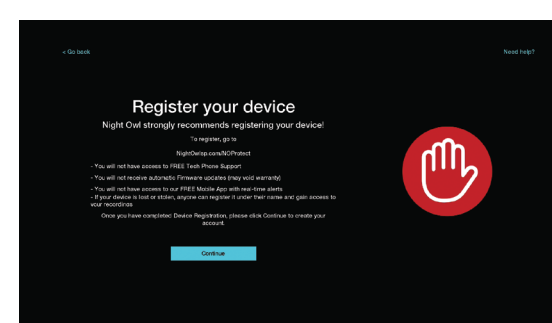

**B** Create Local Password  
1. Default username is "admin"  
2. Create a password (any alphanumeric combo with a minimum of 8 characters; MUST include a number, a lowercase, and uppercase letter).  
3. Click "Continue" to go to the Login Screen.

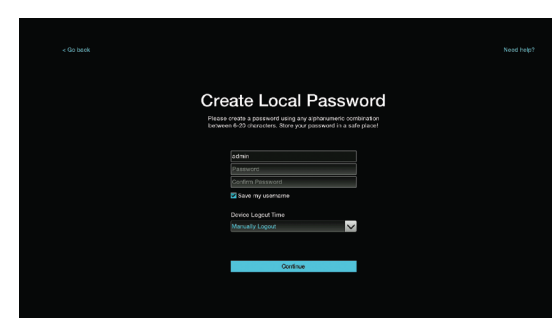

**C** Once the WNVR is added to the App, complete the Startup Wizard and camera installation.

## Step 3: Startup Wizard

**3a** When prompted, log in using the Night Owl Protect App credentials created in Step 2b.

**NOTE:** The WNVR is automatically added to the Night Owl Protect App when you log in using your Night Owl Protect credentials.

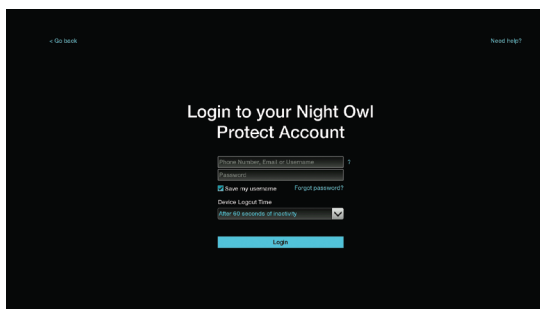

**3b** Follow the onscreen steps to pair the cameras to the WNVR.

**NOTE:** When powered on, the cameras are in pairing mode (Green Status Light flashes rapidly). Refer to the "Pairing Mode" section if a camera is not in pairing mode.

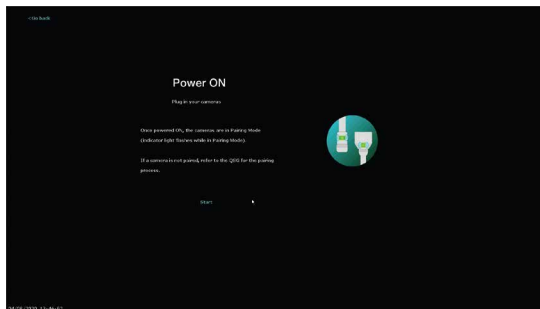

**3c** Make sure you see all of the cameras in the Live View before completing the Startup Wizard.

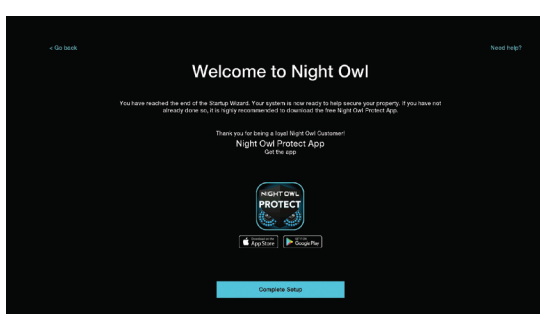

**STOP:** If you are NOT connecting your WNVR to the Internet, follow the onscreen steps for updating firmware, device registration, and pairing cameras. Then, skip to "I Don't Want to Connect the WNVR to the Internet."

## If a Camera is not in Pairing Mode

- Make sure the camera is close to the WNVR and powered on.
- Insert a pin into the Reset Hole and press and hold for 5 seconds.
- Wait for the green Status Light to flash rapidly.
- Return to the Startup Wizard and search for the camera.

For more information, refer to the camera's Quick Setup Guide at [Support.NightOwlSP.com](http://Support.NightOwlSP.com)

**FCC Statement**

This equipment has been tested and found to comply with the limits for a Class B digital device, pursuant to part 15 of the FCC rules. These limits are designed to provide reasonable protection against harmful interference in a residential installation. This equipment generates, uses and can radiate radio frequency energy and, if not installed and used in accordance with the instructions, may cause harmful interference to radio communications. However, there is no guarantee that interference will not occur in a particular installation. If this equipment does cause harmful interference to radio or television reception, which can be determined by turning the equipment off and on, the user is encouraged to try to correct the interference by one or more of the following measures:

- Reorient or relocate the receiving antenna.
- Increase the separation between the equipment and receiver.
- Connect the equipment into an outlet on a circuit different from that to which the receiver is connected.
- Consult the dealer or an experienced radio/TV technician for help.

Responsible for compliance could void the user's authority to operate this equipment. (Example- use only shielded interface cables when connecting to computer or peripheral devices).

Any Changes or modifications not expressly approved by the party responsible for compliance could void the user's authority to operate the equipment.

This equipment complies with Part 15 of the FCC Rules. Operation is subject to the following two conditions:

- (1) This device may not cause harmful interference, and
- (2) This device must accept any interference received, including interference that may cause undesired operation.

**FCC Radiation Exposure Statement:**

The equipment complies with FCC Radiation exposure limits set forth for uncontrolled environment. This equipment should be installed and operated with minimum distance 20cm between the radiator and your body.