

<p>Certificate of Conformity</p> <p>Inspection Date: _____</p> <p>Inspection Personnel: _____</p>	<p>Product Anti-counterfeiting Label</p>
--	--



QR code for
installation video



QR code of
Pet's journey App

Manufacturer: Shenzhen Wei Wu Sen Lin Technology Company Limited
Address: Room 504, 5/F., Tower C, Amazing Plaza, 4088 Qiaoxiang Rd,
Nanshan, Shenzhen, Guangdong Province, 518074, China

Self-Cleaning Litter Box

Instruction manual

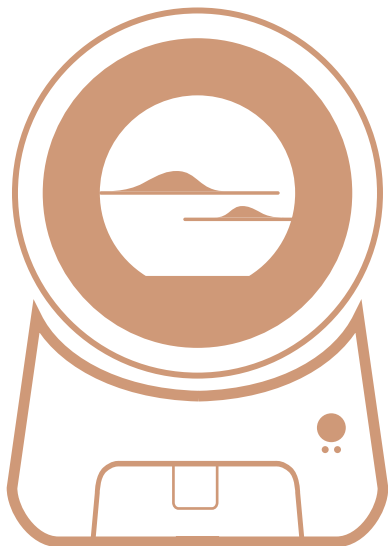

Self-Cleaning Litter Box

IMPORTANT NOTICE

Please read this product manual carefully before use. Once the product is installed or used, it means that you have read it carefully and accepted the following safety precautions.

Our company shall not be responsible for any accidents and losses caused by improper operations, nor shall it bear any legal liability.

The right to interpret and modify this manual belongs to our company.

Precautions

1. Please install and use this equipment strictly in accordance with this manual.
2. Please use the original power adapter. Otherwise, it may damage the equipment or cause it to fail to work properly, and even pose potential safety hazards.
3. If the power cord is damaged, in order to avoid danger, it must be replaced by professionals from the manufacturer, its maintenance department or similar departments.
4. Please properly cover or store the power cord to prevent pets from biting the wire and causing potential safety hazards.
5. Do not touch the plug or switch with wet hands to avoid electric shock. If you don't use this product for a long time, please unplug the power cord.
6. It is recommended to use the equipment in an indoor environment. Avoid using it in high-temperature, high-humidity environments or under direct sunlight. Keep it away from fire sources.
7. Do not place any items within 15 cm on the left and right sides and 30 cm in front of the equipment to avoid affecting the infrared induction data monitoring.
8. Please place the equipment on a dry, stable and flat surface for use. Do not immerse the bottom in water or soak it.
9. A weight sensor is installed at the bottom of the equipment. When moving it, please lift and place it gently. Do not drag it.
10. Do not place other items on the top of the equipment. When the product is running, do not open the sand-filling cover or the upper cover to avoid potential safety hazards.
11. For young pets under 6 months old or weighing less than 1.5 kg, please turn on the "Kitten Mode" when using it.
12. Children under 8 years old are prohibited from operating the equipment. Children over 8 years old should use it under the guidance of adults.
13. Do not disassemble, modify or repair this product by yourself. Otherwise, it will be regarded as giving up all rights to warranty and service.
14. If you need to leave home for a long time for some reason, please make sure that there is sufficient cat litter remaining in the bucket.
15. Only conduct sand-filling after confirming safety. When cleaning the whole machine, turn off the power in advance or unplug the plug before proceeding to avoid causing harm.
16. If you encounter any problems in using the product, please contact customer service immediately.

Product Introduction

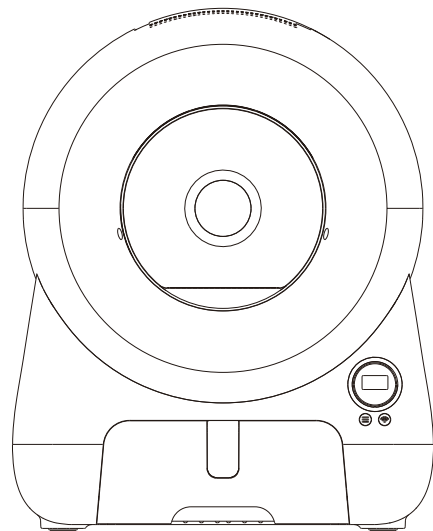

Main Unit

Product Accessories:



Adapter



Instruction Manual



Garbage Bags



Aromatherapy Tablets



Quick Operation Guide

*Please confirm whether the accessories are complete.

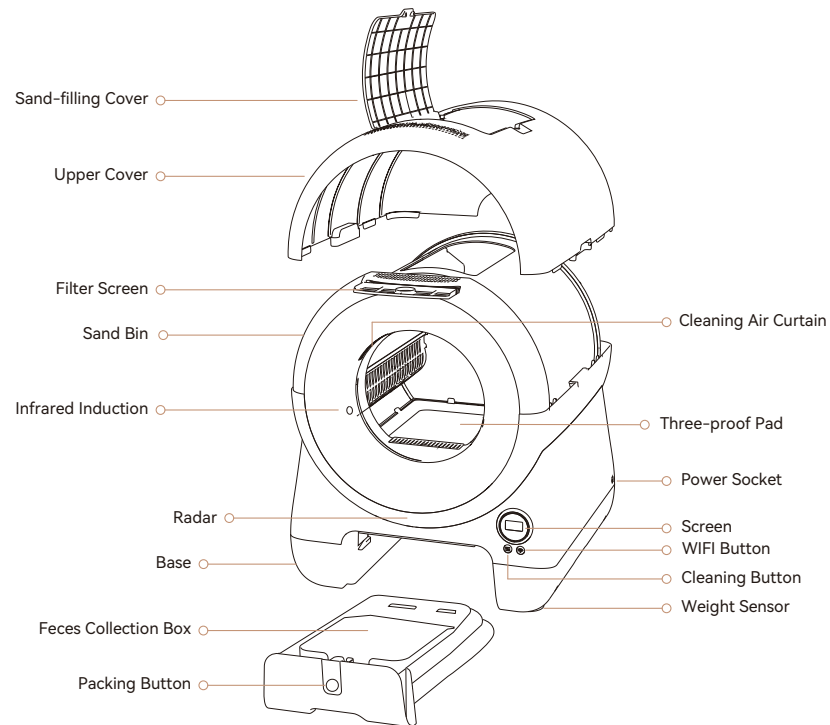

Instructions for Use

1. Place the base on a level, hard and stable surface. Remember to handle it with care and avoid dragging or moving it roughly.

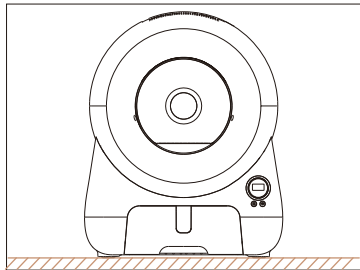

2. Put a garbage bag on the feces collection box and push it along the slot until it is parallel to the front of the base.

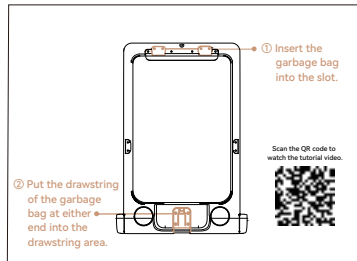

3. After that, push the feces collection box back to its position in the equipment.

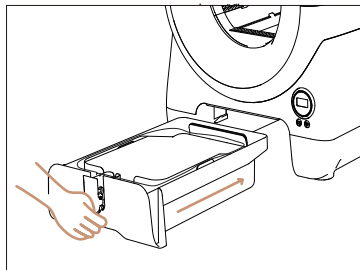

4. Lift off the upper cover.

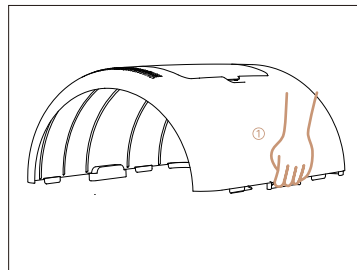

5. Take out the slot of the air curtain filter screen, put the aromatherapy tablet into it, push the filter screen back, and finally install the upper cover.

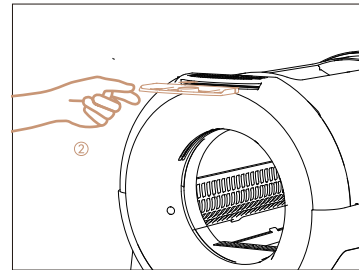

6. Plug in the power supply. The equipment will conduct self-inspection, and the sand bin will automatically rotate and reset. Please wait patiently.

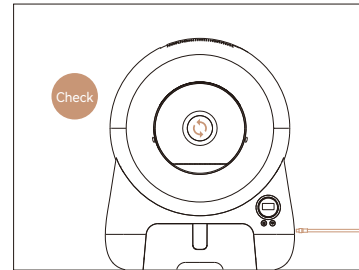

7. Open the sand-filling cover and pour in no less than 3 kg of cat litter. After double-clicking the WiFi button to unlock it, double-click the cleaning button. When you hear two "beep" sounds, smooth the cat litter and then it can be used.

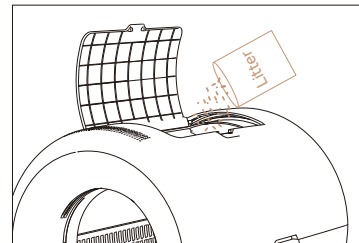

8. Scan the QR code to download and install the app. After the installation is completed, follow the step-by-step guidance to connect the equipment, and then the network connection operation can be completed.

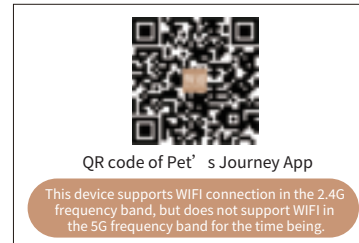

Function Description

1. Induction Mode (Default Initial Function)

One minute after the cat leaves the toilet, the equipment will conduct automatic cleaning. Users can also change the time interval for cleaning after the cat leaves through the app.

2. Timing Mode

Users can choose the timing mode through the app and set the corresponding cleaning time (such as 9:00 in the morning and 4:00 in the afternoon). The equipment will automatically carry out cleaning at the set time.

3. Kitten Mode

Since kittens are relatively low in height and weight, for the sake of safety in use, users can choose the kitten mode through the app. In this mode, the equipment will not conduct automatic cleaning. After sensing that the kitten has used the toilet three times, it will remind users to conduct a manual cleaning around the equipment.

4. Deep Cleaning

The equipment will conduct a deep cleaning according to the selected mode, which is applicable when the cat has soft stools.

5. Manual Cleaning

Users can unlock the equipment and click the cleaning button or click "Clean Immediately" on the app. The equipment will start cleaning after emitting a "beep" sound.

6. Cleaning Air Curtain

In the initial state, the air curtain is turned on by default during cleaning, aiming to block cat litter dust and purify the surrounding air. Meanwhile, it is also possible to set a schedule to turn on the cleaning air curtain regularly to optimize the air quality at fixed times.

7. Smoothing the Cat Litter

After adding cat litter, users can unlock the equipment and double-click the cleaning button. After two "beep" sounds from the equipment, it will smooth the cat litter.

8. Replacing Cat Litter

Users can set a countdown for replacing cat litter according to their own usage cycle. When the time is up, the screen will display that the cat litter is insufficient, and the app will send a message push. Users can perform a one-click operation to empty the cat litter, then replace it and reset the countdown.

Low cat litter.

9. Replacing the Deodorant Aromatherapy Tablets.

The app will set a one-month countdown according to the usage time of the aromatherapy tablets. When the time is up, the screen will display that the aromatherapy tablets have expired, and the app will send a message push. Users can then carry out the operation of replacing the aromatherapy tablets and reset the countdown.

Scent pad expired.

10. Cleaning the Feces Collection Box.

Users can set a countdown for the time of cleaning the feces collection box according to their own usage cycle. When the time is up, the screen will display "Clean the Feces Collection Box", and the app will send a message push. Users can then clean the feces collection box and reset the countdown.

Clean the box.

11. Radar Function

To prevent cats or children from accidentally touching the sand bin while it is rotating and ensure the safety of use, we have installed a radar sensor at the front end of the equipment. When there is a moving object within 30 cm in front of the equipment, the sand bin will stop rotating, and the screen will display "Foreign Object Approaching". It will resume operation 5 seconds after the moving object stops or leaves.

Button Operations and Indicator Light Descriptions

Components	Operations	Status
Cleaning Button	Single-click	One-click cleaning
	Double-click5	Soothing the cat litter
	Press and hold for 3 seconds.	One-click emptying of the cat litter.
	Press and hold for 10 seconds.	Sand bin reset
WIFI Button	Double-click the button.	Button unlocking
	Press and hold for 5 seconds.	Network reconnection
	Press and hold for 10 seconds.	Restore factory initialization
Child Lock Indicator Light	The white light is on.	Child lock on
	The white light is off.	Child lock off
WIFI Indicator Light	The white light flashes slowly.	Network not connected.
	The white light flashes quickly.	Network connecting.
	The white light stays on constantly.	Network is normal.
Indicator Light	The red light stays on constantly.	Equipment malfunction / Supplies expired / Clean the box / Box is full

Cleaning and Maintenance

- 1.After unlocking, press and hold the cleaning button for 3 seconds. When you hear two "beep" sounds, the equipment will start to empty the sand. After the emptying is completed, lift off the upper cover, take out the sand bin, and then you can clean the sand bin.
- 2.The three-proof mat inside the sand bin can be removed and washed with water.
- 3.After ensuring that the sand has been emptied and the sand bin has been lifted out, remove the garbage bag, and then you can clean the feces collection box.
*The feces collection box and the sand bin can be washed all over with water.
- 4.The base part (including the cleaning air curtain) contains electronic components. Washing with water is prohibited. Wipe it with a damp cloth. You can choose to wipe it with a neutral cleaning solution. Avoid using alcohol or chemical reagent cleaning solutions for cleaning.
- 5.The filter screen in the cleaning air curtain can be taken out and washed entirely with water.
- 6.After cleaning, dry each component by wiping or airing them. Install them in sequence according to the steps, and then the equipment can be used.
- 7.It is recommended to clean the equipment once a month. The cleaning frequency can be adjusted according to the home use environment to provide cats with a better toilet environment.

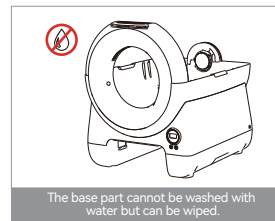
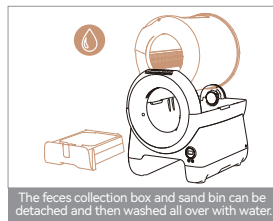

I Frequently Asked Questions

Q: Why doesn't the equipment operate when it's plugged into the power supply?

A: Reconnect it to the power supply. If there is still no response, please contact customer service.

Q: What's the capacity of the sand bin?

A: The capacity of the sand bin is about 65 liters, and it can hold about 20 catties of cat litter at most.

Q: How large is the capacity of the feces collection box?

A: The capacity of the feces collection box is about 11 liters, and for a single cat, the maximum usage time is 14 days.

Q: What kind of cats need to turn on the kitten mode?

A: It is recommended that cats weighing less than 1.5 kg turn on the kitten mode to avoid safety issues during use.

I Product Parameters

Product Name: Self-Cleaning Litter Box

Product Model: YJE030

Product Dimensions: 591 * 526 * 653 mm

Product Net Weight: 13.8 kg

Rated Voltage: 12V 

Rated Power: 5W

This equipment contains radio transmission modules with the model approval codes (respectively) as follows: CMIIT ID: 2020DP6462.

I After-Sales Service Card

Warranty Regulations

In case of product performance failures caused by non-human damage during the warranty period, the following Three Guarantees services can be enjoyed:

- 1.If there are quality problems with this product within 7 days from the date of purchase, consumers can choose to get a one-time refund for the shipping price and return the product, or replace it with a product of the same model and specifications.
- 2.If there are quality problems with this product within 15 days from the date of purchase, consumers can choose to replace it with a product of the same model and specifications.
- 3.The Three Guarantees period for this product is half a year.
- 4.This card shall not be altered, otherwise it will be regarded as an invalid voucher.
- 5.This card will only take effect after being stamped by the selling unit.
- 6.This device complies with part 15 of the FCC Rules. Operation is subject to the following two conditions:
(1)This device may not cause harmful interference, and
(2)this device must accept any interference received, including interference that may cause undesired operation.

Non-Warranty Regulations

The following situations (but not limited to the following) are not covered by the "Three Guarantees":

- 1.Those without the "Three Guarantees" voucher, lacking a valid invoice, or having an expired "Three Guarantees" service validity period.
- 2.Damages caused by failure to use, maintain, and store the product as required in the user manual.
- 3.Damages caused by force majeure such as fire, lightning strikes, and floods.

FCC Radiation Exposure Statement:

This equipment complies with FCC radiation exposure limits set forth for an uncontrolled environment. This equipment should be installed and operated with minimum distance 20cm between the radiator & your body.

FCC Warning

This device complies with Part 15 of the FCC Rules. Operation is subject to the following two conditions:

(1) This device may not cause harmful interference, and (2) this device must accept any interference received, including interference that may cause undesired operation.

Note: This equipment has been tested and found to comply with the limits for a Class B digital device, pursuant to part 15 of the FCC Rules. These limits are designed to provide reasonable protection against harmful interference in a residential installation. This equipment generates, uses and can radiate radio frequency energy and, if not installed and used in accordance with the instructions, may cause harmful interference to radio communications. However, there is no guarantee that interference will not occur in a particular installation. If this equipment does cause harmful interference to radio or television reception, which can be determined by turning the equipment off and on, the user is encouraged to try to correct the interference by one or more of the following measures:

- Reorient or relocate the receiving antenna.
- Increase the separation between the equipment and receiver.
- Connect the equipment into an outlet on a circuit different from that to which the receiver is connected.
- Consult the dealer or an experienced radio/TV technician for help.

NOTE 2: Any changes or modifications to this unit not expressly approved by the party responsible for compliance could void the user's authority to operate the equipment.

Warranty Card

Customer Name		Customer's Telephone Number	
Customer Address			
Purchase Date			
Reason for Malfunction			

Product Name		Signature of Maintenance Personnel	
Repair Submission Situation			
Date of Repair Submission			

尺寸：125*125mm

材质：128g双铜纸+骑马订，16页

工艺：四色印刷