

# Bluetooth Transmitter & Receiver KH34

## User Manual

**Contents:**

- 1. Product Overview----- 2
- 2. Basic Operation ----- 3
- 3. How to use as a Bluetooth Transmitter (TX)----- 4
- 4. How to use as a Bluetooth Receiver (RX)----- 7
- 5. Charging-----10
- 6. LED Indicator -----11
- 7. Product Specification-----12
- 8. Attention and Q & A-----13

# 1.Product Overview

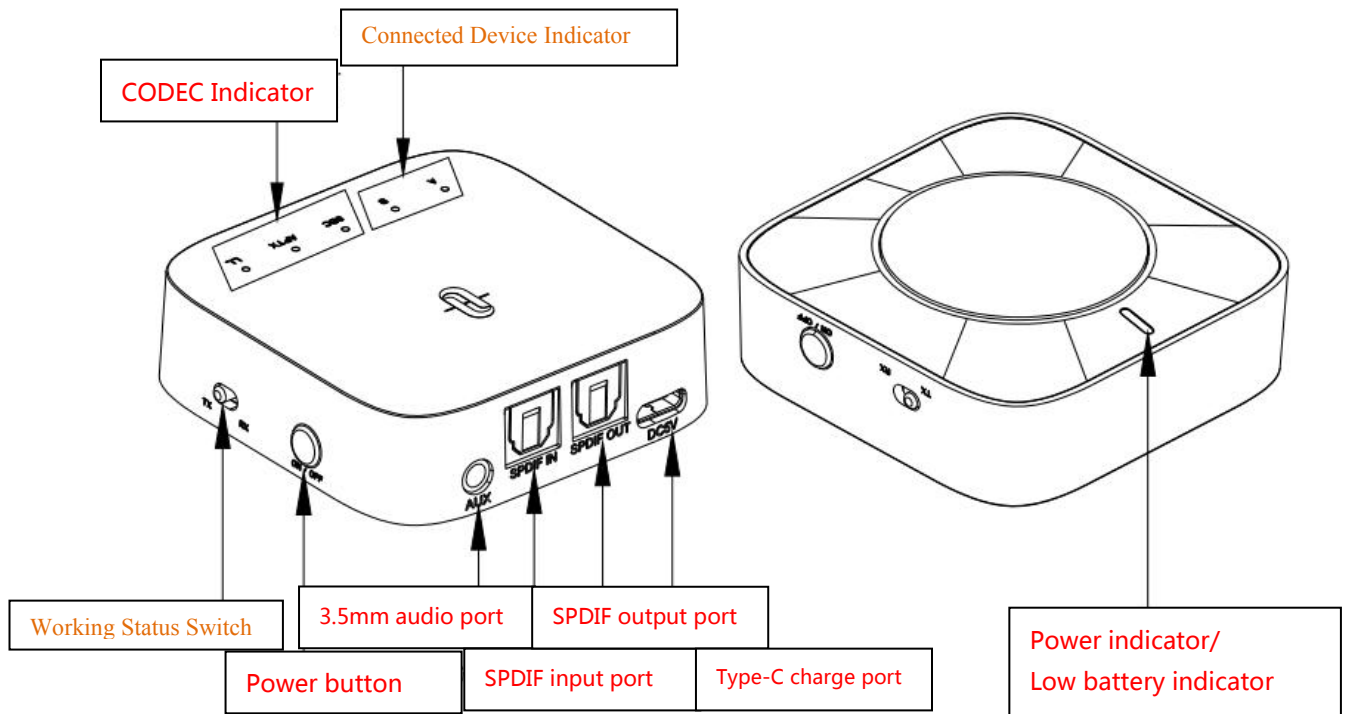

## Package Contents:

- A. KH-34 Bluetooth Transmitter & Receiver \*1
- B. 3.5mm Audio Cable \*1
- C. Type-C USB Charging Cable \*1
- D. User Manual \*1
- E. Fiber Optic Cable \*1

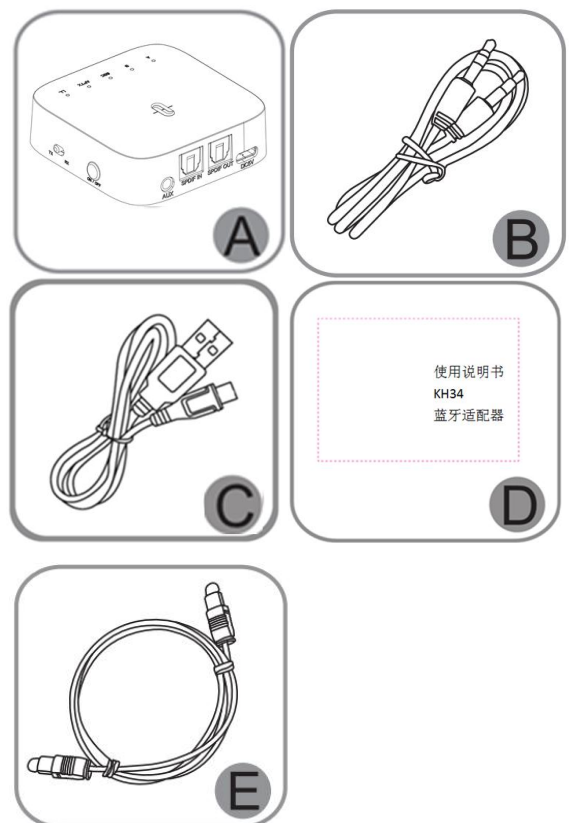

## 2. Basic Operation

Button	Function	Operation
MFB (Multi Function Button)	Power on	In off status, long press MFB 3 seconds to power on.
	Power off	In on status, long press MFB 3 seconds to power off.
	Enter pairing mode	In on status, double press MFB to enter pairing mode. *Not work in Multi Point Connection.
	Play / Pause	In RX play music status, short press MFB to pause / play the music. *Not work in TX.
TX/RX mode selection	In off status, switch the button to TX side for TX mode, or switch the button to RX side for RX mode and power on.  *The paired records of the last mode will be delete when switch to another mode.  *Please turn off the units after 3 seconds then switch to another function mode.	
SPDIF/AUX mode	Insert the 3.5 mm audio cable or RCA cable to enter into the AUX mode, insert the fiber optic cable to enter into the SPDIF mode.	

## 3. How to use as a Bluetooth Transmitter (TX)

### 3.1 Bluetooth Pairing and Connection

A . Off mode, switch the button to TX side and long press MFB 3 seconds to power on.

B . Double press MFB button to enter into pairing mode with pairing indicator “A” LED fast flash if not automatically enter it after power on.

C . Turn on the Bluetooth function of your device (bluetooth headphone, speaker or receiver etc.) to pairing mode with Red & Blue LED flash alternately or Blue LED flash.

D . Place the KH-34 and the device close and wait for 5-30 seconds, after successful connection, KH-34 will turn to solid TX LED, solid A LED, and solid CODEC LED, please refer to Point 6.

E . Connect KH34 and your phone with 3.5 mm audio cable, and could play music from your phone to the headphone or speaker.

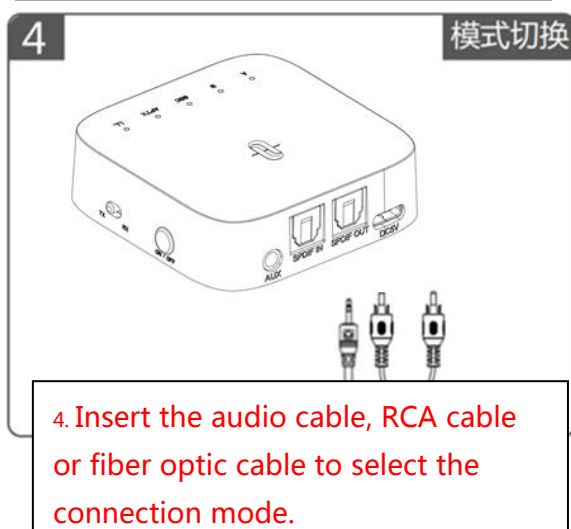
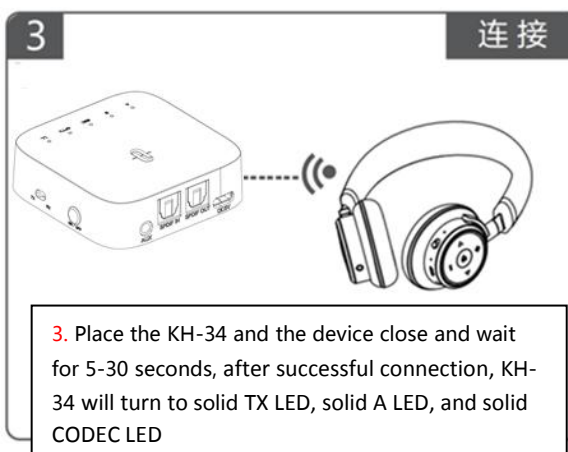
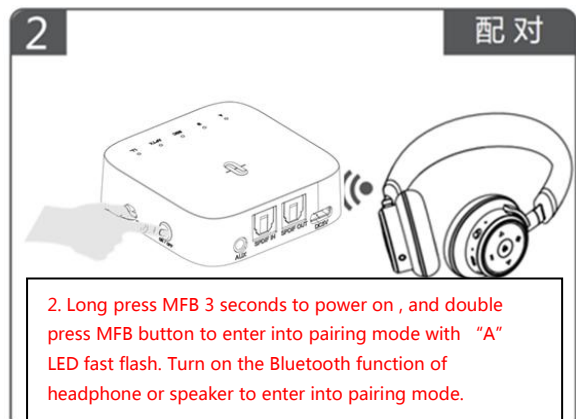
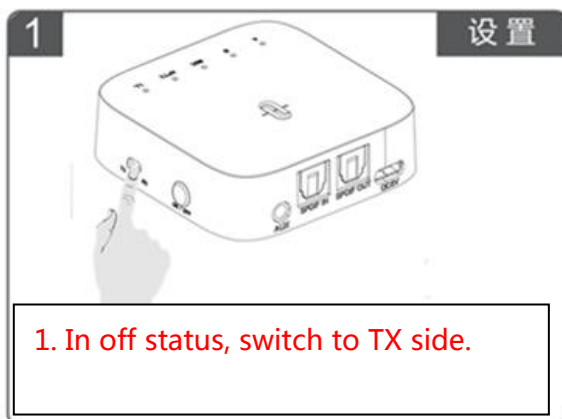

Notes:

CODEC indicator flash in different way depend on different CODEC (of connected device) after connected, refer to point 6 LED indicator.

## 3.2 Multi Point Connection

A . Follow 3.1 to connect with the first device, double press MFB button to enter into pairing mode again with pairing indicator "B" LED fast flash.

B . Turn on the Bluetooth function of the second device (Bluetooth headphone, speaker or receiver etc) to enter into pairing mode, place them close and wait for 5-30 seconds. KH34 pairing indicator "A" " B" solid LED after connected with two devices.



### Notes :

1. Pls turn off KH34 and turn on again, and try to reconnect or repair with two devices, when it could not connected with two devices at the first time.
2. Multi point connections could compatible with most Bluetooth devices of market, but there are some devices maybe have some problem when connect with it.
3. Single connection priority support aptX™ LL (connected device also need to support aptX™ LL). Two connections priority support aptX™ LL, aptX™ or SBC also will be according to the device setting of the priority support.
4. When during multi point connections, connect the second device but not disconnect the first device, when the second device is connected successfully will with temporarily bad working, pls wait for 5 to 20 seconds for normal working.

### 3.3 TV Connection

Connect KH34 and the TV with 3.5mm audio cable , RCA cable or fiber optic cable, and Bluetooth connect KH34 with devices ( Bluetooth headphone or speaker ), and could transmit the audio from TV to the devices .

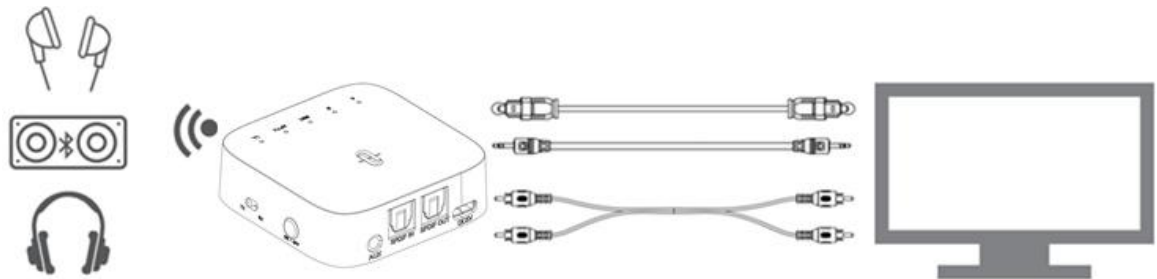

Notes :

1. Pls test the TV with wired headphone by selecting 3.5mm output or RCA sound device insert into RCA audio port to check the TV's audio settings to make sure the devices connect in the right way and play audio from the TV.
2. If bluetooth headphone can not hear sound from TV, please check the TV audio setting, normally can output sound one of them or all: fiber optic, 3.5mm, tv speaker.
3. Pls connect the TV and SPDIF IN port with fiber optic cable when select the Toslink connection mode.

## 4. How to use as a Bluetooth Receiver (RX)

### 4.1 Bluetooth Pairing and Connection

A . Off mode, switch the button to RX side and long press MFB 3 seconds to power on.

B . Double press MFB button to enter into pairing mode with Red & Blue LED flash alternately.

C. Turn on Bluetooth function of Phone, search and click to connect "TaoTronics TT-ba09 Pro" on Bluetooth device lists.

D. LED turns to solid Blue after connected, connect KH34 and headphone or speaker with 3.5mm audio cable. play music from phone to the headphone or speaker.

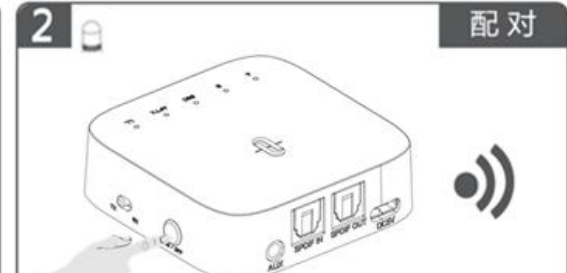
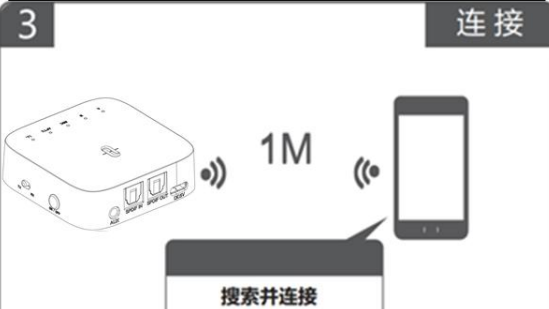
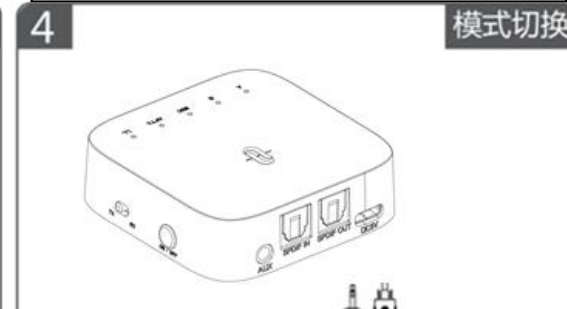
<div>1 设置</div>  <div>1. In off status, switch to RX side.</div>	<div>2 配对</div>  <div>2. Long press MFB 3 seconds to power on , and double press MFB button to enter into pairing mode with "A" LED fast flash. Turn on the Bluetooth function of headphone or speaker to enter into pairing mode.</div>
<div>3 连接</div>  <div>3. Turn on Bluetooth function of Phone, search and click to connect "TaoTronics TT-ba09 Pro" on Bluetooth device lists. "A" solid LED after connect.</div>	<div>4 模式切换</div>  <div>3. Insert the 3.5mm audio cable or fiber optic cable to select the AUX or SPDIF connection mode.</div>

Notes:

CODEC indicator LED flash in different way depend on different CODEC after connected and playing music, refer to point 6 LED indicator.

## 4.2 Multi Point Connection

A . Follow 4.1 to connected with first phone (PC, laptop).

B. Double press KH34 MFB button to enter into pairing mode again with pairing indicator "B" LED fast flash.

C. Turn on Bluetooth function of the second phone, search and click to connect KH34 on phone Bluetooth lists. Multi point connections with solid green LED.



Notes :

- (1) Only could play music from one phone when with two connections. Need to stop the first one's music then to play the other one's music.
- (2) In two connections, the CODEC indicator will flash according to the connected phone.



### 4.3 Speaker Connection

Connect KH34 and Speaker with 3.5 mm audio cable, and Bluetooth connect with phone (PC, laptop), play music from your phone to speaker.

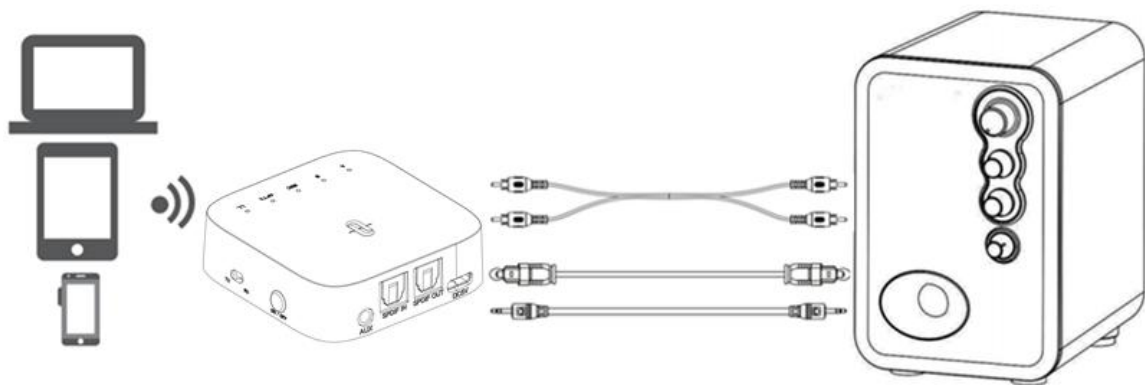

Notes :

1. Pls test the speaker with 3.5 mm audio cable (connect phone) to see if workable, if could not play when connect with KH34.
2. Pls insert to SPDIF OUT port for Toslink connection.

## 5. Charging

Pls charging KH34 when low battery with Red LED flash. LED turn off when full charged (about 2 hours ).

Connection for charge

Connect KH34 and power supply (charger , car charger , computer USB etc )with Micro USB cable.

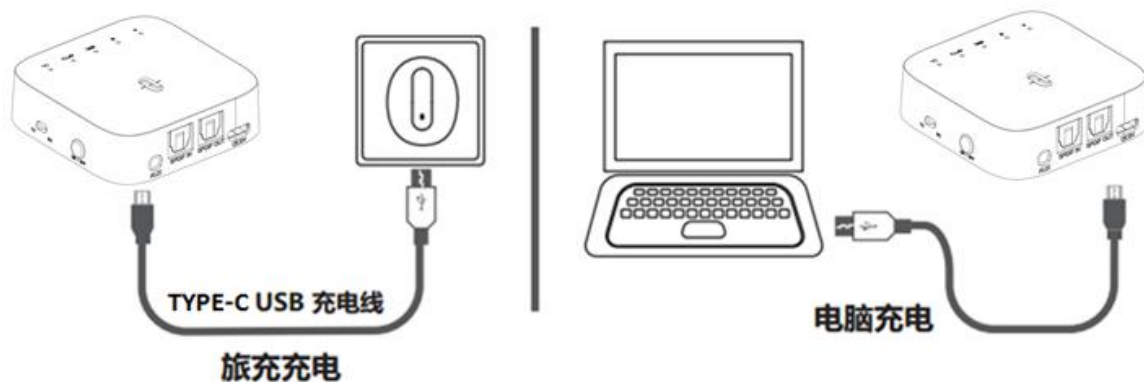

Charging with Type-C USB cable / Charging with PC

Notes:

1. Pls charge the KH34 at least once every 2 months if without use.
2. Pls press "MFB" and connect with power supply to reset the item , when it dead during use.

## 6. LED Indicator

Status	LED Indicator	
Power on	Power indicator LED flash twice (TX/RX)	
Power off	Power indicator LED flash twice (TX/RX)	
Pairing mode	Pairing indicator "A" LED fast flash (TX/RX)	
Unconnected standby mode	Pairing indicator "A" LED flash once every 5 second (TX/RX)	
Reconnect mode	Pairing indicator "A" LED flash once every second (TX)	
	Pairing indicator "A" LED flash once every 5 second (RX)	
Connected standby mode	Pairing indicator "A" solid LED (RX)	
Connected working mode (CODEC)	aptX™ low latency	LL indicator solid LED
	aptX™	aptX™ indicator solid LED
	SBC	SBC indicator solid LED
Low battery	Low battery indicator solid LED	
Charging	Power indicator solid LED	
Full charged	Power indicator LED turn off	

\*Pairing indicator "A" turn to solid LED after connected in TX/RX, CODEC indicator will turn on while working.

There is no connected standby mode in TX, it is working status once connected, so pairing indicator "A" and CODEC indicator will turn on.

## 7. Product Specification

Bluetooth Version	V5.0		
Chipset Solution	CSR 8670		
Operation Range	Up to 10 meters		
Bluetooth Profile	TX/RX: A2DP, AVRCP		
CODEC	<b>RX:</b> aptX™ low latency, aptX™, SBC <b>TX:</b> aptX™ low latency, aptX™, SBC		
Battery Capacity	620mAh/3.7V		
Charging Time	About 2 hours		
Standby Time	About 100 hours		
Working Time	AUX	RX	About 24 hours
		TX	About 24 hours
	SPDIF	RX	About 28 hours
		TX	About 28 hours
Operating Temperature	-10---50°C		
Net Weight	About 44 g		
Size	60.6*60.6*19.3mm		

### Notes:

1. Working time will be different depend on different working environment and CODEC.
2. Standby time will be same as working time on TX mode, as it will be working once connected.
3. CODEC code depend on the connected devices and follow the turns as mention.

## **8. Attention and Q & A**

### **Q . Power off automatically?**

A: Without connect with any devices for more than 10 minutes the item will power off automatically in RX mode, except in TX mode.

### **Q . How to reconnect?**

A: KH34 will reconnect with paired devices when power on. If not , pls follow the 3.1 or 4.1 to pair & connect again.

### **Q . How to delete the paired records?**

A: Switch to another mode ( TX or RX ) and power on, will delete the paired records of the last mode. (Pls switch to another mode after 3 seconds from power off in last mode.)

### **Q . Password for connect?**

A: Pls enter "0000" (four zero), "8888" (four eight), " 1111" (four one), or "1234" (one, two, three, four) for some devices which need password to connect .

### **Q. Could not power on or dead when connect?**

A: Press MFB and connect with power supply to reset the item, and repower for use.

### **Q. Charging power supply?**

A: Charging power supply: 5V,  $\geq 500$  mA. (Charger, car charger , computer USB etc.)

## **FCC STATEMENT :**

This device complies with Part 15 of the FCC Rules. Operation is subject to the following two conditions:

- (1) This device may not cause harmful interference, and
- (2) This device must accept any interference received, including interference that may cause undesired operation.

**Warning:** Changes or modifications not expressly approved by the party responsible for compliance could void the user's authority to operate the equipment.

NOTE: This equipment has been tested and found to comply with the limits for a Class B digital device, pursuant to Part 15 of the FCC Rules. These limits are designed to provide reasonable protection against harmful interference in a residential installation. This equipment generates uses and can radiate radio frequency energy and, if not installed and used in accordance with the instructions, may cause harmful interference to radio communications. However, there is no guarantee that interference will not occur in a particular installation. If this equipment does cause harmful interference to radio or television reception, which can be determined by turning the equipment off and on, the user is encouraged to try to correct the interference by one or more of the following measures:

Reorient or relocate the receiving antenna.

Increase the separation between the equipment and receiver.

Connect the equipment into an outlet on a circuit different from that to which the receiver is connected.

Consult the dealer or an experienced radio/TV technician for help.

## **FCC Radiation Exposure Statement:**

This equipment complies with FCC radiation exposure limits set forth for an uncontrolled environment. This equipment should be installed and operated with minimum distance 20cm between the radiator & your body.