

# TONOR

Voice Amplifier Instruction Manual

---

K12





## ABOUT THIS MANUAL

---

Thank you for purchasing TONOR Voice Amplifier. This manual is intended to help you understand all about this Voice Amplifier and how to use it. TONOR always strives for the ultimate user experience. All our knowledge and passion for audio technology are incorporated into building Voice Amplifier with high performance for you. The TONOR Voice Amplifier is high quality and easy to use to achieve the best user experience.

Enjoy your Voice Amplifier!

TONOR Team

## PACKAGE INCLUDING

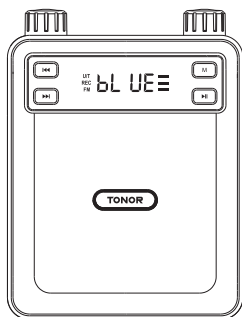

Black fast charging cable

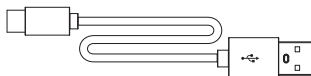

## OPERATING ENVIRONMENTS & NOTES

- When using this device, keep it away from water.
- Use the device in ventilated environment, keep it away from fire.
- Since it's a wireless device, please keep it away from other interfering sources.
- Don't take apart the device.
- Please use the standard power supply, high voltage may damage the device.
- When the battery is low, the mic or voice amplifier will automatically shut down. Please charge it.
- Recommended to use the original charging cable for all charging equipment. Or use a Type-A to Type-C charging cable.
- Not recommended to use equipment while charging.

## SPECIFICATIONS

1. Bluetooth version: V5.3
2. Frequency range: 2402-2480MHz
3. RF power: 1.6mW
4. Bluetooth Working distance: 10m
5. Wireless headset microphone Working distance: 25m
6. Frequency response: 100Hz-18kHz
7. Voice Amplifier peak power: 25W
8. Speaker: 3.25"/4Ω
9. Mic Battery: Lithium battery 3.7V/450mAh
10. Mic Charging Time: 2 hours 5V/500mA
11. Mic Battery Life: 6~8 hours
12. Voice Amplifier Battery: Lithium battery 3.7V/5000mAh
13. Voice Amplifier Charging Time: 3 hours using 5V 2A cable. And 1.5~2 hours using 9V 2.5A cable.
14. Voice Amplifier Battery Life: 12~15 hours
15. Working temperature: -10℃ ~45℃

Note: The above parameters are based on experimental data and may vary depending on actual usage conditions.

# VOICE AMPLIFIER OPERATION INSTRUCTION

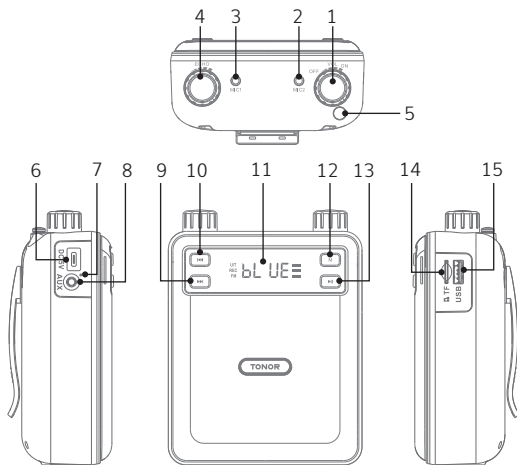

## 1. Power switch/volume adjustment

· Power on: Rotate to ON. Keep rotate to increase the volume. Rotate back to decrease the volume.

· Shut down: Rotate to OFF

## 2. 3.5mm MIC2 jack

## 3. 3.5mm MIC1 jack

## 4. ECHO

## 5. FM antenna

## 6. Type-c charging socket

## 7. Charging indicator

· When using a 5V 2A cable, the red light flashes when charging. The red light stays on when fully charged.

· When using a 9V 2.5A cable, the blue light stays on and the red light flashes when charging. The blue light goes out and the red light stays on when fully charged.

8. AUX input jack
9. Next song
10. Previous song
11. Display
12. Mode switching
  - Long press to enter recording mode.
13. Play/pause
14. TF card slot
15. USB socket

#### Charging Note:

1. If the amplifier wants to achieve fast charging, it needs to be equipped with a charger that supports fast charging and a Type-C charging cable with data function.
2. Voice Amplifier supports the input fast charging protocols of Type-C PD, Huawei FCP, Samsung AFC, and MTK PE+1.1/2.0.

## DISPLAY CONTENT

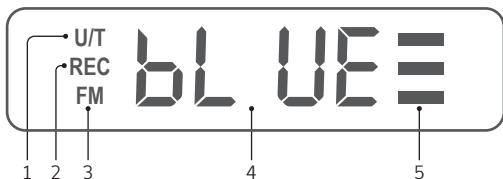

1. U/T logo: U disk or TF card mode indicator
2. Recording Indicator
3. FM Mode Indicator
4. Display area: different modes display different content
5. Voice Amplifier real-time battery
  - Flashing when charging, and always on when fully charged.
  - When the battery is low, the last indicator light column flashes and there is a voice prompt.

## REMOTE CONTROL INTRODUCTIONS

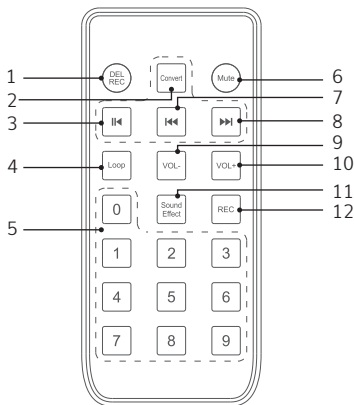

1. Delete recording
2. Mode switching
3. Play/Pause
4. Single Repeat/ Repeat All
5. Numeric buttons(Only for USB mode and TF card mode)
6. MUTE button
7. Previous song
8. Next song
9. Volume -
10. Volume +
11. EQ Mode Key
12. REC button

Note:

- Please aim at the receiver window of the speaker When using remote control.
- The remote control distance is generally about 5 meters.



## AMPLIFICATION MODE

1. Wireless amplification mode: Turn on the amplifier and wireless headset mic to automatically enter the wireless amplification mode.
2. Wired amplification mode: Turn on the amplifier, connect the headset through the 3.5mm "MIC" jack, and enter wired amplification mode.
3. Wear the headset microphone correctly and adjust the angle of the microphone.
4. To achieve good results, please adjust the microphone to 1-2cm away from your mouth.
5. Rotate to adjust to the appropriate volume.

Note: Don't put the microphone in front of the voice amplifier or too close to it, or it may cause noise.

## BLUETOOTH MODE

1. When the amplifier is in Bluetooth mode, turn on the Bluetooth of your phone, find TONOR K12 and pair it. After successful pairing, you can use your phone to play your favorite music. If your mobile phone is trying to connect to TONOR K12 for the first time, you need to click on the search device, find TONOR K12 and then pair it.

2. Long press the "Play/Pause" button for 2 seconds to disconnect the currently connected Bluetooth device.

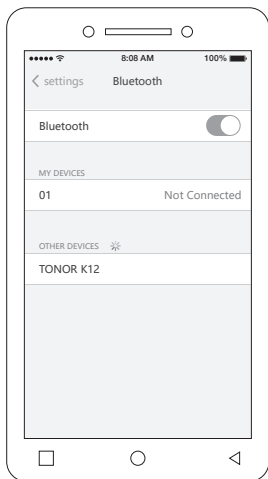

## AUX MODE

1. Use a 3.5mm audio cable to connect the amplifier to external audio source devices such as mobile phones, tablets or computers. Turn on the amplifier and play your favorite music from your phone, tablet or computer.
2. In AUX mode, press the "M" key to switch to other modes.

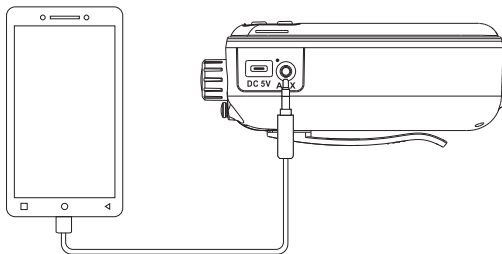

## FM RADIO MODE

1. Automatic station search: Short press the "M" button to enter FM mode. When entering FM mode for the first time, long press the "Play/Pause" button for 2 seconds to automatically search for stations. After the station search is completed, the station will be automatically saved. Short press "Previous song" or "Next song" to switch stations.
2. Manual station search: Long press "Previous Song" or "Next Song" to search for stations. After searching for a station, release the button to listen. Continue long pressing "Previous" or "Next" to retrieve new channels. Manually searched stations are not saved automatically.
3. If the signal is not good, try adjusting the FM antenna or moving the amplifier.

## TF CARD AND U DISK MODE

1. Insert the TF card or U disk, automatically switch to TF card or U disk mode. And automatically play the audio files in the TF card or U disk.
2. During playback, long press the "Play/Pause" button for 2 seconds to switch between single loop or all loops. Long press the "Rewind" button to rewind. Long press the "Forward" button to fast forward.
3. This unit has a power-off memory function. When it is turned off, it will remember the track played at that time. When you turn it on next time and use the TF card or U disk mode, it will continue playing from the breakpoint of the last track played.
4. Maximum supported capacity of TF card or U disk: 32GB
5. TF card or USB disk format: FAT32/exFAT
6. Music playback format: supports MP3

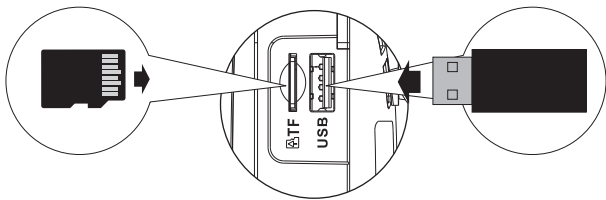

## RECORDING MODE

1. Start recording: Turn on the speaker and wireless headset microphone. Long press the "M" button to enter recording mode and start recording.
2. Stop recording: In recording mode, long press the "M" button again, then the host will automatically save the recording file and start playing the recording file.
3. Play the recording in TF card or U disk mode:
  - Quickly double-click the "M" key to enter the recording file playback mode and exit TF card or U disk mode .
  - Quickly double-click the "M" key again to exit the recording file playback mode and switch TF card or U disk mode.
4. Delete the recording: While the recording is playing, long press the "Play/Pause" button to delete the palying recording. Then star playing the next recording file. When all recording files are deleted, the speaker switches to TF card or U disk mode.

Note: Before recording, prepare a TF card or a USB flash drive and insert it into the amplifier.

## **Conditions and restrictions for using frequencies**

There may be special conditions and restrictions for using frequencies in your country.

Before putting the product into operation, find the information for your country at the following address:

<https://www.tonormic.com/pages/permitted-frequency-bands>

## **WARRANTY**

TONOR provides 2 years of after-sales service, free replacement to products that are NOT damaged resulting from accident, alteration, misuse, negligence, or abuse. If exceeding 30 days of Amazon return policy, you can still contact us through our Shopify TONOR-MIC. We will serve you with full sincerity!

## **FCC Statement**

This device complies with part 15 of the FCC Rules. Operation is subject to the following two conditions:

(1) This device may not cause harmful interference.

(2) This device must accept any interference received, including interference that may cause undesired operation.

Product Name: Voice Amplifier K12

Model Number: 24486

FCC ID: 2AZNY-24486S

FREQ.RANGE: 2402-2480MHz

Changes or modifications not expressly approved by the party responsible for compliance could void the user's authority to operate the equipment.

NOTE: This equipment has been tested and found to comply with the limits for a Class B digital device, pursuant to part 15 of the FCC Rules. These limits are designed to provide reasonable protection against harmful interference in a residential installation. This equipment generates uses and can radiate radio frequency energy and, if not installed and used in accordance with the instructions, may cause harmful interference to radio communications. However, there is no guarantee that interference will not occur in a particular installation. If this equipment does cause harmful interference to radio or television reception, which can be determined by turning the equipment off and on, the user is encouraged to try to correct the interference by one or more of the following measures:

- Reorient or relocate the receiving antenna.
- Increase the separation between the equipment and receiver.
- Connect the equipment into an outlet on a circuit different from that to which the receiver is connected.
- Consult the dealer or an experienced radio/TV technician for help.

#### Radiation Exposure Statement

The device has been evaluated to meet general RF exposure requirement. The device can be used in portable exposure condition without restriction.

MANUFACTURER: EASTWEST ELECTRONIC COMMERCE CO.,LIMITED  
ADDRESS: 6/F MANULIFE PLACE 348 KWUN TONG ROAD KL  
EMAIL: EASTWESTLIMITED123@HOTMAIL.COM

US-REP: EASTWEST ELECTRONIC COMMERCE CO US LIMITED  
ADDRESS: 3500 SOUTH DUPONT HIGHWAY, SUITE G106 DOVER, DE  
19901 UNITED STATES

MADE IN CHINA

Official Website: [www.tonormic.com](http://www.tonormic.com)  
Customer Service Email: [support@tonormic.com](mailto:support@tonormic.com)