

## Quick Start

### 1. Re:Balans patch placement and skin preparation

Trim hair\*.  
Clean the skin  
and let it dry.  
Place the patch  
2-4 cm left or  
right of spine.

\*Use hair trimmer, do not use razor.

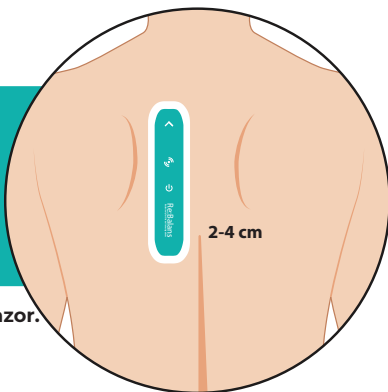

### 2. Apply the patch

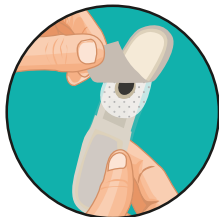

Remove release  
liner #1



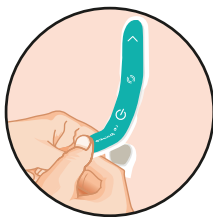

Apply the first half  
of the patch with  
arrow up.

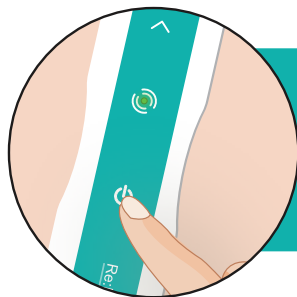

Remove release  
liner #2 and  
press patch gently.

### 3. Activate the patch



Press and hold  button  
until green light.  
If yellow light, read the  
Instructions for Use.  
Use Patch ID on this label  
for wireless connection.

## Quick Start

### Intended Use

Intended for use under the direction of a physician, for the non-invasive monitoring and management of patients with fluid management related health conditions. The device is intended to measure changes in the electrical impedance of the back of the patient. Data from the device should be considered in conjunction with other clinical data.

The device is not intended to replace standard-of-care for fluid monitoring.

### Contraindications

- 1) Patients with known allergies or skin sensitivities to electrode hydrogel and/or acrylic-based adhesives
- 2) Patients with non-intact skin such as skin breakdown where the device is to be placed
- 3) Patients with implantable pulse generators such as pacemakers and defibrillators.

### Patch ID

For wireless connection

[

L

[

L

### Storage Conditions

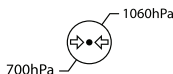
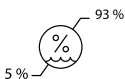

Remove prior to MR scan



Rx only

IP54

FCC-ID: 2A6Z8-PCT005

Device Version: PCT005A

Quantity: 1



A Mode Sensors product



Mode Sensors AS  
Professor Brochs Gate 2  
7030, Trondheim, Norway  
support@modesensors.com  
www.modesensors.com