

# EZCast Pocket RX & TX User Manual

Rev 1.0



Product information is subject to change without prior notice.

# Abut EZCast Pocket

## Transmitter (C-1 or H-1)

Easily mirror whatever shows on your laptop or mobile screen, ideal for video-watching, game-play, and idea sharing.

\* The Type-C connector model is the C-1, while the HDMI connector model is the H-1.

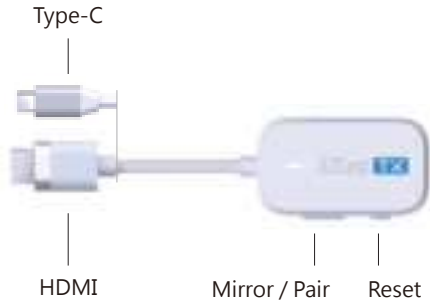

## Receiver (R-1)

Display the contents passed from your transmitter on the big screen like HDTV or projector screen.



# How to mirror

## 1 Install the receiver

Use the Type C connector to connect EZCast Receiver to the HDMI port on TV, and power on by an independent power 5V/1A adapter.

## 2 Plug and play

Plug EZCast Transmitter to Type C or HDMI port on laptop or mobile. Wait a few seconds until the flashing light on transmitter stops, and it will start mirroring automatically.

When using the Transmitter H-1 (HDMI connector), using the Type C connector connect to an independent power 5V/1A adapter.

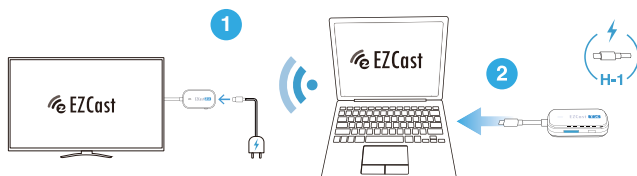

## 3 Stop and restart mirroring

Press the mirror / pair button on the transmitter to stop mirroring or restart mirroring.

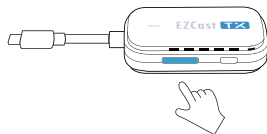

**Note :** EZCast Transmitter support mirroring for all laptops including Windows and MacOS, and Android mobiles with DP Alt output. To reset to default, press the reset button for 5s.

# How to pair Transmitter with receiver

## 1 Turn on pairing mode for the receiver

- (1) Power up the receiver by an external adapter (5V/1A).
- (2) Plug the receiver to the HDMI port on the monitor.
- (3) Press the reset button on receiver for 2 seconds. Release when the screen shows "Release the button to pair with EZCast" .

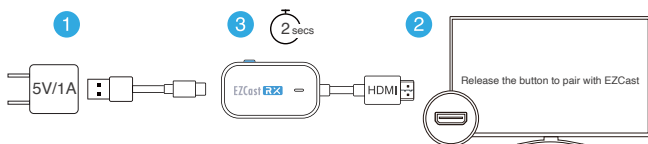

## 2 Press the Mirror / Pair button on Transmitter

Plug the transmitter on laptop or mobile, when using the Transmitter H-1 , please make sure using the Type C connector to provide power. Press the mirror / pair button on the transmitter for 5 seconds to complete pairing while the screen shows "Ready to pair" . After paired, it will start casting automatically.

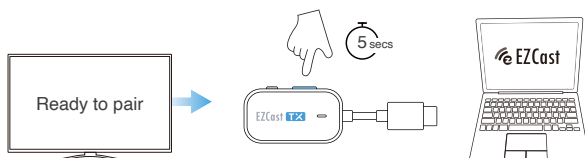

**Note :** There are 2 mode for reset button on Receiver, depending on pressing duration.

- (1) Press for 2 seconds: Turn on pairing mode for the Transmitter.
- (2) Press for 10 seconds: Reset the Receiver to default.

# OTA Upgrade

## 1 Download EZCast App

(1) Plug the receiver to the monitor, and using the Type C connector to provide power.



(2) Scan the QRCode with a computer or mobile phone, or go to [www.ezcast.com/app](http://www.ezcast.com/app) to download the EZCast app.

## 2 Connect to the Receiver

(1) Connect the mobile's or computer's Wi-Fi to the receiver.

(2) Launch EZCast, into  and select the SSID of the receiver and connect it.

(3) Into to the settings page , select Internet, and connect the receiver to the Internet.

(4) Check the icon ... on the monitor, verify the receiver is connected to the network.



## 3 Using the EZCast App to Upgrade

(1) Ensure mobile or computer is connect to same Wi-Fi as the Receiver.

(2) Launch EZCast, choose , and confirm it's link to the receiver.

(3) Automatically checks the current version status. If the most recent version is available, agree to update to complete the system upgrade.



## Product informations

### Transmitter

- Antenna: 1T1R (on board)
- Wi-Fi: 5Ghz
- Chipset: 8360D
- Interface: HDMI or Type-C

### Receiver

- Antenna: 1T1R (on board)
- Wi-Fi: 5Ghz
- Chipset: 8268D
- Interface: HDMI

### NCC 警語

取得審驗證明之低功率射頻器材，非經核准，公司、商號或使用者均不得擅自變更頻率、加大功率或變更原設計之特性及功能。低功率射頻器材之使用不得影響飛航安全及干擾合法通信；經發現有干擾現象時，應立即停用，並改善至無干擾時方得繼續使用。前述合法通信，指依電信管理法規作業之無線電通信。低功率射頻器材須忍受合法通信或工業、科學及醫療用電波輻射性電機設備之干擾。

### FCC statement

This device complies with part 15 of the FCC Rules. Operation is subject to the following two conditions: (1) this device may not cause harmful interference (2) this device must accept any interference received, including interference that may cause undesired operation.

Note: This equipment has been tested and found to comply with the limits for a Class B digital device, pursuant to part 15 of the FCC Rules. These limits are designed to provide reasonable protection against harmful interference in a residential installation. This equipment generates, uses, and can radiate radio frequency energy and, if not installed and used in accordance with the instructions, may cause harmful interference to radio communications. However, there is no guarantee that interference will not occur in a particular installation.

If this equipment does cause harmful interference to radio or television reception, which can be determined by turning the equipment off and on, the user is encouraged to try to correct the interference by one or more of the following measures:

- Reorient or relocate the receiving antenna.
- Increase the separation between the equipment and receiver.
- Connect the equipment to an outlet on a circuit different from that to which the receiver is connected.
- Consult the dealer or an experienced radio/TV technician for help.

Changes or modifications to this product not authorized by Apple could void the electromagnetic compatibility (EMC) and wireless compliance and negate your authority to operate the product.

This product has demonstrated EMC compliance under conditions that included the use of compliant peripheral devices and shielded cables between system components. It is important that you use compliant peripheral devices and shielded cables between system components to reduce the possibility of causing interference to radios, television sets, and other electronic devices.

### RF Exposure Statement( Receiver ):

To maintain compliance with FCC's RF Exposure guidelines, this equipment should be installed and operated with minimum distance of 20cm the radiator your body. This device and its antenna(s) must not be co-located or operation in conjunction with any other antenna or transmitter.

### SAR statement (Transmitter):

This device meets the government's requirements for exposure to radio waves. This device is designed and manufactured not to exceed the emission limits for exposure to radio frequency (RF) energy set by the Federal Communications Commission of the U.S. Government.

The SAR limit set by the FCC is 1.6W/Kg. For body-worn operation, this device has been tested and meets the FCC RF exposure guidelines for use with an accessory that contains no metal and positions the device a minimum of 0mm from the body. RF exposure compliance with any body-worn accessory that contains metal was not tested and certified. And use of such body-worn accessory should be avoided. Accessory available in market and must be used to keep use distance 0mm from EUT to body-worn operation.



**Website:** <https://www.EZCast.com>  
**YouTube:** <https://www.YouTube.com/EZCast>