



厦门爱立得科技有限公司
Xiamen iLead Tek Co., Ltd.

厦门市软件园三期诚毅北大街50号2101单元01室
Room 01, Unit 2101, No.50 Chengyi North Street,
Software Park Phase III, Xiamen, Fujian, China

www.ileadtek.com service@ileadtek.com 400-8550-520

peripage

爱立熊迷你标签机
产品说明书
INSTRUCTION MANUAL



Product Sketch

① Type-C

Charged with power bank or mobile phone charger

② Power Button

- Press and hold 3 seconds to turn on/off
- Double click to print device connection QR code

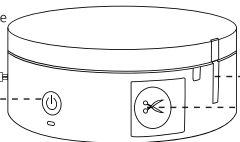

③ Paper Outlet

Paper width 14mm

④ Paper Cutting Button

Press to cut paper

Power Indicator Status

- 💡 Green light on: Normal use status.
- 💡 Red light on: Cover opened, please check the paper position and close the cover tightly.
- 💡 Red light flash: Low power, please charge in time for low battery.

App Download

- Search for "PeriPage" on google play or App store, or scan the QR code to download APP.



Download and install
"PeriPage" App

Connect to print

- Turn on the device, following the PeriPage App prompts to search and connect printer. Or double-click the power button to print QR code, scan the QR code to connect printer in PeriPage App.

🏠 Don't connect printer in the mobile phone Bluetooth settings .

Charging Instructions

- 5V \pm 1A input charging. Recommended to use mobile phone adapter for charging.
- Recommended to fully charge for the first time.
- If it is not used for a long time, please charge it every 3 months to avoid long-term natural loss of lithium battery.

Tips

- Operating ambient: 5°C-40°C ambient temperature, 45%-90%RH (Non condensing state).
- Please keep out of reach of infants and children after use.
- Don't touch the cutter blade.

Replace sticky tape

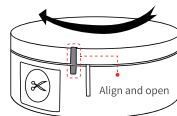

- ❶ Rotate left and align, open the cover.

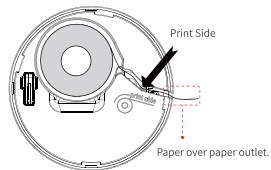

- ❷ Put the paper into paper storehouse.

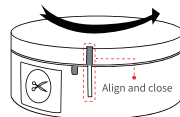

- ❸ Rotate right and align, close the cover.

FCC Statement

This device complies with part 15 of the FCC rules. Operation is subject to the following two conditions: (1) this device may not cause harmful interference, and (2) this device must accept any interference received, including interference that may cause undesired operation.

Changes or modifications not expressly approved by the party responsible for compliance could void the user's authority to operate the equipment.

NOTE: This equipment has been tested and found to comply with the limits for a Class B digital device, pursuant to part 15 of the FCC Rules. These limits are designed to provide reasonable protection against harmful interference in a residential installation. This equipment generates uses and can radiate radio frequency energy and, if not installed and used in accordance with the instructions, may cause harmful interference to radio communications. However, there is no guarantee that interference will not occur in a particular installation. If this equipment does cause harmful interference to radio or television reception, which can be determined by turning the equipment off and on, the user is encouraged to try to correct the interference by one or more of the following measures:

- Reorient or relocate the receiving antenna.
- Increase the separation between the equipment and receiver.
- Connect the equipment into an outlet on a circuit different from that to which the receiver is connected.
- Consult the dealer or an experienced radio/TV technician for help.

The device has been evaluated to meet general RF exposure requirement. The device can be used in portable exposure condition without restriction.