

ULTIMEA

Dolby Atmos

HDMI™
HIGH-DEFINITION MULTIMEDIA INTERFACE

Bluetooth®



User Manual

Nova S80

EN: User Manual

FR: Manuel de l'Utilisateur

DE: Benutzerhandbuch

IT: Manuale d'uso

JP: ユーザーマニュアル

ES: Manual del usuario

Model No.: U4120

Nova S80 5.1.2 Channel Dolby Atmos Soundbar

Contents

01	User Manual	English
	Connection and Installation	02
07	Benutzerhandbuch	Deutsch
	Anschluss und Installation	08
13	ユーザーマニュアル	日本語
	接続と設置	14
19	Mode d'Emploi	Français
	Raccordement et installation	20
25	Manuale d'uso	Italiano
	Connessione e installazione	26
31	Manual del usuario	Español
	Conexión e instalación	32

User Manual



Model No.: U4120

WE ARE
READY
TO HELP



Prefer video tutorial?

Setup guidance video, USER MANUAL or Trouble Shooting on UTIMEA website.

@ultimea_official



support.ultimea.com

+1 888-598-8875 (US) Mon-Fri 9am-5pm (PST)
 +49 89-628-25828 (EU) Mon-Fri 9am-5pm (CET)

1 ACCESSORIES LIST

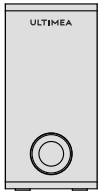

Subwoofer

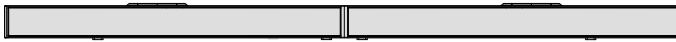

Soundbar



Surround Speaker x 2



Power Adaptor

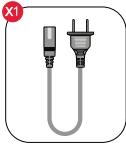

Subwoofer Power Cable

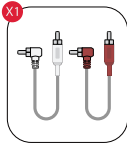

Stereo RCA to RCA Cable (6m)

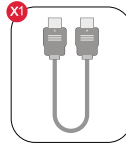

HDMI Cable

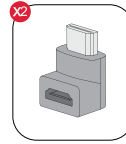

HDMI Adaptor

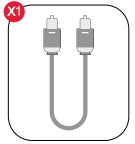

Digital Optical Cable

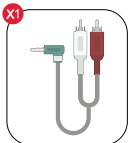

Stereo 3.5mm to RCA Audio Cable

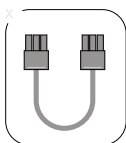

6-pin Cable for Soundbar Connection (140mm)



Remote Control

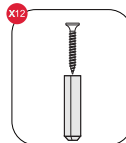

Wall Mounted Kit

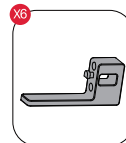

Wall Bracket



User Manual

2 SOUNDBAR CONTROLS

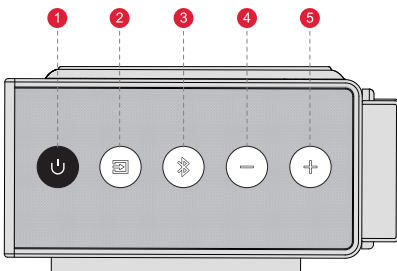

Control Panel

- 1 "Power Button": Power Button**
Press to power on / Hold for 3 seconds to power off.
- 2 "Input Mode": Input Mode**
Press to switch channels: eARC-HD IN (HDMI IN)-OPT (OPTICAL) -BT-AUX-USB.
- 3 "BT": BT**
Press to switch to Bluetooth channel and enter pairing mode. Hold for 3 seconds to disconnect the current device and connect to a new device manually on your mobile phone / PC / TV (BT ID: Nova S80).
- 4 "Volume Down": Volume Down**
- 5 "Volume Up": Volume Up**

Remote Control

- 1 "⏻": **Power Button**
Press to power on / Hold for 3 seconds to power off.
- 2 "eARC": **eARC**
Press to switch to HDMI eARC channel.
- 3 "HD IN": **HD IN**
Press to switch to HDMI IN channel.
- 4 "OPT": **OPT**
Press to switch to OPTICAL channel.
- 5 "BT": **BT**
Press to switch to Bluetooth channel and enter pairing mode.
Hold for 3 seconds to disconnect current device and connect to a new device manually on your mobile phone / PC / TV (BT ID: Nova S80).
- 6 "EQ": **EQ**
Press to switch among Movie, Dialogue, Music mode, the display will show: "MOVIE", "JLOG", "MUSIC".
- 7 "INPUT": **INPUT**
Press to switch channels: eARC-HD IN (HDMI IN)-OPT (OPTICAL)-BT-AUX-USB.
- 8 "+": **Volume Up**
- 9 "-": **Volume Down**
- 10 "<": **Previous**
For BT and USB mode only: Skip to previous track.
- 11 ">": **Next**
For BT and USB mode only: Skip to next track.
- 12 "⏮": **Play / Pause**
For BT and USB mode only.
USB mode: Hold for 3 seconds to switch between single loop playback and list loop playback.
- 13 "Dolby Atmos": **Dolby Atmos**
Press to adjust upward-firing sound level, the display will show: "AT-1", "AT 0", "AT 1".
- 14 "SURROUND": **Surround**
Press to adjust surround sound level, the display will show: "SR 2", "SR-1", "SR 0", "SR 1".
- 15 "BASS": **BASSMX™**
Press to adjust bass level, the display will show: "BS-2", "BS-1", "BS 0", "BS 1", "BS 2".
- 16 "🔇": **Mute / Recover the volume.**

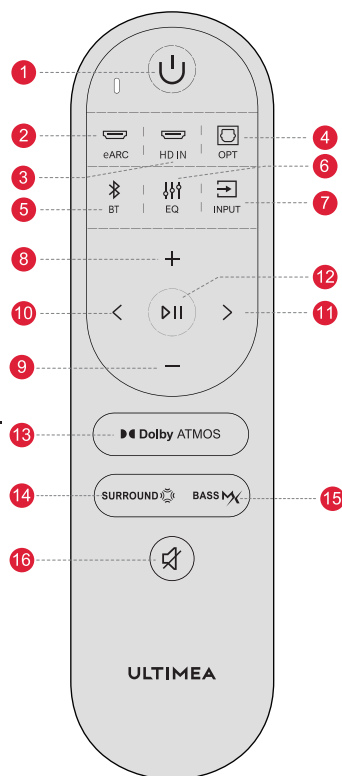

3 SOUNDBAR INSTALLATION

Assembly Steps

Step 1

Set the two parts of the Soundbar on the same level and align the connection joints. Connect the two parts by pushing parallelly to combine as one piece.

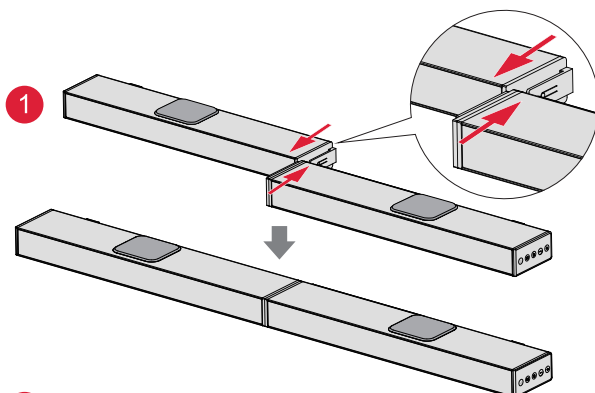

Step 2

Plug in 6pin Cable.

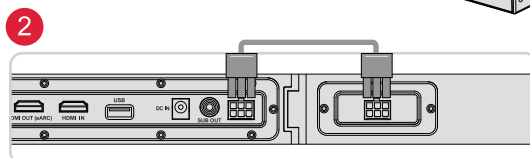

4 CONNECT TO TV VIA HDMI OUT eARC / ARC

EN

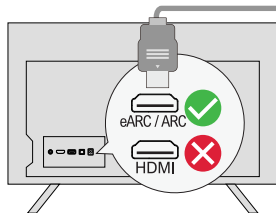

Step 1:

Connect one end of the HDMI cable to the eARC / ARC port on the back of your TV.

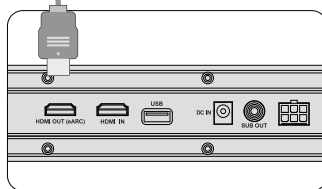

Step 2:

Then connect the other end into the HDMI OUT (eARC) port of the soundbar.

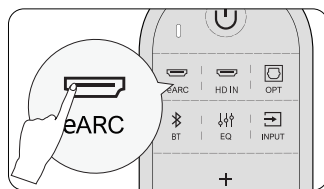

Step 3:

Press "eARC" button on the remote control to select "HDMI OUT (eARC)" input.

Note:

Make sure your TV HDMI supports eARC, otherwise the Dolby Atmos audio signal cannot be transmitted.

Atmos: If you are watching a movie in the Dolby Atmos format, please set the audio output on your TV to Pass Through:

TV Settings > Home > Settings > Sound > Digital Audio Output > Pass Through

DTS: If you are watching a movie in the DTS format, please set the audio output on your TV to PCM:

TV Settings > Home > Settings > Sound > Digital Audio Output > PCM

What's the difference between: HDMI IN, HDMI ARC, HDMI eARC?

HDMI IN is a standard HDMI input that allows you to connect devices to your TV or audio system. It supports audio and video signals, but it does not support audio return channel (ARC) or enhanced audio return channel (eARC) functionality.

HDMI ARC is a special HDMI port that supports two-way communication between your TV and audio system. This means that audio can be sent from your TV to your audio system, and audio system can send audio back to your TV.

HDMI eARC (Enhanced Audio Return Channel) is an updated version of HDMI ARC that supports higher quality audio formats such as Dolby Atmos and DTS:X.

Note: Please turn on the "CEC" function on your TV.

When eARC / ARC is connected, your TV remote control can control the soundbar and TV simultaneously:

- 1 Turn on / off
- 2 Adjust the volume

5 CONNECT TO OTHER DEVICE VIA HDMI IN

Step 1

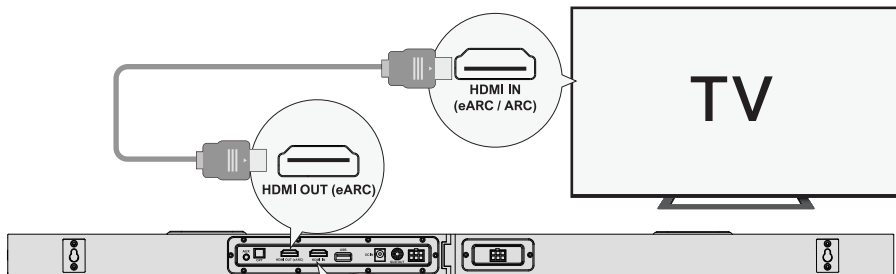

Step 2

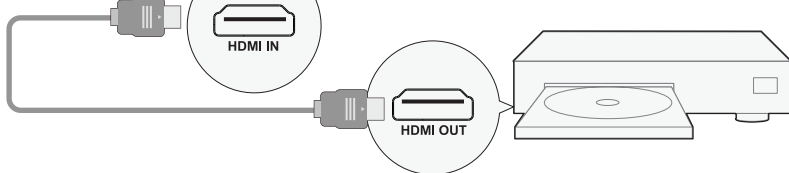

Step 3

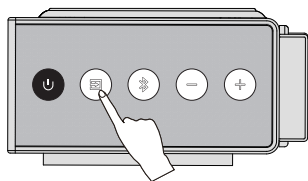

Step 1: Connect the HDMI Cable to the HDMI OUT (eARC) port on the Soundbar and the other end to the eARC / ARC port on the TV.

Step 2: Connect the HDMI cable to the HDMI OUT port on the other device (Such as DVD or game console) and the other end to HDMI IN port on the Soundbar.

Step 3: Press "HDMI IN" button on Soundbar or Remote Control to switch to HDMI IN channel.

6 CONNECT TO TV VIA OPTICAL / AUX

EN

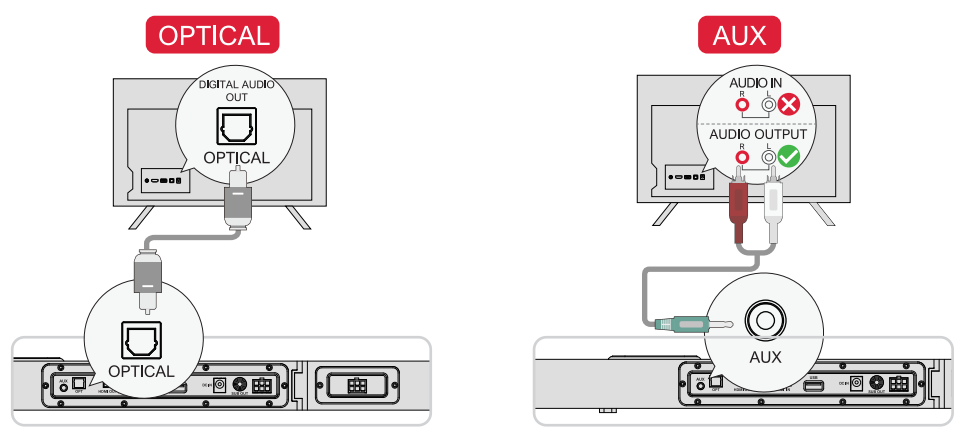

OPTION 1: OPTICAL

- 1 Make sure the cable is connected to OPTICAL OUT port on your TV, and the other end to OPTICAL port on the Soundbar.
 - 2 Make sure the optical plug is inserted correctly as it shows in the picture. Do not insert the plug upside down and break the optical.
- Note:** If audio is coming from the internal TV speakers, mute or minimize the TV volume.

OPTION 2: AUX

- 1 Connect the 3.5mm to RCA audio cable to connect to your TV's RCA AUDIO OUT port.
 - 2 Make sure the color of the cables ends matches the color of the TV ports.
- Note:** Please remember to unplug the AUX cable from TV and Soundbar when you want to switch other mode.

In Optical Mode: If there is no sound, try setting the TV audio output to PCM: TV Settings > Home > Settings > Sound > Digital Audio Output > PCM

7 CONNECT TO BLUETOOTH

- 1 Press the "Bluetooth" button on the soundbar or remote control to enter Bluetooth pairing mode.
- 2 Open your phone's Bluetooth settings, find and select "Nova S80" to connect the soundbar.

Note: If it's already in the Bluetooth mode and connected, press and hold "Bluetooth" button for 3 seconds to disconnect current device and connect to new device manually on your mobile phone / PC / TV.

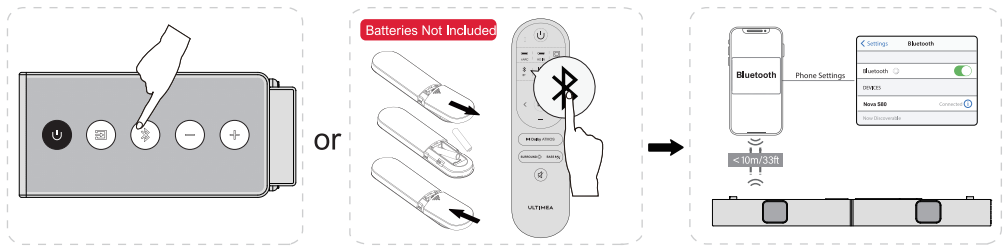

8 CONNECT TO SUBWOOFER AND SURROUND SPEAKERS

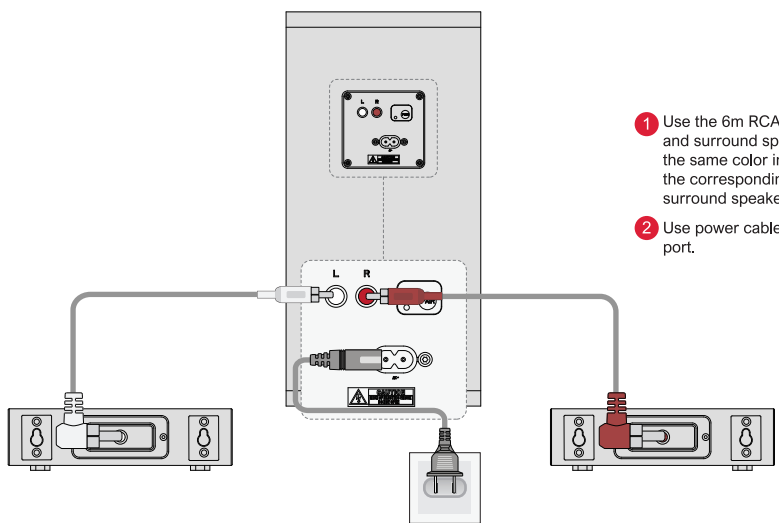

- 1 Use the 6m RCA-RCA cables to connect the subwoofer and surround speakers, please pay attention to match the same color interfaces on the surround speakers with the corresponding ones on the subwoofer and place the surround speakers accordingly.
- 2 Use power cable to connect your subwoofer and power port.

9 PAIRING SUBWOOFER

EN

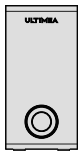

The subwoofer has been paired with the soundbar by ULTIMEA.
If there is no sound coming from the subwoofer, you need to re-pair the Soundbar with the subwoofer.



Step 1

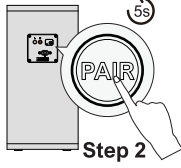

Step 2

Step 1

Press and hold the "BASS" button on the remote control for 5 seconds, the display will show "SUB" flashing.

Step 2

Press and hold the PAIR button on subwoofer for 5 seconds, the white LED will be fast flashing.

The white LED will be always on when the subwoofer is paired successfully.

10 PLACEMENT OPTIONS

Full 360° Surround (Better Surround)

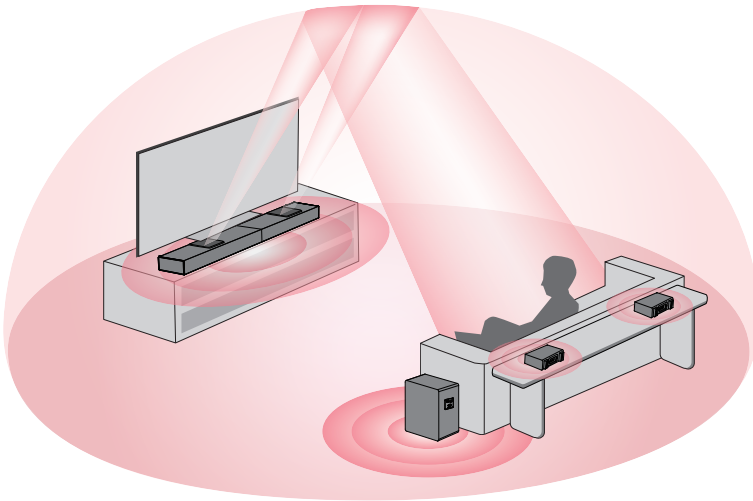

Front Surround

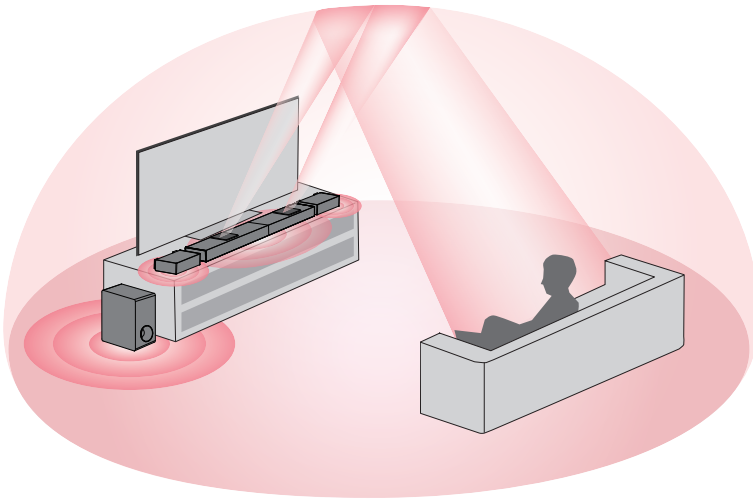

- 1 For a better listening experience, please choose one of the two placement options shown in the illustration above based on your home environment.
- 2 The soundbar and surround speakers should be placed at or near ear level.

11 WALL MOUNT INSTALLATION

EN

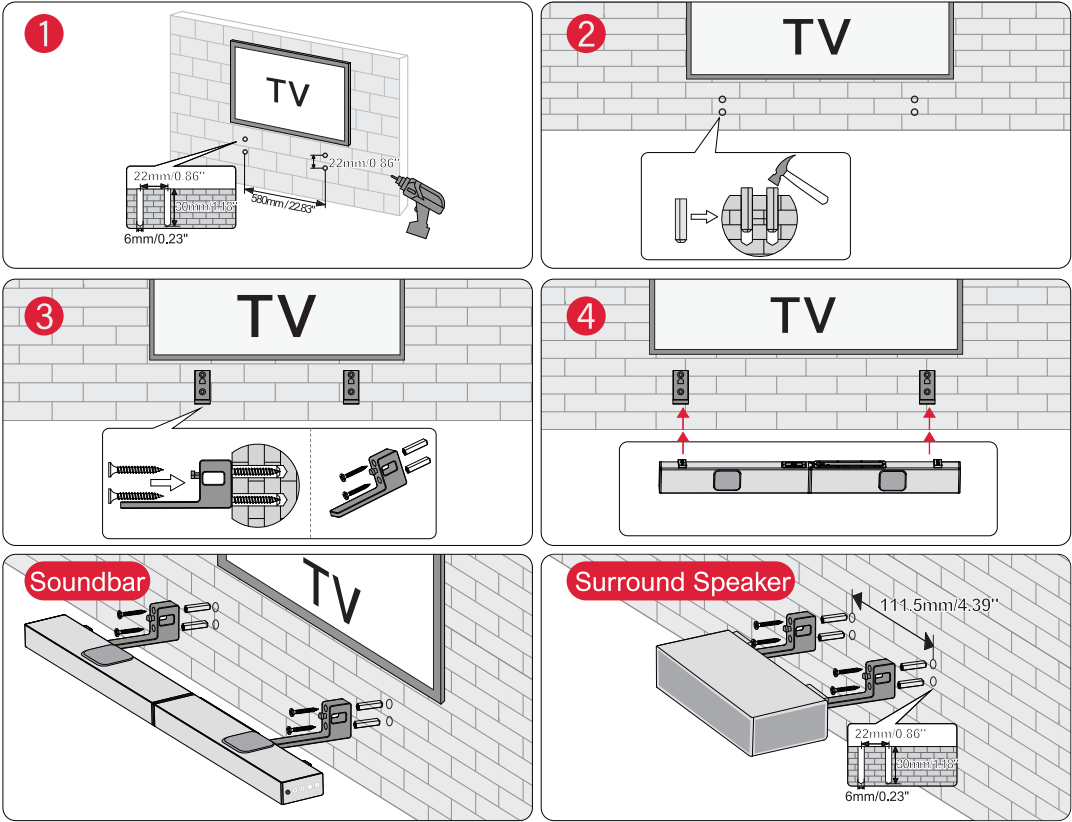

Note: Please use the HDMI Adaptor for easy plugging and unplugging of the HDMI Cable.

12 SPECIFICATIONS

Model Number	U4120
Power Supply	AC 100-240V, ~50/60Hz
Soundbar Drivers	(3.1" x 1.2") x 3 (Soundbar) + 1.8" x 2 (upward-firing Driver) + (3.1" x 1.2") x 2 (Surround Speaker) + 8" (Subwoofer)
Frequency Response	35Hz - 18kHz
Standby Power	<0.5W
Operating Temperature	0°C - 45°C / 32°F - 113°F
Bluetooth Version	5.3

Dimensions and Weight		
Soundbar	800(W) x 38(H) x 90(D)mm	31.5" x 1.5" x 3.5"
Subwoofer	315(W) x 385(H) x 190(D)mm	12.4" x 15.2" x 7.5"
Surround Speaker	150(W) x 38(H) x 82(D)mm	5.9" x 1.5" x 3.2"
Packaging	472(W) x 306(H) x 430(D)mm	15.6" x 12" x 16.9"
Net Weight	6.7kg / 14.77lbs	
Gross Weight	8.94kg / 19.71lbs	

SAFETY INSTRUCTIONS

Please read this user manual carefully and save it for future reference.

Do not make unauthorized alterations to the product, doing so may compromise safety, regulatory compliance, system performance, and may void the warranty.

- Avoid dropping.
- Do not disassemble.
- Do not submerge in water
- Avoid extreme temperatures.
- Do not use the device outdoors during thunderstorms.
- Use original or certified cables.
- Do not place dangerous items on top of this device (e.g. liquid filled objects, lit candles).
- Clean with a dry, soft lint-free cloth. Do not use any corrosive cleaner or oil.
- To avoid hearing damage, do not listen for extended periods at high volume.
- Do not expose the batteries to extreme heat sources such as direct sunlight or open flames.
- The ideal operating temperature for this product and its accessories is between 41°F/5°C and 95°F/35°C.
- The adapter should be installed near the device and should be easily accessible.
- Do not use this product in environments of extreme heat or cold. Never expose this device to strong sunshine or wet environments.

PROPER DISPOSAL INSTRUCTIONS



This mark shown on the product or its packaging, indicates that this product should not be disposed of with other household waste at the end of its working life.

To prevent possible harm to the environment or human health from uncontrolled waste disposal, please separate this from other types of wastes and recycle it responsibly to promote the sustainable reuse of material resources.

Waste Electrical & Electronic Equipment

Household user should contact either the retailer where they purchased this product, or their local government office, for details of where and how they can take this item for environmentally safe recycling.

Business users should contact their suppliers and check the terms and conditions of the purchase contract. This product should not be mixed with other commercial wastes for disposal.

FCC REGULATORY COMPLIANCE

Any changes or modifications not expressly approved by the party responsible for compliance could void the user's authority to operate the equipment.

This device complies with Part 15 of the FCC Rules.

Operation is subject to the following two conditions:

- (1) This device may not cause harmful interference.
- (2) This device must accept any interference received, including interference that may cause undesired operation.

NOTE: This equipment has been tested and found to comply with the limits for a Class B digital device, pursuant to part 15 of the FCC Rules. These limits are designed to provide reasonable protection against harmful interference in a residential installation. This equipment generates, uses, and can radiate radio frequency energy, and if not installed and used in accordance with the instructions, may cause harmful interference to radio communications.

However, there is no guarantee that interference will not occur in a particular installation. If this equipment does cause harmful interference to radio or television reception, which can be determined by turning the equipment off and on, the user is encouraged to try to correct the interference by one or more of the following measures:

- Reorient or relocate the receiving antenna.
- Increase the separation between the equipment and the receiver.
- Connect the equipment to an outlet on a circuit different from that to which the receiver is connected.
- Consult the dealer or an experienced radio / TV technician for help.

This equipment complies with FCC radiation exposure limits set forth for an uncontrolled environment. This equipment should be installed and operated with a minimum distance of 20cm between the radiator & your body. This transmitter must not be co-located or operating in conjunction with any other antenna or transmitter.

ISED WARNINGS

This device contains licence-exempt transmitter (s) / receiver (s) that comply with Innovation, Science and Economic Development Canada's licence-exempt RSS (s). Operation is subject to the following two conditions:

- (1) This device may not cause interference.
- (2) This device must accept any interference, including interference that may cause undesired operation of the device.

L'émetteur/récepteur exempt de licence contenu dans le présent appareil est conforme aux CNR d'Innovation, Sciences et Développement économique Canada applicables aux appareils radio exempts de licence. L'exploitation est autorisée aux deux conditions suivantes:

- (1) L'appareil ne doit pas produire de brouillage;
- (2) L'appareil doit accepter tout brouillage radioélectrique subi, même si le brouillage est susceptible d'en compromettre le fonctionnement.

The device meets the exemption from the routine evaluation limits in section 2.5 of RSS 102 and compliance with RSS-102 RF exposure, users can obtain Canadian information on RF exposure and compliance.

Le dispositif rencontre l'exemption des limites courantes d'évaluation dans la section 2.5 de RSS 102 et la conformité à l'exposition de RSS-102 rf, utilisateurs peut obtenir l'information canadienne sur l'exposition et la conformité de rf.

This transmitter must not be co-located or operating in conjunction with any other antenna or transmitter. This equipment should be installed and operated with a minimum distance of 20 centimeters between the radiator and your body.

Cet émetteur ne doit pas être Co-placé ou ne fonctionnant en même temps qu'aucune autre antenne ou émetteur. Cet équipement devrait être installé et actionné avec une distance minimum de 20 centimètres entre le radiateur et votre corps.

Declaration of Conformity

We (Manufacturer is responsible for this declaration)
Dyanic (Shenzhen) Technology Limited
(Company name)

20th Floor, Building 4, Tianan Cloud Park, Bantian St.,
Longgang District Shenzhen, China 518000
(Company address)

Declare under our sole responsibility that the product
Trade Mark: ULTIMEA
Product Name: Nova S80 5.1.2 Channel Dolby Atmos Soundbar
Model No.: U4120
To which this declaration relates is in conformity with
the essential
requirement set out in the Council Directive on the
Approximation of the laws of the Member States
relating to RED Directive (2014/53/EU) & RoHS (2011/
65/ EU) product is responsible to affix CE marking, the
following standards were applied:

EN 55032:2015/A11:2020
EN 55035:2017/A11:2020
ENIEC 61000-3-2:2021
EN 61000-3-3:2013/A1:2021
ETSIEN 301 489-1 V2.2.3(2019-11)
ETSIEN 301 489-17 V3.2.4(2020-09)
EN 300 328 V2.2.2(2019-07)
EN 50663:2017
ENIEC 62368-1:2020+A11:2020
IEC62321-3-1:2013
IEC 62321-4:2013+A1:2017
IEC 62321-5:2013
IEC 62321-6:2015
IEC 62321-7-1:2015
IEC 62321-7-2:2017
IEC 62321-8:2017

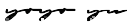
Full Name: Yoyo.Yu
Position: Approbation Manager
Signature: 
Place/Date: Shenzhen, China / Dec. 25-2022

Trade Marks:



Dolby, Dolby Vision, Dolby Atmos, and the double-D symbol are registered trademarks of Dolby Laboratories Licensing Corporation. Manufactured under license from Dolby Laboratories. Confidential unpublished works. Copyright© 1992-2021 Dolby Laboratories. All rights reserved.



The Bluetooth® word mark and logos are registered trademarks owned by Bluetooth SIG, Inc. and any use of such marks by Soundlab Technology Co.,Ltd. is under license. Other trademarks and trade names are those of their respective owners.



The Adopted Trademarks HDMI, HDMI High-Definition Multimedia Interface, HDMI trade dress and the HDMI Logos are trademarks or registered trademarks of HDMI Licensing Administrator, Inc. in the United States and other.

ULTIMEA

Nova S80 5.1.2 Channel Dolby Atmos Soundbar
Model No.: U4120

EC

REP

Dyanic GmbH
Buchenring 57, 22359 Hamburg, Germany

UK

REP

UK Crossborder limited
7 Bell Yard London WC2A 2JR, UK United Kingdom

Made in China
Manufacturer: Dyanic (Shenzhen) Technology Limited
Address: 20th Floor, Building 4, Tianan Cloud Park, Bantian St.,
Longgang District, Shenzhen, China 518000

If you need our support, kindly reach out to our
service team. We are always glad to help.



+1 888-598-8875 (US)
Mon-Fri 9am-5pm (PST)
+49 89-628-25828 (EU)
Mon-Fri 9am-5pm (CET)



support@ultimea.com
support@ultimea.de



support.ultimea.com
support.ultimea.de













@ultimea_official