

# SRP620 Series

## Quick Start Guide

### Welcome to the SRP Series

SRP series ruggedized outdoor router provides 5G NR service in a ruggedized form factor. With an operating temperature range of -40°C ~ 70°C endurance, they offer industrial-grade environmental qualifications while providing higher speed data services for video and other bandwidth-intensive applications. SRP series industrial router has very strong anti-vibration ability and it is qualified for extreme industrial environments and ideally suited for rail, transportation, mining, oil and gas, manufacturing, and other outdoor applications.

With the diverse self-developed 5G NR embedded modules integrated, SRP series industrial router can support multi-band for Private 5G NR, even support uncommon frequencies. SRP series industrial router can provide accurate real-time location information.

This document will serve as a quick start guide for SRP series ruggedized outdoor router. In this document, the SRP series ruggedized outdoor router will be replaced by the router.

### Device Architecture

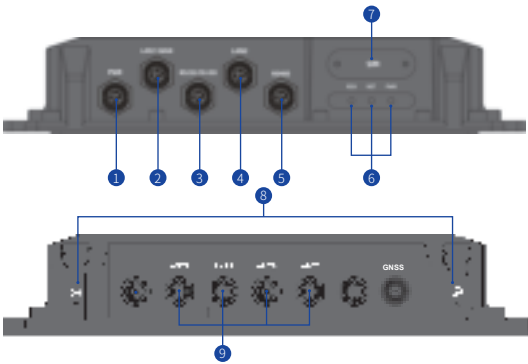

- 1 Power port
- 2 LAN1/WAN port
- 3 RS232 and DIDO port
- 4 LAN2 port
- 5 RS485 port
- 6 LED interface
- 7 SIM interface
- 8 Ground screws
- 9 5G NR antenna interface

**Note1** The reset button is beside SIM interface, if press 1s, router will restart; If press on for 10s, the router will reset to factory defaults.

**Note2** There are two white ground screws also at behind of device.

### RS232/485 Cable Definition

RS232/485 cable definition				
Number	Colors	RS485	RS232+DIDO	
1	Orange&white	NC	DO2	
2	Orange	NC	DI2	
3	Green&white	RS_GND	DO1	
4	Blue	RS_GND	DI1	
5	Blue&white	RS_GND	RS_GND	
6	Green	RS_GND	RS_GND	
7	Brown&white	RS485_B	RS232_TX	
8	Brown	RS485_A	RS232_RX	

### LAN/WAN Cable Definition

LAN/WAN cable definition			
Number	Colors	LAN/WAN	
1	Orange&white	MDI0-/RJ45-1	
2	Orange	MDI0-/RJ45-2	
3	Green&white	MDI1-/RJ45-3	
4	Blue	MDI2-/RJ45-4	
5	Blue&white	MDI2-/RJ45-5	
6	Green	MDI1-/RJ45-6	
7	Brown&white	MDI3-/RJ45-7	
8	Brown	MDI3-/RJ45-8	

### Power Cable Definition

Power cable definition			
Number	Colors	PWR	
1	Red	PWR_Positive	
2	Black	PWR_GND	
3	NC	NC	
4	NC	NC	

### Working Environment

Operating Temperature	-40°C ~ 70°C
Storage Temperature	-40°C ~ 80°C
Humidity	5% ~ 95%
Power Supply	9 ~ 36VDC
Power Consumption	<20W
Water and Dustproof	IP67

### Packing List

Items	Accessories	Qty
1	A-Code cable to RJ45 jack ADC2 (Ethernet cable)	1
2	A-Code 8-Pin cable ADB1 (Data cable)	1
3	A-Code 4-Pin cable M12A (Power cable)	1
4	Mounting bolt	4
5	Grounding cable	1
6	Protective cap (TNC)	6
7	Protective cap (M12)	5

### Hardware Configuration

#### Install SIM Cards

**Step1** Use a cross screwdriver to remove the SIM card cover.

**Step2** Slide the SIM cards into the SIM slots until they click into place. By default, the SIM card in slot 1 (the upper slot) is the Primary SIM card. When the SRP router is powered on or rebooted, it automatically connects to the network associated with the Primary SIM card.

**Step3** Re-attach the cover.

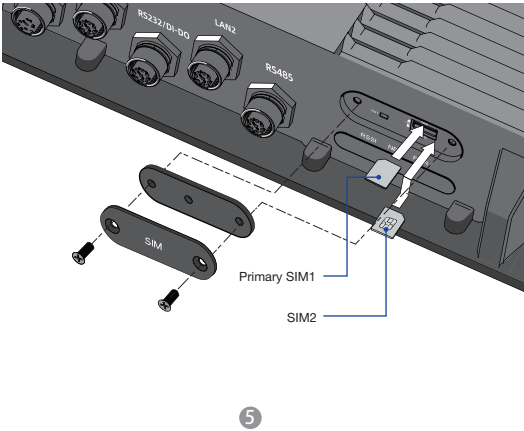

### Connect and Turn on the Router

Please connect the protecting ground cable as first step, connect 9-36 VDC power cable as the last step.

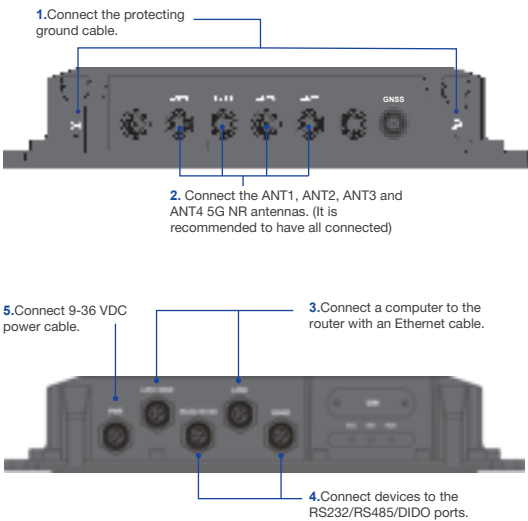

### Connect to the Network

When the router is powered on, a green PWR LED may occur. This indicates that the power input is good.