

Smart Plug User Manual

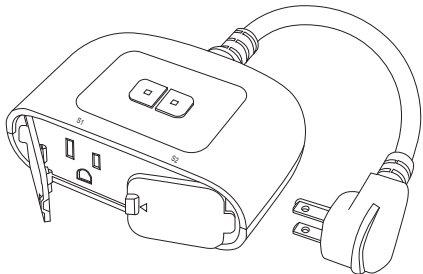

Model: SPU027

IP44

Safety Information

- The plug is waterproof to IP44, so avoid immersing or rinsing the socket in water.
- Avoid exposure to high temperatures, direct sunlight, or moisture.
- The maximum capacity is 1800 W. Any overload may result in a risk of fire or damage to the device.
- Keep the device away from heat sources or flammable materials.
- Avoid using the device in high-humidity areas like bathrooms.
- Do not disassemble. The device does not contain any serviceable parts. In case of a malfunction, please contact the service.
- Do not continue to use the device if there is visible damage.
- Make sure to use this product together with 15A circuit breaker in the upstream.

Intended use

This product is intended as a smart plug to remotely control your home appliances.

This product has a power monitor to measure electric power values.

This plug complies with the protection class IP44 if the appliance device plug is splash-proof (IP44) as well.

Introduction

Before use, please ensure the package is complete and undamaged. The package should include:

- Outdoor Smart Plug
- User Manual

Specifications

Model Number	SPU027
FCC ID	2APQK-SPU027
IC	28612-SPU027
Material	PC+ABS
Rated Voltage	120V~, 60Hz
Max. Load	15A 1800W
Working Temp	-20~40°C
Waterproof Rating	IP44
Support System	Android 4.4 & iOS 8.0 and above
Wi-Fi Standard	IEEE 802.11 b/g/n; 2.4 GHz only
Wi-Fi Connectivity Range	Up to 300 feet (Open Space)
Security Mechanism	WPA/WPA2/WPA3
Encryption Type	WEP/TKIP/AES

Device Overview

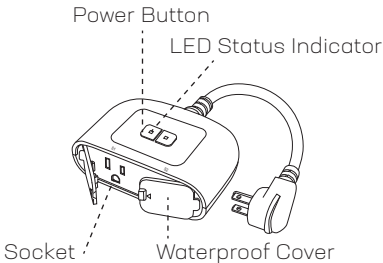

Power Button:

- Press each Power Button to turn the corresponding socket ON or OFF.
- Press and hold (for 5 seconds) until the LED flashes to initiate the app onboarding process or switch the indicator flashing state.
- Press and hold for 5 seconds while the indicator light is flashing to toggle the flashing state.

Installation

1. Search and download Smart Life APP in Google Play Store or APP Store.

If you cannot find Smart Life APP, please scan the following QR code.



2. Open the Smart Life APP, create a Smart Life account and log in. If you already have one, please log in directly.
3. Plug the smart plug into the socket.
4. Choose one of the following three connection methods to connect. It is recommended to follow the first one (BLE Mode).

Notice:

- a. Please make sure the distance between the smart plug and the router is within 100ft.
- b. Before starting the connection, make sure your mobile phone has its Bluetooth turned on and is connected to the 2.4GHz WiFi network only.

A)BLE Mode(Recommended):

Step 1. Turn on the Bluetooth of your mobile phone and connect your phone to the 2.4GHz Wi-Fi network.

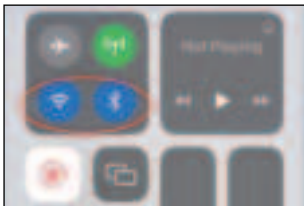

Step 2. Connect the plug to the power source and long press any of the power button for more than 5s till the indicator flashes.



Step 3. Launch the Smart Life app, the device will be found automatically.

Step 4. Tap Add and enter the name and password of the 2.4GHz Wi-Fi network.

Step 5. Wait for connection (may take up to 2 minutes).



B) AP Mode

Step1. Connect your phone to the 2.4GHz Wi-Fi Network.

Step2. Long press any of the power button for 5s till the indicator flashes slowly(1 time every 2 seconds); If it's flashing quickly, press and hold for 5s to switch to slow flashing mode.

Step3. Launch Smart Life APP>Tap Add device >Choose "Socket (Wi-Fi)">Enter the name & password of the 2.4GHz Wi-Fi Network >Tap "Blink Slowly".

Step4. Connect your plug to the hotspot named SmartLife-XXXX or SL-XXXX, and back to Smart Life APP.

Step5. Wait for connection (may take up to 2 minutes).

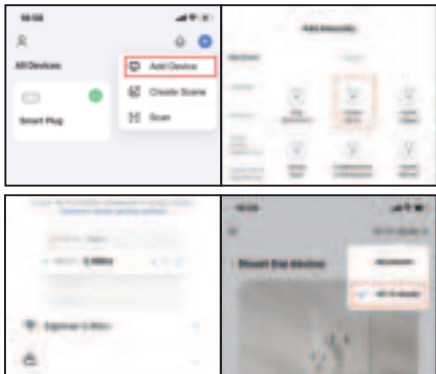

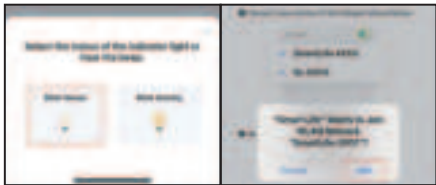

C)EZ Mode:

Step 1. Connect your phone to the 2.4GHz Wi-Fi Network.

Step 2. Long press any of the power button till the indicator flashes quickly (Flashes twice per second).

Step 3. Launch the Smart Life app and tap "Add device".

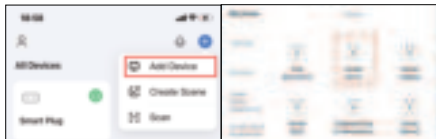

Step 4. Choose "Socket (Wi-Fi)" and enter the name and password of the 2.4GHz Wi-Fi Network.

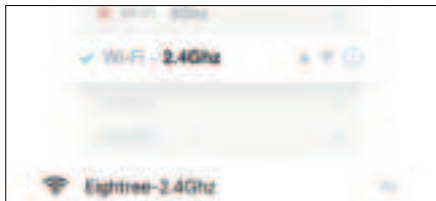

Step 5. Tap "Blink Quickly".

Select the status of the indicator light or hear the beep:

Blink Slowly

Blink Quickly

Step 6. Wait for connection (may take up to 2 minutes).

Third Party Control (Alexa, SmartThings and Google Assistant)

Step 1. Make sure you have connected the plug to the "Smart Life" App first.

Step 2. Launch the Smart Life app > Tap "Me" > Third-party service > Follow the app prompts.

Functions:

1. Remote control: Turn on/off the device remotely through the mobile phone anytime, anywhere.
2. Timer:
 - a. Schedule: Schedule your smart plug to turn on/off automatically to simplify your daily routine;
 - b. Countdown: Set the countdown timer and your smart plug will automatically be toggled after the time ends (e.g., 1: turn on/off the plug after 10 mins);
 - c. Delay off: When the device is turned on, it will be automatically turned off at the end of the set time (e.g., 2: turn off the plug after 10 mins);
3. Scene: Turn the plug on/off based on changes in weather, location, or device status, etc.
4. Group Control: The app allows you to control multiple devices at the same time and create groups for easy management.

5. Device Sharing: Share the control of the outdoor smart plug with your family members.
6. Remote & Voice Control: Tap the corresponding socket button on the app to turn on/off the plug. Alternatively, use a voice command to turn on/off the plug.
7. Power meter function Optional.
The integrated power meter allows you to watch both the live and previous power measurements of the smart plug, so you can see how much electricity a product is using or has been using for each day of the last year.

Troubleshooting

1.Fail to connect to Wi-Fi

- Make sure the distance between the smart plug and the router is within 100ft;
- Check the Wi-Fi connection of the smart plug (Only Support 2.4GHz Wi-Fi);
- Make Sure the Wi-Fi name and password you entered is correct.

2.Device Offline

- Make Sure your Wi-Fi signal is good and stable;
- Check if the Wi-Fi name or password has been changed.
- Try to reset the smart plug.

3.The smart plug can be turned on/off via APP, but the connected device does not work

- Manually turn the plug on/off to see if the LED lights up/off normally to eliminate the socket faults;

- Ensure the connected device is compatible and functioning properly.
- If the plug is defective, please contact our support team for a new replacement or refund.

FCC Statement

This equipment has been tested and found to comply with the limits for a Class B digital device, pursuant to part 15 of the FCC rules. These limits are designed to provide reasonable protection against harmful interference in a residential installation. This equipment generates, uses and can radiate radio frequency energy and, if not installed and used in accordance with the instructions, may cause harmful interference to radio communications. However, there is no guarantee that interference will not occur in a particular installation. If this equipment does cause harmful interference to radio or television

reception, which can be determined by turning the equipment off and on, the user is encouraged to try to correct the interference by one or more of the following measures:

Reorient or relocate the receiving antenna.

Increase the separation between the equipment and receiver.

Connect the equipment into an outlet on a circuit different from that to which the receiver is connected. Consult the dealer or an experienced radio/TV technician for help.

To assure continued compliance, any changes or modifications not expressly approved by the party. Responsible for compliance could void the user's authority to operate this equipment.

[Example use only shielded interface cables when connecting to computer or peripheral devices].

This equipment complies with Part 15 of the FCC Rules. Operation is subject to the following two conditions:

[1] This device may not cause harmful interference.

[2] This device must accept any interference received, including interference that may cause undesired operation. FCC Radiation Exposure Statement:

The equipment complies with FCC Radiation exposure limits set forth for uncontrolled environment. This equipment should be installed and operated with minimum distance 20cm between the radiator and your body.

IC Warning

-English-This device complies with Industry Canada licence-exempt RSS standard.

Operation is subject to the following two conditions: [1] this device may not cause interference. and [2] this device must accept any interference, including interference that may cause undesired operation of the device. Under Industry Canada regulations, this radio

transmitter may only operate using an antenna of a type and maximum [or lesser] gain approved for the transmitter by Industry Canada. To reduce potential radio interference to other users, the antenna type and its gain should be so chosen that the equivalent isotopically radiated power [e.i.r.p.] is not more than that necessary for successful communication.

ISED Radiation Exposure Statement:

The equipment complies with ISED Radiation exposure limits set forth for uncontrolled environment. This equipment should be installed and operated with minimum distance 20cm between the radiator and your body.

-French-Le présent appareil est conforme aux CNR d'Industrie Canada applicables aux appareils radio exemptés de licence. L'exploitation est autorisée aux deux conditions suivantes:

- [1] l'appareil ne doit pas produire de brouillage, et
- [2] l'utilisateur de l'appareil doit accepter tout

brouillage radio électrique subi, même si le brouillage est susceptible d'en compromettre le fonctionnement.

Selon les règlements d'Industrie Canada, cet émetteur radio ne peut fonctionner qu'à l'aide d'une antenne d'un type et d'un gain maximal [ou moindre] approuvé pour l'émetteur par Industrie Canada. Pour réduire les interférences radio électriques potentielles avec d'autres utilisateurs, le type d'antenne et son gain doivent être choisis de telle sorte que la puissance équivalente rayonnée [p.i.r.e.] ne soit pas supérieure à celle nécessaire pour une communication réussie. Déclaration d'exposition aux rayonnements de l'ISED: L'équipement est conforme aux limites d'exposition aux rayonnements de l'ISED fixées pour un environnement non contrôlé. Cet équipement doit être installé et utilisé avec une distance minimale de 20 cm entre le radiateur et votre corps.

NOTE 2: Any changes or modifications to this unit not expressly approved by the party responsible for compliance could void the user's authority to operate the equipment.

