



USER MANUAL SMART WATCH

Downloading the App

Scan the following QR code, download and install the App.



Scan QR Code and Download

Charging and Active

Charging the device to active before the first time using;
To charge your device, plug the charging cable into the adapter or USB port on your computer.

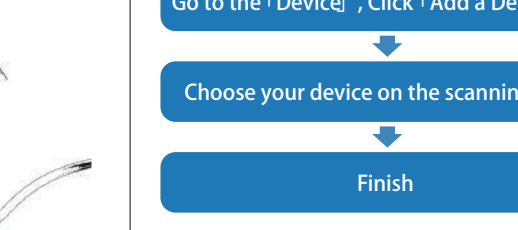

Pairing

Open the App and set up your profile

Go to the 「Device」, Click 「Add a Device」

Choose your device on the scanning list

Finish

Long press the 「time page」 on your device, go to the detail page. The MAC address on the detail page could help you identify your device on the scanning list.

Smart Watch Features

Sports

Smart Watch automatically tracks Steps taken, Calories burned, Distance traveled and displays on the screen.

NOTE: Your movement stats reset to zero at midnight.

Sleep

If you keep wearing Smart Watch in your sleep, it can provide the hours slept and quality of sleep stats on both the screen and the APP.

NOTE: Sleep stats reset to zero at 8:00 pm.

Smart Watch Features

Heart Rate Test

Tap to the heart rate page to start measuring your heart rate. On the heart rate page, It can show the heart rate measured data of the last-7-times.

Training

Tap to the training page to start a new training measure recording, there are 8 sport modes to be chosen. The last training recording will be shown on the training page.

Smart Watch Features

Blood Pressure Test

Tap to the blood pressure page to start measuring your blood pressure. On the blood pressure page, It can show the blood pressure measured data of the last-7-times.

SpO2 Test

Tap to the SpO2 page to start measuring your SpO2. On the SpO2 page, It can show the SpO2 measured data of the last-7-times.

Smart Watch Features

Weather

It could show the weather info of current and tomorrow on the weather page. Weather info is synced after connecting with the APP, it will not be updated after a long disconnected.

Messages Reminder

The device can sync incoming notifications from Twitter, Facebook, Whatsapp, Instagram etc. Recently 3 messages can be stored. Note: You can switch of/off the incoming notification in the APP.

Smart Watch Features

Remote Shutter

After connecting the device can remote control the camera on your phone.

Music Play Contraller

After connecting the device can remote control the music player on your phone.

Smart Watch Features

Other Features

Other features include stopwatch, brightness adjustment, mute mode, factory reset, and power off.

Stop Watch

Tap to on the stopwatch page to start timing, and long press again to stop timing.

Smart Watch Features

Silent Alarms

Set up the alarm on the APP, the device will vibrate to remind on time.

Remind to Move

The device will vibrate to remind you to make a relax after 1 hour sitting. Note: You can switch on/off the feature in the APP.

Getting to Know Your Device

1.Using in Wet Conditions

Your device is water-resistant, which means it is rain-proof and splash-proof and can stand up to even the sweatiest workout. NOTE: Do not swim with your Smart Watch. We also don't recommend showering with your wristband; though the water won't hurt the device, wearing it 24/7 does not give your skin a chance to breathe. Whenever you get your bracelet wet, dry it thoroughly before putting it back on.

2.Using the Touch Button

Single tap the Touching Area under the main screen to wake up the device and switch to other functional pages. Long press the Touching Area to enter for more functions which is needed.

3.Using Quick View

With Quick View you can check the time or the message form your phone on your Smart Watch without taping. Just turn your wrist towards you and the time screen will appear for a few seconds.

General Info & Specifications

1.Environmental Conditions

Operating temperature: 14℉ to 122℉ (-10℉ to 50℉)
Non-operating temperature: -4℉ to 140℉ (-20℉ to 60℉)

2.Size

Fits a wrist between 5.5 and 7.7 inches in circumference.

3.Disposal and Recycling

Please kindly be aware that it is the consumer's responsibility to properly dispose and recycle Smart Watch and accompanying components. Do not dispose of Smart Watch with common household waste, the Smart Watch unit is considered electronic waste and should be disposed of at your local electronic equipment collection facility. For more information, please contact your local electronic equipment waste management authority or the retailer where you bought the product.

This equipment has been tested and found to comply with the limits for a Class B digital device, pursuant to Part 15 of the FCC Rules. These limits are designed to provide reasonable protection against harmful interference in a residential installation. This equipment generates, uses and can radiate radio frequency energy and, if not installed and used in accordance with the instructions, may cause harmful interference to radio communications. However, there is no guarantee that interference will not occur in a particular installation. If this equipment does cause harmful interference to radio or television reception, which can be determined by turning the equipment off and on, the user is encouraged to try to correct the interference by one or more of the following measures:
-- Reorient or relocate the receiving antenna.
-- Increase the separation between the equipment and receiver.
-- Connect the equipment into an outlet on a circuit different from that to which the receiver is connected.
-- Consult the dealer or an experienced radio/TV technician for help.

This equipment complies with FCC radiation exposure limits set forth for an uncontrolled environment. This transmitter must not be co-located or operating in conjunction with any other antenna or transmitter.

changes or modifications not expressly approved by the party responsible for compliance could void the user's authority to operate the equipment.

This device complies with Part 15 of the FCC Rules. Operation is subject to the following two conditions: (1) this device may not cause harmful interference, and (2) this device must accept any interference received, including interference that may cause undesired operation