

Uniden®



AppCam 50HD

3MP Wi-Fi Camera

User Manual

Uniden Security Cloud

3MP
Resolution

180° Field
of View

Two-way
Audio

Cloud
Ready

Night
Vision

Remote
Viewing

Welcome to a simpler, smarter way to protect your home.

The Uniden AppCam 50HD is a versatile WiFi camera that can be used with Uniden Security Cloud.



To use the AppCam 50 HD without cloud storage, see the Uniden One Setup Guide.

Appearance

Name	Description
------	-------------

Power Input	Micro USB interface for the power supply (5V). Plug the power cable into the power input interface to power on the camera.
--------------------	--

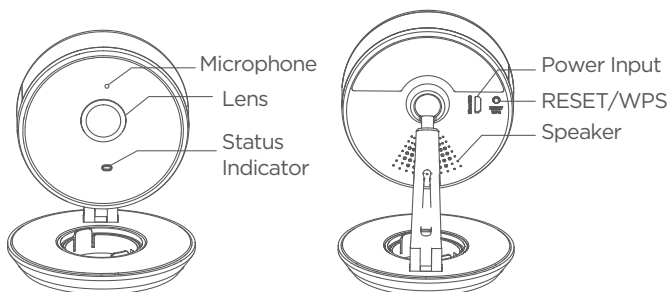

Status Indicator	<ul style="list-style-type: none">• Steady red: The camera is starting up.• Flashing blue: The camera is started, and is ready for Wi-Fi set-up.• Steady blue: Wi-Fi configuration is completed and the camera is running properly.• Flashing red: network communication is abnormal.
-------------------------	--

Memory Card Slot	For microSD card.
RESET/ WPS	RESET: Hold down the button for 10 seconds when the camera is starting up or rebooting.

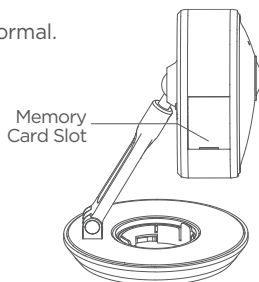

Installation

1. Install the camera.

The camera supports table mounting, wall mounting and ceiling mounting.

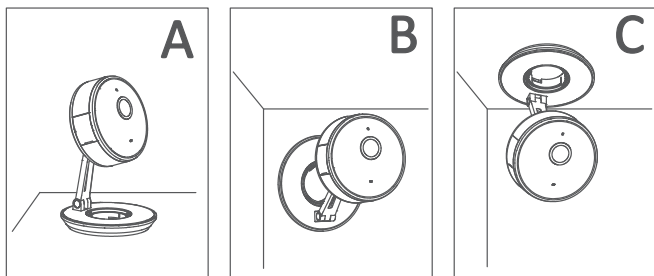

2. Power the camera

Plug the camera into the microUSB power cord.

- After approximately 20 seconds the camera will say “Hello”

- After approximately 45 seconds the camera will say “Your device is ready for network connection, please add your device to the mobile client to complete configuration.”

Uniden Security Cloud Installation

Download the Uniden Cloud App

- Plug the micro USB power cord into your AppCam 50HD and plug into wall socket.
- Download the Uniden Cloud app from with the Apple Store or Google Play. Open the app and “Sign In” to your Uniden Cloud account. If you don’t have a Uniden Cloud account, click “Sign Up”.

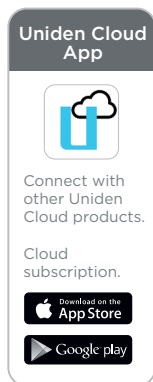

- 1. Click “Sign Up”
- 2. Fill in your information

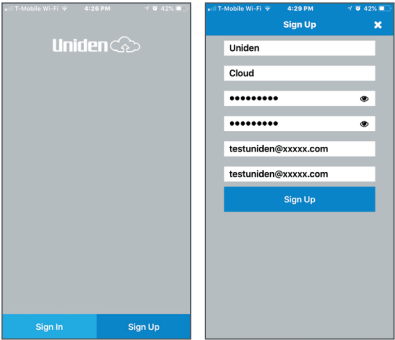

- 3. Click “Add Cameras” and give your camera a name

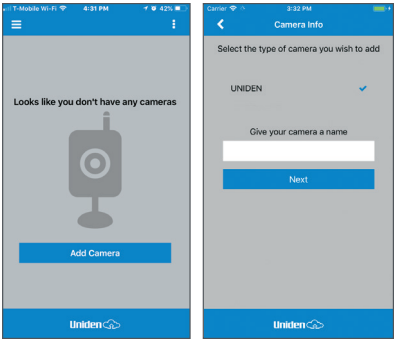

- 4. Scan Camera QR Code
Scan the camera’s QR code located either on the camera or on camera identifier leaflet.

Important! *Keep these QR codes in a safe place for future use.*

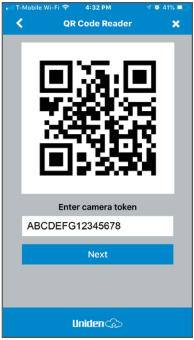

5. WiFi Setup

Enter your Wi-Fi name and password
Click “Next” to generate a Wi-Fi Connection Code

Band Steering Information

IMPORTANT: Ensure your phone is connected to the 2.4Ghz WiFi signal of your router. The AppCam 50HD will not connect to a 5Ghz signal.

If you have a single modem/router from your internet service provider and you only have 1 WiFi SSID (name of your WiFi you connect to) you might have a feature in your router turned on called “band steering”.

To connect the AppCam 50HD and other 2.4Ghz devices you will need to disable this feature and have separate 2.4Ghz and 5Ghz WiFi SSIDs.

Contact your ISP for assistance if the AppCam 50HD does not connect to your single WiFi SSID.



6. Next, hold your phone with the WiFi Connection Code about 3-8" from the camera. You will hear a “beep” if successfully scanned.

If no message is heard within 10 seconds, click back and ensure your WiFi settings are correct.

After the beep, wait about ~ 30 seconds until the status indicator is **SOLID BLUE** and you hear the message “Network connected successfully.”



7. Enter the camera user name and password

Username = admin
Password = admin
[Verification Code on back of camera]

Example: adminABCDEF



8. Next update any settings you want. Scroll down & click “Finish”.

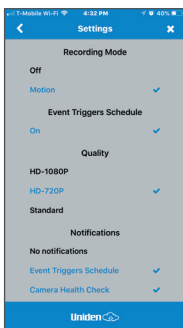

9. Access the live view by pressing the “Live” button.

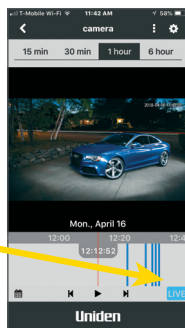

Live View Application

Congratulations! Your camera is now set up. Navigate the Live View to see all your camera features.

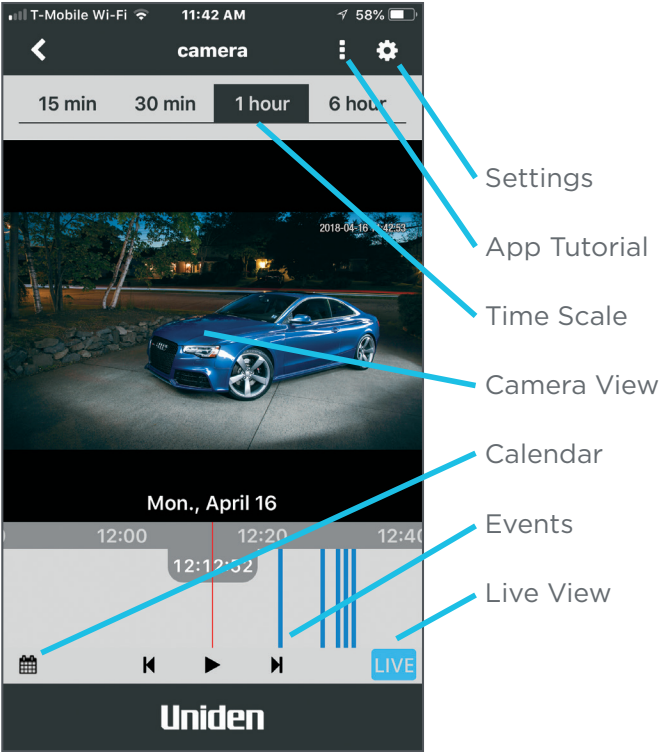

Login to the Uniden Cloud app

Pinch'n Zoom to change the orientation of the cameras connected to your cloud security.

Pinch

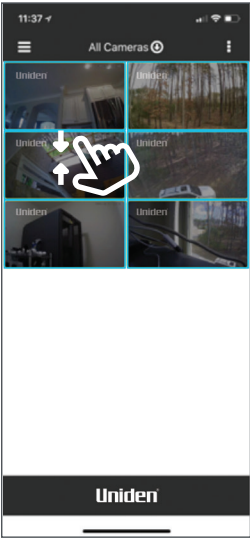

Zoom



Events

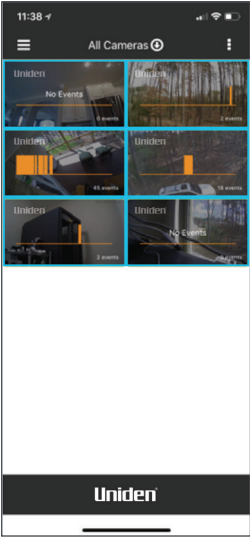

Ready for the Ultimate Security?

Uniden offers Cloud Lite and Cloud Premium plans to fit your need and your budget.

Log on to your Uniden Security Cloud Account at www.unidencloud.com with same username and password.

Each camera is given a **FREE 30-day Cloud Lite Storage Plan.** (7-day storage).*

In your Uniden Cloud account, click your username in the upper right corner and choose UPGRADE.

Choose your plan and continue to the payment processing.

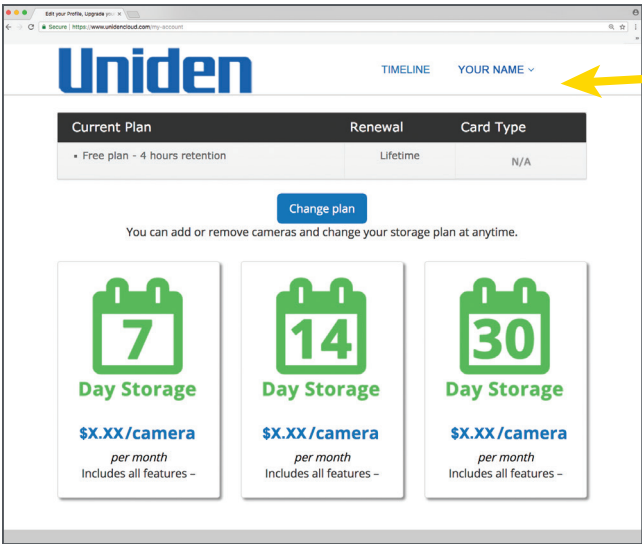

Go to the order form. Click **REVIEW ORDER** - Enter credit card information and place order.

30-Day Free Trial of Cloud Lite Storage Plan

SUBSCRIPTION REQUIRED

The Uniden surveillance camera you have purchased contains built-in software that detects and streams motion and/or sound. Use of your new Uniden camera requires a subscription to Uniden Cloud. Uniden will provide you with a Free 30-Day Trial Subscription to Uniden Cloud for each camera included within your account. To enroll in the Free 30-day Trial Subscription, you will need to set up an account here www.unidencloud.com and provide billing information for monthly renewals.

The Free 30-day Uniden Cloud subscription is based on a 7-day Lite Cloud (motion only) subscription plan per enrolled camera.

AUTOMATIC MONTHLY RENEWALS

Once your Free 30-day Trial Subscription ends, your subscription will automatically be renewed monthly until you cancel your subscription. You may cancel your subscription at any time by logging on to your Uniden Cloud account and cancelling your subscription. Your subscription will not terminate until the end of the current monthly billing cycle.

Pro-rated refunds will not be given.

For full Terms and Conditions details visit www.unidencloud.com/uniden-terms.

Regulatory Information

FCC Information

Please note that changes or modifications not expressly approved by the party responsible for compliance could void the user's authority to operate the equipment.

FCC Compliance

This equipment has been tested and found to comply with the limits for a Class B digital device, pursuant to part 15 of the FCC Rules. These limits are designed to provide reasonable protection against harmful interference in a residential installation. This equipment generates, uses and can radiate radio frequency energy and, if not installed and used in accordance with the instructions, may cause harmful interference to radio communications. However, there is no guarantee that interference will not occur in a particular installation.

FCC Statement

This equipment has been tested and found to comply with the limits for a Class B digital device, pursuant to part 15 of the FCC Rules. These limits are designed to provide reasonable protection against harmful interference in a residential installation. This equipment generates, uses and can radiate radio frequency energy and, if not installed and used in accordance with the instructions, may cause harmful interference to radio communications. However, there is no guarantee that interference will not occur in a particular installation. If this equipment does cause harmful interference to radio or television reception, which can be determined by turning the equipment off and on, the user is encouraged to try to correct the interference by one or more of the following measures:

- Reorient or relocate the receiving antenna.
- Increase the separation between the equipment and receiver.
- Connect the equipment into an outlet on a circuit different from that to which the receiver is connected.
- Consult the dealer or an experienced radio/TV technician for help.

FCC Radiation Exposure Statement

This device complies with FCC radiation exposure limits set forth for an uncontrolled environment and it also complies with Part 15 of the FCC RF Rules. This equipment must be installed and operated in accordance with provided instructions and the antenna(s) used for this transmitter must be installed to provide a separation distance of at least 20 cm from all persons and must not be co-located or operating in conjunction with

any other antenna or transmitter. End-users and installers must be provided with antenna installation instructions and consider removing the no-collocation statement.

This device complies with Part 15 of the FCC Rules. Operation is subject to the following two conditions:

1. This device may not cause harmful interference, and
2. This device must accept any interference received, including interference that may cause undesired operation

IC Regulations

This device complies with Industry Canada licence-exempt RSS standard(s). Operation is subject to the following two conditions: (1) this device may not cause interference, and (2) this device must accept any interference, including interference that may cause undesired operation of the device.

Under Industry Canada regulations, this radio transmitter may only operate using an antenna of a type and maximum (or lesser) gain approved for the transmitter by Industry Canada. To reduce potential radio interference to other users, the antenna type and its gain should be so chosen that the equivalent isotropically radiated power (e.i.r.p.) is not more than that necessary for successful communication.

Symbol Conventions



IMPORTANT Provides additional information to emphasize or supplement important points of the main text.



WARNING Indicates a potentially hazardous situation, which if not avoided, could result in equipment damage, data loss, performance degradation, or unexpected results. Safety Instructions

Safety Instructions

These instructions are intended to ensure that a user can use the product correctly to avoid danger or property loss.

Proper configuration of all passwords and other security settings is the responsibility of the installer and/or end-user.

- In the use of the product, you must be in strict compliance with the electrical safety regulations of your area.
- Do not connect several devices to one power adapter as adapter overload may cause over-heating or a fire hazard.
- Please make sure that the plug is firmly connected to the power socket. When the product is mounted on wall or ceiling, the device shall be firmly fixed.



WARNING

- Make sure the power supply voltage is correct before using the camera.
- Do not drop the camera or subject it to physical shock.
- Do not touch sensor modules with fingers. If cleaning is necessary, use a clean cloth with a bit of ethanol and wipe it gently. If the camera will not be used for an extended period, replace the lens cap to protect the sensor from dirt.
- Do not aim the camera at the sun or extra bright places. Blooming or smearing may occur, and affect the sensor's endurance at the same time.
- The sensor may be burned out by a laser beam, so when any laser equipment is in use, make sure that the surface of sensor will not be exposed to the laser beam.
- Do not place the camera in extremely hot, cold (the operating temperature shall be -10°C to +40°C), dusty, or damp locations, and do not expose it to high electromagnetic radiation.
- To avoid heat accumulation, ensure that there is good ventilation to the device.
- Keep the camera away from liquids.
- If the product does not work properly, please contact your retailer or Uniden customer service.
- Never attempt to disassemble the camera yourself. (We shall not assume any responsibility for problems caused by unauthorized repair or maintenance.)

Uniden Corporation Limited 1 Year Warranty

IMPORTANT: Keep your receipt. Proof of original purchase is required for warranty service.

WARRANTOR: Uniden America Corporation (“Uniden”) **ELEMENTS OF WARRANTY:** Uniden warrants, for one year, to the original retail owner, this Uniden Product to be free from defects in materials & craftsmanship with only the limitations or exclusions set out below. Uniden only warrants the Products contained in the original factory packaging.

WARRANTY DURATION: This warranty to the original user shall terminate & be of no further effect 12 months after the date of original retail sale. The warranty is invalid if the Product is (A) damaged or not maintained as reasonable or necessary, (B) modified, altered, or used as part of any conversion kits, subassemblies, or any configurations not sold by Uniden, (C) improperly installed, (D) serviced or repaired by someone other than an authorized Uniden service center for a defect or malfunction covered by this warranty, (E) used in any conjunction with equipment or parts or as part of any system not manufactured by Uniden, or (F) installed or programmed by anyone other than as detailed by the owner's manual for this product.

STATEMENT OF REMEDY: In the event that the product does not conform to this warranty at any time while this warranty is in effect, warrantor will either, at its option, repair or replace the defective unit & return it to you without charge for parts, service, or any other cost (except shipping & handling) incurred by warrantor or its representatives in connection with the performance of this warranty. Warrantor, at its option, may replace the unit with a new or refurbished unit. Warrantor is not responsible for any additional costs associated with reinstallation of product.

THE LIMITED WARRANTY SET FORTH ABOVE IS THE SOLE & ENTIRE WARRANTY PERTAINING TO THE PRODUCT AND THE CONTENTS CONTAINED IN THE ORIGINAL FACTORY PACKAGING & IS IN LIEU OF & EXCLUDES ALL OTHER WARRANTIES OF ANY NATURE WHATSOEVER, WHETHER EXPRESS, IMPLIED OR ARISING BY OPERATION OF LAW, INCLUDING, BUT NOT LIMITED TO ANY IMPLIED WARRANTIES OF MERCHANTABILITY OR FITNESS FOR A PARTICULAR PURPOSE. THIS WARRANTY DOES NOT COVER OR PROVIDE FOR THE REIMBURSEMENT OR PAYMENT OF INCIDENTAL OR CONSEQUENTIAL DAMAGES TO THE PRODUCT CAUSED BY IMPROPER INSTALLATION OF THE PRODUCT. THIS WARRANTY DOES NOT COVER ANY COSTS RELATING TO THE REMOVAL, REPLACEMENT, OR INSTALLATION OF ANY PRODUCT.

Some states do not allow this exclusion or limitation of incidental or consequential damages so the above limitation or exclusion may not apply to you.

LEGAL REMEDIES: This warranty gives you specific legal rights, & you may also have other rights which vary from state to state. This warranty is void outside the United States of America & Canada.

PROCEDURE FOR OBTAINING PERFORMANCE OF WARRANTY: If, after following the instructions in the owner's manual you are certain that the Product is defective, pack the Product carefully (preferably in its original packaging). The Product should include all parts & accessories originally packaged with the Product. Include evidence of original purchase & a note describing the defect that has caused you to return it. The Product should be shipped freight prepaid, by traceable means, to warrantor at:

Uniden America Service

c/o Saddle Creek
743 Henrietta Creek Rd., Suite 100
Roanoke, TX 76262

AppCam 50HD

3MP Wi-Fi Camera

User Manual - Uniden Security Cloud

This device complies with Industry Canada licence-exempt RSS standard(s). Operation is subject to the following two conditions:

- (1) this device may not cause interference, and
- (2) this device must accept any interference, including interference that may cause undesired operation of the device.

Le présent appareil est conforme aux CNR d'Industrie Canada applicables aux appareils radioexempts de licence. L'exploitation est autorisée aux deux conditions suivantes :

- (1) l'appareil ne doit pas produire de brouillage, et
- (2) l'utilisateur de l'appareil doit accepter tout brouillage radioélectrique subi, même si le brouillage est susceptible d'en compromettre le fonctionnement.

Under Industry Canada regulations, this radio transmitter may only operate using an antenna of a type and maximum (or lesser) gain approved for the transmitter by Industry Canada. To reduce potential radio interference to other users, the antenna type and its gain should be so chosen that the equivalent isotropically radiated power (e.i.r.p.) is not more than that necessary for successful communication.

Conformément à la réglementation d'Industrie Canada, le présent émetteur radio peut fonctionner avec une antenne d'un type et d'un gain maximal (ou inférieur) approuvé pour l'émetteur par Industrie Canada. Dans le but de réduire les risques de brouillage radioélectrique à l'intention des autres utilisateurs, il faut choisir le type d'antenne et son gain de sorte que la puissance isotrope rayonnée équivalente (p.i.r.e.) ne dépasse pas l'intensité nécessaire à l'établissement d'une communication satisfaisante.

This equipment complies with FCC/IC RSS-102 radiation exposure limits set forth for an uncontrolled environment. This equipment should be installed and operated with minimum distance 20cm between the radiator & your body.

Ce matériel est conforme aux limites de dose d'exposition aux rayonnements, FCC / CNR-102 énoncée dans un autre environnement. Cette équipement devrait être installé et exploité avec distance minimale de 20 cm entre le radiateur et votre corps.

This device complies with Industry Canada licence-exempt RSS standard(s). Operation is subject to the following two conditions:

- (1) this device may not cause interference, and
- (2) this device must accept any interference, including interference that may cause undesired operation of the device.

Le présent appareil est conforme aux CNR d'Industrie Canada applicables aux appareils radioexempts de licence. L'exploitation est autorisée aux deux conditions suivantes :

- (1) l'appareil ne doit pas produire de brouillage, et
- (2) l'utilisateur de l'appareil doit accepter tout brouillage radioélectrique subi, même si le brouillage est susceptible d'en compromettre le fonctionnement.