

Quick guide

Nokia xx

TA-1307
EN-LATAM



Tip: To find out if your phone can use 2 SIM cards, see the label on the sales box. If there are 2 IMEI codes on the label, you have a dual-SIM phone.
5. If you have a memory card, slide it in the memory card slot.

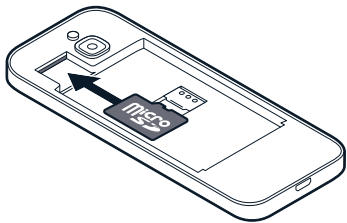

6. Put back the battery.
7. Put back the cover.

Note: On dual SIM capable devices, both SIM1 and SIM2 slots support 4G networks. However, if your SIM1 and SIM2 are both LTE SIM cards, the primary SIM supports 4G/3G/2G networks, while the secondary SIM can only support 2G/3G. For more information on your SIM cards, contact your service provider.
Important: Do not remove the memory card when an app is using it. Doing so may damage the memory card and the device and corrupt data stored on the card.

Switch your phone on or off

To switch on the phone, press and hold the power key. To switch off the phone, press and hold and select **Power Off**.

Charge the battery

1. Plug the charger into the wall outlet.

For your safety

Read these simple guidelines. Not following them may be dangerous or against local laws and regulations. For further information, read the complete user guide.

SWITCH OFF IN RESTRICTED AREAS
Switch the device off when mobile phone use is not allowed or when it may cause interference or danger, for example, in aircraft, in hospitals or near medical equipment, fuel, chemicals, or blasting areas. Obey all instructions in restricted areas.

ROAD SAFETY COMES FIRST
Obey all local laws. Always keep your hands free to operate the vehicle when driving. Your first consideration while driving should be road safety.

INTERFERENCE
All wireless devices may be susceptible to interference, which could affect performance.

AUTHORIZED SERVICE
Only authorized personnel may install or repair this product.

BATTERIES, CHARGERS AND OTHER ACCESSORIES
Use only batteries, chargers, and other accessories approved by HMD Global for use with this device. Do not connect incompatible products.

KEEP YOUR DEVICE DRY
Your device is not water-resistant. Keep it dry.

PROTECT YOUR HEARING
To prevent possible hearing damage, do not listen at high volume levels for long periods. Exercise caution when holding your device near your ear while the loudspeaker is in use.

SAR
This device meets RF exposure guidelines when used either in the normal use position against the ear or when positioned at least 10 mm (0,4 inches) away from the body. The specific maximum SAR values can be found in the Certification Information (SAR) section of this user guide. For more info, go to www.sar-tick.com.
When a carry case, belt clip or other form of device holder is used for body-worn operation, it should not contain metal and should provide at least the above-stated separation distance from the body. Note that mobile devices may be transmitting even if you are not making a voice call.

Keys and parts

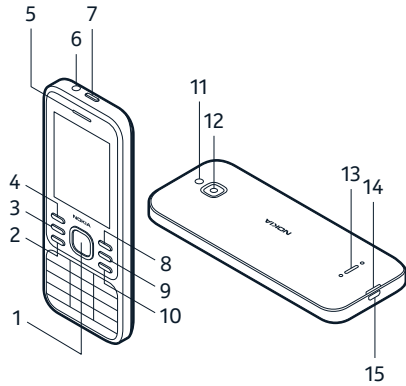

- 1 Scroll key
- 2 Call key
- 3 Multi-function key

marks, or some language options, take more space, and limit the number of characters that can be sent in a single message.

Camera

1. To switch the camera on, press the scroll key to open the apps list, and select **Camera**.

2. To take a photo, press the scroll key.
Keep a safe distance when using the flash. Do not use the flash on people or animals at close range. Do not cover the flash while taking a photo.

Listen to radio

To listen to the radio, you need to connect a compatible headset to the device. The headset acts as an antenna.

- To switch the radio on, press the scroll key to open the apps list, and select **FM Radio > TURN ON**.
- To search for available stations, select **Stations > Options > Scan Stations**.
- To save a station, select **Options > Add to favorites**.
- To switch to a saved station, select **Favorites** and the station from the list.
- To change the volume, select **Options > Volume**, and scroll up or down.
- To turn off the radio, select **TURN OFF**.
- To exit, press the end key.

Listen to music

You can listen to your MP3 music files with the music player. To play music, you need to store the music files on a memory card or the phone memory.

1. Press the scroll key to open the apps list, and select **Music**.
2. Scroll right to **Songs** to see all your saved music. To listen to a song, select it. You can also select music from **Albums** or **Artists**.

- 4 Left selection key
 - 5 Earpiece
 - 6 Headset connector
 - 7 Power key
 - 8 Right selection key
 - 9 Back key
 - 10 End key
 - 11 Flash
 - 12 Camera
 - 13 Loudspeaker
 - 14 Back cover opening slot
 - 15 USB connector
- To lock the keys, press and hold and select **Lock**. To unlock the keys, select **Unlock**.

Avoid touching the antenna area while the antenna is in use. Contact with antennas affects the communication quality and may reduce battery life due to higher power level during operation.

Do not connect to products that create an output signal, as this may damage the device. Do not connect any voltage source to the audio connector. If you connect an external device or headset, other than those approved for use with this device, to the audio connector, pay special attention to volume levels.

Parts of the device are magnetic. Metallic materials may be attracted to the device. Do not place credit cards or other magnetic stripe cards near the device for extended periods of time, since the cards may be damaged.

Some of the accessories mentioned in this user guide, such as charger, headset, or data cable, may be sold separately.

Note: You can set the phone to ask for a screen lock code. Press the scroll key and select **Settings**. Scroll right to **Privacy & Security**, and select **Screen Lock > Screen**

Switch on the flashlight

1. On the home screen, press the scroll key up.
2. Scroll to **Flashlight** and press the scroll key.
3. To switch the flashlight off, press the scroll key again.

Do not point the light directly to anyone's eyes.

Note: When using the flashlight, be careful when touching the LED as it may feel hot. Always switch off the flashlight before putting the phone in your pocket or handbag.

Find your model number and serial number (IMEI)

If you need to contact your care point or your service provider, you may need info such as the model number and the serial number (IMEI). To see the model number, dial *#0000#. To see the serial number, dial *#06#. If you have a dual SIM phone, only IMEI1 is needed. You can also find the info on your phone label, which is located under the battery.

Product and safety info

For info on HMD Global Privacy Policy, go to www.nokia.com/phones/privacy. For the online user guide, even more info, and troubleshooting help, go to www.nokia.com/mobile-support.

Note: Pre-installed system software and apps use a significant part of memory space.

Network services and costs

You can use your device on the GSM 850, 900, 1800, 1900; WCDMA 1, 2, 4, 5, 8; LTE 2, 3, 4, 5, 7, 28 networks. You need a subscription with a service provider.

Using some features and services, or downloading content, including free items, require a network connection. This may cause the transfer of large amounts of data, which may result in data costs. You may also need to subscribe to some features.

Lock > On, and create a four-digit code. Note, however, that you need to remember the code you created, as HMD Global is not able to open or bypass it.

This phone cannot be located or locked remotely if lost.

Insert the SIM and memory card

Use only original nano-SIM cards. Use of incompatible SIM cards may damage the card or the device, and may corrupt data stored on the card.



Use only compatible memory cards approved for use with this device. Incompatible cards may damage the card and the device and corrupt data stored on the card.



Note: Switch the device off and disconnect the charger and any other device before removing any covers. Avoid touching electronic components while changing any covers. Always store and use the device with any covers attached.

1. Put your fingernail in the small slot at the bottom of the phone, lift and remove the cover.

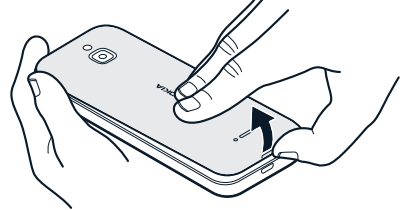

Emergency calls

Important: Connections in all conditions cannot be guaranteed. Never rely solely on any wireless phone for essential communications like medical emergencies.

Before making the call:

- Switch the phone on
- If the phone keys are locked, unlock them.
- Move to a place with adequate signal strength.

1. Press the end key repeatedly, until the home screen is shown.
 2. Type in the official emergency number for your present location. Emergency call numbers vary by location.
 3. Press the call key.
 4. Give the necessary info as accurately as possible. Do not end the call until given permission to do so.
- You may also need to do the following:
- Put a SIM card in the phone.
 - If your phone asks for a PIN code, type in the official emergency number for your present location, and press the call key.
 - Switch the call restrictions off in your phone, such as call barring, fixed dialling, or closed user group.

Take care of your device

Handle your device, battery, charger and accessories with care. The following suggestions help you keep your device operational.

- Keep the device dry. Precipitation, humidity, and all types of liquids or moisture can contain minerals that corrode electronic circuits. If your device gets wet, remove the battery, and let the device dry.

- Do not use or store the device in dusty or dirty areas.
- Do not store the device in high temperatures. High temperatures may damage the device or battery.
- Do not store the device in cold temperatures. When the device warms to its normal temperature, moisture can form inside the device and damage it.
- Do not open the device other than as instructed in the user guide.
- Unauthorized modifications may damage the device and violate regulations governing radio devices.
- Do not drop, knock, or shake the device or the battery. Rough handling can break it.
- Only use a soft, clean, dry cloth to clean the surface of the device.
- Do not paint the device. Paint can prevent proper operation.
- For optimal performance, switch the device off and remove the battery from time to time.
- Keep the device away from magnets or magnetic fields.

2. If the battery is in the phone, lift it out.
3. Slide the SIM card holder to the left and open it up. Place the nano-SIM in the slot face down, close down the holder and slide it to the right to lock it in place.

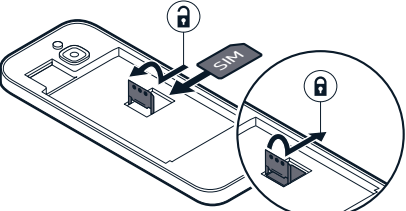

4. If you have a dual-SIM phone, slide the SIM2 holder to the right and open it up. Place the nano-SIM in the SIM2 slot face down, close down the holder and slide it to the left to lock it in place. Both SIM cards are available at the same time when the device is not being used, but while one SIM card is active, for example, making a call, the other may be unavailable.

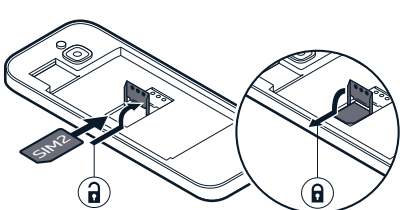

- To keep your important data safe, store it in at least two separate places, such as your device, memory card, or computer, or write down important info.

Restore original settings

To reset your phone to its original settings and to remove all your data, press the scroll key to open the apps list, and select **Settings > Device > Device information > Reset phone**.

Recycle



When this device has reached the end of its working life, all of its materials can be recovered as materials and energy. Recycle packaging and user guides at your local recycling scheme. When you cooperate and deliver all these materials to one of the available collection sites, you contribute in helping the environment and help to ensure the health of future generations.
All electrical and electronic products and batteries may contain recyclable metals and other potentially hazardous substances and must be taken to their respective collection sites at the end of their working life. Under no circumstances should you break open a battery or other related materials. Do not dispose of these products as unsorted municipal waste, as this may cause contamination of the environment or risks to human health. All HMD Global products are in compliance with the applicable industry international production standards and to all requirements defined by the competent government agencies.

Crossed-out wheelie-bin symbol



The crossed-out wheelie-bin symbol on your product, battery, literature, or packaging reminds you that all electrical and electronic products and batteries must be taken to separate collection at the end of their working life. Do not dispose of these products as unsorted municipal waste: take them for recycling. For info on your nearest recycling point, check with your local waste authority.

Battery and charger info

Use your device only with an original BL-4XL rechargeable battery. Charge your device with the AC-18U charger. Charger plug type may vary. HMD Global may make additional battery or charger models available for this device.

