



# Lenovo Smart Display 7

## Safety, Warranty & Quick Start Guide

Lenovo CD-17302F

 Read this guide carefully before using the device.

# Read before using the Lenovo Smart Display 7

## Read first - regulatory information

Device models equipped with wireless communications comply with the radio frequency and safety standards of any country or region in which it has been approved for wireless use. In addition, if your product contains a telecom modem, it complies with the requirements for connection to the telephone network in your country.

Be sure to read the *Regulatory Notice* for your country or region before using the wireless devices contained in your device. To obtain a PDF version of the *Regulatory Notice*, refer to the “Downloading publications” section below.

## Getting support

To get support on network services and billing, contact your wireless network operator. To learn more, go to <https://support.lenovo.com>.

## Legal notices

Lenovo and the Lenovo logo are trademarks of Lenovo in the United States, other countries, or both.

Other company, product, or service names may be trademarks or service marks of others.

LIMITED AND RESTRICTED RIGHTS NOTICE: If data or software is delivered pursuant a General Services Administration “GSA” contract, use, reproduction, or disclosure is subject to restrictions set forth in Contract No. GS-35F-05925.

Google and Google Home are trademarks of Google LLC.

# Overview

Name	Model
Lenovo Smart Display 7	Lenovo CD-17302F

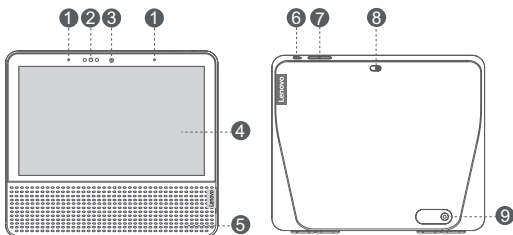

- 1 Microphone
- 2 Light/proximity sensor
- 3 Front camera
- 4 Touch screen
- 5 Speaker
- 6 Microphone mute switch
- 7 Volume buttons
- 8 Camera privacy shutter
- 9 Power adapter connector

 All pictures and illustrations in this document are for your reference only and may differ from the final product.

## Getting started

### Plug it in

Connect the power adapter to your device.

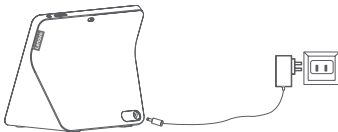

- ⚠ The power adapter is suitable for the Lenovo Smart Display 7, do not use it for other purposes

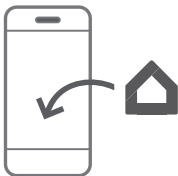

### Getting the app

Download and run the Google Home app on a phone/tablet. Set up the Lenovo Smart Display 7 in the Google Home app.

### Connecting to the Internet

You'll need to connect your device to the Internet before using it. Follow the on-screen instructions to set up your Lenovo Smart Display 7.

- ⚠ Use the same Wi-Fi network for your Lenovo Smart Display 7 and phone/tablet.

### Talking to your device

The Lenovo Smart Display 7 has the Google Assistant. Just say "Ok Google" to get started.

## Using the camera privacy shutter

Make sure the camera privacy shutter is switched completely to the left to cover the camera or to the right to uncover the camera.

## Factory reset

Press and hold the volume up button and the volume down button at the same time for a few seconds.

## Using the touch screen

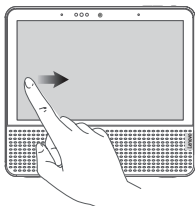

To exit swipe from the left edge

For quick settings swipe from the bottom

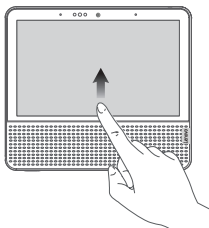

# Important safety and handling information

## Plastic bag notice

**Danger:** Plastic bags can be dangerous. Keep plastic bags away from babies and children to avoid danger of suffocation.

## Safety instructions for parents and adult supervisors

Your mobile device is not a toy. As with all electrical products, precautions should be observed during handling and using of electrical products to reduce the risk of electric shock. If parents choose to allow children to use the device, they should caution his or her child about the potential hazard while using and handling the mobile device.

Parents should inspect the mobile device (including the ac power adapter and the small part, as applicable) periodically for damage. Routinely check this mobile device to ensure that the device is working properly and is safe for children to use.

## Service and support information

The following information describes the technical support that is available for your product, during the warranty period or throughout the life of your product. Refer to the *Lenovo Limited Warranty* (LLW) for a full explanation of Lenovo warranty terms. See “*Lenovo Limited Warranty notice*” later in this document for details on accessing the full warranty.

### Online technical support

Online technical support is available during the lifetime of a product at:  
<https://support.lenovo.com>

### Telephone technical support

You can get help and information from the Customer Support Center by telephone. Before contacting a Lenovo technical support representative, please have the following information available: model and serial number, the exact wording of any error message, and a description of the problem.

Your technical support representative might want to walk you through the problem while you are at your device during the call.

### Worldwide Lenovo Support telephone list

**Important:** Telephone numbers are subject to change without notice. The most up-to-date telephone list for the Customer Support Center is always available at:  
<https://smartsupport.lenovo.com/supportphonelist>

If the telephone number for your country or region is not listed, contact your Lenovo reseller or Lenovo marketing representative.

# Warranty information

## **Lenovo Limited Warranty notice**

This product is covered by the terms of the LLW, version L505-0010-02 08/2011. Read the LLW at [http://www.lenovo.com/warranty/llw\\_02](http://www.lenovo.com/warranty/llw_02). You can read the LLW in a number of languages from this Web site. If you cannot view the LLW from the Web site, contact your local Lenovo office or reseller to obtain a printed version of the LLW.

## **Warranty period and type of warranty service**

Country or region	Warranty period	Type of warranty service
United Kingdom, Australia, New Zealand	Parts and Labor - 1 year	3
India, Singapore, South Korea, Mexico	Parts and Labor - 1 year	4
United States of America, Canada	Parts and Labor - 1 year	1,5
Japan	Parts and Labor - 1 year	5
Spain, Netherlands, Sweden, Denmark, Norway, France, Germany, Italy	Parts and Labor - 2 years	3

\* Excludes some components. 90-day limited warranty for power adapters, keyboards, plastics, and hinges.

### **Type of warranty service**

1. Customer Replaceable Unit ("CRU") Service
2. On-site Service
3. Courier or Depot Service
4. Customer Carry-In Service
5. Mail-in Service
6. Customer Two-Way Mail-in Service
7. Product Exchange Service

For a full explanation of the types of warranty service, refer to the full warranty. See "*Lenovo Limited Warranty notice*" for details on accessing the full warranty. If you need support for this device, do not go back to your point of purchase. Please visit <https://support.lenovo.com>, where you will find answers to frequently asked questions, software updates and details on how to get in touch with us.

# Environmental, recycling, and disposal information

## General recycling statement

Lenovo encourages owners of information technology (IT) equipment to responsibly recycle their equipment when it is no longer needed. Lenovo offers a variety of programs and services to assist equipment owners in recycling their IT products. For information on recycling Lenovo products, go to <http://www.lenovo.com/recycling>.

## Recycling information for Japan

Recycling and disposal information for Japan is available at:  
<http://www.lenovo.com/recycling/japan>

## WEEE information



Electrical and electronic equipment marked with the symbol of a crossed-out wheeled bin may not be disposed as unsorted municipal waste. Waste of electrical and electronic equipment (WEEE) shall be treated separately using the collection framework available to customers for the return, recycling, and treatment of WEEE. Country-specific information is available at: <http://www.lenovo.com/recycling>

## Restriction of Hazardous Substances Directive (RoHS)

### India

Lenovo products sold in India, on or after May 1, 2012, meet the requirements of the India E-waste (Management) Rules ("India RoHS").

### European Union

Lenovo Products meet the requirement of Directive 2011/65/EC on the restriction of the use of the certain hazardous substances in electrical and electronic equipment ("RoHS 2"). Lenovo products sold in the European Union, from the 21st July 2019, meet the requirement of Commission Delegated Directive (EU 2015/863) amending Directive 2011/65/EU. For more information about Lenovo progress on RoHS, go to: [https://www.lenovo.com/us/en/social\\_responsibility/RoHS-Communication.pdf](https://www.lenovo.com/us/en/social_responsibility/RoHS-Communication.pdf)

### Singapore

Lenovo products sold in Singapore, on or after June 1, 2017, meet the requirements of Government Gazette order No. S 263/2016 Restriction of Hazardous Substances in Electrical and Electronic Equipment in Singapore ("SG-RoHS").



# European Union compliance statement

## European Union conformity



### Compliance with the RE Directive

Lenovo PC HK Limited declares that the radio equipment type Lenovo CD-17302F is in compliance with Directive 2014/53/EU.

The full text of the EU declaration of conformity is available at the following internet address:

<https://www.lenovo.com/us/en/compliance/eu-doc>

This radio equipment operates with the following frequency bands and maximum radio-frequency power:

Model Name	Frequency Bands	Maximum Power (dBm)
Lenovo CD-17302F	WLAN 2400-2483.5	<20
	WLAN 5150-5250	<20
	WLAN 5250-5350	<20
	WLAN 5470-5725	<20
	WLAN 5725-5850	<14
	Bluetooth 2400-2483.5	<10

The device could be used with a separation distance of 20cm to the human body.

Adapter shall be installed near the equipment and shall be easily accessible  
Please make sure the temperature for device will be 0-40 °C

 The above information is for EU countries only. Please refer to the actual product for supported frequency bands in other countries.

© Copyright Lenovo 2019.

**Reduce | Reuse | Recycle**



V1.0\_20190823



xxxxxxxx

MC

Printed in China