

## User's Guide for the Wireless Car Kit (CARK112)

---

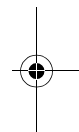

9353697  
Issue 1

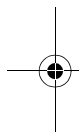
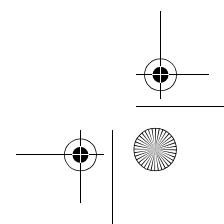
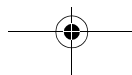
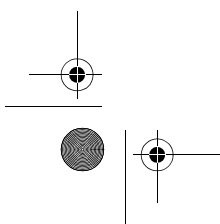

#### DECLARATION OF CONFORMITY

We, NOKIA CORPORATION declare under our sole responsibility that the product CARK112 is in conformity with the provisions of the following Council Directive: 1999/5/EC.

A copy of the Declaration of Conformity can be found from  
[http://www.nokia.com/phones/declaration\\_of\\_conformity/](http://www.nokia.com/phones/declaration_of_conformity/).

Copyright © Nokia Corporation 2002. All rights reserved.

Reproduction, transfer, distribution or storage of part or all of the contents in this document in any form without the prior written permission of Nokia is prohibited.

Nokia is a registered trademark of Nokia Corporation. Other product and company names mentioned herein may be trademarks or tradenames of their respective owners.

Nokia operates a policy of continuous development. Nokia reserves the right to make changes and improvements to any of the products described in this document without prior notice.

Under no circumstances shall Nokia be responsible for any loss of data or income or any special, incidental, consequential or indirect damages howsoever caused.

The contents of this document are provided "as is". Except as required by applicable law, no warranties of any kind, either express or implied, including, but not limited to, the implied warranties of merchantability and fitness for a particular purpose, are made in relation to the accuracy, reliability or contents of this document. Nokia reserves the right to revise this document or withdraw it at any time without prior notice.

The availability of particular products may vary by region. Please check with the Nokia dealer nearest to you.

9353697 / Issue 1

## Contents

<b>Contents .....</b>	<b>3</b>	Ending a call .....	11
<b>Introduction .....</b>	<b>4</b>	Answering a call .....	11
Bluetooth wireless technology .....	4	Rejecting a call .....	11
The sticker in the sales package .....	5	Automatic answer .....	11
A few practical rules for		Redialling the last number dialled ..	11
accessory operation .....	5	Adjusting the volume of	
		the car kit speaker .....	11
<b>1. Getting started .....</b>	<b>6</b>	Switching the call between	
Overview .....	6	car kit and phone .....	11
Connecting the remote control		Car radio mute .....	12
button to the handsfree unit .....	6	Ignition sense .....	12
Attaching the remote control		Disconnecting the car kit	
button to your car .....	7	from the phone .....	12
Taking the car kit into use		Reconnecting the paired	
for the first time .....	8	car kit to your phone .....	13
Troubleshooting .....	9	Using the car kit	
		with several phones .....	13
		Using the car kit with	
		several paired phones .....	13
<b>2. Using the remote</b>		Resetting the car kit .....	13
<b>control button .....</b>	<b>10</b>		
Connecting the paired car kit		<b>Care and maintenance .....</b>	<b>14</b>
to your phone .....	10		
Making a call .....	10		
Voice dialling .....	10		

## Introduction

## Introduction

The Wireless Car Kit CARK112 can be connected without cables to a compatible phone that supports Bluetooth wireless technology. The main parts of the Wireless Car Kit are the handsfree unit (HFW-1) and the remote control button (CUW-2).

Read this user's guide carefully before using the Wireless Car Kit. More detailed information is given in the user's guide of your phone. Do not use this Wireless Car Kit (CARK112) user's guide in place of the user's guide of your phone, which provides important safety and maintenance information.

This user's guide mainly describes the installation and use of the CUW-2 remote control button. For information about other parts of the Wireless Car Kit, refer to the installation guide that comes with it.

### ■ Bluetooth wireless technology

Since Bluetooth devices communicate using radio waves, your Bluetooth phone and Wireless Car Kit do not need to be in a line of sight. For example, your phone may be in your bag while it is connected to the Wireless Car Kit. The two devices only need to be within a maximum of 10 meters of each other, although the connection can be subject to interference from obstructions, such as walls, or from other electronic devices.

The Wireless Car Kit is specially designed for Nokia phones that support Bluetooth wireless technology. The car kit can, however, be used with any compatible Bluetooth devices that support the Handsfree profile. ("Profile" in this case means a set of Bluetooth commands that your phone uses for controlling the Wireless Car Kit.)

The Wireless Car Kit provides the best performance when it is used with a compatible Nokia phone. If you use the Wireless Car Kit with a phone produced by another manufacturer, all the functions described in this user's guide may not be available.

In some countries, there may be restrictions on using Bluetooth devices. Check with your local authorities.

## Introduction

### ■ The sticker in the sales package

The sticker contains the Bluetooth passkey you need for pairing your phone with the Wireless Car Kit. Keep this sticker in a safe and secure place.

For details on using the passkey, see Taking the car kit into use for the first time on page 8.

### ■ A few practical rules for accessory operation

- Check regularly that any vehicle-installed accessories are mounted and are operating properly.
- Installation of any complex car accessories must be made by qualified personnel only.
- Use only accessories that have been approved by the phone manufacturer. The use of any other types could invalidate any approval or warranty applying to the phone, and could be dangerous.

## Getting started

## 1. Getting started

### ■ Overview

The Wireless Car Kit is controlled with the remote control button CUW-2.

The parts of the remote control button are described below. For information about other parts of the car kit, refer to the installation guide that comes with it.

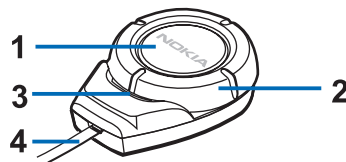

**1 – Button:** Answers or ends a call. This button can also be used for voice dialling and switching an active call between the car kit and the phone.

**2 – Ring:** Adjusts the volume of the car kit speaker. When you turn the ring clockwise, the volume is increased. When you turn the ring counterclockwise, the volume is decreased.

**3 – Indicator light:** Indicates the current status of the Bluetooth connection between your phone and the car kit. When the light is shown, your phone is connected to the car kit.

**4 – Connection cable:** Links the remote control button to the HFW-1 handsfree unit.

### ■ Connecting the remote control button to the handsfree unit

When the Wireless Car Kit is installed in your car, connect the remote control button to the HFW-1 handsfree unit.

## Getting started

For details on installing the car kit, refer to the installation guide that comes with it.

To connect the remote control button to the handsfree unit: Carefully insert the connection cable into the appropriate socket in the handsfree unit as shown below.

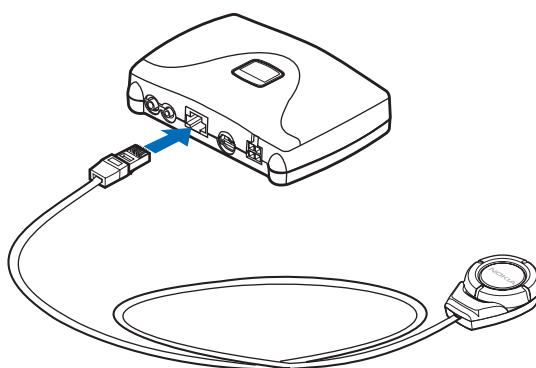

### ■ Attaching the remote control button to your car

You can attach the remote control button for example to the dashboard in your car.

To attach the remote control button:

1. Detach the two grip pads from each other (1).



### Getting started

2. Attach the pad with soft fabric: peel off the protective sheet from the adhesive side (2) and attach the pad to the desired location in your car.

Make sure that the surface where you attach this pad is dry and free from dirt (such as grease) and dust.



3. Attach the pad with rugged fabric: peel off the protective sheet from the adhesive side and attach the pad to the bottom of the remote control button (3).

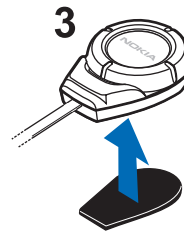

4. Press the remote control button against the pad in your car until the button is firmly in place (4).

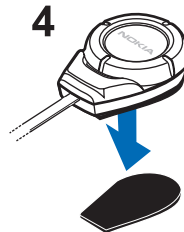

### ■ Taking the car kit into use for the first time

1. Make sure that your phone is switched on.
2. Switch on the car kit: Turn on the ignition in your car.
3. Enter your phone's Bluetooth menu and make sure that the Bluetooth feature is activated.
4. Enter the submenu where you can set the phone to search for Bluetooth devices, and start the search.



## Getting started

The phone searches for all Bluetooth devices within about 10 meters and shows them as a list.

5. Select the car kit from the list.
6. Enter the passkey to associate ("pair") and connect the car kit to your phone. **The passkey is marked on the sticker that is provided in the sales package of the Wireless Car Kit.**

Once you have entered the passkey, your phone becomes the default phone that uses the car kit, if the car kit has not been previously paired with another phone. See also Using the car kit with several phones on page 13.

The indicator light of the remote control button is shown, and the car kit appears in the phone menu where you can view the Bluetooth devices that are currently paired with your phone.

7. Start using the car kit and the remote control button (see page 10).

## Troubleshooting

If you cannot connect the car kit to your phone, do as follows:

- Make sure that the car ignition is turned on.
- Make sure the Bluetooth feature is activated on your phone.
- Make sure that the car kit is paired with your phone.
- Check that your phone is within a maximum of 10 meters of the handsfree unit and that there are no obstructions, such as walls, or other electronic devices between the handsfree unit and the phone.
- The pairing information list of the handsfree unit may be full. The handsfree unit can hold pairing information of up to 8 phones at a time. If the list becomes full, reset the handsfree unit to the original settings, see page 13.

Using the remote control button

## 2. Using the remote control button

Before using the car kit, make sure that

- the car kit is paired and connected to your phone. For pairing the car kit, see Taking the car kit into use for the first time on page 8. For connecting the car kit, see Connecting the paired car kit to your phone below.
- the phone's Bluetooth function is on; see the user's guide of your phone
- the car ignition is turned on
- your phone is within a maximum of 10 meters of the handsfree unit
- there are no obstructions, such as walls, or other electronic devices between the handsfree unit and the phone.

For using the car kit with several phones, see page 13.

### ■ Connecting the paired car kit to your phone

To connect the car kit to your phone, turn on the car ignition or make the connection in the phone's Bluetooth menu.

Note that turning on the car ignition creates the connection automatically only if you have set the phone to accept Bluetooth connection requests without your permission.

For disconnecting the car kit from your phone, see page 12.

### ■ Making a call

When the car kit is connected to your phone, make the call by using your phone in the normal way.

### ■ Voice dialling

When no call is in progress, press and hold the **button** until you hear a tone that indicates that you can say the desired name ("voice tag"). Say the voice tag. The phone plays the voice tag and dials the related phone number.

## Using the remote control button

You can also activate voice dialling with your phone. For details on using voice dialling, see the user's guide of your phone.

### ■ Ending a call

Press the **button** to end the currently active call. Or: End the call by using your phone.

### ■ Answering a call

Press the **button** to answer the call. Or: Answer the call by using your phone.

When you receive a call, you hear a ringing tone selected on your phone.

### ■ Rejecting a call

If you do not want to answer a call, press the **button** twice briefly.

### ■ Automatic answer

If the Automatic answer function is set on in your phone, the phone automatically answers the incoming call after one ring.

### ■ Redialling the last number dialled

Press the **button** twice briefly while no call is in progress.

### ■ Adjusting the volume of the car kit speaker

Turn the ring around the button clockwise to increase or counterclockwise to decrease the volume.

### ■ Switching the call between car kit and phone

You can switch the active call between the car kit and the phone.

**Switching the call from car kit to phone**

- Press and hold the **button**. OR:
- Use the respective function in your phone.

#### Using the remote control button

##### Switching the call from phone to car kit

- Press and hold the **button**. **OR:**
- Use the respective function in your phone.

#### ■ Car radio mute

When the car radio mute function is activated, the radio volume is automatically set to silent when you make or receive a call.

For activation of this function, see the installation guide that comes with the car kit.

#### ■ Ignition sense

When the ignition sense function is activated, the car kit is automatically switched off a few seconds after you turn off the ignition.

Use of this function can help prevent accidental draining of the car battery.

For activation of this function, refer to the installation guide that comes with the car kit.

#### ■ Disconnecting the car kit from the phone

You can disconnect the car kit from your phone, for example, when you want to use another Bluetooth device with your phone.

The car kit can be disconnected in the following ways:

- Turn off the car ignition. If you have a call in progress, the car kit will be disconnected after the call.
- OR:**
- Disconnect the car kit in the phone's Bluetooth menu.

The car kit will also be disconnected if you move your phone more than 10 meters away from the handsfree unit.

Note that you do not need to delete the pairing with the car kit to disconnect it. When you reconnect a paired car kit, you will not be asked for its passkey.

## Using the remote control button

**Reconnecting the paired car kit to your phone**

See Connecting the paired car kit to your phone on page 10.

**■ Using the car kit with several phones**

Before the car kit can be used with your phone, the phone has to be paired with the car kit. The car kit can be paired with up to 8 phones but connected to only one phone at a time.

**Using the car kit with several paired phones**

The phone that was first paired with the car kit is called the "default phone". The phone that was last used with the car kit is called the "last used phone".

If the car ignition is turned on and there are several paired phones in the vicinity, the car kit tries to find the "default phone" within a few seconds.

If the car kit cannot connect to the "default phone" (e.g. because it is switched off or its user rejects the connection), the car kit tries to connect to the "last used phone" within a few seconds.

Thereafter, you can connect to the car kit in the phone's Bluetooth menu.

To use the car kit with a paired phone that is not a "default phone" or "last used phone", make the connection in the phone's Bluetooth menu.

**■ Resetting the car kit**

You can reset the car kit to the original settings, for example, to change the default user of the car kit.

When you reset the car kit, all of its settings, including pairing information, are cleared.

**To reset the car kit:** Detach the microphone cable from the handsfree unit for less than 5 seconds. During resetting, the indicator light of the remote control button flashes. Once the car kit has been reset, the car kit beeps twice.

## Care and maintenance

## Care and maintenance

Your wireless car kit and remote control button are products of superior design and craftsmanship and should be treated with care. The suggestions below will help you to fulfil any warranty obligations and to enjoy these products for many years.

- Keep all accessories out of the reach of small children.
- Keep the wireless car kit and the remote control button dry. Precipitation, humidity and all types of liquids or moisture can contain minerals that will corrode electronic circuits.
- Do not use or store the wireless car kit or the remote control button in dusty, dirty areas. Their moving parts can be damaged.
- Do not store the wireless car kit or the remote control button in hot areas. High temperatures can shorten the life of electronic devices, damage batteries, and warp or melt certain plastics.
- Do not store the wireless car kit or the remote control button in cold areas. When it warms up (to its normal temperature), moisture can form inside, which may damage electronic circuit boards.
- Do not attempt to open the wireless car kit or the remote control button. Non-expert handling may damage it.
- Do not drop, knock or shake the wireless car kit or the remote control button. Rough handling can break internal circuit boards.
- Do not use harsh chemicals, cleaning solvents, or strong detergents to clean the wireless car kit or the remote control button.
- Do not paint the wireless car kit or the remote control button. Paint can clog the moving parts and prevent proper operation.

If the wireless car kit or the remote control button is not working properly, take it to your nearest qualified service facility. The personnel there will assist you and, if necessary, arrange for service.