

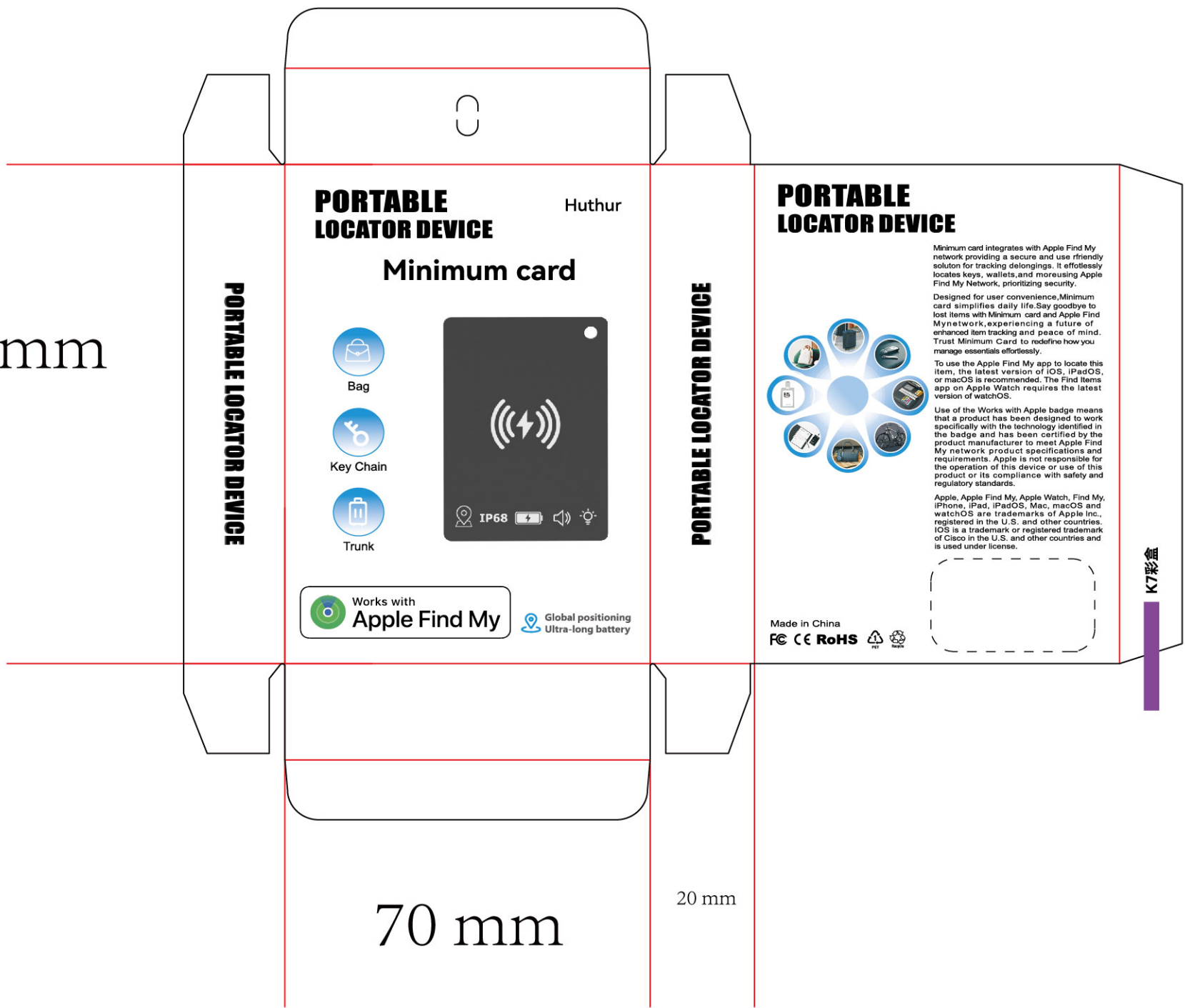

K7

YJ 做货



封面

<p><b>PORTABLE LOCATOR DEVICE</b></p> <p><b>Minimum card</b></p> 	<p><b>Overview introduction</b></p> <p>Minimum card integrates with Apple Find My Network providing a secure and user-friendly solution for finding belongings. With the Find My network, it's easy to locate keys, wallets and so on, with security being given top priority. Designed for user convenience, Minimum card simplifies daily life. Say goodbye to lost items with Minimum card and Apple Find My Network, experiencing a future of enhanced item finding and peace of mind. Trust Minimum card to redefine how you manage essentials effortlessly.</p> <p><b>How To Pair</b></p> <p>Note: iOS or macOS with the latest version.</p> 	<p>1.4 Open the "Find My" app.</p> <p>1.5 In "Find My" app, Tap "+", then "Add Other Item". As shown in Figure 1.</p> <p>1.6 Once your Minimum card is located, tap "Connect". As shown in Figure 2 and tap "Continue". As shown in Figure 3.</p> <p>1.7 Enter a name and choose an emoji for your Minimum card.</p> <p>1.8 Find My will ask for confirmation to add your Minimum card to your Apple ID. Tap "Agree".</p> <p>1.9 Tap "Finish" and your Minimum card will be set up and ready to be used.</p> <p><b>Battery</b></p> <p>Minimum card contains a rechargeable lithium battery.</p> <p><b>Charging Operation:</b></p> <p>2.1 Locate the wireless charging logo on the back of the card.</p> <p>2.2 Align it and place it on a wireless charger. There will be a beep and the red light will turn on when charging starts.</p> <p>2.3 When the battery is fully charged, the FINDER indicator will turn green and there will be three consecutive beeps.</p>	<p><b>Additional Tips</b></p> <p>3.1 Press and hold the button until you hear one beep, followed by two consecutive beeps, and then three consecutive beeps. Keep pressing for 5 seconds. When you hear a long beep, release the button and the device will be restored to factory settings.</p> <p>3.2 To delete FINDER from your Apple device, open the "Find" application, select "Items", click on the device to be removed, and then scroll down and click "Remove This Device".</p> <p>3.3 If FINDER fails to connect to the Find My application, perform a factory reset as described in 3.3 and then restart the pairing process.</p> <p><b>Important matters</b></p> <p>The Minimum card contains delicate electronic parts, including a battery to avoid damage, loss of function, or potential harm, please refrain from dropping, hitting, puncturing, crushing, disassembling, exposing it to extreme heat or liquids, or placing it in areas with a high concentration of industrial chemicals.</p> <p><b>WARNING:</b> Do not swallow the battery. There is a chemical burn hazard.</p>	<p><b>Choking Hazard Warning</b></p> <p>The Minimum card, its battery compartment door, the battery itself, and the case may pose a choking hazard or cause injury to small children. Please keep these items out of reach of young children.</p> <p>The Minimum card, the battery hatch, the battery itself, and the enclosure may pose a choking hazard or cause injury to young children. Keep these out of the reach of small children.</p> <p><b>Medical Device Interference</b></p> <p>The Minimum card contains components and radios that emit electromagnetic fields, as well as magnets. These elements may potentially interfere with pacemakers, defibrillators, or other medical devices. To ensure safety, maintain a safe distance between your medical device and the Minimum card. We strongly advise consulting your physician and the manufacturer of your medical device for information that is specific to your situation. If you suspect that the Minimum card is interfering with your pacemaker defibrillator or any other medical device, discontinue its use immediately.</p>	<p><b>Important Handling Guidelines</b></p> <p>It's normal for the Minimum card to show discoloration with regular use. To clean it, use a soft, dry, lint-free cloth.</p> <p>Avoid applying pressure with sharp objects on the rubber seal or the battery terminal contacts inside the device.</p> <p>Do not allow moisture to enter any openings or use aerosol sprays, solvents or abrasive materials to clean the device.</p> <p><b>Legal notice</b></p> <p>Use of the Works with Apple badge means that a product has been designed to work specifically with the technology identified in the badge and has been certified by the product manufacturer to meet Apple Find My Network product Specifications and requirements. Apple is not responsible for the operation of this device or use of this product or its compliance with safety and regulatory standards.</p> <p>Apple, Apple Find My, Apple Watch, Find My, iPhone, iPad, iPadOS, Mac, macOS and watchOS are trademarks of Apple Inc., registered in the U.S. and other countries. iOS is a trademark or registered trademark of Cisco in the U.S. and other countries and is used under license.</p>
--	---	---	---	--	---

封底

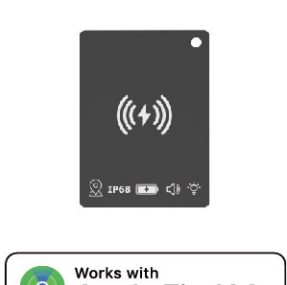
<p><b>便携式防丢器</b></p> 	<p><b>概述介绍</b></p> <p>FINDER 与苹果的 Find My 网络集成，为追踪物品提供了一个安全且对用户友好的解决方案。使用 Find My 网络轻松定位钥匙、钱包等，并优先考虑安全性。FINDER 专为方便用户而设计，简化了日常生成。使用 FINDER 和苹果的 Find My 网络告别丢失物品，体验增强物品防丢和安心的生活方式。相信 FINDER 可以重新定义您轻松管理物品。</p> <p><b>开机</b></p> <p>短按功能键（约 2 秒），听见 1 声提示音，表示设备开机。</p> <p><b>关机</b></p> <p>长按住功能按键，将依次听见 1 声提示音、连续的 2 声提示音、连续的 3 声提示音，此时松开按键（约 6 秒）。</p> <p><b>如何配对</b></p> <p>注：请 iOS 或 macOS 更新为最新版本。</p>	<p>1.1 将 FINDER 放在您的苹果设备（如 iPhone）旁边；</p> <p>1.2 在您的苹果设备（如 iPhone）上打开蓝牙并连接到互联网；</p> <p>1.3 轻按一下 FINDER 按钮，听到一声蜂鸣声即可接通电源；</p> <p>1.4 打开“查找”应用程序；</p> <p>1.5 在“查找”应用程序中，点击添加物品-其他支持物品，如图 2 所示；</p> <p>1.6 点击“继续”，如图 2 所示；</p> <p>1.7 命名您的 FINDER，然后点击“继续”，如图 3 所示；</p> <p>1.8 选择一个表情符号；</p> <p>1.9 点击“继续”，然后点击“完成”，即可完成配对。</p>	<p><b>电池</b></p> <p>包含一块可充电的锂电池。</p> <p><b>充电操作</b></p> <p>2.1 找到卡片背面的无线充电标识；</p> <p>2.2 将其对准位置在支持无线充电的充电器上，充上电响一声，亮红灯；</p> <p>2.3 电量充满后，FINDER 指示灯会亮绿灯，并伴随震动、滴、滴 3 声提示音。</p> <p><b>其他提示</b></p> <p>3.1 按住按钮，直到听到 1 个提示音，然后是 2 个连续提示音，再是 3 个连续提示音。继续按 5 秒钟。当您听到长提示音时，松开按钮设备将恢复出厂设置。</p> <p>3.2 要从您的苹果设备中删除 FINDER，请打开“查找”应用程序，选择“物品”，点击需要移除的设备，然后向下滚动点击“移除此设备”。</p> <p>3.3 如果 FINDER 无法连接到 Find My 应用程序，请按照第 3.1 中的说明，执行恢复出厂重置，然后重新启动配对过程。</p>	<p><b>重要事项</b></p> <p>FINDER 包含精密的电子部件，包括电池。为避免损坏、功能丧失或潜在伤害，请避免跌落、撞击、刺穿、压碎、拆卸、暴露在高温或液体中，或将其放置在工业化学品浓度高的区域。</p> <p><b>警告：</b>请勿吞下电池；存在化学灼伤危险</p> <p><b>窒息危险警告</b></p> <p>FINDER、电池舱门、电池本身和外壳可能会造成窒息危险或对幼儿造成伤害。请把这些东西放在小孩子够不着的地方。</p> <p><b>医疗器械干扰</b></p> <p>FINDER 包含发射电磁场的组件和无线电。这些元件可能潜在干扰起搏器或其他医疗设备。为确保安全，请在您的医疗设备和 FINDER 之间保持安全距离。我们强烈建议咨询您的医生和医疗设备制造商，以获取针对您具体情况的信息。如果您</p>	<p>怀疑 FINDER 干扰了您的起搏器或任何其他医疗设备，请立即停止使用。</p> <p><b>重要处理指南</b></p> <p>FINDER 在经常使用时出现变色是正常的。要清洁它，请使用柔软、干燥、无绒布。避免用尖锐物体对设备内部的橡胶密封件或蓄电池端子触点施加压力。</p> <p>不要让湿气进入任何开口，也不要使用气雾剂、溶剂或研磨材料清洁设备。</p> <p><b>法律声明</b></p> <p>使用 Works with Apple Find My 徽标意味着产品是专门为与徽标中指定的技术配合使用，并已通过产品制造商的认证，以满足 Apple Find My 网络产品的规范和要求。苹果不对本产品的操作、本产品的使用或是否符合安全标准和监管标准负责。</p> <p>Apple, Apple Find My, Apple Watch, iPhone, iPad, iPadOS, Mac, macOS 和 watchOS 是苹果股份有限公司在美国和其他国家注册的商标。iOS 是思在在美国和其他国家/地区的商标或注册商标，经许可使用。</p> <p>最新版本。</p>
--	--	--	--	---	---

折成品：50\*65mm

K5说明书，正反面折页5折6页

## FCC Statement

This device complies with part 15 of the FCC Rules. Operation is subject to the following two conditions: (1) This device may not cause harmful interference, and (2) this device must accept any interference received, including interference that may cause undesired operation.

This equipment has been tested and found to comply with the limits for a Class B digital device, pursuant to part 15 of the FCC Rules. These limits are designed to provide reasonable protection against harmful interference in a residential installation. This equipment generates, uses and can radiate radio frequency energy and, if not installed and used in accordance with the instructions, may cause harmful interference to radio communications. However, there is no guarantee that interference will not occur in a particular installation. If this equipment does cause harmful interference to radio or television reception, which can be determined by turning the equipment off and on, the user is encouraged to try to correct the interference by one or more of the following measures:

- Reorient or relocate the receiving antenna.
- Increase the separation between the equipment and receiver.
- Connect the equipment into an outlet on a circuit different from that to which the receiver is connected.
- Consult the dealer or an experienced radio/TV technician for help.

Caution: Any changes or modifications to this device not explicitly approved by manufacturer could void your authority to operate this equipment.

### RF Exposure Information

The device has been evaluated to meet general RF exposure requirement. The device can be used in portable exposure condition without restriction.