



FCC Compliance Statement:

This device complies with Part 15 of the FCC Rules. Operation is subject to the following two conditions:  
(1) this device may not cause harmful interference, and  
(2) this device must accept any interference received, including interference that may cause undesired operation.

Changes or modifications not expressly approved by the party responsible for compliance could void the user's authority to operate the equipment.

NOTE: This equipment has been tested and found to comply with the limits for a Class B digital device, pursuant to Part 15 of the FCC Rules. These limits are designed to provide reasonable protection against harmful interference in a residential installation. This equipment generates, uses instructions, may cause harmful interference to radio communications. However, there is no guarantee that interference will not occur in a particular installation. If this equipment does cause harmful interference to radio or television reception, which can be determined by turning the equipment off and on, the user is encouraged to try to correct the interference by one or more of the following measures:

- Reorient or relocate the receiving antenna.
- Increase the separation between the equipment and receiver.
- Connect the equipment into an outlet on a circuit different from that to which the receiver is connected.
- Consult the dealer or an experienced radio/TV technician for help.

FCC Radiation Exposure Statement

This equipment must be installed and operated in accordance with provided instructions and the antenna(s) used for this transmitter must be installed to provide a separation distance of at least 20 cm from all persons and must not be co-located or operating in conjunction with any other antenna or transmitter. End-users and installers must be provide with antenna installation instructions and transmitter operating conditions for satisfying RF exposure

[Buttons and Ports]

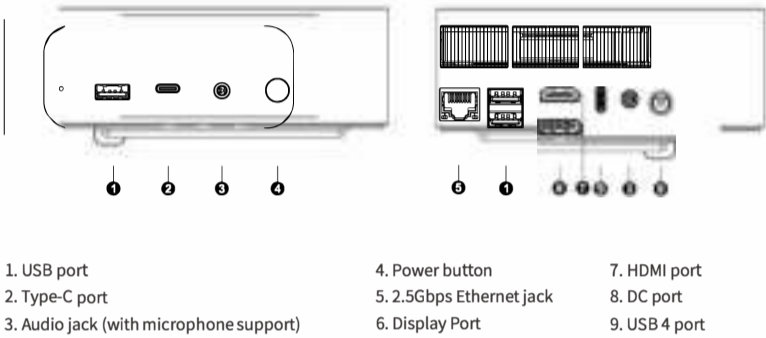

 To ensure safety and avoid hazards, we strongly recommend that you use the original power adapter for power supply.  
\*The specifications are subject to the actual product.

[Precautions for Use]

In order to continuously improve the user experience, we may occasionally update applications and firmware.

- Do not use strong chemical solvents to clean the product, and we recommend you wipe it with a soft cloth.
- Please keep this product away from fire.
- Please do not try to open the case or perform repairs yourself. If a failure occurs, please contact customer service.
- When cleaning the electronic product, please keep it dry and be cautious of electric shocks.
- Please check whether any cables or plugs are worn or damaged.
- Do not dispose of the product carelessly, be mindful to protect the environment.
- Ideal working environment temperature: 10°C-45°C; humidity: 30%-85%.
- Ideal storage environment temperature: -20°C-60°C; humidity: 10%-90%.



The terms “HDMI” and “HDMI High-Definition Multimedia Interface”, the HDMI trade dress, and the HDMI logo are all trademarks or registered trademarks of HDMI Licensing Administrator, Inc.

[RAM and SSD Installation (This operation should be performed when the power is disconnected)]

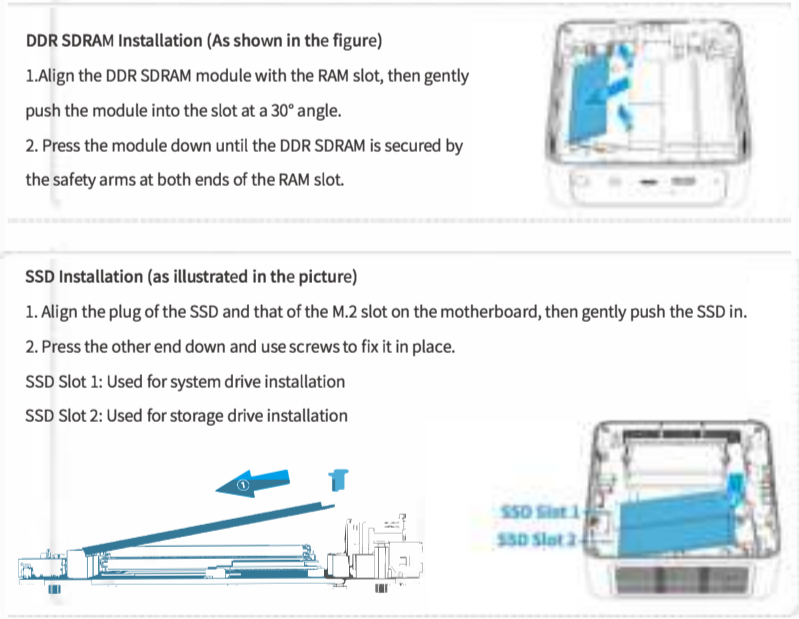

[Steps for Connection]

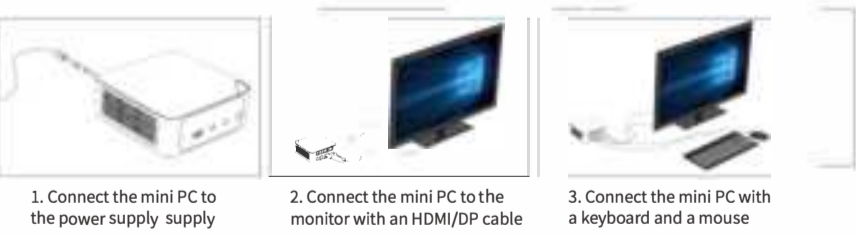

[Switching the Audio Playback Device in Windows]

If your PC is connected to multiple audio playback devices (eg. speakers, headphones, Bluetooth headset, monitors with built-in speakers, etc) simultaneously, you will need to choose one of them for audio playback

