

Job#/Project Name:	93120076 NPI C by GE 5857619 Q3
Version# (date)	6 (01-17-20) CN
Bar Code:	N/A
Insert:	NONE
Supplier Project#:	N/A
Print Method:	<input type="checkbox"/> Offset/Litho <input type="checkbox"/> Flexo (direct)
GE DIE#:	NOT CONTROLLED
PK#:	PK-00102820-1



Lighting Graphics Approval

Approvals designate all items on checklist have been reviewed & are correct in addition to other organizational responsibilities.

REVIEWED DATE	SIGNATURE	PACKAGING GRAPHICS
<div> <input type="checkbox"/> Proof Reading – Spelling <input type="checkbox"/> Website </div> <div> <input type="checkbox"/> Proof against TDS request <input type="checkbox"/> Graphics Printability </div>		

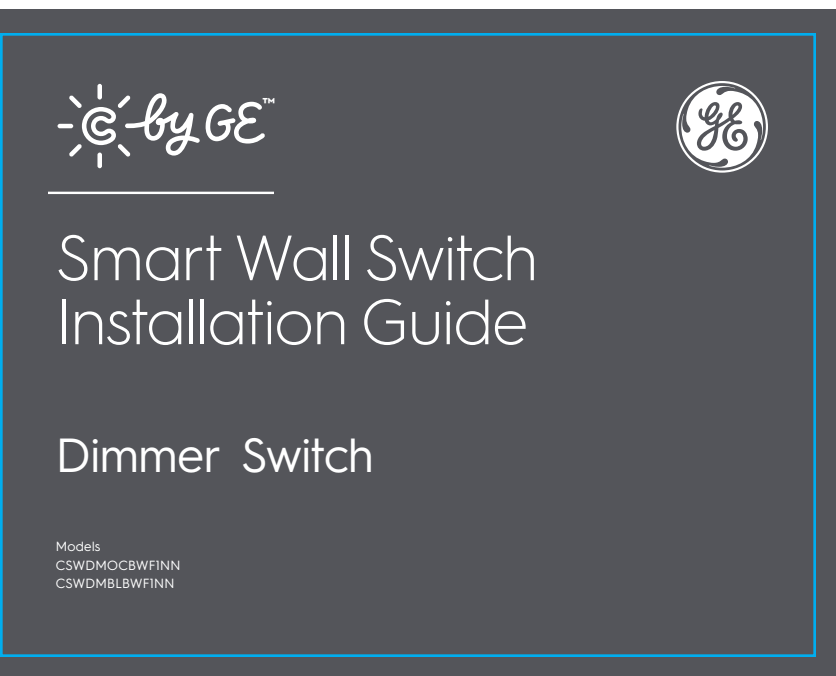

4.25"

PC93120076 INS

This art is supplied at 100% size.
Do not resize, reshape or alter in any way.

3.25"

digital review only

Process
CYAN

Process
MAGENTA

Process
YELLOW

Process
BLACK

PMS
COOL
GRAY 11

Job#/Project Name:	93120076 NPI C by GE 5857619 Q3
Version# (date)	6 (01-17-20) CN
Bar Code:	N/A
Insert:	NONE
Supplier Project#:	N/A
Print Method:	<input type="checkbox"/> Offset/Litho <input type="checkbox"/> Flexo (direct)
GE DIE#:	NOT CONTROLLED
PK#:	PK-00102820-1

Lighting Graphics App roval

Approvals designate all items on checklist have been reviewed & are correct in addition to other organizational responsibilities.

REVIEWED DATE	SIGNATURE	PACKAGING GRAPHICS
<div><div><input type="checkbox"/> Proof Reading – Spellig</div><div><input type="checkbox"/> Website</div><div><input type="checkbox"/> Proof against TDS request</div><div><input type="checkbox"/> Graphics Printability</div></div>		

Process
CYAN

Process
MAGENTA

Process
YELLOW

Process
BLACK

PMS
COOL
GRAY 11

Job#/Project Name:	93120076 NPI C by GE 5857619 Q3
Version# (date)	6 (01-17-20) CN
Bar Code:	N/A
Insert:	NONE
Supplier Project#:	N/A
Print Method:	<input type="checkbox"/> Offset/Litho <input type="checkbox"/> Flexo (direct)
GE DIE#:	NOT CONTROLLED
PK#:	PK-00102820-1

Lighting Graphics App roval

Approvals designate all items on checklist have been reviewed & are correct in addition to other organizational responsibilities.

REVIEWED DATE	SIGNATURE	PACKAGING GRAPHICS
<div><div><input type="checkbox"/> Proof Reading – Spellig</div><div><input type="checkbox"/> Website</div><div><input type="checkbox"/> Proof against TDS request</div><div><input type="checkbox"/> Graphics Printability</div></div>		

PC93120076 INS

This art is supplied at 100% size.
Do not resize, reshape or alter in any way.

digital review only

3.25"

4.25"

PC93120076 INS

This art is supplied at 100% size.
Do not resize, reshape or alter in any way.

digital review only

3.25"

4.25"

Process
CYAN

Process
MAGENTA

Process
YELLOW

Process
BLACK

PMS
COOL
GRAY 11

Job#/Project Name:	93120076 NPI C by GE 5857619 Q3
Version# (date)	6 (01-17-20) CN
Bar Code:	N/A
Insert:	NONE
Supplier Project#:	N/A
Print Method:	<input type="checkbox"/> Offset/Litho <input type="checkbox"/> Flexo (direct)
GE DIE#:	NOT CONTROLLED
PK#:	PK-00102820-1

Lighting Graphics App roval

Approvals designate all items on checklist have been reviewed & are correct in addition to other organizational responsibilities.

REVIEWED DATE	SIGNATURE	PACKAGING GRAPHICS
<div><div><input type="checkbox"/> Proof Reading – Spellig</div><div><input type="checkbox"/> Website</div><div><input type="checkbox"/> Proof against TDS#quest</div><div><input type="checkbox"/> Graphics Printabilijt</div></div>		

Process
CYAN

Process
MAGENTA

Process
YELLOW

Process
BLACK

PMS
COOL
GRAY 11

Job#/Project Name:	93120076 NPI C by GE 5857619 Q3
Version# (date)	6 (01-17-20) CN
Bar Code:	N/A
Insert:	NONE
Supplier Project#:	N/A
Print Method:	<input type="checkbox"/> Offset/Litho <input type="checkbox"/> Flexo (direct)
GE DIE#:	NOT CONTROLLED
PK#:	PK-00102820-1

Lighting Graphics App roval

Approvals designate all items on checklist have been reviewed & are correct in addition to other organizational responsibilities.

REVIEWED DATE	SIGNATURE	PACKAGING GRAPHICS
<div><div><input type="checkbox"/> Proof Reading – Spellig</div><div><input type="checkbox"/> Website</div><div><input type="checkbox"/> Proof against TDS#quest</div><div><input type="checkbox"/> Graphics Printabilijt</div></div>		

PC93120076 INS

This art is supplied at 100% size.
Do not resize, reshape or alter in any way.

digital review only

3.25"

Compatibility Requirements

- Rating 120V AC 60Hz

Works with halogen, incandescent and LED bulbs, including C by GE Smart Bulbs.

LED up to 150 watts

Incandescent/halogen up to 450 watts
- Neutral wire is not required (Wire is usually white or grey and is not required)

Ground wire is required (Wire is usually green, green with a yellow stripe, or copper) ⚡

Wi-Fi 802.11 b/g/n @ 2.4 GHZ is required

4.25"

! IMPORTANT NOTE ON 3-WAY WIRING:
Some lights have one wall switch, while others are controlled by two or more wall switches (such as stair lights, which have a switch at both the top and bottom of the stairs). If your lights have more than one switch (called a 3-way), we’ve created instructions for how to install and enable the capability.

Visit cbyge.com/switch-support for 3-way installation instructions and how-to-videos.

4.25"

PC93120076 INS

This art is supplied at 100% size.
Do not resize, reshape or alter in any way.

digital review only

3.25"

Process
CYAN

Process
MAGENTA

Process
YELLOW

Process
BLACK

PMS
COOL
GRAY 11

Job#/Project Name:	93120076 NPI C by GE 5857619 Q3
Version# (date)	6 (01-17-20) CN
Bar Code:	N/A
Insert:	NONE
Supplier Project#:	N/A
Print Method:	<input type="checkbox"/> Offset/Litho <input type="checkbox"/> Flexo (direct)
GE DIE#:	NOT CONTROLLED
PK#:	PK-00102820-1

Lighting Graphics App roval

Approvals designate all items on checklist have been reviewed & are correct in addition to other organizational responsibilities.

REVIEWED DATE	SIGNATURE	PACKAGING GRAPHICS
<div><div><input type="checkbox"/> Proof Reading – Spellig</div><div><input type="checkbox"/> Website</div><div><input type="checkbox"/> Proof against TDS request</div><div><input type="checkbox"/> Graphics Printability</div></div>		

Process
CYAN

Process
MAGENTA

Process
YELLOW

Process
BLACK

PMS
COOL
GRAY 11

Job#/Project Name:	93120076 NPI C by GE 5857619 Q3
Version# (date)	6 (01-17-20) CN
Bar Code:	N/A
Insert:	NONE
Supplier Project#:	N/A
Print Method:	<input type="checkbox"/> Offset/Litho <input type="checkbox"/> Flexo (direct)
GE DIE#:	NOT CONTROLLED
PK#:	PK-00102820-1

Lighting Graphics App roval

Approvals designate all items on checklist have been reviewed & are correct in addition to other organizational responsibilities.

REVIEWED DATE	SIGNATURE	PACKAGING GRAPHICS
<div><div><input type="checkbox"/> Proof Reading – Spellig</div><div><input type="checkbox"/> Website</div><div><input type="checkbox"/> Proof against TDS request</div><div><input type="checkbox"/> Graphics Printability</div></div>		

PC93120076 INS

This art is supplied at 100% size.
Do not resize, reshape or alter in any way.

digital review only

3.25"

Let's Do It

INCLUDED

Dimmer Switch

Wall Plate

4 Wire Nuts

Bulb Adaptor

2 Phillips Mounting Screws

2 Phillips Face Plate Screws

Wire Labels

Line/Load

Line/Load

Ground

YOU'LL NEED

Phillips Screwdriver

Needle Nose Pliers
(recommended)

Voltage Tester
(recommended)

Approximately
30 minutes of your day
to install and setup
the switch

4.25"

4.25"

PC93120076 INS

This art is supplied at 100% size.
Do not resize, reshape or alter in any way.

digital review only

3.25"

Process
CYAN

Process
MAGENTA

Process
YELLOW

Process
BLACK

PMS
COOL
GRAY 11

Job#/Project Name:	93120076 NPI C by GE 5857619 Q3
Version# (date)	6 (01-17-20) CN
Bar Code:	N/A
Insert:	NONE
Supplier Project#:	N/A
Print Method:	<input type="checkbox"/> Offset/Litho <input type="checkbox"/> Flexo (direct)
GE DIE#:	NOT CONTROLLED
PK#:	PK-00102820-1

Lighting Graphics App roval

Approvals designate all items on checklist have been reviewed & are correct in addition to other organizational responsibilities.

REVIEWED DATE	SIGNATURE	PACKAGING GRAPHICS
<div><div><input type="checkbox"/> Proof Reading – Spellig</div><div><input type="checkbox"/> Website</div><div><input type="checkbox"/> Proof against TDS#quest</div><div><input type="checkbox"/> Graphics Printabilijt</div></div>		

Process
CYAN

Process
MAGENTA

Process
YELLOW

Process
BLACK

PMS
COOL
GRAY 11

Job#/Project Name:	93120076 NPI C by GE 5857619 Q3
Version# (date)	6 (01-17-20) CN
Bar Code:	N/A
Insert:	NONE
Supplier Project#:	N/A
Print Method:	<input type="checkbox"/> Offset/Litho <input type="checkbox"/> Flexo (direct)
GE DIE#:	NOT CONTROLLED
PK#:	PK-00102820-1

Lighting Graphics App roval

Approvals designate all items on checklist have been reviewed & are correct in addition to other organizational responsibilities.

REVIEWED DATE	SIGNATURE	PACKAGING GRAPHICS
<div><div><input type="checkbox"/> Proof Reading – Spellig</div><div><input type="checkbox"/> Website</div><div><input type="checkbox"/> Proof against TDS#quest</div><div><input type="checkbox"/> Graphics Printabilijt</div></div>		

PC93120076 INS

This art is supplied at 100% size.
Do not resize, reshape or alter in any way.

digital review only

3.25"

You Got This!

And we’re here to help.
For in-depth instructional videos and a guided tour through the installation, go to cbyge.com/switch-support.

8

For Help, Go To: cbyge.com/switch-support or call 1-844-30C-BYGE

BEFORE YOU DO ANYTHING: Step 1

Turn Off The Power!

Turn off the power for the switch location at the circuit breaker box.

Test existing switch by toggling switch on/off, ensuring lights do not turn on.

Now, follow these setup steps for a single gang switch.

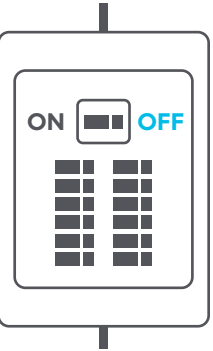

9

For Help, Go To: cbyge.com/switch-support or call 1-844-30C-BYGE

4.25"

4.25"

PC93120076 INS

This art is supplied at 100% size.
Do not resize, reshape or alter in any way.

digital review only

3.25"

Process
CYAN

Process
MAGENTA

Process
YELLOW

Process
BLACK

PMS
COOL
GRAY 11

Job#/Project Name:	93120076 NPI C by GE 5857619 Q3
Version# (date)	6 (01-17-20) CN
Bar Code:	N/A
Insert:	NONE
Supplier Project#:	N/A
Print Method:	<input type="checkbox"/> Offset/Litho <input type="checkbox"/> Flexo (direct)
GE DIE#:	NOT CONTROLLED
PK#:	PK-00102820-1

Lighting Graphics App roval

Approvals designate all items on checklist have been reviewed & are correct in addition to other organizational responsibilities.

REVIEWED DATE	SIGNATURE	PACKAGING GRAPHICS
<div><div><input type="checkbox"/> Proof Reading – Spellig</div><div><input type="checkbox"/> Website</div><div><input type="checkbox"/> Proof against TDS request</div><div><input type="checkbox"/> Graphics Printability</div></div>		

Process
CYAN

Process
MAGENTA

Process
YELLOW

Process
BLACK

PMS
COOL
GRAY 11

Job#/Project Name:	93120076 NPI C by GE 5857619 Q3
Version# (date)	6 (01-17-20) CN
Bar Code:	N/A
Insert:	NONE
Supplier Project#:	N/A
Print Method:	<input type="checkbox"/> Offset/Litho <input type="checkbox"/> Flexo (direct)
GE DIE#:	NOT CONTROLLED
PK#:	PK-00102820-1

Lighting Graphics App roval

Approvals designate all items on checklist have been reviewed & are correct in addition to other organizational responsibilities.

REVIEWED DATE	SIGNATURE	PACKAGING GRAPHICS
<div><div><input type="checkbox"/> Proof Reading – Spellig</div><div><input type="checkbox"/> Website</div><div><input type="checkbox"/> Proof against TDS request</div><div><input type="checkbox"/> Graphics Printability</div></div>		

PC93120076 INS

This art is supplied at 100% size.
Do not resize, reshape or alter in any way.

digital review only

3.25"

IF APPLICABLE
Install adaptor onto
C by GE smart or
non-dimmable LED bulbs

C by GE smart switches and dimmers are compatible with C by GE smart bulbs. To keep your C by GE bulbs always available and connected, the included bulb adaptor should be used to have full control of C by GE bulbs on the same circuit as the switch.

NOTE: Only one bulb adaptor is needed per switch, even if there are multiple C by GE bulbs on the circuit.

4.25"

Simply twist the bulb adaptor onto the base of one C by GE smart bulb and Screw into the fixture.

NOTE: Keep your bulb adaptor handy. Even if you don't have C by GE bulbs, the bulb adaptor can be used to improve the performance of some traditional LED bulbs if you begin experiencing any performance issues. If installing in a recessed can application, you may need to adjust the depth of the recessed can to ensure the bulb is flush. Go to: cbyge.com/switch-support for more helpful tips on when to use the bulb adaptor.

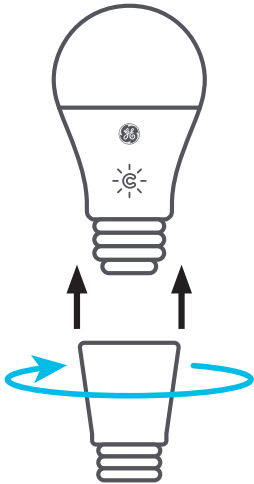

4.25"

PC93120076 INS

This art is supplied at 100% size.
Do not resize, reshape or alter in any way.

digital review only

3.25"

Process
CYAN

Process
MAGENTA

Process
YELLOW

Process
BLACK

PMS
COOL
GRAY 11

Job#/Project Name:	93120076 NPI C by GE 5857619 Q3
Version# (date)	6 (01-17-20) CN
Bar Code:	N/A
Insert:	NONE
Supplier Project#:	N/A
Print Method:	<input type="checkbox"/> Offset/Litho <input type="checkbox"/> Flexo (direct)
GE DIE#:	NOT CONTROLLED
PK#:	PK-00102820-1

Lighting Graphics App roval

Approvals designate all items on checklist have been reviewed & are correct in addition to other organizational responsibilities.

REVIEWED DATE	SIGNATURE	PACKAGING GRAPHICS
<div><div><input type="checkbox"/> Proof Reading – Spellig</div><div><input type="checkbox"/> Website</div><div><input type="checkbox"/> Proof against TDSrequest</div><div><input type="checkbox"/> Graphics Printabilijt</div></div>		

Process
CYAN

Process
MAGENTA

Process
YELLOW

Process
BLACK

PMS
COOL
GRAY 11

Job#/Project Name:	93120076 NPI C by GE 5857619 Q3
Version# (date)	6 (01-17-20) CN
Bar Code:	N/A
Insert:	NONE
Supplier Project#:	N/A
Print Method:	<input type="checkbox"/> Offset/Litho <input type="checkbox"/> Flexo (direct)
GE DIE#:	NOT CONTROLLED
PK#:	PK-00102820-1

Lighting Graphics App roval

Approvals designate all items on checklist have been reviewed & are correct in addition to other organizational responsibilities.

REVIEWED DATE	SIGNATURE	PACKAGING GRAPHICS
<div><div><input type="checkbox"/> Proof Reading – Spellig</div><div><input type="checkbox"/> Website</div><div><input type="checkbox"/> Proof against TDSrequest</div><div><input type="checkbox"/> Graphics Printabilijt</div></div>		

PC93120076 INS

This art is supplied at 100% size.
Do not resize, reshape or alter in any way.

digital review only

3.25"

- STEP 2
- Remove Your
Old Switch
1. Remove the existing wall plate and switch from the wall.

2. Use voltage tester on the black wires to confirm power to the switch is off (recommended).

3. Before disconnecting the wires from the wall, label each with the provided wire labels.

⚠ Ground wire is required. If you don't have this wire, the C by GE switch is not compatible.

4. Disconnect wires and remove existing switch.

4.25"

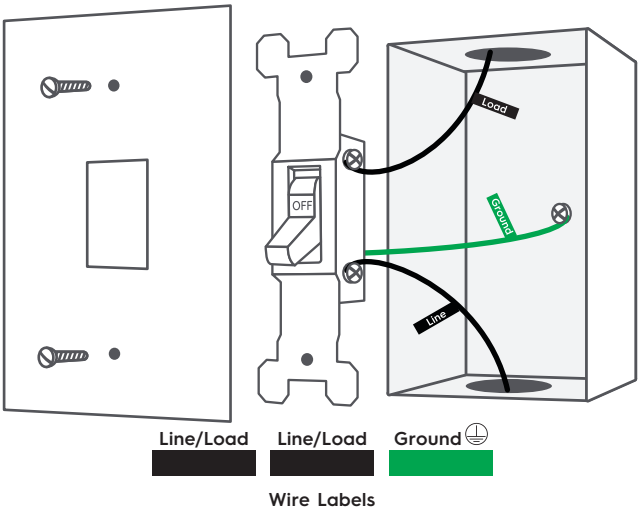

4.25"

PC93120076 INS

This art is supplied at 100% size.
Do not resize, reshape or alter in any way.

digital review only

3.25"

Process
CYAN

Process
MAGENTA

Process
YELLOW

Process
BLACK

PMS
COOL
GRAY 11

Job#/Project Name:	93120076 NPI C by GE 5857619 Q3
Version# (date)	6 (01-17-20) CN
Bar Code:	N/A
Insert:	NONE
Supplier Project#:	N/A
Print Method:	<input type="checkbox"/> Offset/Litho <input type="checkbox"/> Flexo (direct)
GE DIE#:	NOT CONTROLLED
PK#:	PK-00102820-1

Lighting Graphics App roval

Approvals designate all items on checklist have been reviewed & are correct in addition to other organizational responsibilities.

REVIEWED DATE	SIGNATURE	PACKAGING GRAPHICS
<div><div><input type="checkbox"/> Proof Reading – Spellig</div><div><input type="checkbox"/> Website</div><div><input type="checkbox"/> Proof against TDS#quest</div><div><input type="checkbox"/> Graphics Printabilijt</div></div>		

Process
CYAN

Process
MAGENTA

Process
YELLOW

Process
BLACK

PMS
COOL
GRAY 11

Job#/Project Name:	93120076 NPI C by GE 5857619 Q3
Version# (date)	6 (01-17-20) CN
Bar Code:	N/A
Insert:	NONE
Supplier Project#:	N/A
Print Method:	<input type="checkbox"/> Offset/Litho <input type="checkbox"/> Flexo (direct)
GE DIE#:	NOT CONTROLLED
PK#:	PK-00102820-1

Lighting Graphics App roval

Approvals designate all items on checklist have been reviewed & are correct in addition to other organizational responsibilities.

REVIEWED DATE	SIGNATURE	PACKAGING GRAPHICS
<div><div><input type="checkbox"/> Proof Reading – Spellig</div><div><input type="checkbox"/> Website</div><div><input type="checkbox"/> Proof against TDS#quest</div><div><input type="checkbox"/> Graphics Printabilijt</div></div>		

PC93120076 INS

This art is supplied at 100% size.
Do not resize, reshape or alter in any way.

digital review only

3.25"

STEP 3

Connect The Wires

- NOTE:** Both black wires on the switch are interchangeable and can be connected to either the load or line wire from the wall.
1. Connect the first line/load (black) wire on the switch to the line or load (black label) wire from the wall.
 2. Connect the second line/load (black) wire on the switch to the line or load (black label) wire from the wall.

3. Connect the ground (⊕)(green) wire on the switch with the ground (green label) wire from the wall.
4. Cap the 3-way/multi-way traveler wire (if applicable).
For 3-way switch setup, visit cbyge.com/switch-support
⚠Attention: Incorrectly connecting the Ground wire from the wall to the Ground wire on the switch will damage the product.
5. Cap the neutral wire from the wall (if applicable). Neutral wire is not required to operate this switch.

14

For Help, Go To: cbyge.com/switch-support or call 1-844-30C-BYGE

4.25"

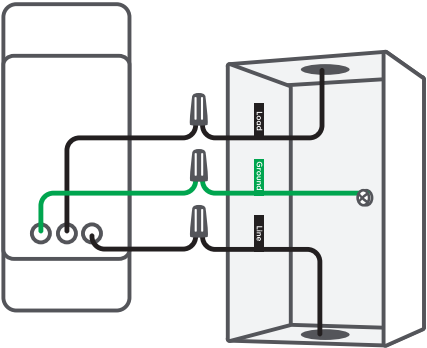

USING WIRE NUTS

1. Insert wires into wire nut.
2. Turn wire nut clockwise.
3. Pull gently on wires to test connection.

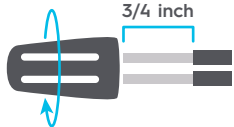

15

For Help, Go To: cbyge.com/switch-support or call 1-844-30C-BYGE

4.25"

PC93120076 INS

This art is supplied at 100% size.
Do not resize, reshape or alter in any way.

3.25"

digital review only

Process
CYAN

Process
MAGENTA

Process
YELLOW

Process
BLACK

PMS
COOL
GRAY 11

Job#/Project Name:	93120076 NPI C by GE 5857619 Q3
Version# (date)	6 (01-17-20) CN
Bar Code:	N/A
Insert:	NONE
Supplier Project#:	N/A
Print Method:	<input type="checkbox"/> Offset/Litho <input type="checkbox"/> Flexo (direct)
GE DIE#:	NOT CONTROLLED
PK#:	PK-00102820-1

Lighting Graphics App roval

Approvals designate all items on checklist have been reviewed & are correct in addition to other organizational responsibilities.

REVIEWED DATE	SIGNATURE	PACKAGING GRAPHICS
<div><div><input type="checkbox"/> Proof Reading – Spellig</div><div><input type="checkbox"/> Website</div><div><input type="checkbox"/> Proof against TDS#quest</div><div><input type="checkbox"/> Graphics Printabilijt</div></div>		

Process
CYAN

Process
MAGENTA

Process
YELLOW

Process
BLACK

PMS
COOL
GRAY 11

Job#/Project Name:	93120076 NPI C by GE 5857619 Q3
Version# (date)	6 (01-17-20) CN
Bar Code:	N/A
Insert:	NONE
Supplier Project#:	N/A
Print Method:	<input type="checkbox"/> Offset/Litho <input type="checkbox"/> Flexo (direct)
GE DIE#:	NOT CONTROLLED
PK#:	PK-00102820-1

Lighting Graphics App roval

Approvals designate all items on checklist have been reviewed & are correct in addition to other organizational responsibilities.

REVIEWED DATE	SIGNATURE	PACKAGING GRAPHICS
<div><div><input type="checkbox"/> Proof Reading – Spellig</div><div><input type="checkbox"/> Website</div><div><input type="checkbox"/> Proof against TDS#quest</div><div><input type="checkbox"/> Graphics Printabilijt</div></div>		

PC93120076 INS

This art is supplied at 100% size.
Do not resize, reshape or alter in any way.

3.25"

digital review only

STEP 4

Fit Wires Into Wall Box

Neatly push the wires back into the box, rotating the switch so it's oriented according to the image.

4.25"

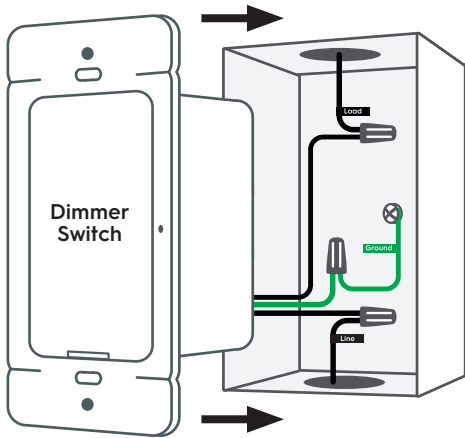

4.25"

PC93120076 INS

This art is supplied at 100% size.
Do not resize, reshape or alter in any way.

3.25"

digital review only

Process
CYAN

Process
MAGENTA

Process
YELLOW

Process
BLACK

PMS
COOL
GRAY 11

Job#/Project Name:	93120076 NPI C by GE 5857619 Q3
Version# (date)	6 (01-17-20) CN
Bar Code:	N/A
Insert:	NONE
Supplier Project#:	N/A
Print Method:	<input type="checkbox"/> Offset/Litho <input type="checkbox"/> Flexo (direct)
GE DIE#:	NOT CONTROLLED
PK#:	PK-00102820-1

Lighting Graphics App roval

Approvals designate all items on checklist have been reviewed & are correct in addition to other organizational responsibilities.

REVIEWED DATE	SIGNATURE	PACKAGING GRAPHICS
<div><div><input type="checkbox"/> Proof Reading – Spellig</div><div><input type="checkbox"/> Website</div><div><input type="checkbox"/> Proof against TDS request</div><div><input type="checkbox"/> Graphics Printability</div></div>		

Process
CYAN

Process
MAGENTA

Process
YELLOW

Process
BLACK

PMS
COOL
GRAY 11

Job#/Project Name:	93120076 NPI C by GE 5857619 Q3
Version# (date)	6 (01-17-20) CN
Bar Code:	N/A
Insert:	NONE
Supplier Project#:	N/A
Print Method:	<input type="checkbox"/> Offset/Litho <input type="checkbox"/> Flexo (direct)
GE DIE#:	NOT CONTROLLED
PK#:	PK-00102820-1

Lighting Graphics App roval

Approvals designate all items on checklist have been reviewed & are correct in addition to other organizational responsibilities.

REVIEWED DATE	SIGNATURE	PACKAGING GRAPHICS
<div><div><input type="checkbox"/> Proof Reading – Spellig</div><div><input type="checkbox"/> Website</div><div><input type="checkbox"/> Proof against TDS request</div><div><input type="checkbox"/> Graphics Printability</div></div>		

PC93120076 INS

This art is supplied at 100% size.
Do not resize, reshape or alter in any way.

digital review only

3.25"

STEP 5

Secure
The Switch

Using a Phillips screwdriver and the screws provided, secure the switch to the wall until level and flush. Then snap the faceplate cover onto the bracket.

18

For Help, Go To: cbyge.com/switch-support or call 1-844-30C-BYGE

4.25"

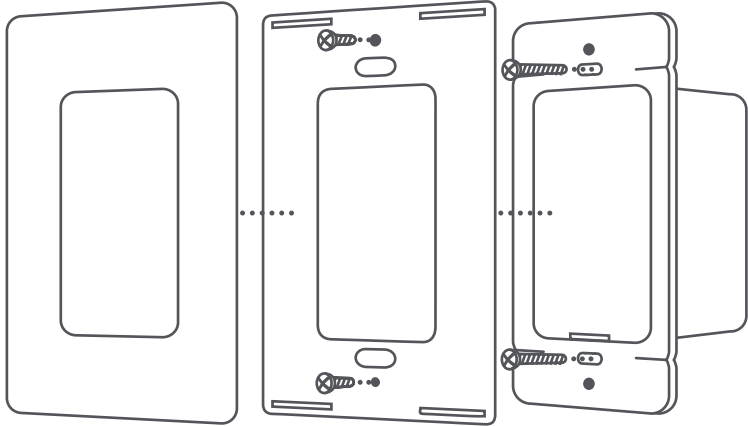

For Help, Go To: cbyge.com/switch-support or call 1-844-30C-BYGE

19

4.25"

PC93120076 INS

This art is supplied at 100% size.
Do not resize, reshape or alter in any way.

digital review only

3.25"

Process
CYAN

Process
MAGENTA

Process
YELLOW

Process
BLACK

PMS
COOL
GRAY 11

Job#/Project Name:	93120076 NPI C by GE 5857619 Q3
Version# (date)	6 (01-17-20) CN
Bar Code:	N/A
Insert:	NONE
Supplier Project#:	N/A
Print Method:	<input type="checkbox"/> Offset/Litho <input type="checkbox"/> Flexo (direct)
GE DIE#:	NOT CONTROLLED
PK#:	PK-00102820-1

Lighting Graphics App roval

Approvals designate all items on checklist have been reviewed & are correct in addition to other organizational responsibilities.

REVIEWED DATE	SIGNATURE	PACKAGING GRAPHICS
<div><div><input type="checkbox"/> Proof Reading – Spellig</div><div><input type="checkbox"/> Website</div><div><input type="checkbox"/> Proof against TDS#quest</div><div><input type="checkbox"/> Graphics Printabilijt</div></div>		

Process
CYAN

Process
MAGENTA

Process
YELLOW

Process
BLACK

PMS
COOL
GRAY 11

Job#/Project Name:	93120076 NPI C by GE 5857619 Q3
Version# (date)	6 (01-17-20) CN
Bar Code:	N/A
Insert:	NONE
Supplier Project#:	N/A
Print Method:	<input type="checkbox"/> Offset/Litho <input type="checkbox"/> Flexo (direct)
GE DIE#:	NOT CONTROLLED
PK#:	PK-00102820-1

Lighting Graphics App roval

Approvals designate all items on checklist have been reviewed & are correct in addition to other organizational responsibilities.

REVIEWED DATE	SIGNATURE	PACKAGING GRAPHICS
<div><div><input type="checkbox"/> Proof Reading – Spellig</div><div><input type="checkbox"/> Website</div><div><input type="checkbox"/> Proof against TDS#quest</div><div><input type="checkbox"/> Graphics Printabilijt</div></div>		

PC93120076 INS

This art is supplied at 100% size.
Do not resize, reshape or alter in any way.

digital review only

3.25"

STEP 6

Turn The Power Back On

After the switch is secured and faceplate mounted, turn the power back on at the circuit breaker box.

At the switch, LED indicator light or light ring will flash blue indicating the device is wired correctly and the device is in setup mode. Press any button on the switch to enable setup mode if setup mode times out.

20 For Help, Go To: cbyge.com/switch-support or call 1-844-30C-BYGE

LED indicator light or light ring will flash blue until the switch is added to the C by GE app.

LED indicator light or light ring will flash red if the circuit is overloaded. Max load rating 150 watts for LED and 450 watts for incandescent/halogen.

LED indicator light or light ring will not illuminate if wired incorrectly.

IF LIGHTS DON'T TURN ON:

- Check that power to the switch is on at the breaker.
- Turn power off at the breaker, return to the switch to confirm the wires are securely and properly wired according to the installation guide.
- Go to cbyge.com/switch-support for more troubleshooting.

For Help, Go To: cbyge.com/switch-support or call 1-844-30C-BYGE 21

4.25"

4.25"

PC93120076 INS

This art is supplied at 100% size.
Do not resize, reshape or alter in any way.

digital review only

3.25"

Process
CYAN

Process
MAGENTA

Process
YELLOW

Process
BLACK

PMS
COOL
GRAY 11

Job#/Project Name:	93120076 NPI C by GE 5857619 Q3
Version# (date)	6 (01-17-20) CN
Bar Code:	N/A
Insert:	NONE
Supplier Project#:	N/A
Print Method:	<input type="checkbox"/> Offset/Litho <input type="checkbox"/> Flexo (direct)
GE DIE#:	NOT CONTROLLED
PK#:	PK-00102820-1

Lighting Graphics App roval

Approvals designate all items on checklist have been reviewed & are correct in addition to other organizational responsibilities.

REVIEWED DATE	SIGNATURE	PACKAGING GRAPHICS
<div><div><input type="checkbox"/> Proof Reading – Spellig</div><div><input type="checkbox"/> Website</div><div><input type="checkbox"/> Proof against TDS#quest</div><div><input type="checkbox"/> Graphics Printabilijt</div></div>		

Process
CYAN

Process
MAGENTA

Process
YELLOW

Process
BLACK

PMS
COOL
GRAY 11

Job#/Project Name:	93120076 NPI C by GE 5857619 Q3
Version# (date)	6 (01-17-20) CN
Bar Code:	N/A
Insert:	NONE
Supplier Project#:	N/A
Print Method:	<input type="checkbox"/> Offset/Litho <input type="checkbox"/> Flexo (direct)
GE DIE#:	NOT CONTROLLED
PK#:	PK-00102820-1

Lighting Graphics App roval

Approvals designate all items on checklist have been reviewed & are correct in addition to other organizational responsibilities.

REVIEWED DATE	SIGNATURE	PACKAGING GRAPHICS
<div><div><input type="checkbox"/> Proof Reading – Spellig</div><div><input type="checkbox"/> Website</div><div><input type="checkbox"/> Proof against TDS#quest</div><div><input type="checkbox"/> Graphics Printabilijt</div></div>		

PC93120076 INS

This art is supplied at 100% size.
Do not resize, reshape or alter in any way.

digital review only

3.25"

Congratulations!

You’ve completed the Smart Switch installation.

Next...

Download the C by GE app

Add your Smart Switch to the C by GE app

Setup your Alexa or Google voice assistant following the instructions in the C by GE app

Enable Your Voice Assistant

Amazon Alexa

To setup, open the Alexa app, search for the C by GE skill, follow the setup instructions.

Try this...

Alexa, turn off the living room.

Alexa, turn on the bedroom.

Google Assistant

To setup, open the Google Assistant or Google Home app, search for the C by GE action, follow the setup instructions.

Try this...

Hey Google, turn on the lights.

Hey Google, good morning.

Hey Google, I’m leaving.

4.25"

4.25"

PC93120076 INS

This art is supplied at 100% size.
Do not resize, reshape or alter in any way.

digital review only

3.25"

Process
CYAN

Process
MAGENTA

Process
YELLOW

Process
BLACK

PMS
COOL
GRAY 11

Job#/Project Name:	93120076 NPI C by GE 5857619 Q3
Version# (date)	6 (01-17-20) CN
Bar Code:	N/A
Insert:	NONE
Supplier Project#:	N/A
Print Method:	<input type="checkbox"/> Offset/Litho <input type="checkbox"/> Flexo (direct)
GE DIE#:	NOT CONTROLLED
PK#:	PK-00102820-1

Lighting Graphics App roval

Approvals designate all items on checklist have been reviewed & are correct in addition to other organizational responsibilities.

REVIEWED DATE	SIGNATURE	PACKAGING GRAPHICS
<div><div><input type="checkbox"/> Proof Reading – Spellig</div><div><input type="checkbox"/> Website</div><div><input type="checkbox"/> Proof against TDS request</div><div><input type="checkbox"/> Graphics Printability</div></div>		

Process
CYAN

Process
MAGENTA

Process
YELLOW

Process
BLACK

PMS
COOL
GRAY 11

Job#/Project Name:	93120076 NPI C by GE 5857619 Q3
Version# (date)	6 (01-17-20) CN
Bar Code:	N/A
Insert:	NONE
Supplier Project#:	N/A
Print Method:	<input type="checkbox"/> Offset/Litho <input type="checkbox"/> Flexo (direct)
GE DIE#:	NOT CONTROLLED
PK#:	PK-00102820-1

Lighting Graphics App roval

Approvals designate all items on checklist have been reviewed & are correct in addition to other organizational responsibilities.

REVIEWED DATE	SIGNATURE	PACKAGING GRAPHICS
<div><div><input type="checkbox"/> Proof Reading – Spellig</div><div><input type="checkbox"/> Website</div><div><input type="checkbox"/> Proof against TDS request</div><div><input type="checkbox"/> Graphics Printability</div></div>		

PC93120076 INS

This art is supplied at 100% size.
Do not resize, reshape or alter in any way.

3.25"

digital review only

Additional Information and Warnings

FCC Compliance Statement Compliance Notice:

This equipment has been tested and found to comply with the limits for a Class B digital device, pursuant to part 15 of the FCC Rules. These limits are designed to provide reasonable protection against harmful interference in a residential installation. This equipment generates, uses and can radiate radio frequency energy and, if not installed and used in accordance with the instructions, may cause harmful interference to radio communications. However, there is no guarantee that interference will not occur in a particular installation. If this equipment does cause harmful interference to radio or television reception, which can be determined by turning the equipment off and on, the user is encouraged to try to correct the interference by one or more of the following measures:

- Reorient or relocate the receiving antenna.
- Increase the separation between the equipment and receiver.
- Connect the equipment into an outlet on a circuit different from that to which the receiver is connected.
- Consult the dealer or an experienced radio/TV technician for help.

This device contains license-exempt transmitter(s)/receiver(s) that comply with Innovation, Science and Economic Development Canada's license-exempt RSS(s). Operation is subject to the following two conditions:

1. This device may not cause interference.
2. This device must accept any interference, including interference that may cause undesired operation of the device.

Changes or modifications that are not expressly approved by the manufacturer could void the user's authority to operate the equipment.

RF Exposure Information:
This equipment complies with FCC radiation exposure limits set forth for an uncontrolled environment. In order to avoid the possibility of exceeding the FCC radio frequency exposure limits, human proximity to the antenna shall not be less than 8 inches during normal operation.

RF Exposure Statement:
This equipment complies with IC RSS-102 radiation exposure limits set forth for an uncontrolled environment. This transmitter must be installed to provide a separation distance of at least 8 inches from all persons and must not be collocated or operating in conjunction with any other antenna or transmitter.

4.25"

4.25"

PC93120076 INS

This art is supplied at 100% size.
Do not resize, reshape or alter in any way.

3.25"

digital review only

Process
CYAN

Process
MAGENTA

Process
YELLOW

Process
BLACK

PMS
COOL
GRAY 11

Job#/Project Name:	93120076 NPI C by GE 5857619 Q3
Version# (date)	6 (01-17-20) CN
Bar Code:	N/A
Insert:	NONE
Supplier Project#:	N/A
Print Method:	<input type="checkbox"/> Offset/Litho <input type="checkbox"/> Flexo (direct)
GE DIE#:	NOT CONTROLLED
PK#:	PK-00102820-1

Lighting Graphics App roval

Approvals designate all items on checklist have been reviewed & are correct in addition to other organizational responsibilities.

REVIEWED DATE	SIGNATURE	PACKAGING GRAPHICS
<div><div><input type="checkbox"/> Proof Reading – Spellig</div><div><input type="checkbox"/> Website</div><div><input type="checkbox"/> Proof against TDS#quest</div><div><input type="checkbox"/> Graphics Printabilijt</div></div>		

Process
CYAN

Process
MAGENTA

Process
YELLOW

Process
BLACK

PMS
COOL
GRAY 11

Job#/Project Name:	93120076 NPI C by GE 5857619 Q3
Version# (date)	6 (01-17-20) CN
Bar Code:	N/A
Insert:	NONE
Supplier Project#:	N/A
Print Method:	<input type="checkbox"/> Offset/Litho <input type="checkbox"/> Flexo (direct)
GE DIE#:	NOT CONTROLLED
PK#:	PK-00102820-1

Lighting Graphics App roval

Approvals designate all items on checklist have been reviewed & are correct in addition to other organizational responsibilities.

REVIEWED DATE	SIGNATURE	PACKAGING GRAPHICS
<div><div><input type="checkbox"/> Proof Reading – Spellig</div><div><input type="checkbox"/> Website</div><div><input type="checkbox"/> Proof against TDS#quest</div><div><input type="checkbox"/> Graphics Printabilijt</div></div>		

PC93120076 INS

This art is supplied at 100% size.
Do not resize, reshape or alter in any way.

3.25"

digital review only

Renseignements supplémentaires et mises en garde

Déclaration de conformité aux normes de la FCC :

Cet appareil a été testé et reconnu conforme aux limites établies pour les appareils numériques de classe B, selon la section 15 des règlements de la FCC. Ces limites sont conçues pour assurer une protection raisonnable contre le brouillage préjudiciable dans une installation résidentielle. Cet équipement produit, utilise et peut dégager une énergie de fréquence radio; s'il n'est pas installé et utilisé conformément aux consignes, il peut provoquer un brouillage préjudiciable aux communications radio. Cependant, il n'y a aucune garantie quant à l'absence de brouillage dans une installation particulière. Si cet équipement ne provoque pas d'interférence nuisible à la réception de la radio ou de la télévision, ce qu'on peut déterminer en éteignant puis en allumant l'équipement, l'utilisateur est encouragé à essayer de corriger l'interférence en appliquant l'une ou plusieurs des mesures suivantes :

- Réorienter ou repositionner l'antenne de réception.
- Angmenter la distance séparant l'équipement du récepteur.
- Connecter l'équipement à une prise sur un circuit différent de celui auquel le récepteur est branché.
- Consulter le revendeur ou un technicien de radio/TV expérimenté pour obtenir de l'aide.

26

4.25"

L'émetteur/récepteur exempt de licence contenu dans le présent appareil est conforme aux CNR d'Innovation, Sciences et Développement économique Canada applicables aux appareils radio exempts de licence. L'exploitation est autorisée aux deux conditions suivantes :

1. L'appareil ne doit pas produire de brouillage;
2. L'appareil doit accepter tout brouillage radioélectrique subi, même si le brouillage est susceptible d'en compromettre le fonctionnement.

Tout changement non expressément autorisé par le fabricant peut annuler les droits de l'utilisateur d'utiliser cet équipement.

Renseignements relatifs à l'exposition aux radiofréquences :
Cet équipement est conforme aux limites d'exposition aux rayons de la FCC, définies pour un environnement non contrôlé. Afin d'éviter la possibilité de dépasser les limites d'exposition aux radiofréquences établies par la FCC, toute personne ne devait pas se tenir à moins de 20 cm (8 po) de l'antenne lors d'un fonctionnement normal.

Déclaration relative à l'exposition aux radiofréquences :
Cet équipement est conforme aux limites d'exposition aux rayons de la norme IC RSS-102, définies pour un environnement non contrôlé. Cet émetteur doit être installé à au moins 20 cm (8 po) de toutes les personnes et ne doit pas être colocalisé ou fonctionner conjointement avec une autre antenne ou un autre émetteur.

27

4.25"

PC93120076 INS

This art is supplied at 100% size.
Do not resize, reshape or alter in any way.

3.25"

digital review only

Process
CYAN

Process
MAGENTA

Process
YELLOW

Process
BLACK

Process
BLACK

PMS
COOL
GRAY 11

Job#/Project Name:	93120076 NPI C by GE 5857619 Q3
Version# (date)	6 (01-17-20) CN
Bar Code:	N/A
Insert:	NONE
Supplier Project#:	N/A
Print Method:	<input type="checkbox"/> Offset/Litho <input type="checkbox"/> Flexo (direct)
GE DIE#:	NOT CONTROLLED
PK#:	PK-00102820-1

Lighting Graphics App roval

Approvals designate all items on checklist have been reviewed & are correct in addition to other organizational responsibilities.

REVIEWED
DATE

SIGNATURE

PACKAGING GRAPHICS

☐ Proof Reading – Spellig

☐ Website

☐ Proof against TDS request

☐ Graphics Printability

Process
CYAN

Process
MAGENTA

Process
YELLOW

Process
BLACK

Process
BLACK

PMS
COOL
GRAY 11

Job#/Project Name:	93120076 NPI C by GE 5857619 Q3
Version# (date)	6 (01-17-20) CN
Bar Code:	N/A
Insert:	NONE
Supplier Project#:	N/A
Print Method:	<input type="checkbox"/> Offset/Litho <input type="checkbox"/> Flexo (direct)
GE DIE#:	NOT CONTROLLED
PK#:	PK-00102820-1

Lighting Graphics App roval

Approvals designate all items on checklist have been reviewed & are correct in addition to other organizational responsibilities.

REVIEWED
DATE

SIGNATURE

PACKAGING GRAPHICS

☐ Proof Reading – Spellig

☐ Website

☐ Proof against TDS request

☐ Graphics Printability

PC93120076 INS

This art is supplied at 100% size.
Do not resize, reshape or alter in any way.

3.25"

digital review only

For supply connections, use copper wire only rated at 105°C.

⚠ CAUTION - High Voltage - Disconnect power supply before servicing
Operation temperature: 0-40°C
For Control of Electronic Ballast, CFLs, LED, and LED Lamps.
Type 1 Enclosure
IP20
Pollution Degree 2
Impulse Voltage: 2500V
Type 1 action
CAN ICES-3 (B)/NMB-3(B)

Indoor use only.

Cu

AL

28

Pour les raccordements d'alimentation, utiliser du fil de cuivre d'une température nominale de 105 °C seulement.

⚠ ATTENTION – Haute tension – Débrancher l'alimentation électrique avant d'effectuer l'entretien
Température de fonctionnement : De 0 °C à 40 °C
Pour le contrôle des lampes à ballast électronique, fluocompactes et à DEL.
Boîtier de type 1
IP20
Degré de pollution 2
Tension de choc : 2 500 V
Action de type 1
CAN ICES-3 (B)/NMB-3(B)

Réservé à un usage intérieur.

Cu

AL

29

4.25"

PC93120076 INS

This art is supplied at 100% size.
Do not resize, reshape or alter in any way.

3.25"

digital review only

4.25"

Process
CYANProcess
MAGENTAProcess
YELLOWProcess
BLACKPMS
COOL
GRAY 11

Job#/Project Name:	93120076 NPI C by GE 5857619 Q3
Version# (date)	6 (01-17-20) CN
Bar Code:	N/A
Insert:	NONE
Supplier Project#:	N/A
Print Method:	<input type="checkbox"/> Offset/Litho <input type="checkbox"/> Flexo (direct)
GE DIE#:	NOT CONTROLLED
PK#:	PK-00102820-1



Lighting Graphics App roval

Approvals designate all items on checklist have been reviewed & are correct in addition to other organizational responsibilities.

REVIEWED
DATE

SIGNATURE

PACKAGING GRAPHICS

☐ Proof Reading - Spelling☐ Website☐ Proof against TDS request☐ Graphics Printability

PC93120076 INS

This art is supplied at 100% size.
Do not resize, reshape or alter in any way.

digital review only

3.25"

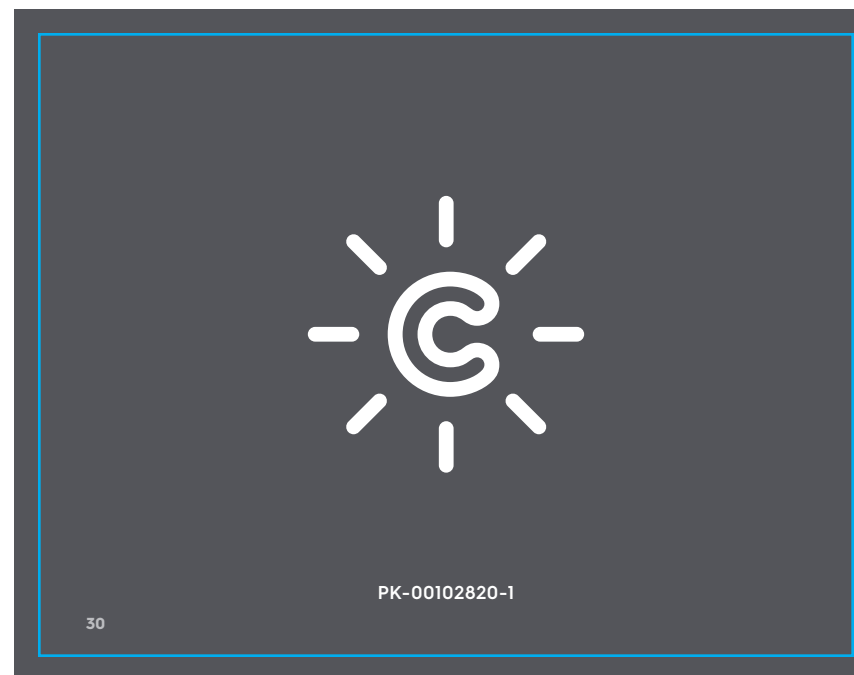

4.25"