

Sonoff®

2路WiFi智能开关

型号：DUALR2

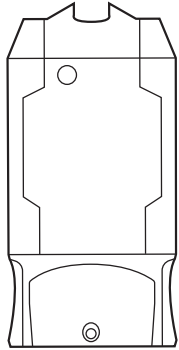

产品参数:

输入电压：交流 100~240V 50/60Hz
输出电压：交流 100~240V 50/60Hz
最大功率：单路2200W，两路总功率3500W
WiFi标准：2.4G b/g/n

使用该设备前请检查以下事项：

- 您的智能手机或平板已连接上一个能上网的2.4G WiFi。
- 使用安卓系统的手机或平板，系统必须是4.0以上版本。
- 使用苹果手机或iPad必须能够访问APP商店并下载APP。
- 如果您的无线路由器设置了MAC地址过滤，请先进入路由器后台关闭MAC过滤功能。



产品使用说明

- 在各大应用市场搜索“易微联”或扫码下载安装。



下载免费“易微联”APP

- 安装过程如有提示权限请求请选择允许。
- 注册账号并登录易微联。

- 打开保护盖，按照设备外壳指示正确接线。

注：本设备的开关原理是通过控制电路火线的通断，从而实现电路工作和停止。本设备必须零火线供电，设备才能正常工作。



中英文对照：
L：火线
N：零线
Input：电源输入
Output：输出（接电器）

4.1 控制两路电器正确接线方法。

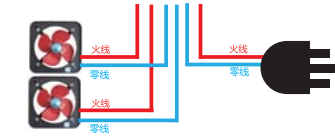

4.2 控制两路单火线开关正确接线方法（比如灯具开关）。



- 上电后，长按设备上的配置按钮大约7秒，直到WiFi指示灯快闪（闪两下亮一秒），松开。此时设备处于等待配对添加状态。

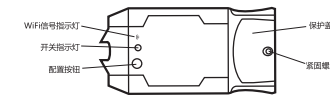

注：由于外壳限制，该设备没有配置手动开关按钮。手动开关接口有做在板子上，可以自行引出。

- 进入易微联，点击APP上的添加按钮 +



- 输入手机当前连接的WiFi密码，下一步。
- 待APP自动添加完成，给设备命名，完成添加。
- 当设备的WiFi指示灯长亮，即可进行远程遥控。

常见问题及解决办法

设备添加成功后，显示离线，无法控制？

答：设备刚添加成功后，需要一两分钟时间连接您的路由器并联网。如果长时间还是显示不在线，请根据设备WiFi指示灯的状态来判断：
指示灯一秒快闪一下：说明设备没有连上您的WiFi。
①可能是WiFi密码输入不正确。
②可能是设备离您的路由器太远，信号太弱，或环境有干扰。请先将设备靠近路由器，如无改善，请断电，然后再重新添加一遍。
③设备不能识别5G的WiFi，请选择2.4G的WiFi重新添加。
④检查您的路由器后台是否开启MAC地址过滤。如有，请关闭。

如果以上均尝试后不能解决，请用一部手机开启个人热点，尝试重新添加。

指示灯一秒快闪2下：说明设备已连接到了WiFi但未连上外网。请确认您的WiFi当前连接外网是否稳定、正常。如时时好时坏，频繁出现这种双闪情况，说明您的网络不稳定，并非产品原因。

*扫码阅读使用Amazon Echo音箱和Google Home音箱语音控制的教程。



ewelink.coolkit.cc
扫码阅读最新的使用说明和帮助



产品安装时，请确保产品的输入线已断开，以免发生触电。
When installing the product, make sure that the product's input cord is disconnected to prevent electric shock.

Sonoff®

2-Gang WiFi Smart Switch

Model: DUALR2

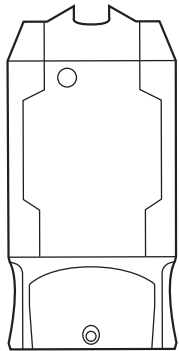

Parameter:

Input voltage: 100-240V AC 50/60Hz
Max. load: 10A,2200W/gang
Max. total load: 15A,3500W
WiFi standard: 2.4GHz b/g/n

Checklist before using the device

- Your smart phone or tablet has connected to a 2.4G WiFi with internet.
- You have the correct WiFi password.
- Your smart phone or tablet must have access to APP Store, Google Play.
- Make sure that your router is MAC-open.

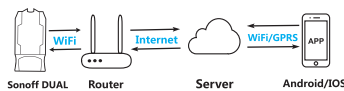

User Guide

- Start with "Ewelink" APP.



- Register an Ewelink account.
- If you have Ewelink account, just log in.

- Open the front cover, power up.

ON/OFF operating principle:
The connected appliances work/stop through live wire power on/off. The device must be powered by L and N.

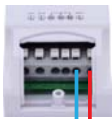

4.1 2 appliances Wiring Instruction.

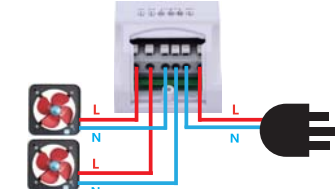

4.2 One wire output instruction (Eg: lights).

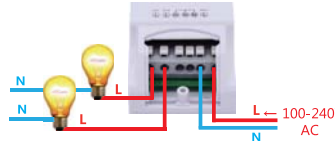

- Press the button for 7 seconds until the WiFi LED blinks like this: blinks 3 times and on repeatedly.

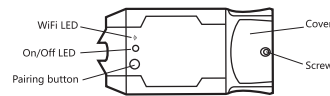

NOTE: This device does not have manual switch buttons. The board has manual switch interface, you can connect with wires to provide the buttons.

- Tap + on Ewelink app.

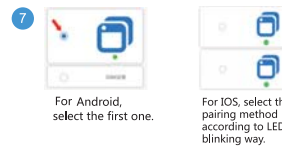

- Input your WiFi SSID & password.
- Name your device to complete.
- When the WiFi LED is on, the device is online. Start to control now!

Troubleshooting

Q: My device on the app stays "Offline" ?

A: The new added device needs 1min to connect to WiFi and the Internet. If it stays offline for a long time, please judge the problem by the WiFi LED status:

WiFi LED quickly blinks one time every second:

Device failed to connect to your WiFi:

- Maybe you have entered wrong WiFi password.
- Device is too far away from your WiFi. Please take it closer.
- Device can not be added to the 5G-wifi-router, only the 2.4G-wifi is OK.
- Make sure your router is MAC-open.

If still failed, try to open a mobile hot spot and add again.

WiFi LED quickly blinks twice every second:
Device has connected to WiFi but failed to connect to server. Please check your network connectivity.

Scan the user guide to read Ewelink works with Amazon Echo, Google Home and Google Nest tutorials.



Scan to download Ewelink free APP



Scan to read the detailed user guide

FCC Warning

Any Changes or modifications not expressly approved by the party responsible for compliance could void the user's authority to operate the equipment.
This device complies with part 15 of the FCC Rules. Operation is subject to the following two conditions:
(1) This device may not cause harmful interference, and
(2) this device must accept any interference received, including interference that may cause undesired operation.

FCC Radiation Exposure Statement:
This equipment complies with FCC radiation exposure limits set forth for an uncontrolled environment. This equipment should be installed and operated with minimum distance 20cm between the radiator & your body.
This transmitter must not be co-located or operating in conjunction with any other antenna or transmitter.

Note: This equipment has been tested and found to comply with the limits for a Class B digital device, pursuant to part 15 of the FCC Rules. These limits are designed to provide reasonable protection against harmful interference in a residential installation. This equipment generates uses and can radiate radio frequency energy and, if not installed and used in accordance with the instructions, may cause harmful interference to radio communications. However, there is no guarantee that interference will not occur in a particular installation. If this equipment does cause harmful interference to radio or television reception, which can be determined by turning the equipment off and on, the user is encouraged to try to correct the interference by one or more of the following measures:
—Reorient or relocate the receiving antenna.
—Increase the separation between the equipment and receiver.
—Connect the equipment into an outlet on a circuit different from that to which the receiver is connected.
—Consult the dealer or an experienced radio/TV technician for help.