



Set-Top Box Start



1 Unbox



Welcome Kit



Activation
Information Card

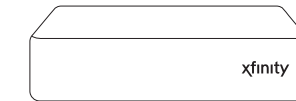

Set-Top Box



Quick Start Guide

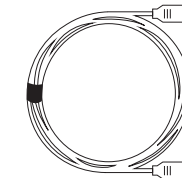

HDMI Cable

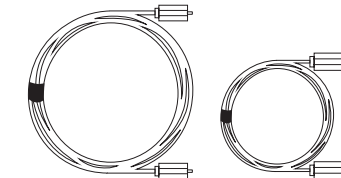

2 Coax Cables

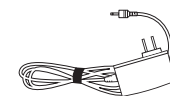

Power Cord



Remote
with (+2 AA
Batteries) Included

2 Connect

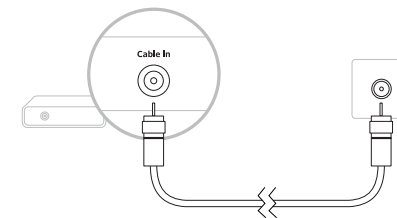

A

Connect the cable wall outlet to the **Cable In** on the Set-Top Box with a **coax cable**.

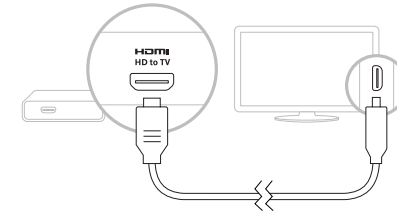

B

If you have an **HDTV**, use the **HDMI cable** to connect the **HDMI Out** connection on your set-top box to the **HDMI In** connection on your TV.

— or —

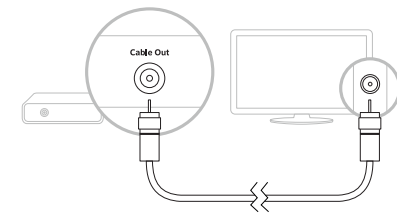

If **not**, use the other **coax cable** to connect your TV to the **TV/RF Cable Out** connection.

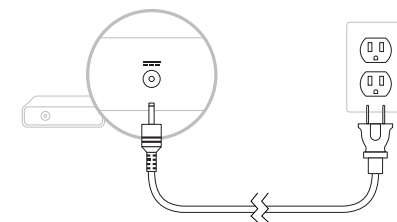

C

Connect the power cord from your **Set-Top Box** to an electrical outlet and wait for it to boot up.

3 Activate

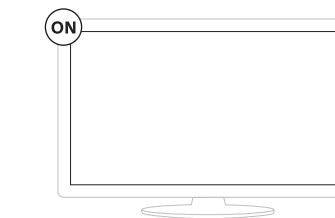

A

Turn on your TV and select the proper input.

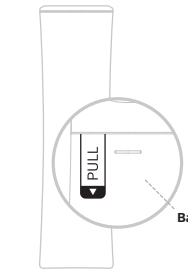

B

Remove the plastic tab from the back of the Remote to turn it on. Refer to the **Remote Setup Guide** to program your remote to control your TV or audio device.

For help, go to xfinity.com/remotes



C

Locate the **Activation Information Card** and follow the on-screen messaging to activate your XFINITY service.

? Seeing a blank screen? Make sure you've selected the proper input on your TV.

Need help ?
Visit xfinity.com/remotes
Use the My Account app for Mobile (iOS/Android) or X1

Keep for future reference, but if you decide to toss, please recycle.

Quick Start Guide v.1.0
1698397C Printed in China