

Safety Instructions

- Read and follow all safety instructions
- Use this product with the provided power adapter only.
 - This product is not waterproof. Avoid exposing it to splashes, water drops, or high-humidity environments.
 - The internal light sources of this product cannot be replaced. If the light sources sustain damage, this product must be replaced.
 - Do not allow children to assemble and install this product without adult supervision.
 - External dimmers cannot be used with this product.
 - Avoid installing this product near potentially dangerous or damaging sources (e.g., candles, liquid-filled objects).
 - Install this product on a clean, dry surface in order to maximize adhesion.
 - Avoid pulling this product's power cord forcibly.
 - Avoid assembling this product with parts from other similar products.

Introduction

Thanks for choosing Govee Glide Lively Wall Lights. This product is composed of 6 modular segments embedded with Govee's cutting-edge RGBIC technology for next-level personalized lighting for your entertainment center, desktop setup, living room, bedroom, and more.

What You Get

Item	Quantity
"A" Segments	2
"B" Segments	4
Control Box	1
Power Adapter	1
User Manual	1

At a Glance

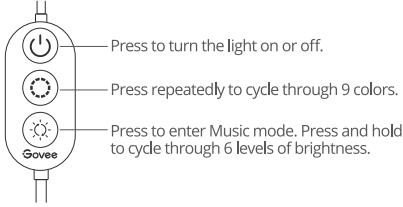
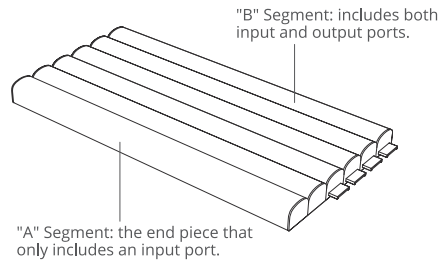

Installing Your Wall Light

Before You Install

- 1.Unpack the box and check that all items are present.
- 2.Assemble the segments together, plug them into power, and confirm all the segments light up properly.

Installation Steps

Note: The below steps are recommended for installing the light bars in a 3-3 configuration in order to get the best RGBIC lighting effects.

- 1.Wipe the planned installation location with a clean cloth to ensure the wall's surface is dry and free of debris.



- 2.Start with a "B" segment and insert the power clip into it first. Then remove the covering from its adhesive strips, and press the segment onto the wall for 5 seconds.

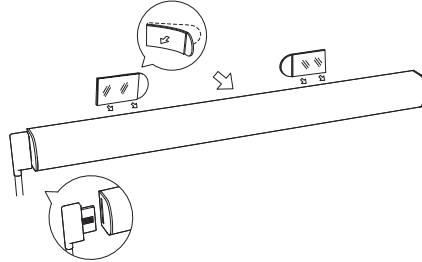

- 3.Take another "B" segment, connect it with the previous "B" segment that has been installed on the wall, and press it onto the wall for 5 seconds. Then connect "A" segment with the same method.

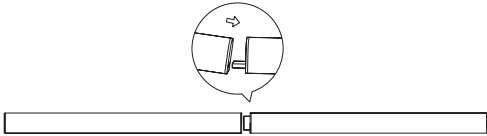

- 4.Use the same installation process above with the other two "B" segments and the "A" segment.

- 5.Plug in the power cable after installing all 6 segments.

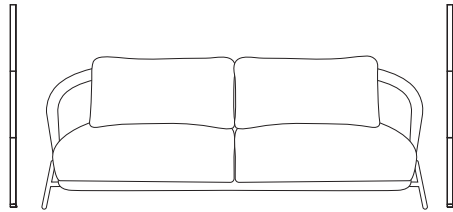

Pairing Your Device with Govee Home App

What You Need

- A Wi-Fi router that supports 2.4GHz and 802.11 b/g/n bands (5GHz is not supported).

Pairing Instructions

- 1.Download Govee Home App from App Store (IOS) or Google Play (Android).
- 2.Open the app, tap the "+" icon in the top right corner and search for "H610A."
- 3.Tap the device icon and follow the on-screen instructions to complete pairing.



Controlling the Device with Your Voice

- 1.Open the app, then tap the device icon to enter its homepage.
- 2.Tap the setting icon in the top right corner.
- 3.Select "User Guide" and follow on-screen instructions to set up controlling the device using your voice.

Specifications

Model	H610A
Power Supply	Adapter 24V
Lighting Color	RGBIC
Control Method	Control Box, Govee Home App, Voice Assistants

Troubleshooting

1. Cannot connect to Govee Home App.

- Check if the wall light is powered on.
- Check if your smartphone's Bluetooth is enabled, or try connecting with another smartphone.
- When connecting for the first time, ensure the smartphone is near the wall light.
- If the connection error still exists, please delete the connected wall light from "My Device" on the app.
- Reconnect to Govee Home App by following the instructions provided previously.

2. Wi-Fi disconnected or failed to connect.

- Check if the wall light is powered on.
- Do not skip connecting to Wi-Fi during pairing process.
- Ensure your Wi-Fi router is 2.4GHz capable (5GHz is not supported).
- Ensure you entered the correct Wi-Fi password during the Wi-Fi connection process.
- Try connecting the wall light with a smartphone hotspot to check if your home network is working properly.
- Shorten the distance between the wall light and the Wi-Fi router to less than 1m, then try reconnecting.

3. Cannot pair or connect with Alexa or Google Assistant.

- Ensure the stability of the Wi-Fi connection.
- Go to the app Settings page and follow the instructions under "User Guide" to pair the device again.

4. Only one user can control the device.

- Each device can only be controlled by one account.
- If multiple users wish to control the same device, ensure they are using the same account.

5. Some segments fail to light up.

- Check if the segments have been assembled properly.
- Try pressing the "Refresh" button in the app to make sure it identifies the correct number of assembled segments.



Customer Service

 Warranty: 12-Month Limited Warranty

 Support: Lifetime Technical Support

 Email: support@govee.com

 Official Website: www.govee.com

 @Govee  @govee_official  @govee.official

 @Goveeofficial  @Govee.smarthome

FCC and ISED Canada Statement

This device complies with Part 15 of the FCC Rules and Industry Canada licence-exempt RSS standard(s). Operation is subject to the following two conditions:

- (1) This device may not cause harmful interference, and
- (2) This device must accept any interference received, including interference that may cause undesired operation.

Warning: Changes or modifications not expressly approved by the party responsible for compliance could void the user's authority to operate the equipment.

Le présent appareil est conforme aux CNR d'Industrie Canada applicables aux appareils radio exempts de licence. L'exploitation est autorisée aux deux conditions suivantes :

- (1) l'appareil ne doit pas produire de brouillage, et
- (2) l'utilisateur de l'appareil doit accepter tout brouillage radioélectrique subi, même si le brouillage est susceptible d'en compromettre le fonctionnement.

NOTE: This equipment has been tested and found to comply with the limits for a Class B digital device, pursuant to Part 15 of the FCC Rules.

These limits are designed to provide reasonable protection against harmful interference in a residential installation. This equipment generates uses and can radiate radio frequency energy and, if not installed and used in accordance with the instructions, may cause harmful interference to radio communications. However, there is no guarantee that interference will not occur in a particular installation. If this equipment does cause harmful interference to radio or television reception, which can be determined by turning the equipment off and on, the user is encouraged to try to correct the interference by one or more of the following measures:

1. Reorient or relocate the receiving antenna.
2. Increase the separation between the equipment and receiver.
3. Connect the equipment into an outlet on a circuit different from that to which the receiver is connected.
4. Consult the dealer or an experienced radio/TV technician for help.

This Class B digital apparatus complies with Canadian ICES-005. Cet appareil numérique de la classe B est conforme à la norme NMB-005 du Canada.

FCC and IC Radiation Exposure Statement

This equipment complies with FCC and IC radiation exposure limits set forth for an uncontrolled environment. This equipment should be installed and operated with minimum distance 20cm between the radiator & your body.

la distance entre l'utilisation et l'appareil ne doit pas être inférieure à 20 cm.

This device uses a non-replaceable light source. When the light source reaches the end of its life cycle, this device should be replaced. Not intended for illumination. Only used for creating ambiance.

1. Do not connect the rope light to the supply while it is in the packing or wound onto a reel;
2. Do not use the rope light when covered or recessed into a surface;
3. Do not open or cut the rope light;

The Bluetooth® word mark and logos are registered trademarks owned by Bluetooth SIG, Inc. and any use of such marks by Shenzhen Intellirocks Tech. Co., Ltd. is under license.

Responsible party :

Name: GOVEE MOMENTS(US) TRADING LIMITED
Address: 13013 WESTERN AVE STE 5 BLUE ISLAND IL 60406-2448
Email: support@govee.com
Contact information: <https://www.govee.com/support>

Govee is a trademark of Shenzhen Intellirocks Tech Co.,Ltd.
Copyright ©2021 Shenzhen Intellirocks Tech Co.,Ltd. All Rights Reserved.



FOR INDOOR USE ONLY
POUR UNE UTILISATION EN INTÉRIEUR UNIQUEMENT



User Manual



Model: H610A

Govee Glide Lively Wall Lights



Govee Home App

For FAQs and more information,
please visit: www.govee.com

H610A说明书

版本:1.0

料号:807-0003-00261

折叠尺寸:75×105(mm)

展开尺寸:375×105(mm)

材质:80G书页纸

工艺:四色印刷

折叠方式:风琴页

页数: 页