Antenna specifications

Electrical Characteristics Description

Model:	Rome BLE antenna		
Transmitter Frequency:	2400MHz-2483.5MHz		
Receiver Frequency:	2400MHz-2483.5MHz		
Antenna information:	Antenna Name	Model(s)/Type(s)	
	RF Antenna Assembly	Model/Part Number:	Rome BLE
		Manufacturer:	Anhui Huami Information Technology Co., Ltd.
		Frequency Range:	2400MHz-2483.5MHz
		Connector Type/ Maximum Gain	-6.11dBi
		Antenna Type/ Pattern:	metal antenna
		Antenna Size	框: C=152mm
		Measurement:	See below

Dimensions

Dimensions See Fig.1 .

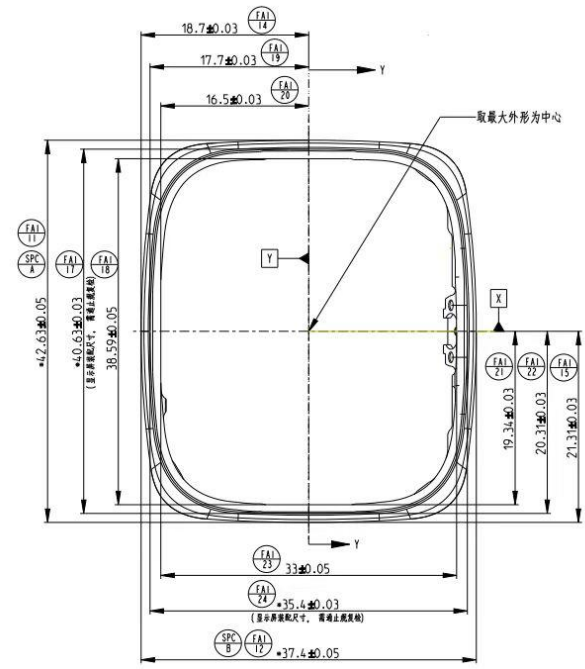
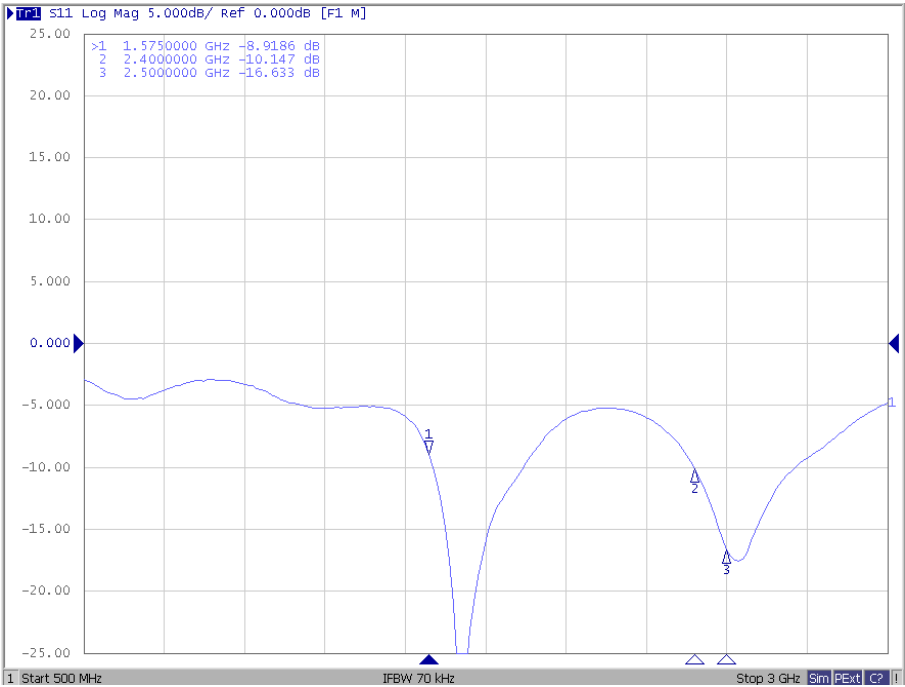

Fig. 1 Antenna Dimensions (示例)

Electrical Performance



S11 parameter test result as Fig.2.

Table 1 shows the emission efficiency and the maximum gain of the antenna at different frequencies changes. The antenna radiation pattern diagram show in Fig.3.

频率/MHz	效率/dB	增益/dBi	效率/%
2400	-9.02	-6.93	12.52
2410	-8.92	-6.87	12.81
2420	-8.83	-6.67	13.1
2430	-8.76	-6.57	13.3
2440	-8.71	-6.48	13.47
2450	-8.72	-6.41	13.41
2460	-8.71	-6.41	13.47
2470	-8.65	-6.29	13.65
2480	-8.52	-6.11	14.05
2490	-8.66	-6.27	13.6
2500	-8.7	-6.25	13.5

Table 1Max. Gain and Efficiency Vs. Frequency(Free space)

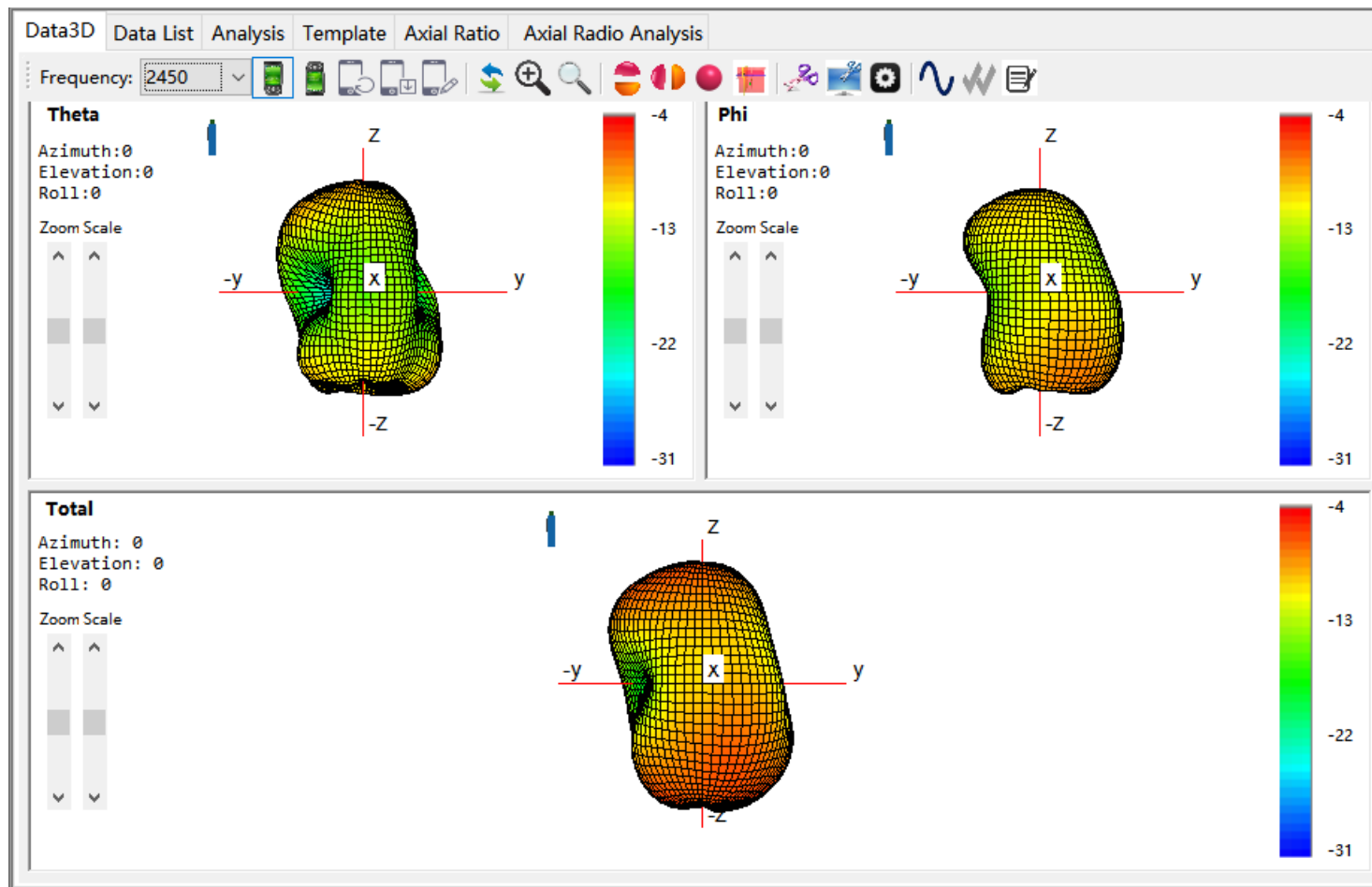

Fig. 3 antenna radiation pattern diagram