

CONTENTS AND BATTERY INSTALLATION

Contents

- RC Porsche Taycan
- Remote Control
- USB Magnetic Charging Station

Battery Installation

The remote requires 2 AAA 1.5V batteries (not included).

Charging your Porsche - Plug the USB side of the charging station into a USB port and then the other end into the front of the Taycan. The rear light will power on while charging and turn off when the vehicle is fully charged.

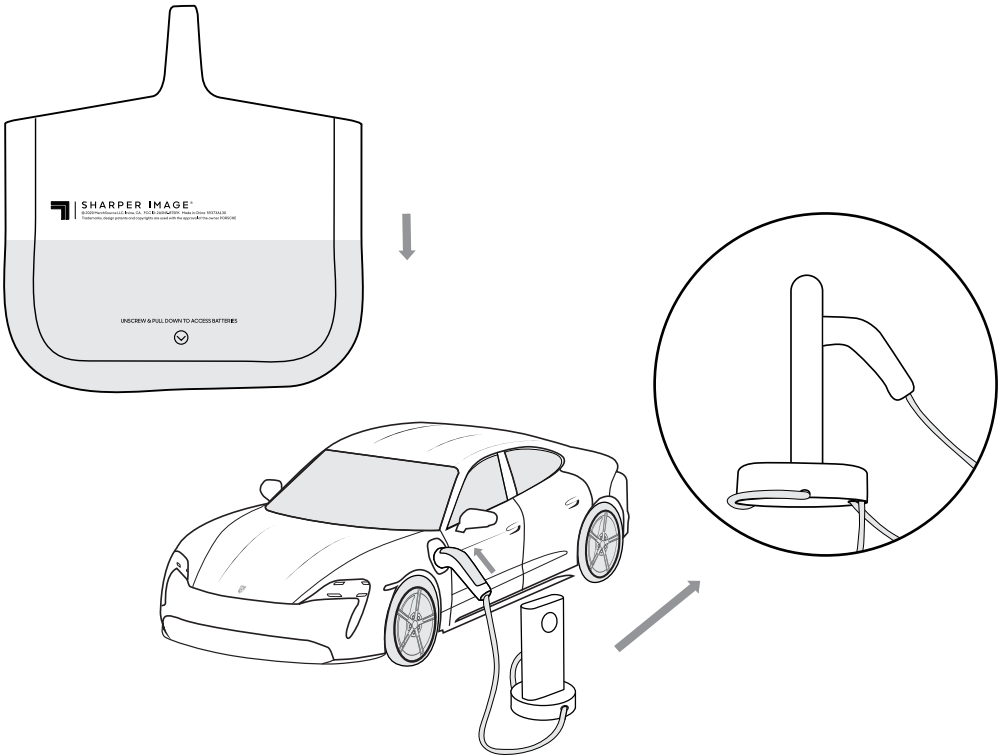

START UP

1. Slide the switch at the bottom of the vehicle to the on position.
2. Power the remote by turning the knob counterclockwise.
3. The remote pair light will pulse. Wait until the light turns solid, indicating the remote has successfully paired with the vehicle.
4. Place the vehicle on a hard, flat surface.

CONTROLS

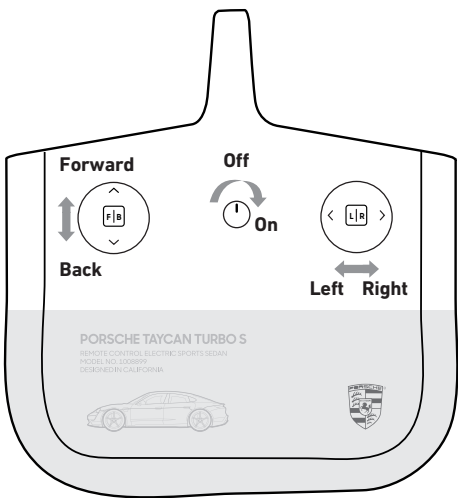

BATTERY WARNING:

- Do not mix old and new batteries.
- Do not mix alkaline, standard (carbon-zinc), or rechargeable batteries.
- Alkaline batteries are recommended. Use only the specified voltage.
- Insert batteries using the correct polarity. Always use, replace, and recharge (if applicable) batteries under adult supervision.
- Do not short-circuit the battery supply terminals.
- Do not dispose of batteries in fire, batteries may explode or leak.
- Remove batteries before storing.
- Recycle or dispose of batteries according to federal, state, and local laws.
- Keep these instructions for future reference.

SAFETY WARNINGS

- Adult supervision required.
- Do not use people or animals as obstacles.
- Never operate your vehicle in inclement weather, rain, or standing water.
- Keep fingers, hair, and loose clothing away from wheels while vehicle is in motion.
- Do not expose to extreme temperatures.
- Do not leave vehicle or transmitter near sources of heat or under direct sunlight for long periods of time.
- Adult supervision is recommended when operating the vehicle.
- Thoroughly inspect products before every use. If the product appears worn, frayed/splintered, cracked, or broken in any manner, discontinue use and discard immediately.

NOTE: This equipment has been tested and found to comply with the limits for a Class B digital device, pursuant to Part 15 of the FCC Rules. These limits are designed to provide reasonable protection against harmful interference in a residential installation. This equipment generates, uses and can radiate radio frequency energy and, if not installed and used in accordance with the instructions, may cause harmful interference to radio communications.

However, there is no guarantee that interference will not occur in a particular installation. If this equipment does cause harmful interference to radio or television reception, which can be determined by turning the equipment off and on, the user is encouraged to try to correct the interference by one or more of the following measures:

- Reorient or relocate the receiving antenna.
- Increase the separation between the equipment and receiver.
- Connect the equipment into an outlet on a circuit different from that to which the receiver is connected.
- Consult the dealer or an experienced radio/TV technician for help.

Warning: Changes or modifications to this unit not expressly approved by the party responsible for compliance could void the user's authority to operate the equipment.

This device complies with Part 15 of the FCC Rules. Operation is subject to the following two conditions: (1) this device may not cause harmful interference, and (2) this device must accept any interference received, including interference that may cause undesired operation.

⚠ WARNING:
CHOKING HAZARD - Small Parts. Not For Children Under 3 Years.

© 2021 MerchSource, LLC. Irvine, CA 92618. All rights reserved.

KEEP THIS INSTRUCTION MANUAL AS IT CONTAINS IMPORTANT INFORMATION FOR FUTURE REFERENCE
Due to continuous product improvements, the picture on the manual may differ slightly from the actual product.

FOR TECHNICAL SUPPORT, PLEASE CALL
1-800-374-2744