

K7 Series Smart Lock

Main Parts and Diagram

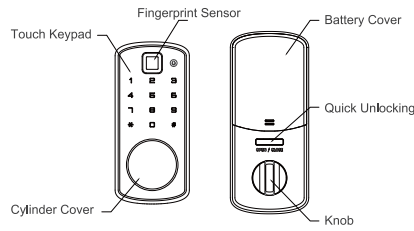

Thanks for choosing our K7 smart lock.
Please check the user manual carefully before operation and installation.
If you disassemble, update or repair the lock by yourself rather than under our instructions, all losses would be borne on your sides.

Packing

NO	Model Type	Quantity	Note
1	Front Plate	1	
2	Back Plate	1	
3	Mortise lock	1	
4	Battery cover	1	
5	Accessories	1	
6	Battery	2	2pcs / group

Installation

Installation Diagram

1. Prepare one cross point screwdriver before installation

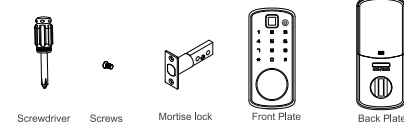

2. Slide the battery cover and unscrew the 3pcs screws, then take off the back plate and pad. Finally, adjust the direction switch part to right position based on the door's direction. (Right to R, Left to L)

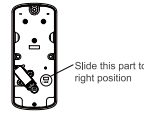
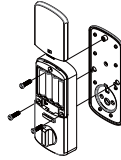

3. Please confirm whether to adjust the mortise lock based on the distance from the center hole to door frame

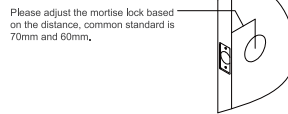

The default backset of the mortise lock is 60mm. If need to change, please follow the below instruction:

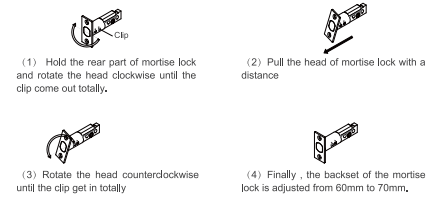

4. When you install the mortise lock, please keep the latch retracted for left to outside or right to inside direction. For the right to outside or left to inside direction please adjust the latch to release with screwdriver.

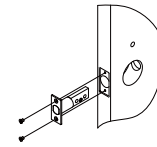

5. Install the front plate and back plate as the diagram, the cylinder trail of the front plate need be horizontal.

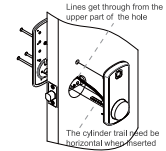

This diagram is with right to outside direction while the latch is released

6. Combine the lines to the plug on the back plate, then install the back plate on the back pad. Please fasten the extra lines to the back pad rather than stuff the lines to the holes.

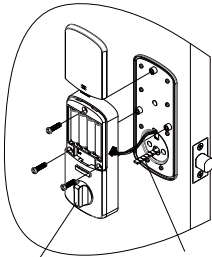

Please keep the knob vertical as the diagram show when install

Adjust the length of the cylinder trail based on door thickness. If too long, cut it with tongs

7. After installation, please test it with battery

Test: When insert the battery, please touch the screen to activate. If do not work, please check:
1. Battery condition
(A: Poor battery B: "+" "-" are inserted correctly C: The battery is too loose or with deviation.)
2. Lines condition
(A: The line is not inserted rightly B: The plugs are damaged)

Emergency Power and System Resetting

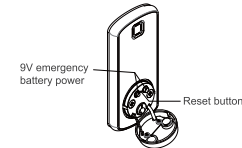

(1) If the battery is dead, you can disassemble the cylinder cover and charge it by one 9V emergency battery
(2) If the system crashed, you can insert one pin to the reset button to reset the system
(3) If the electronic parts do not work, you can open the door by the mechanical key.

Restore Factory Mode Setting

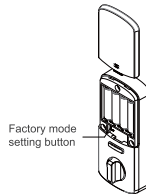

If you forget the admin password, you can remove the battery cover and insert one pin to the factory mode setting button. Keep pressing it for 3s until one "DING" sound, the system would be reset and all data would be cleared.

Unlocking Diagram

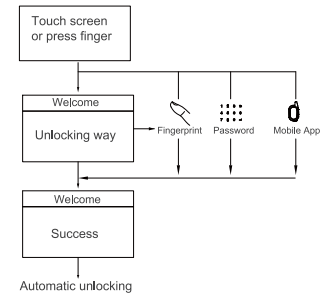

Keyboard Function

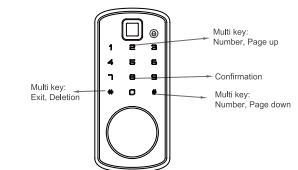

Fingerprint Gathering Way

Right Fingerprint Registration

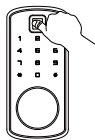

Please register with the fingerprint center part

Wrong Operation

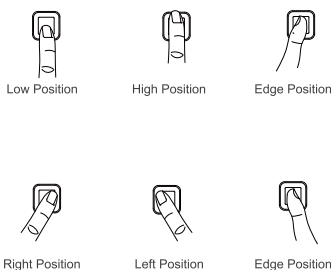

Locking and Unlocking Way

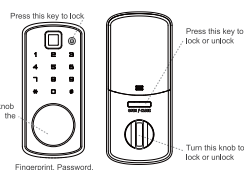
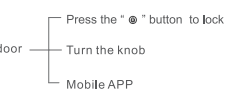
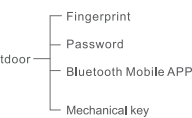
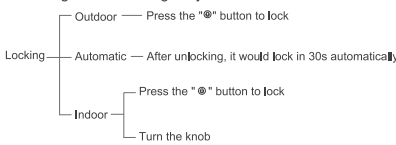

User Manual

Icon Detail:

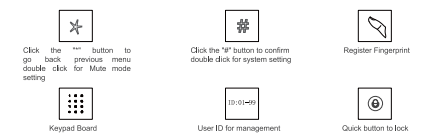

Demo Mode

After installation, the system is at demo mode, any fingerprint or password can open the door. You can try the system under the voice prompt

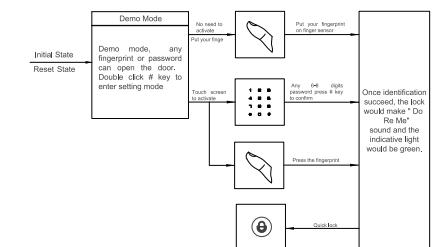

Setting Mode

(Double click the # key to enter the setting mode, you can add or delete the users after registering the first administrator)

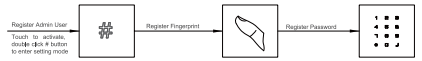

Voice Prompt:

Demo mode, any fingerprint or password can open the door. Double click the pound key to enter setting mode.

Please input administrator fingerprint, input your finger, or Press the pound key to skip fingerprint registration. Please move finger, input again, Please move finger, input again, Fingerprint registration succeed.

Please input 6-8 digits password and press # to confirm, Or press the pound key to skip password registration. Please input the same password again and press # to confirm.

Note:

1. The first password you registered is the administrator password while the ID number is 00.
2. When you register the administrator user, please make sure to set password, if the fingerprint is registered successfully, you can skip the password registration. If the administration registration failed, it would exit the system setting menu and back the demo mode.
3. Please keep the admin password, you need to reset the lock if forget it.
- (1). After identifying and entering the add user mode, press 00+# to change administrator information, After updating, the old fingerprint and password would expire.
- (2). Press the reset button on back plate to clear all data.

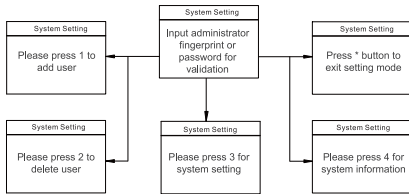

Add user:

(Double click the # key to enter the setting mode, press 1 to add user after validating the administrator.)

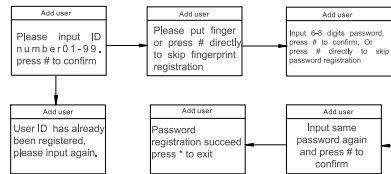

Note:

1. Make sure to set the password and fingerprint for the first administrator, the password is with 6-8 digits.
2. The registration way is same for the administrator and common user.
3. Only one administrator user: ID 00, common user ID: 01-99.
4. During registration, you can press # to skip. After that, you can input same user ID to add password or fingerprint.
5. During registration, no need to input user ID number while the system would choose the smallest available user ID number.

Delete User

(Double click the # key to enter the setting mode, press 2 to delete user after validating the administrator)



Note: The deletion for administrator and normal user are same.

System Setting

(Double click the # key to enter the setting mode, press 3 for system setting after validating the administrator)

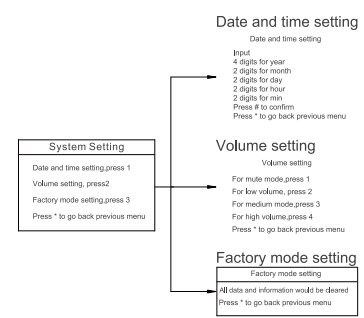

System information

(Double click the # key to enter the setting mode, press 4 for system setting after validating the administrator)

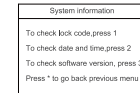

Main Function

User ID grading management

1. Administrator(ID: 00) It not only can open door, but also manage lock internal data information. When in special case, the administrator user owned the supreme authority. We recommended only the households and leadership to use this level function.
2. Common user(ID:01-99) It can only execute open door operation. It can't check or modify lock dates. We recommend the children or company staff to use this level function.

Multi Key

1. When you operate the lock, * key is to exit and delete while # is to confirm
2. When you operate the lock, * key is for quick locking.

Locked inside

When the lock is locked inside, only administrator can open it.

System reset function

When in electronic system crashes or abnormal condition, press reset button to restart system.

Anti peep password

The user can input any number before or after the correct password (total less than 18 digits) to open door.

Emergency battery power

If the battery is dead, you can charge it by one 9V emergency battery power to unlock.

Low voltage alarm

When the voltage is lower than 4.3V, there has alarm to prompt to change battery.

System protection

If you input wrong password or fingerprint more than 5 times in 1min, the system would be in sleep mode and freeze for 3mins.

Clear Function

If you forget the administrator password and fingerprint, you can insert one needle to the clear hole to clear all data and information.

Attention

1. Operating the lock requires special environment. Please use it in specified field technology ranges. The long time overload and exceed usage will reduce the life length. Please keep your finger clear and prevent this product from long time in sunshine when use it.

2. After a period of time, there will has dirt on the fingerprint reader and may affect normal use. Please use soft cotton to clear the fingerprint reader. The fingerprint head and screen are the fragile glass materials, please do not hit or touch by hard object.

3. If the lock voltage is insufficient when open door, the door will prompt with alarm sound and screen showed low voltage, please change the battery. Please do not use with mixed old and new battery. If you do not change the battery on time, the system will out of power and stop running. At this time, you can buy a 9V battery from market for emergency power supply. After open door, please change to AA battery in time.

4. The lock handle is the necessary auxiliary tool to open door. Please do not hang any heavy object on the handle.

5. Please choose professional worker to install the door lock and follow with our installation standard. Please do not disassemble this lock personally and take care of relevant label to avoid unnecessary trouble for warranty.

6. Please register administrator fingerprint and keep the mechanical keys after lock is installed well. When the fingerprint and password and other methods can't open door, you can open door by mechanical key.

FCC ID: 2AW72SMARTLOCK20207

This device complies with Part 15 of the FCC Rules. Operation is subject to the following two conditions: (1) this device may not cause harmful interference, and (2) this device must accept any interference received, including interference that may cause undesired operation.

FCC WARNING

Warning: Changes or modifications to this unit not expressly approved by the party responsible for compliance could void the user's authority to operate the equipment.

FCC STATEMENT

NOTE: This equipment has been tested and found to comply with the limits for a Class B digital device, pursuant to Part 15 of the FCC Rules. These limits are designed to provide reasonable protection against harmful interference in a residential installation. This equipment generates uses and can radiate radio frequency energy and, if not installed and used in accordance with the instructions, may cause harmful interference to radio communications.

However, there is no guarantee that interference will not occur in a particular installation. If this equipment does cause harmful interference to radio or television reception, which can be determined by turning the equipment off and on, the user is encouraged to try to correct the interference by one or more of the following measures:

- ☐ Reorient or relocate the receiving antenna.
- ☐ Increase the separation between the equipment and receiver.
- ☐ Connect the equipment into an outlet on a circuit different from that to which the receiver is connected.
- ☐ Consult the dealer or an experienced radio/TV technician for help.