

## WITH LOVE FROM

We have lots of different ways to show we care.

### Product updates How-to tips FAQs & more

Go to [JLab.com](#) or [JLab.com](#) to unlock your customer benefits including a free gift.

Gift for US only. No APO/FPO/DPO addresses.

We're obsessed with creating the best possible experience around owning our products. If you have any questions, concerns, or feedback, we're here for you. Contact a real human on our U.S.-based customer support team:  
**Website:** [jlab.com/contact](#)  
**Email:** [support@jlab.com](mailto:support@jlab.com)  
**Phone U.S.:** +1 (405) 445-7219  
**Phone U.K./EU:** +44 (20) 8142 9361 (Check hours [jlab.com/hours](#))  
Visit [jlab.com](#) to initiate a return or exchange.  
For international, visit [jlab.com](#) to initiate a return or exchange.

Our team is constantly improving your product experience. This model may have new features or controls which are not detailed in this guide.



For the latest version of the manual, scan the QR code.

FCID: 2AHYV-EOPSP  
IC: 21316-EOPSP

Distributed in U.K. by:  
JLab Ltd  
21 Headlands Business Park, Ringwood,  
Hampshire BH24 3PB United Kingdom

EU Importer:  
JLab  
5007 Lardis Ct,  
Carlsbad, CA 92008, USA



## THE LAB

The Lab is where you'll find real people, developing really great products, in a real place called San Diego.

## DONE BETTER



Designed for You



Lab Quality Sound



Surprisingly Awesome Value

tech

Tech all about you

## MULTIPOINT

- 1 Once **FIRST** device is connected, turn off Bluetooth in device settings. Earbuds will auto enter Bluetooth Pairing.

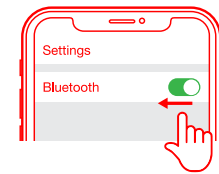

- 2 Enter your **SECOND** device Bluetooth settings and connect.



- 3 Enter your **FIRST** device Bluetooth settings. Turn on Bluetooth and connect to Epic Open Sport.

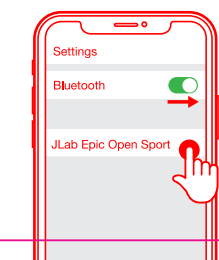

## THE RIGHT SOUND FOR EVERY MOMENT

### EQUALIZER MODES

**"JLab SIGNATURE"**  
JLab C3™ signature sound with amplified vocals and bass

**"BALANCED"**  
Even sound with no additional sound enhancements

**"CUSTOM"**  
Personalize your EQ through the JLab App.

### FIND YOUR FIT

Try all ear tips for best fit and proper seal.

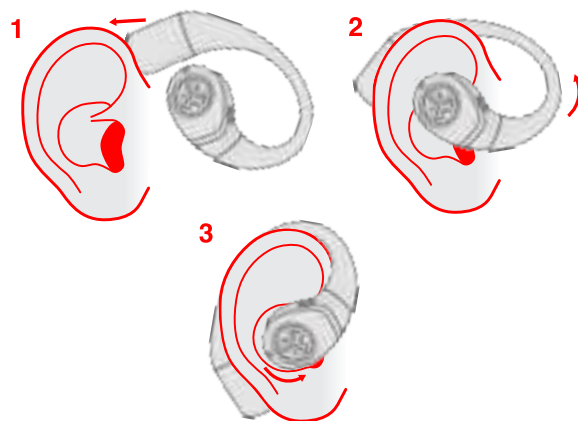

OPEN  
AIR CONDUCTION WIRELESS EARBUDS

## QUICK START GUIDE

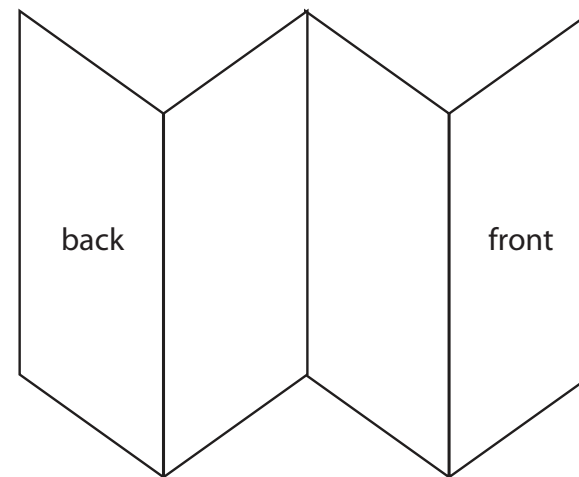

## PAIR UP

- 1 Remove pull tab and close case door.

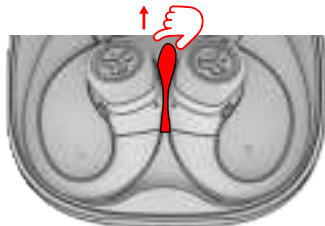

- 2 Blue light on case indicates charge. Remove earbuds.



- 3 One earbud blinks blue/white = Ready to Pair. Connect to JLab Epic Open Sport in your device settings.



## GO AHEAD, PRESS THE BUTTON

1x ● 2x ●● 3x ●●● Press Hold ●●●

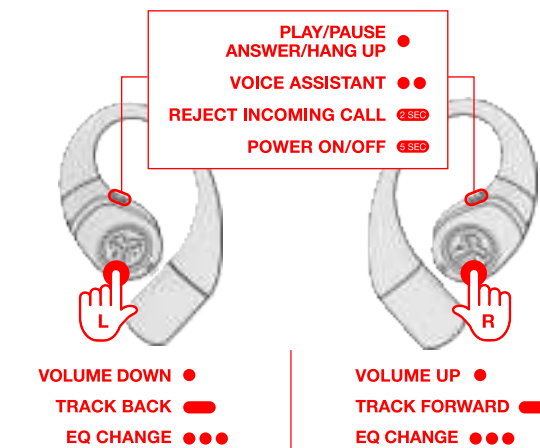

## DOWNLOAD THE APP

Customize Epic Open Sport features and update the latest software. Download the **JLab App** in Apple/Google Play Store.



## GET CHARGED (EARBUDS)

Earbuds auto power off and start charging when placed in case. Earbuds will auto-connect when removed.

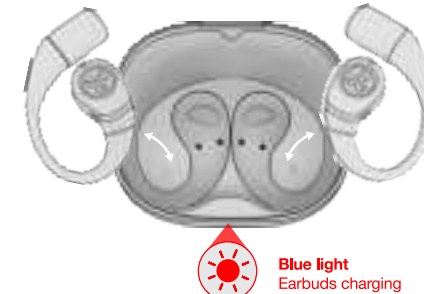

## GET CHARGED (CASE)

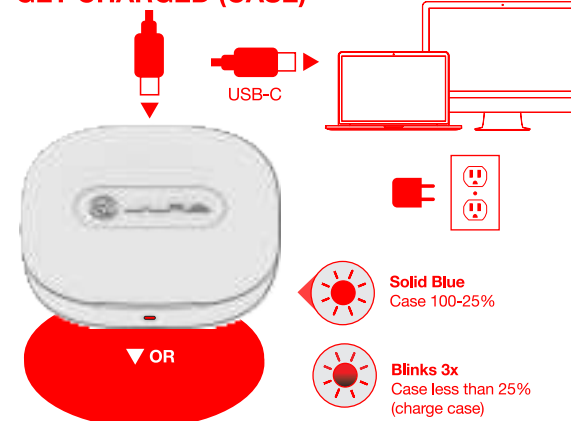

Date: 01.13.25

PROJECT: Epic Open Sport QSG

STOCK: 157g, MATTE

INK: 4/4 CMYK/CMYK

FLAT SIZE: 340mm x 120mm

FOLDED SIZE: 85mm x 120mm