

Inrico®

SINCE 2004

POC RADIO
IN TOUCH TIMELY EVERYWHERE



S200

Instructions



Please read this instruction book carefully before use and keep this with care

Notes before using :

- Do not use the walkie talkie in an explosive environment (such as gas, dust, steam, etc.) or to charge the battery.
- Please turn off the walkie-talkie while refueling or parking at the gas station.
- Do not adapt or modify the machine whether there is any reason.
- Do not let the walkie talkie by prolonged direct sunlight, do not place it near a heating appliance too.
- Do not put the walkie talkie at the extremely dusty, damp and splashing place and do not place it on an unstable surface.
- The repair of the walkie talkie only can be carried out by professional technicians, do not disassemble by yourself.



Note :

Please read above content carefully. It is very important for walkie talkie users to gain general knowledge and understanding of risk about the use of walkie talkie.

Accessory Installation

1 To insert a SIM card

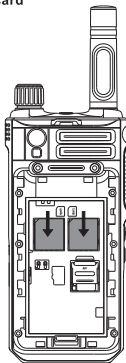

2 To insert a SD card

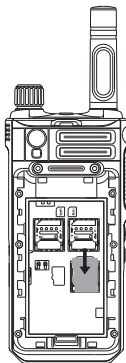

3 To install the battery

- (a) Insert the battery to connect with the metal at the bottom of the tank;
- (b) Press down on the other end of the battery.
- (c) Push the battery lock catch.

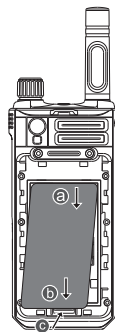

4 Close the battery cover:

- (a) Push the battery cover until it clicks into place;
- (b) Push the battery cover down;

Open the battery cover: Pull up battery cover.



5 Install the belt clip

- (a) The belt clip should be aligned with the back screw hole.
- (b) Install the belt clip by rotating screw.

Uninstall the belt clip

Uninstall the belt clip by rotating screw until loose.

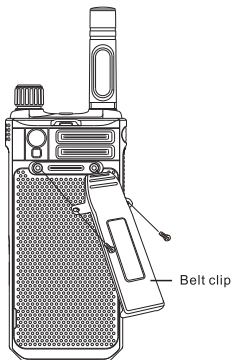

6 Install Lanyard

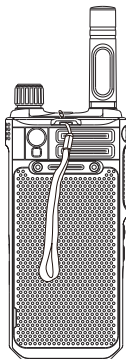

7 Installing headset

Open the cover from the top of device to show the headset sockets. Headset will work immediately after being plugged in.

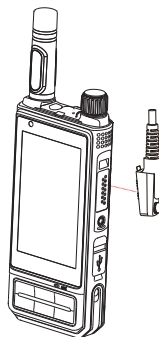

8 Attach/Remove the Antenna

Screw the antenna in to the connector on the top of radio by holding the antenna at its base and turn the antenna clockwise to fasten it.

Turn the antenna counter-clockwise until you can remove it.

(Note: The antenna is neither a handle, a key ring retainer, nor a speaker/ microphone attachment point. Using the antenna in these ways may damage the antenna and degrade your transceiver's performance.)

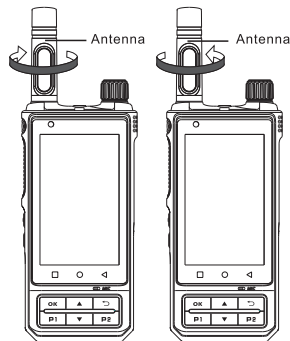

Radio Overview

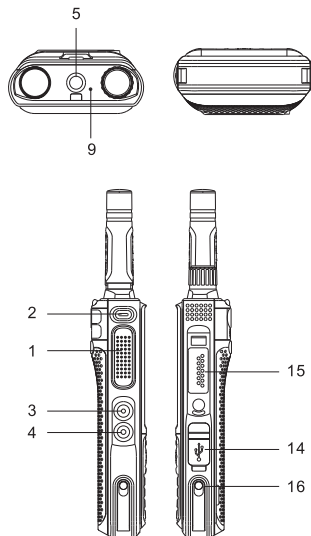
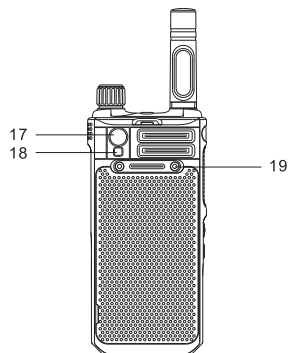
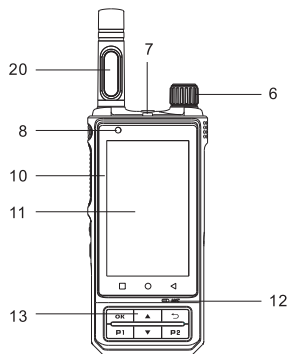

1	PTT	11	Screen
2	Programmable key F1	12	Main MIC
3	Programmable key F2	13	Main button
4	Programmable key F3	14	USB Port
5	SOS	15	M6 Port
6	Power / Volume knob	16	Desktop Charger Port
7	Indicator	17	Rear camera
8	Front camera	18	Flash lamp
9	Auxiliary MIC	19	Back clamp screw
10	Touch Screen	20	Antenna

Functions Sheet

No.	Name	Functions
1	PTT	PTT
2	Programmable key F1	Short press: Short press to turn on / off the mute mode. Long press: long press for 3s to turn the flashlight on / off.
3	Programmable key F2	Short press: voice playback Long press: single calling mode
4	Programmable key F3	Short press: broadcast current group.
5	SOS	Long press SOS key for 3 seconds to SOS alarm. Press PTT key to cancel alarm.
6	Volume / Power knob	Turn the knob clockwise to start up the device or turn up the volume. Turn the knob anti-clockwise to shut off the device or turn down the volume.

Keyboard Definition

No.	Definition
P1	Custom key--Shortcut key (Enter the groups list interface)
P2	Custom key--Shortcut key (Short press P2 key to shut / brighten the screen.)
▲	Scroll-up key
OK	Custom key -- Press "OK" to confirm
▼	Scroll-down key
↶	Custom key -- Mainly the Back key
◀	Virtual key on TP -- Back key
○	Virtual key on TP -- Home key
□	Virtual key on TP -- Menu key

Basic Function

• Power on

Turn the knob clockwise till the knob makes a popping sound, then wait till the boot program starts up.

• Power off

Turn the knob anti-clockwise till the knob makes a popping sound, then it will go off.

Red indicator will be on if it is under battery charging.

• User Log-in

Once user successfully logs in, there will be voice prompts on current user information. (User name, User number, connection mode, SIM card status)

• Calling

Press key (1), that is, PTT key, to start talking. After the communication is established, the device is in the calling state, and the Led light is always red; if the device is in the answering state, the Led light is always green.

If the current voice channel is occupied, that is, the user you're calling is talking, PTT key is invalid.

Each maximum talking time is within 60 seconds. Once it's more than 60 seconds, speaking right will be automatically released. (1-60 seconds can be set via APP.)

• Audio playback

Short press key (3), that is, Programmable key F2, to play back the latest ten audio records in a continuous loop. Press PTT key to automatically play back to the last audio record.

• Current Group

Short press key (4), that is, programmable key F3, to broadcast user name and current group. If it's in the talking stage, it will not broadcast.

System Parameter

Operating system	Android	
Receive sensitivity	~106dBm	
Support	GSM,WCDMA,LTE,GPS	
Working temperature	~10℃~+50℃	
Storage temperature	~40℃~+85℃	
Voltage	3.8V	
Frequency	EU	LTE-FDD: B1/ B3/ B7/ B20/ B28a/ B28b LTE-TDD: B38/ B39/ B40/ B41 WCDMA: B1/ B2/ B5/ B8 GSM: B2/ B3/ B5/ B8
	US	LTE-FDD: B2/ B4/ B5/ B12/ B13/ B17 WCDMA: B1/ B2/ B5/ B8 GSM: B2/ B3/ B5/ B8
Sound output power		

Specification

Size	62*30*142.5mm (W*D*H)
Weight	~210g

Indicator light interpretation

Device Status	LED indicators	
	Color	Frequency
PTT successful	Red	On
Answer call	Green	On
Low battery (<15%)	Red	Flash every 3 secs
Standing by	Green	Flash every 5 secs
Charging	Red	On
Fully charged	Green	On

Security information

Before using the device operation, please read and observe the following precautions to ensure optimum device performance, and avoid dangerous or illegal situations.

● Electronic equipment

The place of civilization provisions that has prohibited the use of wireless devices, don't use the device, otherwise it will lead to interference from other electronic devices or other hazards.

● Area with easy firing and explosion

Refueling point (service station) or near inflammable and explosive materials, flammable and explosive chemical agents in any area, and don't use the device, the device may cause an explosion or fire.

● Operating environment

Don't use the device in dusty, wet, dirty, or near magnetic fields, so as to avoid internal circuit equipment failure.

Don't use this device in a thunderstorm, thunderstorms could result in equipment malfunction or shock hazard.

Don't place in direct sunlight for too long time.

Please avoid equipment and accessories to rain or moisture, otherwise it may be caused a fire or electric shock.

Don't place the device near a heat source or exposed flame sources, such as electric heaters, microwave, oven, water heater, fire, candles or other places may high temperatures.

● Accessories requirement

Don't use unapproved or incompatible power supply, battery charger, otherwise, it may result in a fire, explosion or other hazard.

Only use manufacturer-approved equipment and equipment accessories for this model, if you use other types of accessories, it will be lead to accidental damage to the equipment, breach of warranty of the equipment.

● The charger security

When fully charged or not charged, please disconnect the charger from the device and unplug the charger from the power outlet.

Don't drop or bump the charger, if the charger is damaged, don't continue to use, to avoid accidents.

Don't touch the device and charger with wet hands to avoid short-circuiting device, malfunction or electric shock.

● Battery Safe

Don't use the metal objects with two poles of the battery to docking, or contact with the endpoint of the battery, to avoid the battery short circuit,

as well as damage caused by battery overheating.

Don't expose the battery to high temperature or fever around the device, and battery overheating may cause an explosion.

Don't disassemble or modify the battery, insert foreign objects or liquid intrusion, in order to avoid battery leakage, overheating, causing a fire or explosion.

If a battery leaks, don't contact with skin or eyes. If contact, immediately rinse with water and go to hospital for medical treatment.

If the battery is in the process of using, charging or saving, which have discoloration, deformation, abnormal heating phenomenon, please stop using and replace with new battery.

Don't throw batteries in a fire, otherwise it will cause fire and explosion.

Don't let children touch the battery, to avoid accidents.

Don't use a damaged battery.

When the standby time of the device is significantly shorter than normal, please replace the battery.

Dispose of batteries according to local regulations, not dispose as household waste.

Care and Cleaning

- Do not lift up antenna or an external microphone directly.
- Please use lint-free cloth to remove dust and stains from a radio to avoid poor contact.
- Please place the cover on headphone jacks when not in use.
- The keypad and sensors should be cleaned carefully with a lint-free cloth moistened with clean water and a mild washing liquid. Do not use strong corrosive solvents for cleaning.

warning

Any Changes or modifications not expressly approved by the party responsible for compliance could void the user's authority to operate the equipment.

This device complies with part 15 of the FCC Rules.

Operation is subject to the following two conditions:

(1) This device may not cause harmful interference, and (2) this device must accept any interference received, including interference that may cause undesired operation.

Note: This equipment has been tested and found to comply with the limits for a Class B digital device, pursuant to part 15 of the FCC Rules. These limits are designed to provide reasonable protection against harmful interference in a residential installation. This equipment generates, uses and can radiate radio frequency energy and, if not installed and used in accordance with the instructions, may cause harmful interference to radio communications. However, there is no guarantee that interference will not occur in a particular installation. If this equipment does cause harmful interference to radio or television reception, which can be determined by turning the equipment off and on, the user is encouraged to try to correct the interference by one or more of the following measures:

- Reorient or relocate the receiving antenna.
- Increase the separation between the equipment and receiver.

- Connect the equipment into an outlet on a circuit different from that to which the receiver is connected.

- Consult the dealer or an experienced radio/TV technician for help.

SAR tests are conducted using standard operating positions accepted by the FCC with the device transmitting at its highest certified power level in all tested frequency bands, although the SAR is determined at the highest certified power level, the actual SAR level of the device while operating can be well below the maximum value.

Before a new model device is available for sale to the public, it must be tested and certified to the FCC that it does not exceed the exposure limit established by the FCC. Tests for each device are performed in positions and locations (worn on the body) as required by the FCC.

For face-up, 10mm was used for test, this equipment should be installed and operated with minimum distance 10mm.

For body worn operation, this model phone has been tested and meets the FCC RF exposure guidelines when used with an accessory designated for this product or when used with an accessory that contains no metal and that positions the handset a minimum of 0 cm from the body.

Non-compliance with the above restrictions may result in violation of RF exposure guidelines.