

Bluetooth headphones Quick Start Guide

ブルートゥース ヘッドホン 取扱説明書

What's in Box / 内訳

S

M

L

Eartips (3 pairs)
イヤークピース (3 ペア)



Micro USB cable
マイクロUSBケーブル

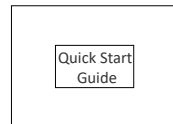

Quick Start Guide
取扱説明書

Buttons / ボタン

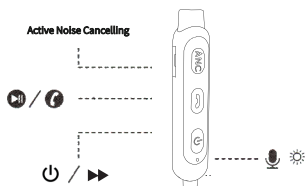

Bluetooth / ブルートゥース

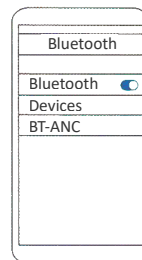

1. A LED indicator flashing for pairing when Earphone turned on.
イヤホンをオンにする際にLEDライトを点滅させます。
2. Turn on the Bluetooth on your device.
デバイスのブルートゥースをオンにします。
3. Search and choose "BT-ANC" to pair.
画面にて表示されるブルートゥース名称を選択してください。

① When turned on, BT-ANC will automatically connect to the last connected device if available. If not, BT-ANC will enter pairing mode.
接続させる際に、曾てイヤホンを一度接続した事があるデバイスには自動的に繋がります。

① To pair a different device, first disable Bluetooth on the connected device then repeat the pairing steps.
異なるデバイスに接続させたい場合は、前回にデバイスのブルートゥースがオフになっているかを確認してから接続設定してください。

① Having connection problems?
接続設定において、トラブルが発生した場合はどうしますか？
Remove BT-ANC from your device's Bluetooth records or restart your BT-ANC, ensure it's less than 3 feet away, then try pairing again.
お使いになるデバイスのブルートゥースの接続履歴を削除し、ブルートゥースを再度オンにして、3 フィート (約 1 m) 範囲内にて接続を再設定させます。

① What's if the phonecall or music lagging or connection breaks?

- 電話や音楽の接続が遅れたり、途中で停止したりすると、どうしますか？
- 1) The earphones out of battery.
電源を切ります。
 - 2) The connection distance over 10m between phone and earphone.
接続範囲を大幅に超えさせます。
 - 3) There is obstacle between phone and speaker to block the signal, e.g. wall.
電話とイヤホンの間に障害物があり、信号をなくさせます。

① Why the voice is not clear when speaking through the mic?

なぜマイクからの通話音声がかたくなのか？

- 1) Too long distance between your mouth and the earphone mic to talk.
Suggest wear the earphone properly then talk through mic.
通話際に、マイクとの距離を離れすぎないようにしてください。
- 2) Jam in the mic of earphone, carefully clean it with a cotton swab damp.
綿棒でイヤホンのマイクを拭いてください。

Pairing / ペアリング モード		Blue, red light blinks alternatively 青色と赤色のLEDライトを交互に点滅します
Connected / 接続完了		Blue light blinks 青いLEDライトが点滅しています

④ Wearing Earphone / イヤホンをつける

① Wearing long time earphone may caused a swelling pain on auricle and ear canal?

The earphone includes three sizes of eartips and earhooks with S, M, L size. Adjust each earhook until it fits flush in your auricle and the eartip seals in the ear canal. 付属品のイヤーフックとイヤークピースが3種のサイズ(S, M, L)があり、耳に適合なサイズを選んでください。

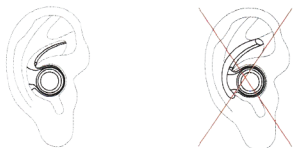

① The sound quality will be better by making the earbuds fit inside ears.

音質を向上させるためには、イヤホンを目に合うサイズをピッタリした方がいい。

⑤ Charging / 充電

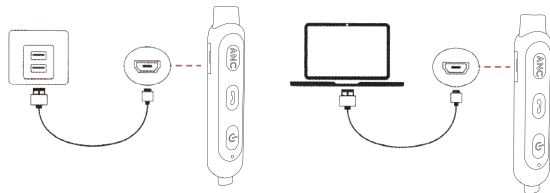

Charging / 充電	● Red light keeps on 赤色ライトが付きます
Full charged / 充電完了	● Blue light keeps on 青い光を保つ
Low power / 低電力	☀ Red light flashes once every second 毎秒1回赤色のライトが点滅します

⑥ Attention / 注意



Non waterproof, don't expose to liquids
防水機能をないため、液体に晒さないでください



NO over charging in case damage the battery life
充電し過ぎると、電池寿命を損します



Don't disassemble
かてに分解しないでください



Avoid extreme temperatures
極端な温度を避けてください



Avoid dropping
落とさないでください

⑦ Controls / コントロール

🎵		
ANC	X1	Noise cancelling On/Off / ノイズキャンセリングオン/オフ
📞	X1	Play / Pause / 再生 / 一時停止
⏻	X1	Next 次曲

📞		
📞	X1	Answer / End call / 通話 / 電話を切る
⏻	X1	Connect the last call / 最終通話をかける

⑧ Specifications / 規格

BT version / ブルートゥース バージョン	BT5.0
FTP	HSP/HFP/A2DP/AVRCP
Noise cancellation depth	20dB
Battery / 電池	270 mAh
Charging time / 充電時間	About 2 hrs / 約 2 hrs
Playing time / 再生時間	40hours
Standby-by-time / 待機時間	About 600hrs / 約 600 hrs
Net weight / 正味	30g
Size / サイズ	600X44X12mm

FCC Statement

This equipment has been tested and found to comply with the limits for a Class B digital device, pursuant to part 15 of the FCC rules. These limits are designed to provide reasonable protection against harmful interference in a residential installation. This equipment generates, uses and can radiate radio frequency energy and, if not installed and used in accordance with the instructions, may cause harmful interference to radio communications. However, there is no guarantee that interference will not occur in a particular installation. If this equipment does cause harmful interference to radio or television reception, which can be determined by turning the equipment off and on, the user is encouraged to try to correct the interference by one or more of the following measures:

- Reorient or relocate the receiving antenna.
- Increase the separation between the equipment and receiver.
- Connect the equipment into an outlet on a circuit different from that to which the receiver is connected.
- Consult the dealer or an experienced radio/TV technician for help.

To assure continued compliance, any changes or modifications not expressly approved by the party.

Responsible for compliance could void the user's authority to operate this equipment. (Example- use only shielded interface cables when connecting to computer or peripheral devices).

This equipment complies with Part 15 of the FCC Rules. Operation is subject to the following two conditions:

- (1) This device may not cause harmful interference, and
- (2) This device must accept any interference received, including interference that may cause undesired operation.

RF warning statement:

The device has been evaluated to meet general RF exposure requirement.
The device can be used in portable exposure condition without restriction.

Any Changes or modifications not expressly approved by the party responsible for compliance could void the user's authority to operate the equipment.