

打印机品牌色

CMYK
C:90 M:0 Y:60 K:0

潘通色
PANTONE: 无光版3265U / 上光版2240C

展开尺寸: 315*297mm

材质: 80g书写纸/双面印刷/折叠

折叠要求: 保证封面在最前面

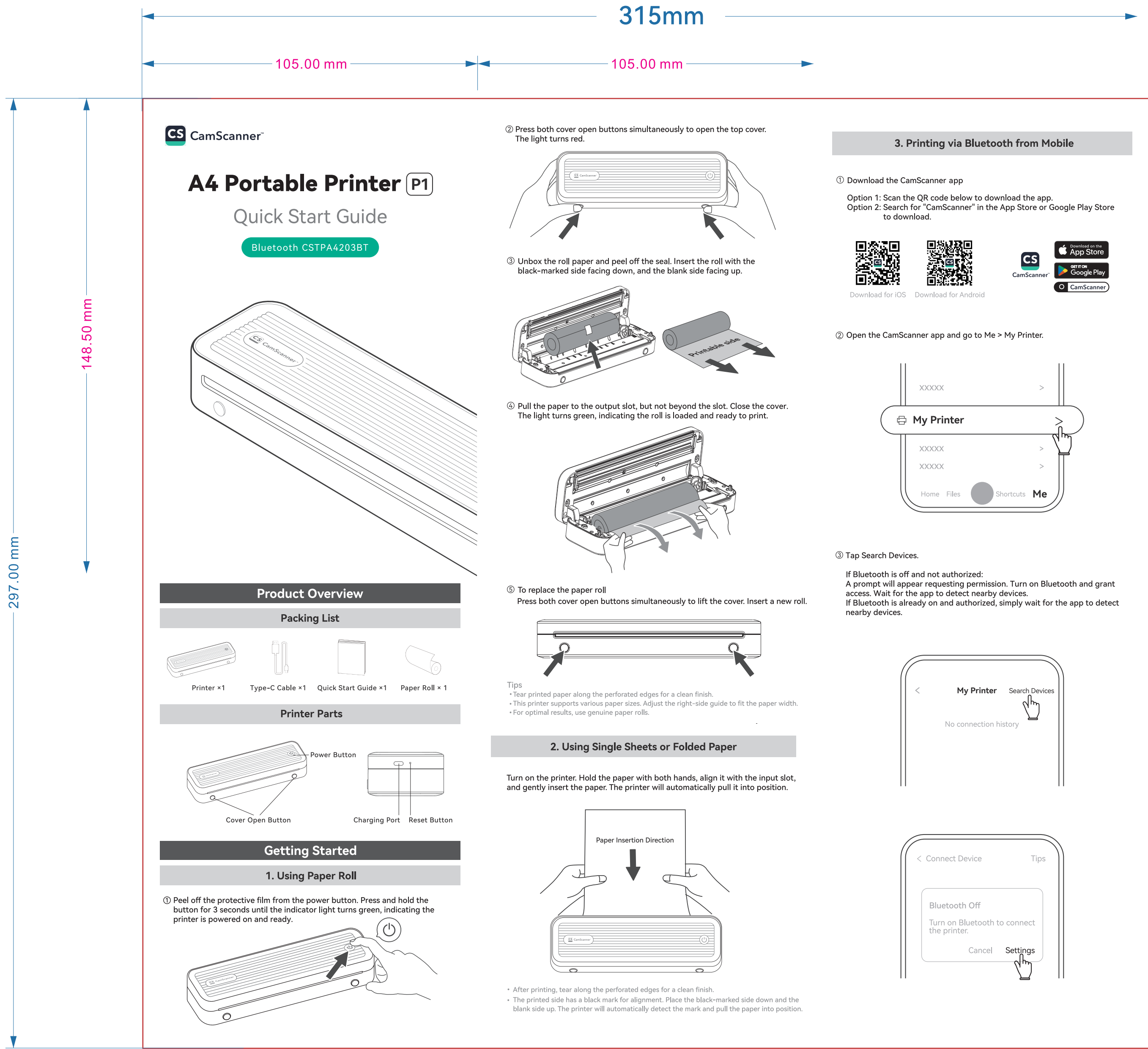

④ Ensure the printer is powered on and nearby. Select the printer to connect.

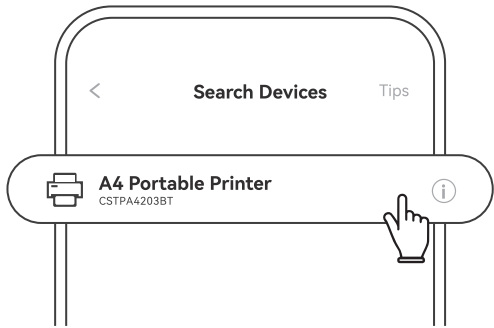

⑤ Once connected, select your file and start printing.

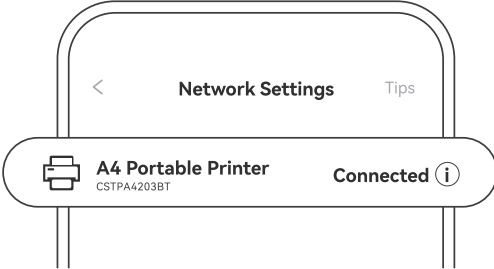

4. Printing via USB or Bluetooth on Computer

1. Install the Printer Driver

Download and install the printer driver from the CamScanner website:
<https://www.camscanner.com/download>

2. Printing via USB

- ① Keep the printer powered on and connect it to your computer using the USB cable.
- ② Open the downloaded driver and complete the installation.
- ③ Select the file you want to print, then choose CSTPA4203BT as your printer to start printing.

Tip: If the printer doesn't appear, reconnect the USB cable, then go to Add Printer to locate and add the device again.

3. Printing via Bluetooth

- ① Keep the printer powered on and enable Bluetooth on your computer.
- ② Open the Settings on your computer, then go to the Printer settings and add your printer.
- ③ Select the file you want to print, then choose CSTPA4203BT (Bluetooth) as your printer to start printing.

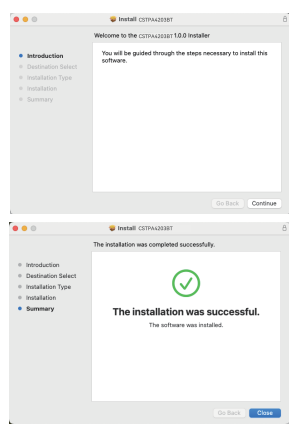

Driver Installation

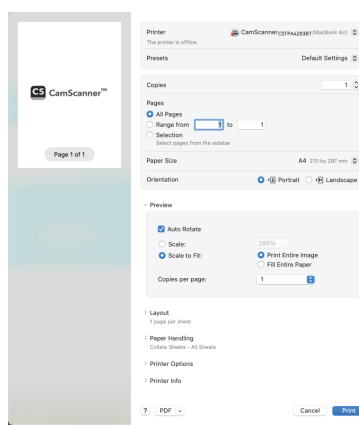

Printing Setup

Information to User

1. FCC INFORMATION (U.S.A.)

This device complies with part 15 of the FCC Rules. Operation is subject to the following two conditions:

- (1) This device may not cause harmful interference, and
- (2) This device must accept any interference received, including interference that may cause undesired operation.

Any changes or modifications not expressly approved by the party responsible for compliance could void the user's authority to operate the equipment.

NOTE: This equipment has been tested and found to comply with the limits for a Class A digital device, pursuant to part 15 of the FCC Rules. These limits are designed to provide reasonable protection against harmful interference when the equipment is operated in a commercial environment. This equipment generates, uses, and can radiate radio frequency energy and, if not installed and used in accordance with the instruction manual, may cause harmful interference to radio communications. Operation of this equipment in a residential area is likely to cause harmful interference in which case the user will be required to correct the interference at his own expense.

Important: Change or modifications not expressly approved by the manufacturer responsible for compliance could void the user's authority to operate the equipment.

2. ISED NOTICE (Canada)

- English:

This device contains licence-exempt transmitter(s)/receiver(s) that comply with Innovation, Science and Economic Development Canada's licence-exempt RSS(s). Operation is subject to the following two conditions:

- (1) This device may not cause interference.
- (2) This device must accept any interference, including interference that may cause undesired operation of the device.

IC RF exposure statement:

The device has been evaluated to meet general IC RF exposure requirement. The device can be used in portable exposure condition without restriction.

- French:

L' émetteur/récepteur exempt de licence contenu dans le présent appareil est conforme aux CNR d' Innovation, Sciences et Développement économique Canada applicables aux appareils radio exempts de licence. L' exploitation est autorisée aux deux conditions suivantes :

- 1) L' appareil ne doit pas produire de brouillage;
- 2) L' appareil doit accepter tout brouillage radioélectrique subi, même si le brouillage est susceptible d' en compromettre le fonctionnement

IC Déclaration d'exposition aux RF:

L'appareil a été évalué pour répondre aux exigences générales d'exposition aux RF d'IC. L'appareil peut être utilisé dans des conditions d'exposition portable sans restriction.

Special Notes

The company assumes full responsibility for the revision and explanation of this manual, exercising utmost diligence to guarantee its accuracy. Nevertheless, please note that any technical improvements to the product may not be separately notified, and that the images of the product, accessories, software interfaces, etc. in this manual serve solely as illustrations and references. Due to product updates and upgrades, the actual product may vary slightly from the images. Please refer to the physical product for accurate representations.