

# Rechargeable Wired & Wireless Optical Mouse User Manual

## Welcome

Thank you for selecting this product! This mouse is one kind of newly developed item, which adopts smart design principle and reasonable layout integrated wired & wireless function. The comfortable and perfect shape is designed according to somatology. With it, you can get rid of the bondage of wires and enjoy the precise of wired optical mouse, and taste your wonderful life from the high technology as well.



## Product Features

1. Data transmission with Radio frequency 27MHz .It has 256 ID code, there is no interference even many mice being used at the same time.
2. Be able to use it as wired mouse as well to enjoy the precision and stable performance.
3. Build-in receiver, the power is off automatically when the receive hidden inside
4. Both functions of automatic power sleeping, and shut off by hand. Save power and batteries life prolonged. .

5. With charge and regular circuit inside, it can use the attached retractable cable to charge for the mouse. Even if there is no battery in the mouse, you can use the mouse directly, thus it resolves the problem of lack of battery.

### **Systems Compatibility**

IBM PC and Windows 98SE/Me/2000/XP

### **Build-in mini receiver**

As below graph, press the receiver-out button, and the receiver can spring out automatically. Of course, you may push the receiver back to the transmitter, and power will be cut down automatically.

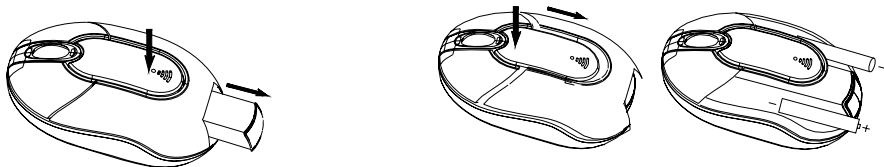

### **The Steps of Battery Installation**

1. Please prepare two pieces of new AAA rechargeable batteries.
2. According to below marks, press the button of the mouse upper cover and pull the battery cover backward
3. Please put the batteries correctly according to the polarity marks of the battery grooves.
4. Pull the battery covers forward, when you hear "crack" sound which shows the battery cover is locked successfully.

### Receiver Installation

1. We propose you to use extension cord, and put the receiver on your working desktop, in this way, you may obtain higher working efficiency.
2. If you use PS/2 connector, please use the USB to PS/2 adaptor and connect with the port before your computer start-up.
3. For laptop, you may connect the receiver directly with the USB port.

### ID Setup as Wireless mouse

1. Please move the mouse close to the receiver
2. Press ID button of receiver with hard and acute object, and in the meantime within 10 seconds, press the ID button of the mouse bottom about 1 second with hard and acute object, the receiver light will flash very fast, a few seconds later it will be on which shows it is successfully to finish the digital transmission between the mouse and the receiver. You may start to use it.
3. Working distance: within 0.6-1.5 m

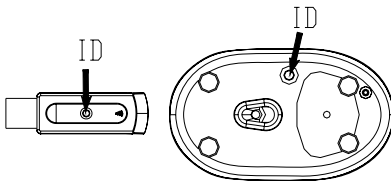

### Use as Wired Mouse

At many occasions such as airport, hospital etc where the wireless mouse can't be used or the mouse is lack of the power. At this time, you can use this mouse as wired mouse. Using the retractable cable, you connect it at the front of mouse, and other end is connected with the computer. If you could not use it freely, please follow the instructions of data transmission. Again press the ID button of the mouse bottom with some hard and acuate object again, then you can use it.

If there is only PS2 port available in your computer, you can use it as a PS2 wired mouse with a PS2 adaptor. In order to avoid losing the receiver, you had better hide the receiver into the mouse, in the same way, and there is no interference to use the mouse.

### **Charge Function**

When using mouse, if the red LED of the low battery beside the wheel flashes, please change batteries or charge them .The mouse can use USB cable to charge, connect one end of USB cable with the port of the computer, and the other end with USB port in the front of mouse, thus it can successfully charge the battery. It can also be charged up while you use the mouse. It is full to charge within about 8-10 hours, and then unplug the connector to stop the charge. Please note that the time of charge may vary when the degree of discharge is different.

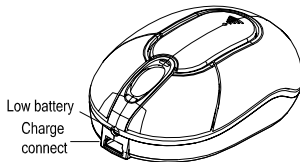

### **Attention Please**

1. Please don't make the mouse far away from the receiver in order to work more smoothly.
2. You'd better use the mouse on the white desk; in this way the batteries can be used longer time. Please remove the batteries if the mouse will not be used for a long time or if you travel outside.
3. This mouse has automatic saving-power sleep function. It would be access into sleep once no operation is for some time. If wake up the mouse, please press any key or scroll the wheel
4. If you want to take off the mouse power, please continue to press the ID switch of the mouse bottom over 3 seconds. If you want to take on the power, please click the ID switch once again.
5. The optical mouse will not work freely on a smooth desk, glass, and any reflecting surface, 3D mouse pad.
6. When you move the mouse, if the light of the battery before the receiver flashes, which shows that the power is nearly finished. Please change the proper-sized new battery or charge it immediately.
7. You can place the receiver in the mouse when you want to carry the mouse on business, and press the switch of ID for a long time so as to switch off the power.

**Caution**

Any changes or modifications not expressly approved by the party responsible for compliance could void the user's authority to operate the equipment.

**Note****FCC Statement**

1. This device complies with Part 15 of the FCC Rules. Operation is subject to the following two conditions:
  - (1) This device may not cause harmful interference, and
  - (2) This device must accept any interference received, including interference that may cause undesired operation.
2. Changes or modifications not expressly approved by the party responsible for compliance could void the user's authority to operate the equipment.

These limits are designed to provide reasonable protection against harmful interference in a residential installation. This equipment generates, uses and can radiate radio frequency energy and, if not installed and used in accordance with the instructions, may cause harmful interference to radio communications. However, there is no guarantee that interference will not occur in a particular installation. If this equipment does cause harmful interference to radio or television reception, which can be determined by turning the equipment off and on, the user is encouraged to try to correct the interference by one or more of the following measures:

- Reorient or relocate the receiving antenna.
- Increase the separation between the equipment and receiver.
- Connect the equipment into an outlet on a circuit different from that to which the receiver is connected.
- Consult the dealer or an experienced radio/TV technician for help.