

BATTERY TIPS

- 1. The car using 3(AA size) batteries and Remote controller use 2(AA size) batteries.
- 2. Pay attention to the electrodes '+' and '-' when install the batteries in the car and controller.
- 3. Take out battery from the car if not playing it for a long time.

ATTENTIONS

Do not play on the road or in a dangerous place.
Do not play the car in a place where it could easily get wetted.
Do not play the car on sands or other uneven surfaces or in a place with too much dust.
Do not play on the carpet in case of malfunction with enlaced fur.

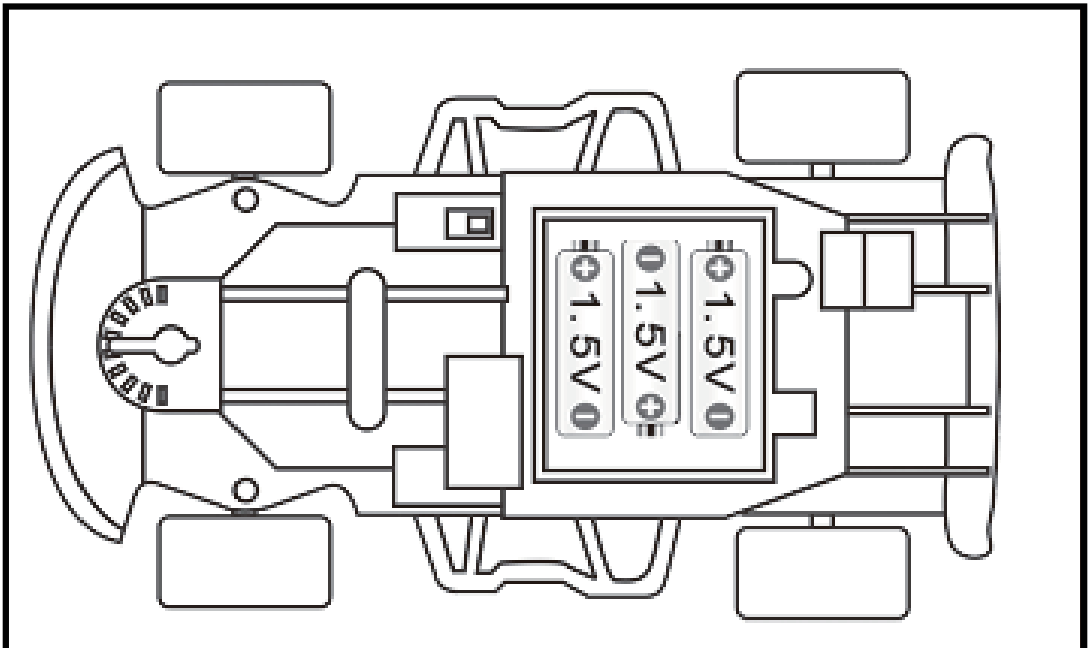

USE 3X1.5V(AA) BATTERY

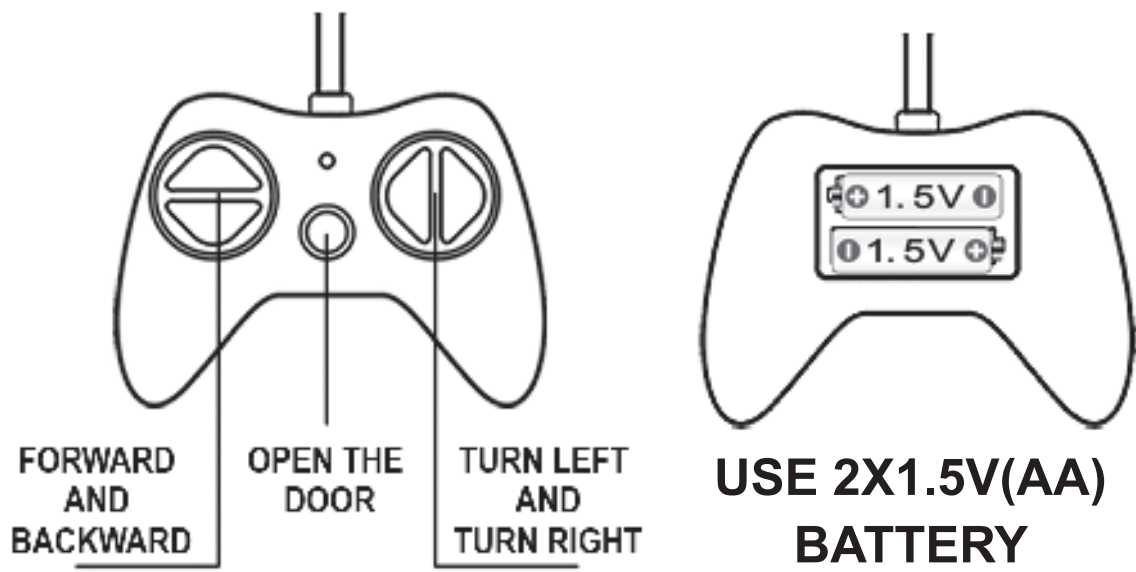

HANDLE REMOTE x1



WATER BOTTLE x1

FCC Statement
Note: This equipment has been tested and found to comply with the limits for a Class B digital device, pursuant to part 15 of the FCC Rules. These limits are designed to provide reasonable protection against harmful interference in a residential installation. This equipment generates, uses and can radiate radio frequency energy and, if not installed and used in accordance with the instructions, may cause harmful interference to radio communications. However, there is no guarantee that interference will not occur in a particular installation. If this equipment does cause harmful interference to radio or television reception, which can be determined by turning the equipment off and on, the user is encouraged to try to correct the interference by one or more of the following measures:
—Reorient or relocate the receiving antenna.
—Increase the separation between the equipment and receiver.
—Connect the equipment into an outlet on a circuit different from that to which the receiver is connected.
—Consult the dealer or an experienced radio/TV technician for help.

This device complies with part 15 of the FCC Rules. Operation is subject to the following two conditions:(1) This device may not cause harmful interference, and (2) this device must accept any interference received, including interference that may cause undesired operation.

Any changes or modifications not expressly approved by the party responsible for compliance could void the user’s authority to operate the equipment.

The device has evaluated to meet general RF exposure requirement. The device can be used be in portable exposure without restriction.