

USER MANUAL

Smart Ultrasonic Humidifier
Model: YH-A936S/YH-A936/YH-A936H

If you have any questions, please feel free to contact
service@kfcsmart.com

CONTENTS

03	Product Accessories List
03	Product Specification
04	Important Tip
05	Safety Instructions (Please Read Carefully Before Use)
06	Product Components
07	Getting to Know Humidifier LED Screen Icon
08	How to Control Your Smart Humidifier
10	Steps for Filling Water
11	Precautions
12	Cleaning and Maintenance
13	Set up Your Humidifier in the App
14	Add a Humidifier to the App
15	Add a Humidifier to the App (cont.)
16	Troubleshooting
17	Warranty
17	Customer Support

Product Accessories List



Smart Ultrasonic
Humidifier x 1



User Manual x 1



Quick Guide x 1

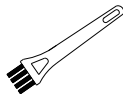

Cleaning Brush x 1

Product Specification

Model	YH-A936S/ YH-A936/ YH-A936H
Voltage	AC100-240V/ 50-60Hz
Wattage	25W
Noise Level	≤35dB (A)
Capacity	3. 0L/4.5L/6. 0L
Atomization Time	Max mist: 10H/15H/20H
Mist Output	150-300mL/H
Net Weight	2.871b/2. 981b/3. 281b
Gross Weight	3.531b/3. 681b/3. 971b
Executive Standard	GB4706.1-2005GB4706.48-2009

Note: Use additional smart humidifier function, download the free 'KFC Smart' app (See page 13).

Important Tip

Important Tip: **DO NOT** leave the humidifier unused for a long time (i.e. several days or more). This may cause premature failure of the circuitry. When the humidifier is not in use, please press the power button '⏻' and unplug the power plug.

OFF POSITION

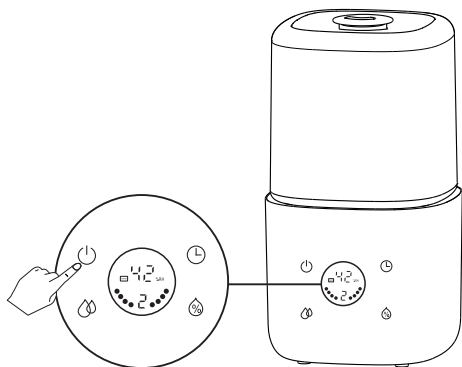

Fig.1

UNPLUG FROM POWER SOURCE

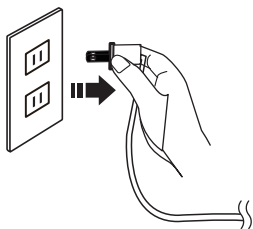

Fig.2

Safety Instructions

(Please Read Carefully Before Use)

- Please follow the operation steps in the user manual (see page 10) to operate the humidifier correctly at home;
- Keep the plug and power supply away from liquids;
- Please check the device before use for any cracks, chips or damage that may cause leakage of the device. If you find any damage, **DO NOT** use it. Only professional or authorized maintenance personnel can repair the appliance. **DO NOT** replace parts or add other items as replacement parts by yourself;
- **DO NOT** pour out the remaining water in the base without unplugging the power plug, otherwise it will cause the atomizer to burn out; pour out the remaining water in the base without unplugging the power plug, otherwise it will cause the atomizer to burn out;
- **DO NOT** add essential oils directly in the water tank. The humidifier has specific locations where you can add essential oils (see page 11);
- When plugging in any power source, make sure your hands are dry to avoid the risk of electric shock;
- When adding water, please hold the water tank with two hands to prevent the water tank from falling. If the equipment is in working condition, **DO NOT** move the water tank;
- When unplugging the plug, **DO NOT** pull the power cord with your hands to unplug the plug. The disconnected part is prone to short-circuit and leakage, which may cause fire and electric shock.
- **DO NOT** let children clean or maintain the humidifier alone;
- **DO NOT** use this appliance in any kind of inflammable environment. Keep the equipment away from any heat sources (e.g. stoves, ovens, radiators) and avoid direct sunlight.

Product Components

- | | | |
|-------------------------------------|--|------------------------------------|
| A. Nozzle | G. Atomization Piece | M. Air Inlet |
| B. Mist Tube | H. Anti-drying Water Level Monitoring Float | N. Power Cord |
| C. Water Tank Cover | I. Air Outlet | O. Water Outlet Valve |
| D. Water Tank | J. Essential Oil Box | P. Floating Ball Limit Post |
| E. Display | K. Max Water Line | Q. Noise Silencer |
| F. Water Level Control Float | L. Base Feet | |

