



QUICK START GUIDE
True Wireless Earbuds



NOTE

Open the charging case or keep long press for the button 3S. Around 15S after power on, 2 earbuds paired. The red blue LED Light of master earbud flashes alternatively, and the blue LED Light fast flash every 3S of the other earbud

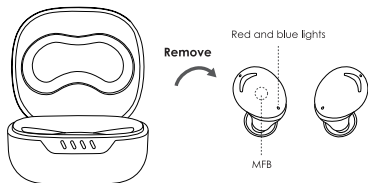

CHARGING

Put the earbuds into the charging case,close the cover,then the charging case will charge the earbuds and in the same time 2 earbuds power off.The red LED Light on,if it's fully charged, the blue LED Light on 10S and then switch off

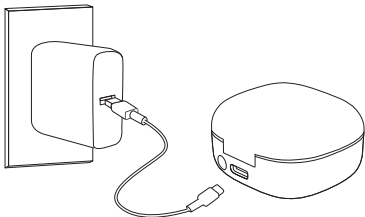

FIND YOUR FIT

Choose the size of ear-tips that provides the most secure and comfortable fit.



L

M

S



PAIRING

1. Open the lid of the charging case

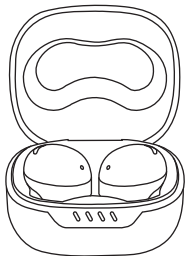

2. Turn on the pairing function on your device

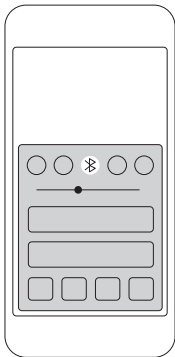

3. Select "M1" and click connected, the earbuds LED Light off. If cannot connect, turn off the earbuds and reopen for trying again

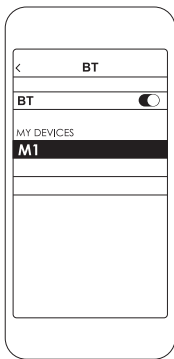

Not pairing with your device?

Try restarting your device and then repeat the pairing process.

CONTROLS

Touch Panel

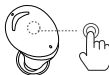

Play/Pause

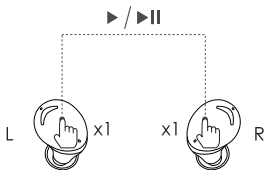

Tap (L/R)

Play/Pause: Click the left or right button

Skip to Previous Track

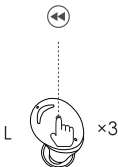

Triple-tap (L/R)

Play Music: Tri-Click the button of the left earbud, then go to previous song after hearing "Du"

Skip to Next Track

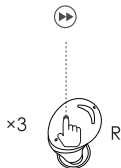

Triple-tap (L/R)

Play Music: Tri-Click the button of the right earbud, then go to previous song after hearing "Du"

Answer/End Calls

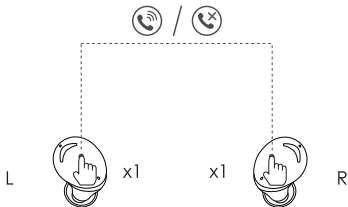

Tap (L/R)

Answer/Hang up the call: Click the left or right button

Refuse calling: Long contact the MFB 2S

Activate Siri or Other Voice Assistants

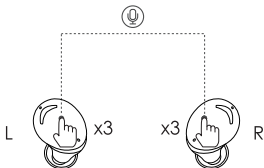

Triple-tap (L/R)

Tri-click the button of either of the earbuds, then go to voice assistant mode, and tri-click again to exit

Volume -

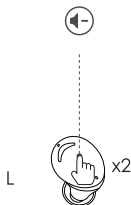

Double-tap

Volume +

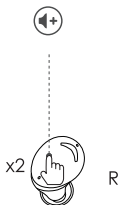

Double-tap

Double click the button of the left earbud, decrease the volume and it will prompt after reach minimize;

Double click the button of the right earbud, decrease the volume and it will prompt after reach maximize

ANC Mode Switching



Long press 2S

After connected, long press the button 2S to change the mode, from Normal -- ANC -- Transparent, the default mode is normal mode

Power off



Long press 5S

Long touch the button 5S, the red LED Light on 3S until switch off.

Power off

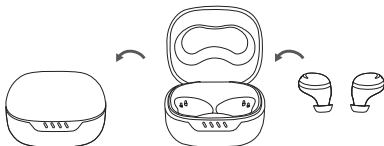

Put the earbuds into the charging case and close the charging case cover, then the earbuds will closed down

Reset the earbuds

Open the charging case, long press the button 5s, white led light of the 1st and 4th LED flashes 5s then reset successfully

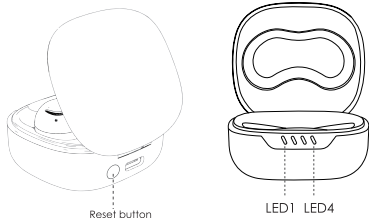

NOTE

Make sure the wireless earbuds is not connected to other devices before resetting.

FCC STATEMENT

Changes or modifications not expressly approved by the party responsible for compliance could void the user's authority to operate the equipment.

This equipment has been tested and found to comply with the limits for a Class B digital device, pursuant to Part 15 of the FCC Rules. These limits are designed to provide reasonable protection against harmful interference in a residential installation. This equipment generates uses and can radiate radio frequency energy and, if not installed and used in accordance with the instructions, may cause harmful interference to radio communications. However, there is no guarantee that interference will not occur in a particular installation. If this equipment does cause harmful interference to radio or television reception, which can be determined by turning the equipment off and on, the user is encouraged to try to correct the interference by one or more of the following measures:

- Reorient or relocate the receiving antenna.
- Increase the separation between the equipment and receiver.
- Connect the equipment into an outlet on a circuit different from that to which the receiver is connected.
- Consult the dealer or an experienced radio/TV technician for help

This device complies with part 15 of the FCC rules. Operation is subject to the following two conditions (1) this device may not cause harmful interference, and (2) this device must accept any interference received, including interference that may cause undesired operation.

Model: M1

