

PRODUCT USER MANUAL

- THE PRODUCT IS INTENDED FOR USE BY CHILDREN AGED 8 AND ABOVE.
- PLEASE READ THIS INSTRUCTION MANUAL CAREFULLY BEFORE USE.

PRODUCT CONFIGURATION

- 1X 1:20 Electric Remote Control Drift Car
- 1X Remote control
- 4X Tire
- 4X Traffic cones
- 1X Lithium-ion battery pack
- 1X USB Charging cable
- 1X DIY Stickers
- 1X Screwdriver
- 1X User Manual

BATTERY DEMAND

DRIFT REMOTE-CONTROL CAR:

3.7V ALKALINE BATTERIES

REMOTE CONTROL:

2X1.5V "AA" BATTERIES (INCLUDING)

BATTERY ASSEMBLY

ASSEMBLY OF REMOTE CONTROL BATTERY

1. Remove the battery cover.
2. As shown in the figure, Install 2X1.5V "AA" batteries in the correct polarity.
3. Close the battery cover.

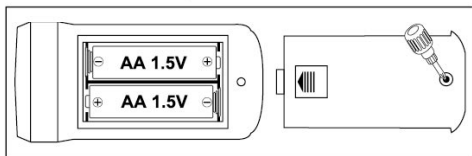

Assembly of Drift Remote Control Car Battery

1. Turn off the power.
2. Use a screwdriver to loosen the screw counterclockwise and remove the battery cover.
3. Install the battery pack, close the battery cover, and screw the screw back in clockwise.

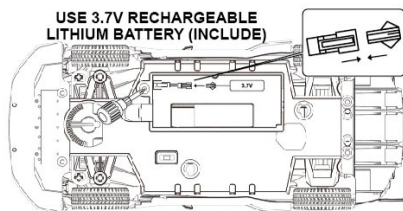

MAINTENANCE AND MAINTENANCE

1. Avoid exposing this product to direct sunlight or heat.
2. Do not submerge this toy in water, as it will damage the electronic components.
3. Check if all screws are loose.
4. Lubricate all moving parts.
5. Wipe off dust and oil.
6. Remove the batteries from the remote control when not in use.
7. Remove the batteries from the vehicle battery compartment when not using the car.

INSTRUCTIONS FOR USING STICKERS:

YOU CAN DIY AND STICK THEM ON SUITABLE LOCATIONS OR ACCORDING TO THE DESIGNED PATTERNS ON THE BODY MARKED POSITIONS.

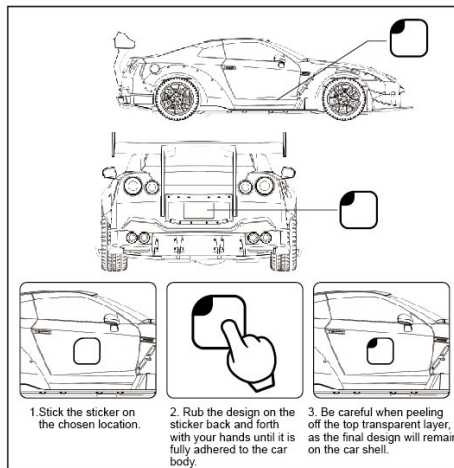

REMOTE-CONTROL CAR DRIVING

1. Turn on the power: Push the power switch on the remote car and the remote controller to the "ON" position.
2. Remote control distance: The maximum remote control distance is about 30 meters. Operating sensitivity may be affected if the distance exceeds this range.
3. Usage time: Up to 20 minutes with a full charge.
4. If the vehicle is not traveling in a straight line, adjust the steering fine-tuning on the chassis at the bottom of the vehicle.
5. Remove the battery from the vehicle battery compartment when you are not using the car.

REMOTE CONTROL:

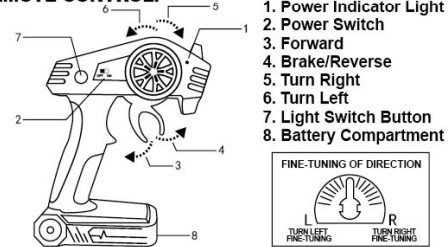

REMOTE CONTROL OPERATION

1. Pull the throttle lever back to make the remote-controlled car move forward. Adjusting the angle of the throttle lever controls the speed of the car's forward movement.
2. Push the throttle lever forward to make the remote-controlled car move backward. Adjusting the angle of the throttle lever controls the speed of the car's backward movement. During the car's backward movement, quickly switch the throttle lever to the backward position to make the car go forward again.
3. Pull the throttle lever back while turning the left steering wheel to make the remote-controlled car turn left and move forward.
4. Pull the throttle lever back while turning the right steering wheel to make the remote-controlled car turn right and move forward.

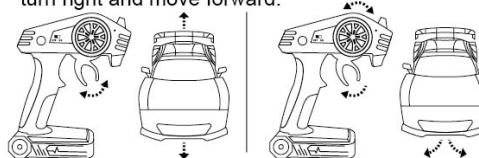

DRIVING SKILLS:

1. Do not drive on grass, sand, or water.
2. Do not drive the remote-controlled vehicle in bad weather conditions.
3. Do not crash the remote-controlled vehicle into hard objects.
4. Turn off the remote controller and vehicle power when not in use.
5. Keep fingers, hair, and loose clothing away from the wheels.
6. For a better drifting experience, operate the remote-controlled vehicle in an open area.

PRECAUTIONS:

1. Non-rechargeable batteries cannot be charged.
2. Battery charging must be operated by adults and children should not charge by themselves.
3. This product is only suitable for children over 8 years old.
4. Always keep the parts dry.
5. Ensure that all chemicals, small parts and other electronic accessories are out of reach of children.
6. Please do not throw away bad batteries, disassemble them or put them into fire or water to avoid accidents.
7. Do not put any part of your vehicle in your mouth to avoid injury or even suffocation.
8. Rechargeable batteries must be charged with a dedicated charger or a charger compatible with lithium batteries. Failure to follow this procedure may cause a fire and harm to the body.
9. Disconnect the battery connection after charging and let the charger cool down after charging.
10. Check the wires, plugs, shells and other parts of the charger and battery before use to see if they are damaged. If damaged, stop using them until they are repaired.
11. Pay attention to polarity when installing or replacing batteries.
12. The remote-control car uses a 3.7V lithium battery, and the remote controller uses 2X1.5V "AA" batteries.

WARNING:

1. Please do not disassemble the remote car or remote controller.
2. Make sure to install the 2X1.5V "AA" batteries in the correct polarity as instructed in the battery box.

Product specifications, colors, and contents may differ from the illustration, please refer to the actual product.

MAKE IN CHINA

FCC Warning

This device complies with part 15 of the FCC Rules. Operation is subject to the following two conditions: (1) This device may not cause harmful interference, and (2) this device must accept any interference received, including interference that may cause undesired operation.

Any Changes or modifications not expressly approved by the party responsible for compliance could void the user's authority to operate the equipment.

Note: This equipment has been tested and found to comply with the limits for a Class B digital device, pursuant to part 15 of the FCC Rules. These limits are designed to provide reasonable protection against harmful interference in a residential installation. This equipment generates uses and can radiate radio frequency energy and, if not installed and used in accordance with the instructions, may cause harmful interference to radio communications. However, there is no guarantee that interference will not occur in a particular installation. If this equipment does cause harmful interference to radio or television reception, which can be determined by turning the equipment off and on, the user is encouraged to try to correct the interference by one or more of the following measures:

- Reorient or relocate the receiving antenna.
- Increase the separation between the equipment and receiver.
- Connect the equipment into an outlet on a circuit different from that to which the receiver is connected.
- Consult the dealer or an experienced radio/TV technician for help.

The device has been evaluated to meet general RF exposure requirement. The device can be used in portable exposure condition without restriction.