

Product maintenance

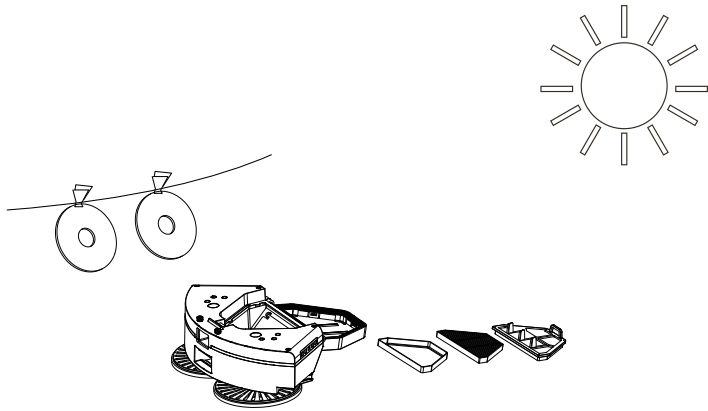

Dry the dust box and filter components and keep them dry to ensure their service life. When the lifting tank is used for 15-30 days, it is recommended to wash it once. The maximum service life of high efficiency filter is 3 months.

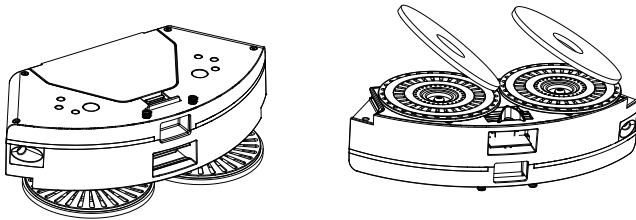

Reinstall the primary high-efficiency filter screen and sponge into the lifting water tank, and then paste the mop onto the pallet. Before installation, please ensure that the dust box, high-efficiency filter screen, sponge and mop are in a dry state.

Product maintenance

5.3 Base station maintenance

Maintenance of mop cleaning bracket

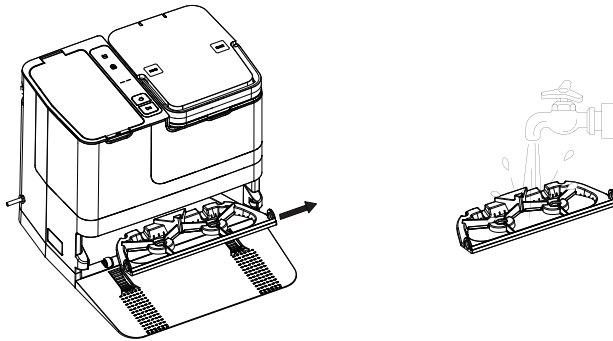

Pull up the mop cleaning bracket, clean it with water and put it back into the base station.

Replace dust bag

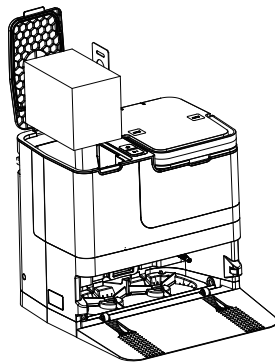

Open the top cover, hold the dust bag handle and pull it upward, so that the dust bag will be separated from the base station. Replace the dust bag with a new one according to the step of placing the dust bag.

Product maintenance

Water tank maintenance

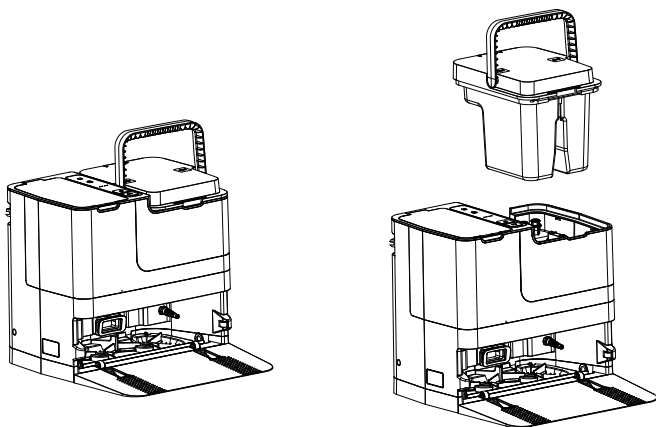

Pull up the handle of the water tank, lift the water tank vertically and take it out.

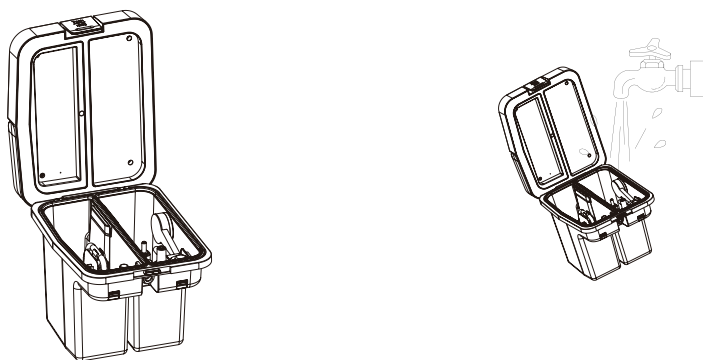

Open the cover of the water tank, dump the water and garbage in the water tank parts and rinse them clean. Add a proper amount of water to the clean water tank and put it back to the base station.

Product maintenance

5.4 Maintenance of roller brush assembly

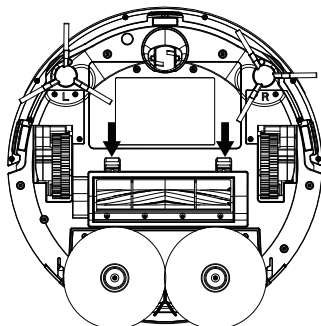

Open the brush cover assembly.

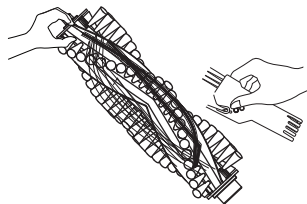
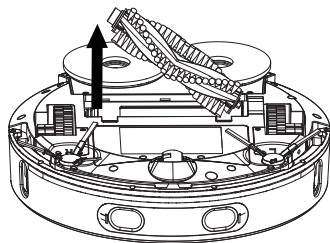

Take out the roller brush shaft and clean the impurities and hair on the roller brush shaft.

5.5 Other component maintenance

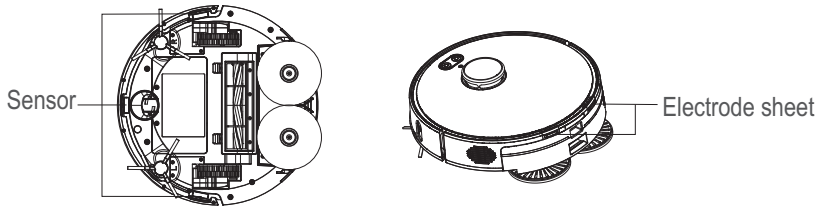

Gently wipe the charging electrode plate and sensor window of the machine chassis with a cleaning tool or a dry soft cloth from time to time.

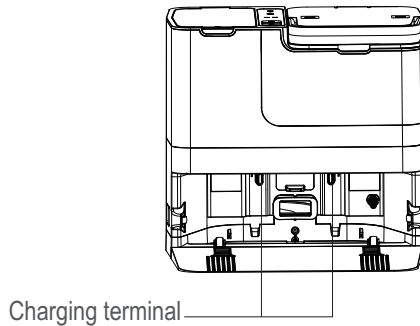

Disconnect the power supply and clean the charging stand terminal with a dry cleaning tool or a soft cloth.

Common malfunctions

6.1 Fault description

Host fault description

Fault conditions	Possible causes	Solution
Host cannot be charged	The charging pole pieces of the host and the base station are not fully contacted.	Ensure that the charging pole pieces of the host and the base station are fully butted.
	The power supply of the base station is turned off and the host computer is turned on, resulting in power consumption.	When the host computer is not working, it is recommended to keep it in a charged state, so as to better carry out the next work.
Host cannot be charged	The host is entangled and blocked by scattered wires, drooping curtains or carpet edges on the ground.	The Host will try various methods to get out of trouble autonomously. If it fails to get out of trouble, it is recommended to help manually.
The cleaning is not completed, the Host returns to charge	The Host can sense low battery during operation and automatically return to charge.	Charge the host.
	The host's working speed and duration are different for wooden floors, tiles and other flat floors.	The Host's working time varies depending on the complexity of the room, the amount of garbage, and the cleaning mode.
Host does not automatically clean according to the scheduled time	The Host is not turned on. The Host cannot work on its own at the agreed time when it is turned off.	Press and hold the cleaning button on the machine to turn on the Host.
	The host is low on power.	When the Host is in standby mode, it should be kept on the charging dock to ensure that it has sufficient power to work at any time.
	The host components are clogged and entangled with garbage.	Turn off the power, clean the dust box, and turn the bottom of the Host upwards. Clean each component separately.
	The host is in Do Not Disturb mode	Check whether the Do Not Disturb mode switch is turned on in the smart cleaning settings of the app.
When the Host is working, there are problems such as missed sweeps, disordered routes, deviations, and irregular and untidy display of the cleaning map on the APP.	The drive wheel may slip on the ground when the host climbs small steps, thresholds, and door strips, thus affecting the host's judgment of the whole house working environment.	It is recommended to close the door of the area and clean the area separately. The Host has the function of self-identifying a single room and will return to the starting point after cleaning. Please feel free to use it.
	Working on a newly waxed, polished floor or smooth floor tiles will reduce the friction between the drive wheel and the ground	It is recommended that you wait until the floor wax is dry before cleaning.
	Objects such as wires and slippers placed on the ground will affect the normal operation of the host	Before the host starts working, please tidy up the scattered wires, slippers and other objects on the ground to reduce the scattered items on the ground as much as possible.

Common malfunctions

Base station fault description

Fault conditions	Possible causes	Solution
Can't add water to the sweeper	Clear water has no water.	Add a proper amount of clean water to the clean water tank.
	The water tank is not installed.	Install the water tank correctly.
The tray overflows with clear water.	The base station mop cleaning bracket is not installed correctly, resulting in water leakage.	Install the mop cleaning bracket of the base station correctly.
	The tray full sensor is blocked by dirt.	Take out the mop cleaning bracket and manually clean the inside of the tray.
Can't suck the tray sewage	The water tank is not installed in place.	Install the water tank correctly.
	The water tank is not fastened correctly.	The water tank is fastened and installed correctly.
	The sewage tank is full.	Dump the sewage from the sewage tank.
	The suction port of the tray is blocked by dirt.	Take out the mop cleaning bracket and clean the blocked suction port in time.
Unable to collect dust normally	The dust bag is not installed correctly.	Install the dust bag correctly.
	The dust bag is full of garbage.	Replace a new dust bag.
	The dust cover was not closed when collecting dust.	When collecting dust, close the dust cover.
Unable to charge the host.	Contact of base station charging metal terminal is dirty.	After power failure, clean the charging metal terminal contacts.
The robot can not enter the station	The station is placed on the uneven floor	Please place the station on the tidy and even floor.

Common malfunctions

6.2 Replaceable module

host machine

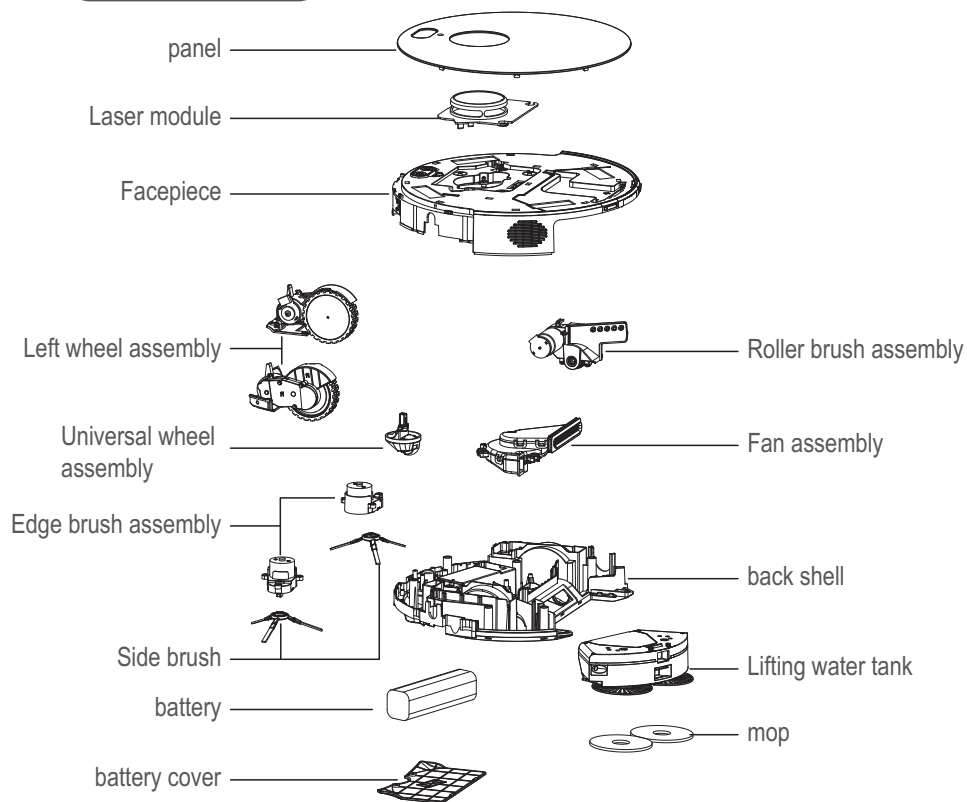

Scope of application

This product is suitable for cleaning homes, hotel rooms, and small offices. It has a good cleaning effect on various short and long carpets (carpet hair less than 1.5 cm), wooden floors, hard floors, and tiles.

Common malfunctions

base station

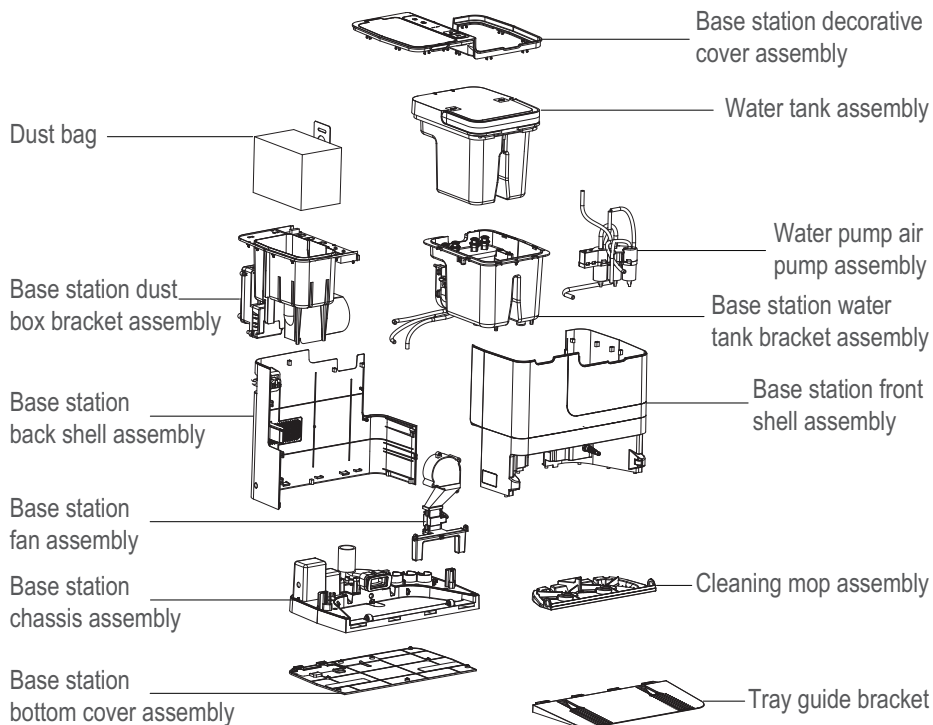

FCC compliance statement

This device complies with Part 15 of the FCC Rules. Operation is subject to the following two conditions: (1) this device may not cause harmful interference, and (2) this device must accept any interference received, including interference that may cause undesired operation.

changes or modifications not expressly approved by the party responsible for compliance could void the user's authority to operate the equipment.

This equipment has been tested and found to comply with the limits for a Class B digital device, pursuant to Part 15 of the FCC Rules. These limits are designed to provide reasonable protection against harmful interference in a residential installation. This equipment generates, uses and can radiate radio frequency energy and, if not installed and used in accordance with the instructions, may cause harmful interference to radio communications. However, there is no guarantee that interference will not occur in a particular installation.

If this equipment does cause harmful interference to radio or television reception, which can be determined by turning the equipment off and on, the user is encouraged to try to correct the interference by one or more of the following measures:

- Reorient or relocate the receiving antenna.
- Increase the separation between the equipment and receiver.
- Connect the equipment into an outlet on a circuit different from that to which the receiver is connected.
- Consult the dealer or an experienced radio/TV technician for help.

FCC Radiation Exposure statement

This equipment complies with FCC radiation exposure limits set forth for an uncontrolled environment. This equipment should be installed and operated with minimum distance 20cm between the radiator and your body. This transmitter must not be co-located or operating in conjunction with any other antenna or transmitter.

Hereby, [MANUFACTURER] declares that the radio equipment type [Model No.] is in compliance with Directive 2014/53/EU. The full text of the EU declaration of conformity is available at the following internet address: [www.http://xxxxx](http://xxxxx)

