

USER MANUAL



1 Main parameters

Item No.: E570-003
Material: plastic and electronic components
Batteries: Car battery: 3.6V AA rechargeable battery;
Remote controller battery: 2 pcs of 1.5V AA batteries.



2 Battery Installation

- 1.Open the cover of battery case locates in the back of controller, inserts 2 pcs of 1.5V AA batteries into the battery case, and then screw the cover (Fig 2A).
2. Please screw out the cover at the back of car by screwdriver, open the cover as the arrow showed, insert 1pcs of 3.6 V AA battery, then screw the cover (Fig 2B).



Fig 2A

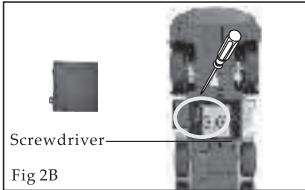

Fig 2B

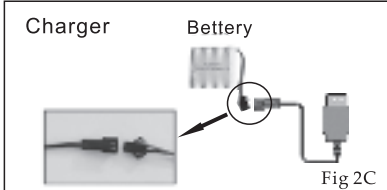

Fig 2C

Notice: This product shall be charged for 2 to 3 hours. The supporting USB charger shall not be used for other devices other than this product.

3 2.4G Auto Coding

- 1.After installing the batteries of truck and remote controller, open the switch of both. The indicator of remote controller and the fronts lights of truck would be flashing slowly, and then at a state of auto-matching.
- 2.One remote controller only could match with one car. After the success of matching, there is non-interference of each car.
- 3.If the remote controller could not find out the 2.4G signal of the car in 1minute, it would turn in a sleeping state(light off of the indicator). To press any key to activate.
- 4.To remake a pair with other cars or remote controllers after turning off the power of both.

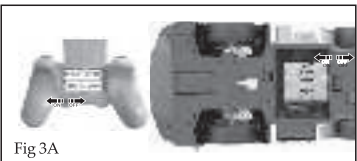

Fig 3A

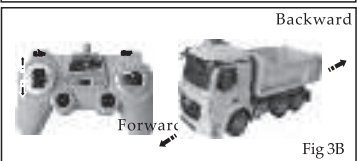

Fig 3B

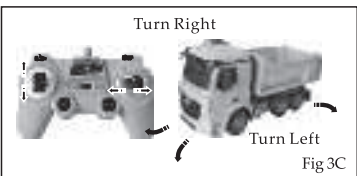

Fig 3C

4 Basic Operation & Functions

- 1.Turn ON/OFF
 - Press the ON/OFF key, there will be a start-up sound; to press the key again after starting. (Fig 3A)
- 2.Horn Key
 - To press the Horn Key on remote controller after starting the car, the car would emit a simulated sound.

3.Forward/Backward

- To push the Left Handle forward/backward, the car would go forward/backward.(Fig 3B)

4.Turn Left/Right

- To push the Left Handle forward/backward, Right Handle turns left/right, the car would turn left/right. (Fig 3C).

5.Up & Down of Carriage

- After starting the car, to press the key of Up & Down, the car would go up & down with a mechanical sound. (Fig 3D)

These functions could be multiple used for simulating operation.

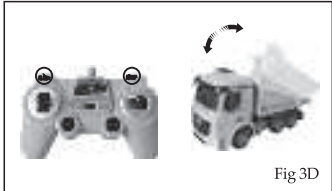

Fig 3D

5 Recharging

Notice: Please push the power switch to “OFF” position if the product will not be used for a long time. Take the batteries out of the remote controller and the truck for storing. Please charge the battery for 4 to 5 hours, 8 hours for initial use.

6 Notice

- 1.Don't play the toy on the road, select a safe place for operating to avoid dangerous.
- 2.Plays the toy in water may cause short-circuit damage. Please use the dry cloth to clean the car.
- 3.If abnormal speed or reaction, it may be because of insufficient battery power, please charge the battery.
- 4.The batteries should be charged under adult supervision. Please use the batteries recommended.
- 5.Please install the battery in a correct polarity.
- 6.Do not mix new and old batteries together, short-circuited.
- 7.Please charge the battery before initial use.
- 8.Please check the plug, case and other units of charger regularly to make sure that it is not broken.Don't use again if you find abnormality of the charger.
- 9.Please do not connect the product to different performance power.

Frequency bands: 2405MHz to 2475MHz

Maximum output power: -6.25dBm (for EU compliance)

Manufacturer: Doubleeagle Industry(China)Limited.

Address: Xingda Industrial Park , Chenghai

District, Shantou City, Guangdong Province , China.

Importer: JAMARA e.K.

Address: Inh .Manu el Natterer

Am Lauerbuhl5-DE-88317 Aichstetten Germany

CHOKING HAZARD-small parts , not for children under 3 years.

FCC Compliance

This device complies with Part 15 of the FCC Rules. Operation is subject to the following two conditions: (1) this device may not cause harmful interference, and (2) this device must accept any interference received, including interference that may cause undesired operation.

Note: This equipment has been tested and found to comply with the limits for a Class B digital device, pursuant to Part 15 of the FCC Rules. These limits are designed to provide reasonable protection against harmful interference in a residential installation. This equipment generates, uses and can radiate radio frequency energy and, if not installed and used in accordance with the instructions, may cause harmful interference to radio communications. However, there is no guarantee that interference will not occur in a particular installation.

If this equipment does cause harmful interference to radio or television reception, which can be determined by turning the equipment off and on, the user is encouraged to try to correct the interference by one or more of the following measures:

-- Reorient or relocate the receiving antenna.

-- Increase the separation between the equipment and receiver.

-- Connect the equipment into an outlet on a circuit different from that to which the receiver is connected.

-- Consult the dealer or an experienced radio/TV technician for help.

Caution: changes or modifications not expressly approved by the party responsible for compliance could void the user's authority to operate the equipment.