

Fast Wireless Charging Holder Instructions

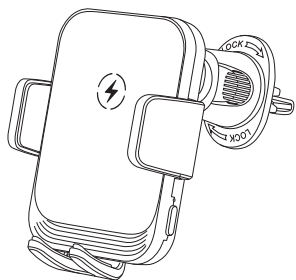

Please read the instructions carefully before using

Features:

- Car holder with wireless charging function, charges your phone conveniently when driving.
- Power output 5W/7.5W/10W/15W, compatible with all phones with Qi standard.
- Full 360 degrees rotation for perfect viewing angle.
- Start charging once as the phone contact with the holder, no need plug cable in the phone.
- Auto-Adjusted foot support helps you align to the charging center automatically.

Parameters:

- Air vent mount

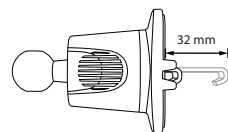

- Charging Cable

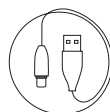

- Wireless charger holder

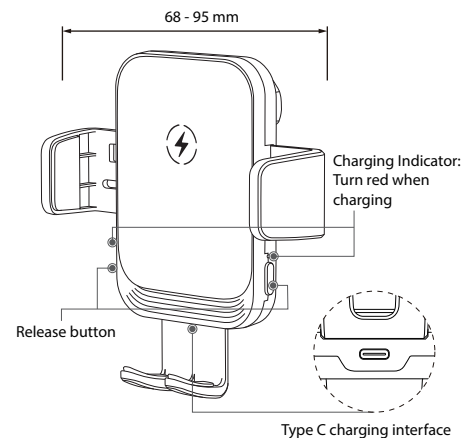

Product specification:

Wireless charger holder:	
Voltage	5V/2A 9V/2.2A
Output	15W (Max)
Charging frequency	115K - 205KHZ
Induction Distance	1-5mm
FCC ID	2BDOG-TAC-151

LED Mode:

Working state	LED light color
Power transfer	Red, blue, red blue light flash once, then off
Standby mode	The light is not bright
Charging	The red light stays on for a long time
FOD Warning	Flashing red light

Compatible devices:

- Work well with all Qi enabled devices including:
iPhone 16, iPhone16 Pro Max, iPhone16 Pro, iPhone 15, iPhone15 Pro Max, iPhone15 Pro, iPhone 14, iPhone14 Pro Max, iPhone14 Pro, iPhone 13, iPhone13 Pro Max, iPhone13 Pro, iPhone13 mini, iPhone 12, iPhone12 Pro Max, iPhone12 Pro, iPhone12 mini, Samsung Note 8, Note 9, iPhone XS MAS, Huawei P30 Pro, MIUI9, Samsung S10+, iPhone 8Plus, Samsung S9+, Samsung S8+, iPhone XR, Samsung S10, Samsung S7edge, Samsung S8, iPhone XS, iPhone X, Samsung S9, iPhone 8, iPhone 11, iPhone SE, Samsung S24, Samsung S23, Samsung S22, Samsung S21, Samsung S20
- Qi disabled devices with wireless receiver or wireless charging case.
(Require receiver compliant with WPC Qi standard to match).

Instructions:

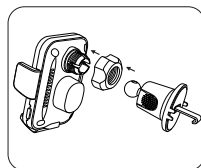

1. Insert the adjuster into ball joint of air vent mount, insert the ball into the socket at the back of bracket, turn the adjuster to tighten.

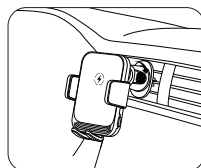

2. Insert the hook into the car air outlet vane and tighten to lock. when you hear 'clatter' sounds, it means the mount has been fixed tightly.

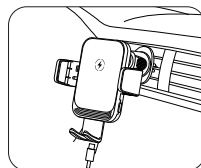

3. Connect the charging cable to the charging interface, press the release buttons in the side then the clamp arms and foot support will open automatically.

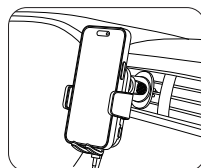

4. Place your device into the bracket, and clamp arms and foot support will lock it automatically then start to charge.

Attentions:

1. Please use the product correctly according instructions.
2. Please do not disassemble the product or throw it to fire and water, to avoid leakage that caused by electrical short circuit.
3. Please do not use wireless charger in high temperature, wet, corrosive environment, to avoid leakage that caused by damaged circuit.
4. Please do not put wireless charger close to cards with magnetic stripes or chips (ID card, credit card etc.) to avoid demagnetization
5. Please keep wireless charger at least 20 CM distance away from implantable medical device (heart pacemaker, Implantable cochlea etc.) to avoid potential interferences.
6. Please do safekeeping, do not let your kids treat wireless charger as toy to avoid unwanted accidents.

The pictures only supplies the reference, please take the actual product as the standard.

FCC Statement

FCC ID: 2BDOG-TAC-151

FCC WARNING: This device complies with part 15 of the FCC Rules. Operation is subject to the following two conditions: (1) this device may not cause harmful interference, and (2) this device must accept any interference received, including interference that may cause undesired operation.

Any changes or modifications not expressly approved by the party responsible for compliance could void the user's authority to operate the equipment.

NOTE: This equipment has been tested and found to comply with the limits for a Class B digital device, pursuant to Part 15 of the FCC Rules. These limits are designed to provide reasonable protection against harmful interference in a residential installation. This equipment generates, uses and can radiate radio frequency energy and, if not installed and used in accordance with the instructions, may cause harmful interference to radio communications. However, there is no guarantee that interference will not occur in a particular installation.

If this equipment does cause harmful interference to radio or television reception, which can be determined by turning the equipment off and on, the user is encouraged to try to correct the interference by one or more of the following measures:
-- Reorient or relocate the receiving antenna.
-- Increase the separation between the equipment and receiver.
-- Connect the equipment into an outlet on a circuit different from that to which the receiver is connected.
-- Consult the dealer or an experienced radio/TV technician for help.

The equipment complies with FCC Radiation exposure limit set forth for an uncontrolled environment. The equipment should be installed and operated with a minimum distance of 20cm between the product and your body.