

SWISS TECH

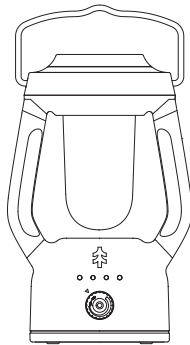

HANGEN

Bluetooth Speaker + Lantern

MORE THAN A LANTERN

RECHARGEABLE
**1000
LUMENS**



MORE THAN A LANTERN

HANGEN

Bluetooth Speaker + Lantern

The Swiss Tech Hangen Bluetooth Speaker and LED Lantern is a classic lantern, reimagined. Inspired by the timeless look of original lanterns, the Hangen merges classic style with modern innovation to bring you the best possible light. Powered by a re-chargeable lithium-ion battery, the long-lasting LEDs provide a massive 1000 lumens. With the dimmable knob, you can brighten or dim the lighting to match the mood of your surroundings. At the highest of settings, you reach an astounding 98-feet (30-meter) range of visibility. The Hangen is a striking IPX4 weather proof device so you are prepared for any situation your adventures throw at you. The durable construction provides additional reliability and strength. The top handle swivels for versatile hanging and comfortable handling. It also collapses for easy storage and transport. Designed specifically with your needs in mind, the lantern brings modern convenience in a single solution. Beyond the light, the Hangen features a quality Bluetooth speaker to have your music always with you. It also boasts a convenient 4000 mah power bank for charging everything from your phone to your flashlight with a universal USB port. For added convenience, you can still utilize all features of the lantern while it is plugged in and charging. Whether you're hitting the trails or preparing your home, the Swiss Tech Hangen Lantern brings the style and functionality you need and want.

Swiss Tech Hangen Bluetooth Speaker and LED Lantern
Vendor Stock Number: 30800

Questions, problems, or missing parts?
Before returning to the store, contact
GreatStar Customer Service
9AM-4PM CST, M-F
Call: 479-802-3580 or Email: Help@greatstar-us.com

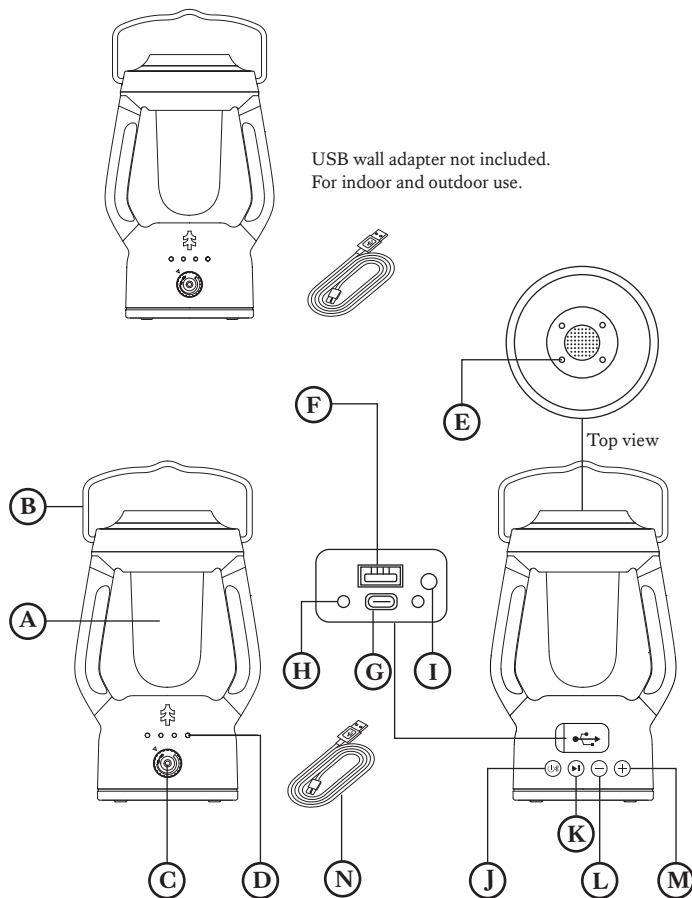

CONTENT

PART	DESCRIPTION	QUANTITY
A	LED Light	1
B	Stainless Steel Handle	1
C	Dimmable Knob	1
D	Battery Indicator Light	4
E	Bluetooth Indicator Light	4
F	Output Recharging Port	1
G	Input Charging Port	1
H	Input Charging Indicator	1
I	Output Recharging Indicator	1
J	Bluetooth Speaker Power Button	1
K	Play/Pause Button	1
L	Volume-	1
M	Volume+	1
N	Charging Cable	1

WARNING

- Read all instructions before using this lantern.
- This product is water resistant, not waterproof.
- Never modify the product or any of its parts as this may result in serious personal injury.
- This lantern is not intended for use in potentially dangerous locations such as places with explosives or flammable atmospheres.
- Never look directly into the light sources/LED chips as they are extremely bright and may cause eye damage from prolonged exposure.
- Place lantern away from any heat source.
- The white lampshade may get hot during use. To avoid the risk of burns, do not touch it.
- Do not place anything on top of the lantern during or after each use to prevent potential fire.
- Never use this lantern if the white protective lampshade is damaged or removed.
- Do not wash lantern with water or allow water to get inside light.
- Keep this lantern away from children.
- Store lantern in temperatures below 86°F.
- Keep lantern dry, clean and free from oil and grease.
- Do not leave the lithium-ion battery powered unit in direct sunlight.

SAFETY INFORMATION

- Never use this lantern around flammable liquids such as gasoline.
- To avoid electrical shock, do not put lantern in water or any other liquids.
- Do not store lantern where it can easily fall into tub/sink/pool of water.
- Do not handle this lantern or try to plug this in while your hands are damp or wet.
- Do not operate this lantern after it has malfunctioned.
- Always make sure the power source conforms to the rating on this fixture. Hence, this lantern light must always be used in accordance with all electrical and safety codes and ordinances, including the most recent National Electric Code (NEC) and with the Occupational Safety and Health Act (OSHA) Volume 1 on General Industry Standards and interpretations.
- Do not use or permit use of lantern in beds or sleeping bags as this fixture can melt fabric and may result in burn injury.

FCC STATEMENT

This equipment has been tested and found to comply with the limits for a Class B digital device, pursuant to Part 15 of the FCC Rules. These limits are designed to provide reasonable protection against harmful interference in a residential installation. This equipment generates uses and can radiate radio frequency energy, and if not installed and used in accordance with the instructions, may cause harmful interference to radio communications. However, there is no guarantee that interference will not occur in a particular installation. If this equipment does cause harmful interference to radio or television reception, which can be determined by turning the equipment off and on, the user is encouraged to try to correct the interference by one or more of the following measures:

- Reorient or relocate the receiving antenna.
- Increase the separation between the equipment and receiver.
- Connect the equipment into an outlet on a circuit different from that to which the receiver is connected.
- Consult the dealer or an experienced radio/TV technician for help.

This device complies with part 15 of the FCC Rules. Operation is subject to the following two conditions:

- This device may not cause harmful interference.
- This device must accept any interference received, including interference that may cause undesired operation.

CAUTION

Changes or modifications not expressly approved by the party responsible for compliance could void the user's authority to operate the equipment.

ELECTRICAL INFORMATION

The charging cable is compatible with any USB wall adapter that has an output of 5V/2A.

- To ensure proper charging, use the enclosed USB charging cable.
- Pull by plug rather than cable when disconnecting work light to avoid damage to electric plug and cable.

SPECIFICATIONS

Product Weight	864g	Charging Cable	40-inches
Product Width	6.5-inches	Mode	Dimmable
Product Depth	5.5-inches	Run Time	3 hours or more
Product Height	10.2-inches	Recharge Time	3 to 5 hours
Rated Voltage	Input/Output:5V, 2A	Lumen Output	1000LM, dimmable
Power	13W	Impact Resistance	3-feet



OPERATING HEADLAMP

- Fully charge the lantern before turning on.
- Rotate the Dimmable Knob to turn on the lantern and adjust the brightness.
- Press the Bluetooth Speaker Power Button to turn on the Bluetooth Speaker.
- Press the Volume – button to decrease music volume.
- Press the Volume + button to increase music volume.
- Press the Play/Pause button to stop and start music at any time.

RECHARGING THE BATTERY & CHARGING FOR OTHER DEVICE

- Battery charging indicator is red when charging and is green when fully charged.
- Battery charging indicator is blue when USB output is used to charge other devices.
- USB port cannot be used while the lantern is recharging, but the Bluetooth speaker remains functional.
- If the lantern is fully charged, it can light up, play music and charge other devices.
- When the battery is completely drained, the lantern will take about 3-5 hours to fully charge.



BLUETOOTH FUNCTION

- Built for playing music on the go with compatible devices.
- Be aware that the Bluetooth connection range is 10 meters.
- With the lantern in stand-by mode, press and hold the Power/Bluetooth button  to select Bluetooth mode. It will sound a prompt tone, and 4 blue indicator lights on top flash quickly. The lantern is now ready to pair with your cell phone.
- Turn on the Bluetooth feature of your cell phone and turn down the volume to avoid sudden loud sound bursts from the speaker. Enable the search or scan feature to find the BT-SPEAKER. Note: If you have more than one lantern within range, make sure you are connecting to the appropriate speaker.
- Select "BT-SPEAKER" from the device list when it appears on your cell phone screen.
- After successfully pairing your cell phone with the lantern, the 4 blue indicator lights on top stop flashing and remain turned on and you will hear a prompt tone. You can now play music from your cell phone wirelessly to the light. Note: If you want to connect the lantern to another cell phone after pairing successfully, then you need to turn off the Bluetooth on the paired cell phone firstly if it is in range before going through the above steps. Otherwise, the light will automatically reconnect to the previously linked cell phone.
- Press the VOLUME +/- button to adjust the volume level.
- Long-press the Power/Bluetooth button  to turn off Bluetooth mode. The 4 blue indicators on top will turn off. Don't forget to also turn off the Bluetooth feature on your cell phone.

Note:

- If the Bluetooth speaker is left idle, whether paused or otherwise, it will stay in standby mode while device is in range. If the speaker is idle for 10 minutes, the lantern will shut off for power saving.
- Bluetooth mode operates normally while lantern is powered on, charging and recharging.
- If you receive a phone call while playing music on the speaker, the Bluetooth speaker function would be paused. After your phone call is complete, the Bluetooth speaker would continue from the last pause.

If the Bluetooth speaker is not working:

- If Bluetooth indicators quickly flash, go back to be within range, both cell phone and lantern will link automatically.
- If Bluetooth indicators remaining turned on, press  button to restart the Bluetooth mode.
- If Bluetooth indicators are off, press the  to re-link (pair) your cell phone manually.

CARE AND MAINTENANCE

- Always keep the battery fully charged when not in use.
- Do not subject the unit to excessive force, shock, dust or extreme temperatures.
- Do not tamper with the external or internal components of the unit.
- Clean your unit with a dry cloth. Solvent or detergent should never be used.
- Avoid leaving your unit in direct sunlight or in hot, humid or dusty places.
- Keep your unit away from heating appliances and sources of electrical noise such as fluorescent lamps or motors.

TROUBLESHOOTING

If the lantern does not work, check the following:

- Fully charge the lantern before first use.
- Ensure the cord is properly plugged into the power source to charge the battery.
- The battery may be depleted, allow the lantern to charge for about 3 to 5 hours.
- Make sure the lantern is powered on by rotating the dimmable knob.

WARRANTY

This lantern is backed with a two-year limited warranty to the original purchaser. This warranty covers against defects in material and workmanship under normal use. This warranty does not cover against abuse, improper use, failure to follow directions, neglecting, and ordinary wear and tear.