

**GSM/GPRS/WCDMA Mobile Phone  
User Guide  
GQ3083**

## Contents

2 CAUTIONS ON MOBILE PHONE USE	5
2.1 INTERFERENCE	5
2.2 REASONABLE USE	5
2.3 QUALIFIED MAINTENANCE SERVICE	5
2.4 WATER-RESISTANCE	5
2.5 EMERGENCY CALLS	5

3 PRECAUTIONS FOR USE OF BATTERY	5
4 CAUTIONS FOR CHILDREN	5
II. KEYS AND PARTS	6
III. START TO USE	7
1 INSERT SIM CARD	7
2 INSERT MEMORY CARD	7
3 CHARGE THE BATTERY	8
IV. BASIC FUNCTIONS	8
1 LOCK AND UNLOCK THE SCREEN	9
2 MAKE IT YOURS	10
4 MAKE A CALL	17
5 CALL LOG	18
6 ANSWERING PHONE CALLS AND REJECTION	19
7 ADD A CONTACT	20

8 SEND AND RECEIVE MESSAGE(S)	21
9 BROWSER THE WEB	23
10 ENJOY MUSIC	24
11 DOWNLOAD APPLICATIONS FROM PLAY STORE	25
12 MANAGE APPLICATIONS	26
13 APPLICATIONS & UTILITIES	27
14 SETTINGS	28
VI. TECHNICAL INFORMATION	31

.

.

## **2 Cautions on mobile phone use**

### **2.1 Interference**

All phones may be interfered, which affect phone calls.

### **2.2 Reasonable use**

Use only in the normal position. Do not touch the antenna area unnecessarily.

### **2.3 Qualified maintenance service**

Only qualified personnel may install or repair this product.

### **2.4 Water-resistance**

Your device is not water resistant. Keep it dry.

### **2.5 Emergency calls**

Ensure the phone is switched on and in service. Enter the emergency number and press the Dial icon.

### **3 Precautions for use of battery**

**3.1** Do not dispose of batteries near or in a fire to avoid dangers.

**3.2** Do not dispose of batteries in the garbage. Dispose of batteries to assigned battery recycling center.

### **4 Cautions for children**

Keep your device out the reach of children in case of accidental injury caused by incorrect use of the device as toys.

## **II. Keys and parts**

- **1. Light sensor / rang sensor**
- **2. Front Camera**
- **3. Receiver**
- **4. Audio jack**

- **5. Adjust volume key**  
Short press on the Power key shall lock the screen and a long press on the Power key shall switch on/off the device.
- **6. Power key**
- **7. LCD**
- **8 Rear Camera**
- **9. Flashlight**
- **10. Fingerprint**
- **11. MIC**
- **12. USB connector**
- **13. Speaker**

### **III. Start to use**

#### **1 Insert SIM card**

The phone is a Dual SIM mobile phone allowing you to use the facility of two networks.

To insert SIM card(s):

Insert the SIM card correctly in the card slot(s), suggest switch off the phone when you insert SIM

card.

## **2 Insert Memory card**

Insert the Micro SD card into the slot with the correct direction, suggest switch off the phone when you insert SIM card.

Note: Use only compatible memory cards with this device. Incompatible memory cards may damage the card or the device and corrupt the data stored in the card.

## **3 Charge the battery**

During charging, the battery indicator on the phone is a thunder icon. If the device is switched off during charging, there will still be a charging indication on the screen that shows the phone is being charged. If the device is overused when the battery is low, the charging icon might take some time to appear.

When the battery indicator on the screen says 'Battery is full', thunder icon will disappear, which means the completion of charging. If the phone is switched off during charging, the screen will display ' Battery is full '. It generally takes 4 hours to charge the battery. During charging, the battery, the device and the charger will get hot. This is normal.

Unplug the charger from the AC electrical outlet and disconnect the wiring between the phone and the charger after charging. .

**Cautions:** Charge the phone in a well ventilated place in which the temperature is between -10°C to +55°C. Use the charger provided by the manufacturer only. The use of unconfirmed charger may lead to dangers and violate the manufacturer's warranty clause. If the temperature is too high or too low during charging, the device will automatically send a warning and stop charging to avoid damage to the battery or any danger.



## **IV. Basic functions**

### **1 Lock and unlock the screen**

Press power button to enter Sleep mode and meanwhile the screen will be locked; press power button again to wake up and then drag to up direction for unlock.



## **2 Make it yours**

1. Home screen: It is your starting point to access all the features on your phone. It displays application icons, widgets, shortcuts, and other features. Long press home screen and Modify Wallpaper



2. Long press Home screen, and then you can Modify Wallpaper; or enter Launcher and long press and hold an application till the screen vibrates, and then release your finger hold.



Long press and hold the widget or icon you want to move. Once the phone vibrates, don't release your hold on the icon. Drag the widget or icon to a new location on the screen Press and hold on an icon till the phone vibrates, and drag the widgets or icon to the trash to remove!



Scroll left desktop interface can enter the rest of the application



3. Notification Bar: At the top of the screen, the Status Bar displays the time, status, and notifications. If there is a new message, missed call or something in the notification bar, you can drag it down to open notification panel and click the desired one to have a view. When you finished, you can close it by dragging the panel up or pressing “Back”



4. If you connect your phone to PC via USB, you can find the USB options, choose Media device (MTP) option you can see your phone memory in PC, this is same function like USB storage,

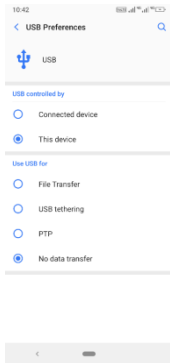
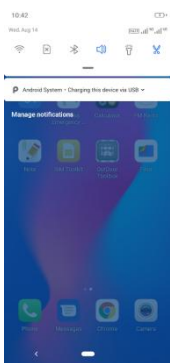

5. Switch to Recently Used Application  
Swipe up from the navigation bar.



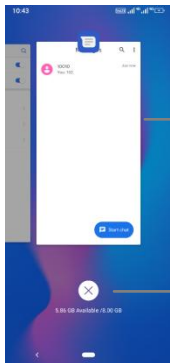

Touch this icon to  
close al Touch and  
slide this place can  
choose to open the

Touch this icon to  
close all history  
application Touch and  
slide this place can

#### 4 Make a call

Click  and enter a complete phone number to make a call. Your phone supports smart search.

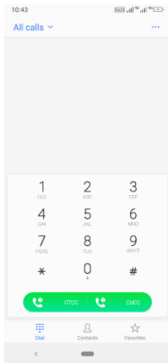

Swipe to right to view Favorite, Call history and Contacts.

## 5 Call log

press the number, you can call back, view contact details etc.

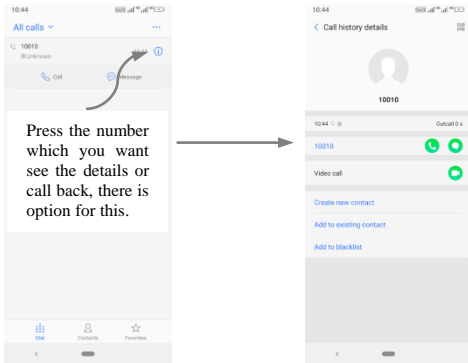

## 6 Answering phone calls and rejection

Although there is a call, you can choose to answer or hang up directly.

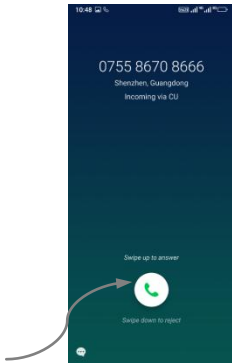

Drag the icon, select the icon to select the answer or hang up.

## 7 Add a contact

Touch  to enter contact

Touch  to add new contact

Click here to add new contact and in this page press menu key to enter menu view, setting,etc.

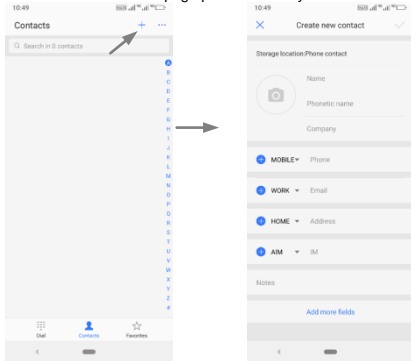

## 8 Send and Receive message(s)

Touch  enter messaging, touch compose new message.

When you are composing a new text message, you can select text for cutting or copying. The

selected text is highlighted in green.



Tap this icon to select desired contact from phone book.



Touch to switch the digital input and symbols

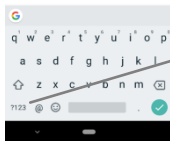

Press space or a punctuation mark to enter the highlighted suggestion

Tap  to add "Attach" including Pictures, Videos, Audios, etc to send MMS. When a new message comes, you can read by dragging notification panel and click the message, or entering Message to read it directly.

Long press one of the all message threads, you can delete thread".

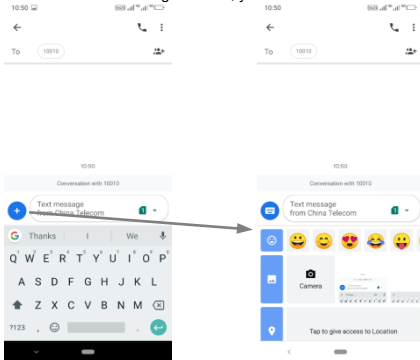

## 9 Browser the Web

1. Set up Internet/Data connection

Enter Settings > More..., scroll down to find out Mobile network, and then enter "Access Points Names, choose the desired WAP account.

## 2. Switch on Data connection or Wi-Fi

To browse the web, you need to switch on Data connection. If there is Wi-Fi around, you can switch on Wi-Fi to use it browse the web.

## 10 Enjoy music

When you copy music to your SD card, the Music player searches the card for music files and builds a catalog of your music, based on information about each file that is stored in the file itself.



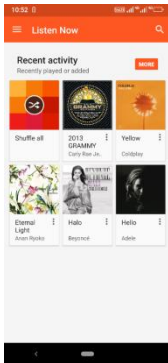

## 11 Download applications from Play Store

1. Add Google account
2. Enter play store and download apps

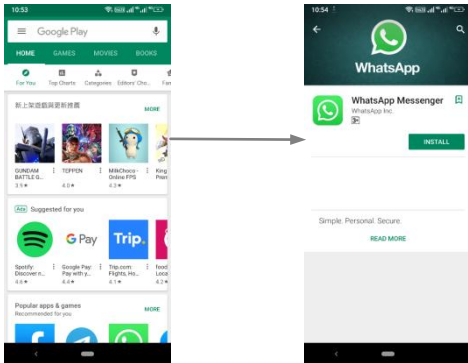

## 12 Manage Applications

Enter Setting > App.

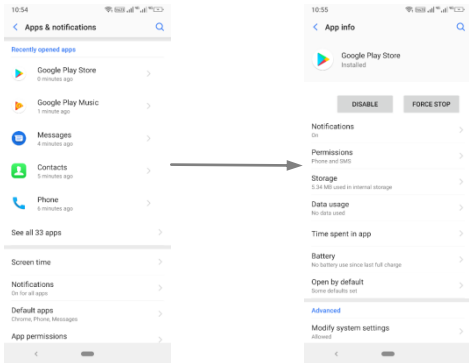

You can see app info.

## 13 APPLICATIONS & UTILITIES

For your entertainment purpose, your device is provided with several interesting games, applications and utilities, such as Gmail, Email, Play store. Please ensure that you have GPRS setting in your device to access the applications. Contact your operator for GPRS settings.

***Tips:*** *With connection to Wi-Fi network, this application can run normally, too.*

## **14Settings**

### **14.1Wi-Fi**

Open Wi-Fi, search nearly Wi-Fi and connect it, then you can use internet or download apps for free.

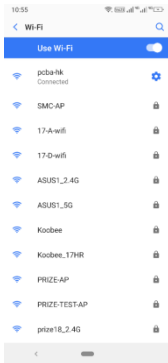

## 14.2 Bluetooth

Open Bluetooth, connect to other phone, you can share something like music, photos, movies etc to other people

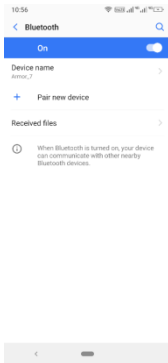

### 14.3 Security

#### Screen lock

There are four screen lock you can choose Slide, Pattern, PIN, Password.

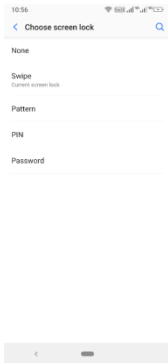

## VI. Technical Information

Model:

Size Length:

Battery:

Networks:

SAR Value:

GSM:

Weight:

Nominal voltage:

Max. Voltage:

Capacity rating:

Continuous standby time:

Continuous calling time:

Operation Temperature:

Discharge:

The operation time of the battery depends on conditions such as:



- Transmitting power level
- Signal (distance between the phone and the base station)
- Network parameters defined by the operator
- Phone use (WAP, games, SMS)
- Charging procedure used

## **FCC compliance statement**

This device complies with part 15 of the FCC Rules. Operation is subject to the following two conditions:

- (1) This device may not cause harmful interference, and
- (2) this device must accept any interference

received, including interference that may cause undesired operation.

**Note:** This equipment has been tested and found to comply with the limits for a Class B digital device, pursuant to part 15 of the FCC Rules. These limits are designed to provide reasonable protection against harmful interference in a residential installation. This equipment generates uses and can radiate radio frequency energy and, if not installed and used in accordance with the instructions, may cause harmful interference to radio communications. However, there is no guarantee that interference

will not occur in a particular installation. If this equipment does cause harmful interference to radio or television reception, which can be determined by turning the equipment off and on, the user is encouraged to try to correct the interference by one or more of the following measures:

- Reorient or relocate the receiving antenna.
- Increase the separation between the equipment and receiver.
- Connect the equipment to an outlet on a circuit different from that to which the receiver is connected.

- Consult the dealer or an experienced radio/TV technician for help.

**Important:** Changes or modifications to this product not authorized by Shenzhen Gotron Electronic CO.,LTD. could void the electromagnetic compatibility (EMC) and wireless compliance and negate your authority to operate the product.

This product has demonstrated EMC compliance under conditions that included the use of compliant peripheral devices and shielded cables between system components. It is important that you use compliant peripheral

devices and shielded cables between system components to reduce the possibility of causing interference to radios, televisions, and other electronic devices.

**SAR Statement:**

This Mobile Phone meets the government's requirements for exposure to radio waves. The guidelines are based on standards that were developed by independent scientific organizations through periodic and thorough evaluation of scientific studies. The standards include a substantial safety margin designed to assure the safety of all persons regardless of

age or health.

FCC RF Exposure Information and Statement  
the SAR limit of USA (FCC) is 1.6 W/kg  
averaged over one gram of tissue. Device types:  
GQ3083 (FCC ID: 2AOWKGGQ3083) has also  
been tested against this SAR limit. This device  
was tested for typical body-worn operations with  
the back of the handset kept 10mm from the  
body. To maintain compliance with FCC RF  
exposure requirements, use accessories that  
maintain a 10mm separation distance between  
the user's body and the back of the handset.  
The use of belt clips, holsters

and similar accessories should not contain metallic components in its assembly. The use of accessories that do not satisfy these requirements may not comply with FCC RF exposure requirements, and should be avoided.