

- 1.2. Place the record on the felt mat so that the center hole aligns with the spindle.

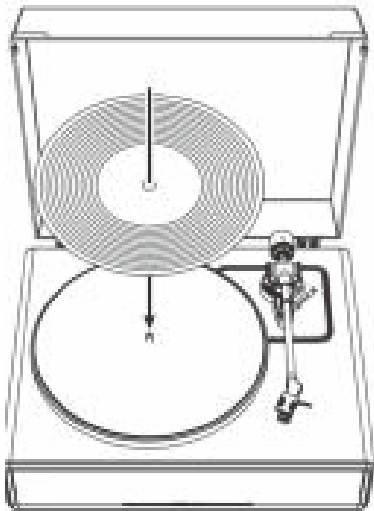

2. Turntable Operation

Sufficiently lower the volume of the amplifier and speakers first.

- 2.1. Connect the included power adapter to the turntable, power on this unit by the power switch at the back side. Turn the power& volume knob to turn on this unit. The indicator will light in red.
- 2.2. Remove the stylus protector from the stylus.
- 2.3. Place the record on the slip mat.
- 2.4. Switch the function knob to choose 33 or 45 RPM speeds according to the type of record.
- 2.5. Unlock the tonearm clip and set the tonearm lift lever to the up position.
- 2.6. Position the tonearm over the desired location (groove) on the record. The platter will start turning automatically.
- 2.7. Carefully lower the tonearm on the record by setting the tonearm lift lever to the down position.
- 2.8. Turn up the volume of the turntable as needed.
- 2.9. When you are finished playing the record, raise the tonearm, return it to rest on the arm clip and press the ON/OFF switch at the back side to turn off the turntable.

- 2.10. The platter will stop turning if there is no sound output from the speakers in 3 minutes. Get the tonearm back to the arm rest and repeat the process 2.6 if you want to play the record again.

Bluetooth Operation

Bluetooth Receiver

1. Connect the included power adapter to the turntable and power on this unit, the indicator will light in red.
2. Switch the function knob to Bluetooth mode. The indicator light turns blue and flash quickly. You will hear an activation sound from the turntable.
3. Turn on the Bluetooth feature of your media device and search for and select "XJ-H01" to pair the media device and turntable.
- 4.

Once your media device is successfully paired with the turntable, the turntable will play a short confirmation sound.

5. Play and stream music from your media device to the turntable. The indicator light will become solid blue.

Note: Bluetooth version: 5.0

“This product has a Bluetooth **reception** function, **you can not transmit any Bluetooth sound with it**: this means that you can receive wirelessly a Bluetooth sound signal from an external source like a smartphone.”

AUX-IN Operation

This turntable includes an auxiliary audio signal input jack for connecting external audio devices like MP3 players, CD players, and older, non-dockable iPods, so you can listen to your external source through the turntable's speakers.

1. Use an audio cable (not included) with one 3.5 mm stereo connection on each end of the cable.
2. Plug one end into the AUX-IN jack on the turntable and the other end to the Line Out jack of the audio device.

3. Power on the turntable and audio device. The indicator light of turntable is red.
4. The volume level can be controlled through the turntable.

Operate all the functions on the auxiliary device as usual.

5. Please note that AUX-IN function is a first-priority function. Even if the indicator light for PHONO/BT is on, these functions won't work while the AUX-IN function is in use. Please unplug the AUX-IN cable before using the PHONO/BT functions.

NOTE:

1. Make sure the tone arm is securely locked to avoid any damage.
2. When you are done, don't forget to turn off the power on the turntable and your external device.

Care

Turntable Body

- When the turntable body is dirty or dusty, first disconnect the AC adapter and then wipe off the dirt and dust with a soft, dry cloth.
- Do not use benzenes, thinners, etc.
- When storing the product for a long time, disconnect the AC adapter from the outlet and wrap the product in plastic; do not allow it to become damp; the drive belt should be removed to prevent unequal stretching.

Stylus Tip

- If dirt and grime are stuck to the stylus tip, clean it with a commercially sold brush.
- We recommend using a stylus cleaner (not included) if the stylus tip is considerably dirty. Clean the stylus tip by moving the brush from the rear to the front of the stylus tip.

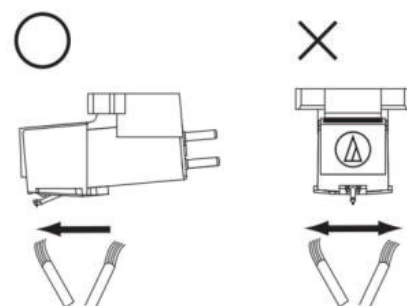

Replacing the Stylus

It's suggested to replace the stylus after 400 hours of use.

Removing the Stylus

- In addition to the deterioration of sound quality, records may also be damaged as the cartridge's stylus tip wears down.
- Be sure to disconnect the product's AC adapter from the outlet.
- When replacing the stylus, hold the headshell and the cartridge body tightly. Rotate the front of the stylus in a forward and down motion.

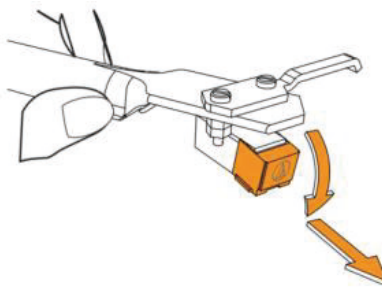

Installing a New Replacement Stylus

1. Mount the new replacement stylus to the cartridge.

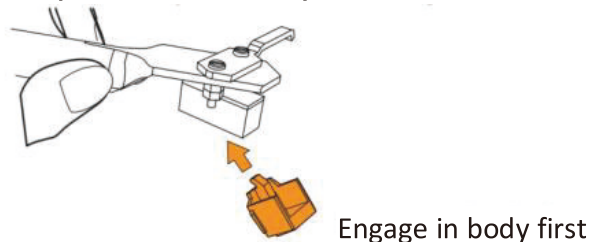

2. Lift the stylus up until you hear a click.

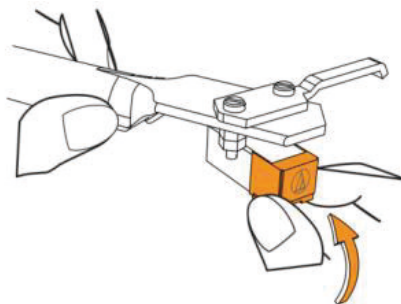

3. Make sure there is no gap between the headshell and the cartridge.

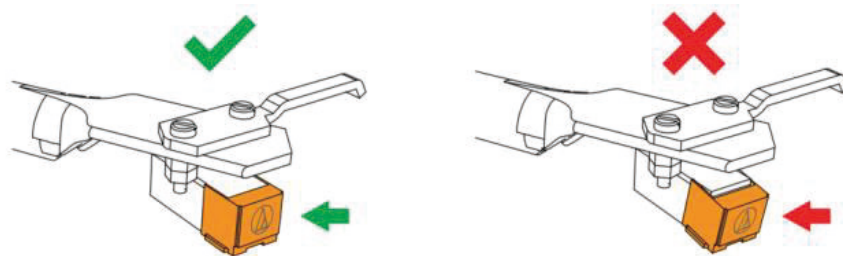

Replacing the Belt

- The belt is a consumable part. Replace the belt if the speed of playback slows down or irregular rotation occurs. As a rule of thumb, we suggest replacing the belt once a year.
- Before replacing the belt, be sure to disconnect the product's AC adapter from the outlet.

1. Remove the slip mat.

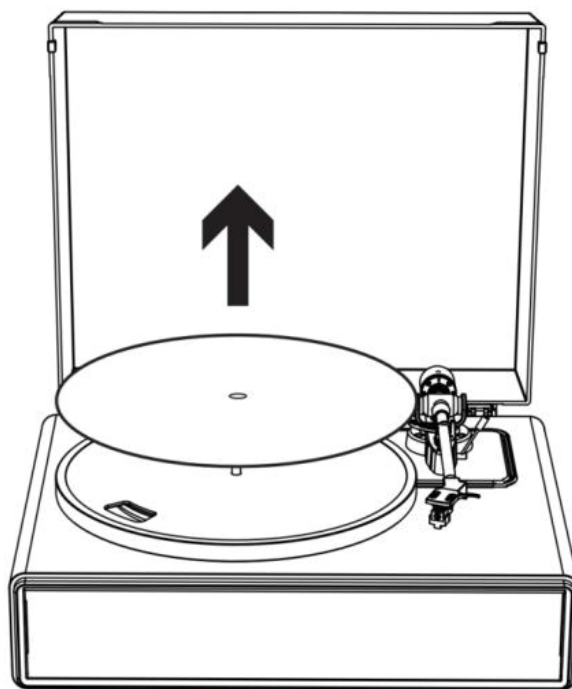

- 2. Remove the belt from the motor pulley.**

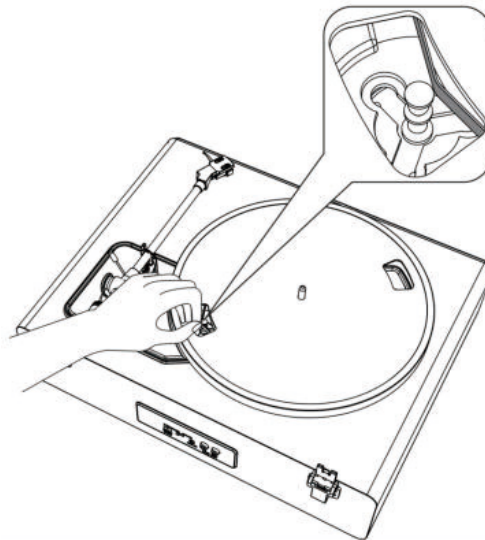

- 3. Remove the main platter and then remove the old belt.**

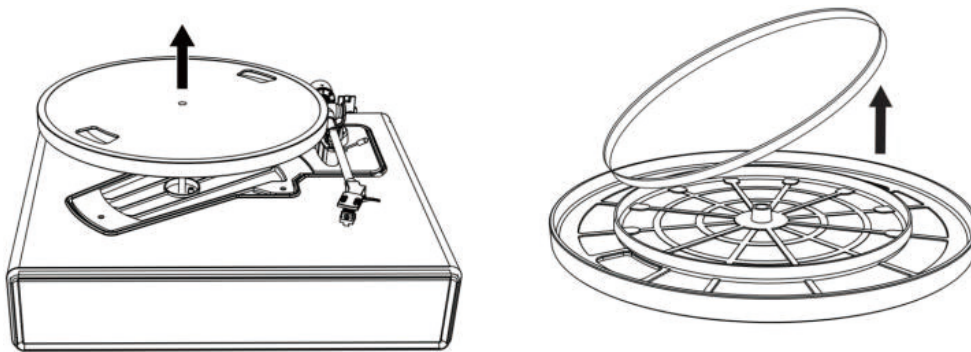

- 4. Turn the platter over and you will see a raised circle. Loop the new belt along the middle circle.**

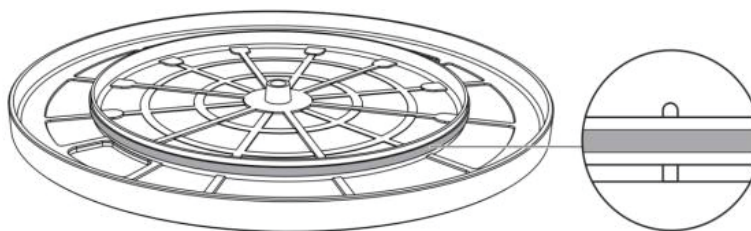

5. Attach the platter.

Align one of the openings with the position of the brass-colored motor pulley.

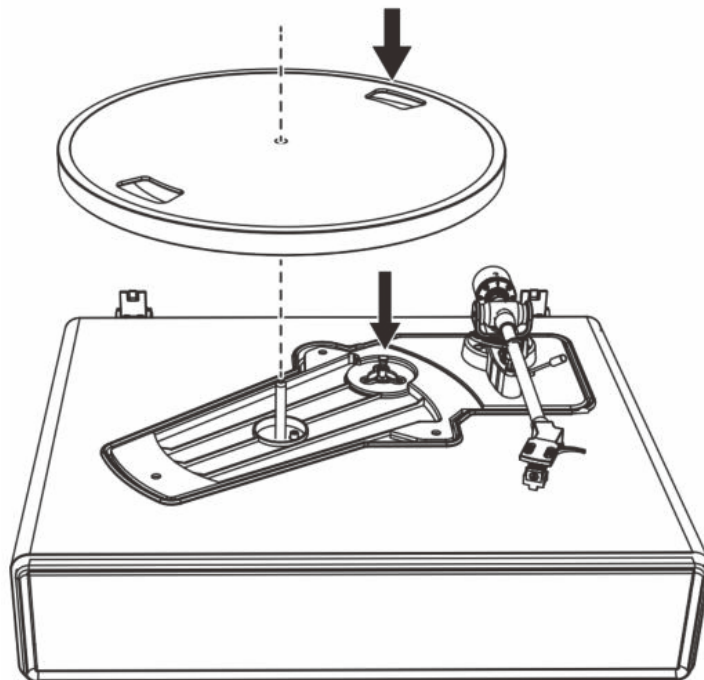

6. Place the belt on the brass-colored motor pulley

Grasp the belt that was attached in step 4 and, while pulling it, place it on the brass motor pulley.

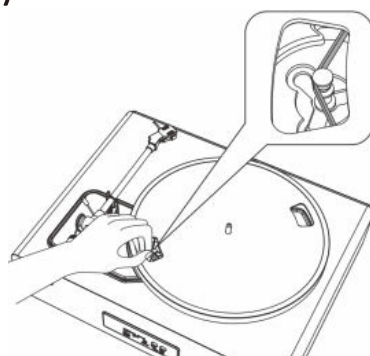

7. Using your hands, slowly rotate the platter ten times in a clockwise direction as shown by the arrow below.

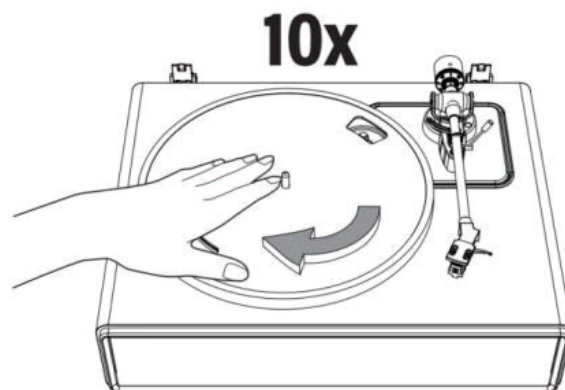

When the Turntable is Moved

Using the product's original packing materials, wrap the turntable in the reverse order from when you unwrapped it. If you do not have the packaging materials, take the following measures:

- After disconnecting the AC adapter from the outlet, remove the felt mat and platter, and then wrap them so that they do not get damaged.
- Attach the protector to the cartridge.
- Use a string or something similar to tie the tonearm to the rest so that it does not become dislodged.
- Wrap the turntable body with paper or a soft cloth so that it does not get damaged.