

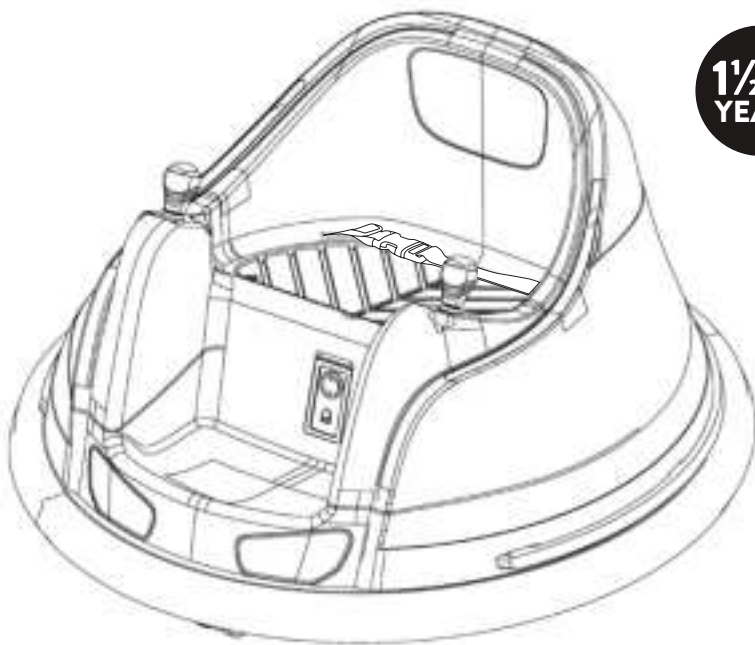

Flybar®

12V RIDE ON BUMPER CAR

ITEM #1752490



**1½-4
YEARS**

⚠ ATTENTION

This product is packed with the battery disconnected. Connect the battery before use.

⚠ ATTENTION

Adult assembly required.

⚠ WARNING

This manual contains important safety and use information. Keep this manual for future reference.

- An adult must read this entire manual
- Adult supervision is required at all times





IMPORTANT SAFETY INFORMATION

DANGER (ELECTRICAL HAZARD)

* To prevent electric shock, do not immerse in water; wipe clean with a damp cloth.

WARNING

PREVENT FIRE

- Never modify the electrical system. Alterations could cause a fire resulting in serious injury and could also ruin the electrical system.
- Use of the wrong type of battery or charger could cause a fire or explosion resulting in serious injury.
- Use of Flybar® components in products other than Flybar® vehicles could cause overheating, fire or explosion.
- The battery must be handled by adults only. The battery is heavy and contains sulfuric acid (electrolyte). Dropping the battery could result in serious injury.
- Never allow children to charge the battery. Battery charging must be done by adults only. A child could be injured by the electricity involved in charging the battery.
- Never lift or carry the battery by the wires or connector. This can damage the battery and possibly cause a fire resulting in serious injury. Lift and carry the battery by the case only.
- Read the safety instructions on the battery.
- Examine the battery, charger and their connectors for excessive wear or damage each time you charge the battery. If damage or excessive wear is detected, do not use the charger or the battery until you have replaced the worn or damaged part.
- Hot motors. Handle carefully.

WARNING

PREVENT INJURIES AND DEATHS

- Direct adult supervision required
- Never ride at night
- Keep children within safe riding areas.

These areas must be:

- Away from swimming pools and other bodies of water to prevent drownings
- Generally level to prevent tip overs
- Away from steps, steep inclines, cars, roads and alleys

Riding rules:

Make sure children know and follow these rules for safe driving and riding.

- Always sit on the seat
- Always wear shoes.
- Only 1 (one) rider at a time





SAFETY INSTRUCTIONS

READ ALL INSTRUCTIONS BEFORE USE

- To protect against electrical shock, do not immerse charger/transformer, battery or the product in water or other liquid. Do not use outside if raining or snowing.
- Only use the included charging adapter provided.
- This toy is not intended for children less than 18 months.
- Adult supervision is necessary when your children are using this product.
- Disconnect the battery if this toy won't be used for a long time.
- Personal protective equipment such as a helmet is needed when using this toy.
- Do not use this toy on a public road, by a swimming pool or near any stairs.
- Do not use this toy on a slippery surface, sand or mud.
- Always keep hands, hair and clothing away from moving parts.
- Maximum weight of child is 66 lbs / 30 kg.
- Only one child should ride on this toy at a time.
- Do not change, modify or add any electrical wiring on this toy.
- Do not use this toy in the dark. Only operate during daytime or well lit areas.
- For your child's safety, please make sure to fasten the seat belt when using this toy.

PRODUCT SPECIFICATIONS

Motor:

2 @ 15 Watts

Battery:

2 @ 6 Volts DC, 4 Ah

Charger:

14.5 Volts 500 Ma

Max Speed:

1.7 mph (2.8 km/h)

Suitable Age:

18 Months to 4 Years

Maximum user weight:

66 Lbs (30 Kg)

Dimensions:

25.7" x 25.7" x 15.7"

Battery charge time:

8-12 hours (maximum charge time: 20 hours)

***ATTENTION: Battery is partially charged upon purchase.
You must fully charge battery before use.**





PARTS AND FEATURES

1. Bumper car body
2. Seat cover
3. Seat belt
4. Control Joysticks
5. Power On/Off/ Speed switch
6. Charging port
7. Charger
8. Remote

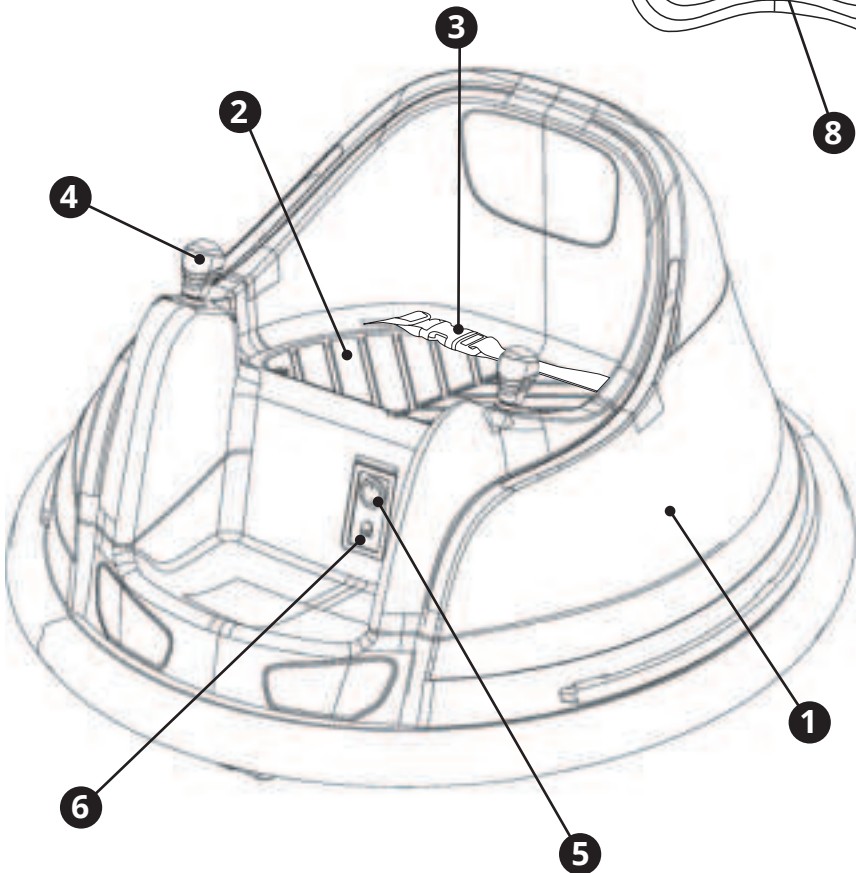
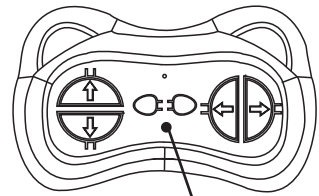



USER INSTRUCTIONS

Power On/Off/Speed switch

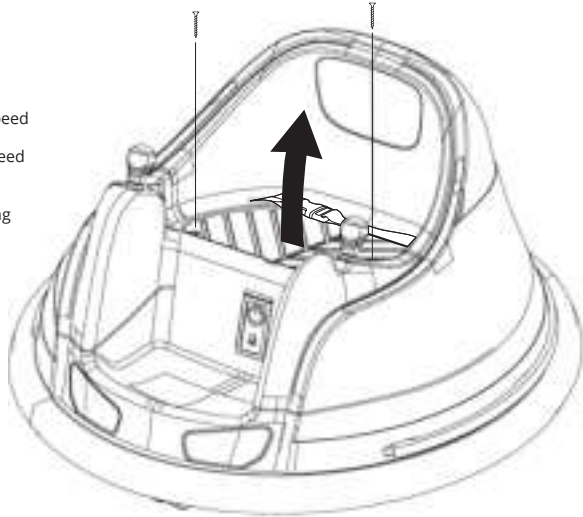
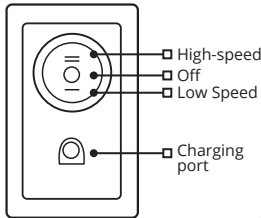

BEFORE USE

- Remove the two screws from the seat cover and lift out the cover.
- Connect the battery terminal. You must connect the same color wires together: black connector to the black terminal, red terminal to the red connector. Make sure they are connected with the correct polarity.
- Replace the seat cover with the two screws and tighten.

CHARGING THE BATTERY

- Plug the charger into a standard 120v wall outlet and the wire end into the charger port.
- Fully charge the battery for 8-12 hours.
- ⚠ Do not charge the battery for more than 12 hours.
- Check the battery and charger for any signs of wear or damage before use and do not use if damaged.

OPERATING THE VEHICLE

- Press the power switch down or up to turn the vehicle on. Note, down position (-) is low speed. Upward position (=) is high speed.
- Bumper car is equipped with slow start function for safety. When starting out bumper car will take 4 seconds to get up to full speed.
- Push or pull the control joysticks to move the vehicle
- Release both control joysticks to stop the vehicle completely

⚠ **WARNING: Close supervision is required when child is operating the vehicle.**





REMOTE CONTROL

REMOTE FUNCTIONS

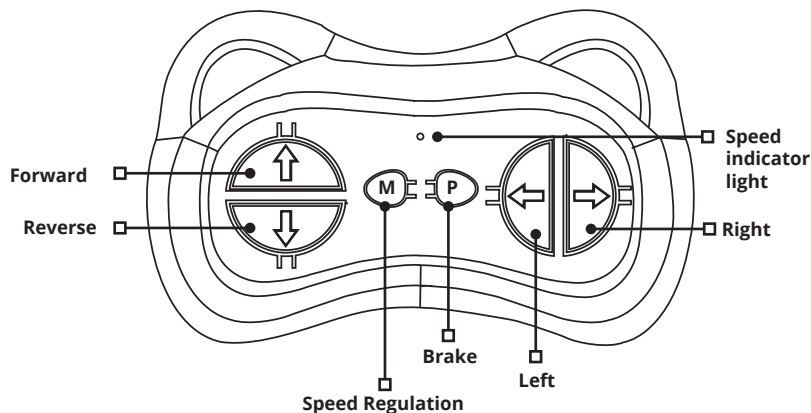

NOTE: Batteries not included. Please unscrew battery compartment on backside of remote and insert qty 2 (AAA) batteries.

CONNECTING REMOTE TO BUMPER CAR

1. When batteries are inserted the remote is active and the indicator light will blink constantly. Turn bumper car power switch on. The remote will connect to bumper car automatically. When connected the remote indicator light will pause and stay on, then continue to blink again.

SPEED REGULATION

2. Press the (M) speed regulation button on the remote to control three bumper cars speed. When the speed indicator light flashes once it is in the slowest gear on the remote control. When the indicator light flashes twice it indicates the medium speed gear of the remote control. When the indicator light flashes three times, it is the fastest gear on the remote control. The speed at which the light flashes reflects the bumper car speed - the slower the flash, the slower the speed, the faster the flash, the faster the speed.

Three Speeds:

Low: .9 mph (1.5 km/h)

Medium: 1.2 mph (2 km/h)

High: 1.7 mph (2.8 km/h)

CONTROL

3. When using the remote control the riders manual use of the driving joysticks on bumper car will override the remote control function. Once driver stops using driving joysticks remote control function will resume.

WARNING!: Only use remote when bumper car is visible to human eye.





Always purchase the correct size and grade of battery most suitable for the intended use.
Replace all batteries of a set at the same time.

Clean the battery contacts and also those of the device prior to battery installation.

Ensure the batteries are installed correctly with regard to polarity (+ and -).

Remove batteries from equipment that is not to be used for an extended period of time.

Remove used batteries promptly.

Always replace the whole set of batteries at one time, taking care not to mix old and new ones or batteries of different types. When batteries of different brand or type are used together, or new and old batteries are used together, some batteries may be over-discharged due to a difference of voltage or capacity. This can result in venting, leakage, and rupture and may cause personal injury.

CARE AND MAINTENANCE

- Check your Bumper Car regularly and make sure there are no missing or loose parts.
- Check for any broken or cracked plastic parts.
- When not using for an extended period of time, cover the product and keep away from heat and/or any damp or wet weather.
- Disconnect the battery wires if the toy will not be used for a long period of time.
- Clean the Bumper Car with a cloth and non-wax furniture polish to restore the plastic to a shine. Do not use abrasive cleaners.
- Do not wash the toy with a hose or immerse any parts in water.

TROUBLESHOOTING

PROBLEM	POSSIBLE REASON	SOLUTION
Vehicle does not move	Low battery	Fully charge the battery
	Fuse protection	Replace with a new fuse
	Disconnected / Badly connected battery	Reconnect the battery
	Failed battery / engine	Contact customer service
Vehicle does not run very long	Low battery	Fully charge the battery
	Old battery	Replace battery if necessary
Vehicle runs very slow	Low battery	Fully charge the battery
	Old battery	Replace battery if necessary
	Vehicle is overloaded	Make sure user's weight is under 66 lb / 30 kg
	Vehicle is being used in harsh environment	Avoid using the vehicle in harsh environment





PROBLEM	POSSIBLE REASON	SOLUTION
Vehicle needs a push to go forward	Poor wire connection	Check if the battery connectors are firmly connected. Contact customer service if necessary
	"Dead spot" on motor	Contact customer service
Loud grinding sound or clicking sound fro the motor or gear box	Damaged motor or gear box	Contact customer service
Battery does not charge	Disconnected / badly connected charger	Reconnect the battery
	Disconnected / badly connected charger	Make sure the charger is firmly plugged into the power source and connected to the charging port
	Charger not working	Contact customer service
Charger feels warm with charging	Normal	

FCC INFORMATION

WARNING

Any changes or modifications to this unit not expressly approved by the party responsible for compliance could void the user's authority to operate the equipment.

NOTE

This equipment has been tested and found to comply with the limits for a Class B digital device, pursuant to part 15 of the FCC Rules. These limits are designed to provide reasonable protection against harmful interference in a residential installation. This equipment generates, uses and can radiate radio frequency energy and, if not installed and used in accordance with instructions may cause harmful interference to radio communications. However, there is no guarantee that interference will not occur in a particular installation. If this equipment does cause harmful interference to radio or television reception, which can be determined by turning the equipment off and on, the user is encouraged to try to correct the interference by one or more of the following measures:

- Reorient or relocate the receiving antenna.
- Increase the separation between the equipment and receiver.
- Connect the equipment into an outlet on a circuit different from that to which the receiver is connected.
- Consult the dealer or an experienced radio/TV technician for help.





LIMITED WARRANTY TERMS

One Year Limited Warranty on 12-Volt Bumper Car Ride-on product Six-Month limited warranty on battery

Flybar, Inc. warrants this product to the original retail purchaser as follows: The ride-on product (except for the battery) is warranted against defective materials or workmanship for one year from the date of original purchase. The battery is warranted against defective materials or workmanship for six months from the date of original purchase. An original receipt is required to validate your warranty. Flybar, Inc. will, at its option, provide replacement parts or replace this product. Flybar, Inc. reserves the right to substitute if the part or model has been discontinued. To make a claim under this warranty you must contact us directly. Proof of purchase is required, and shipping/transportation charges are the responsibility of the consumer.

What does this Limited Warranty cover?

This Warranty covers all parts of the electric ride-on toy to be free from defects in workmanship and materials. This Warranty is only effective if:

- The ride-on toy is used under normal conditions for its intended purposes, by a person that properly fits and is capable of controlling the vehicle.
- The ride-on toy receives all necessary maintenance and adjustments.

What is not covered by this Limited Warranty?

This Warranty does not include labor and transportation charges. You, the original purchaser will be responsible for labor or transportation charges associated with the repair or replacement of any parts found to be eligible for warranty coverage. This Warranty does not cover any damage caused by crash, collision, misuse, abuse, neglect, improper assembly, improper maintenance, lack of maintenance, alteration, or any similar damage to the ride-on toy. For personal use only. Not for commercial use.

This Warranty will be void if the ride-on product is ever:

- Installed with a motor or modified in any other way.
- Used in a manner contrary to the instructions in the manual included with this product.
- Flybar, Inc. will not be liable for incidental or consequential loss or damage, due directly or indirectly from use of this product.

How do you make a claim under this Limited Warranty?

Warranty claims should be submitted via Flybar's online portal at www.flybar.com/pages/contact-us or via email at info@flybar.com. Please have your proof of purchase available before calling to validate your claim.

Limitation of Damages:

The warranty and remedies as set forth are exclusive and in lieu of all others, oral or written, expressed or implied. In no event will Flybar, Inc. or the dealer selling this product be liable to you for any damages, including incidental or consequential damages, arising out of the use or inability to use this product. Some states do not allow limitations as the exclusion or limitation of incidental or consequential damages, so the above limitation may not apply to you.





Limitation of warranties and other warranty terms:

Any implied warranties, including implied warranties of the merchantability and fitness for a particular purpose, shall be limited to the duration and terms of the express written warranty. Some states do not allow limitations as the exclusion or limitation of incidental or consequential damages, so the above limitation may not apply to you. This warranty gives you specific legal rights, and you may have other rights, which vary from state to state. Neither Flybar, Inc. nor the dealer selling this product authorized any person to create for it any other warranty, obligation or liability in connection with this product.

This device complies with part 15 of the FCC Rules. Operation is subject to the following two conditions:

(1) This device may not cause harmful interference, and (2) this device must accept any interference received, including interference that may cause undesired operation.







FOR ANY QUESTIONS, REPLACEMENT PARTS, OR ISSUES, PLEASE CONTACT:

FLYBAR CUSTOMER SUPPORT

Email: info@flybar.com **Phone:** 1-800-764-6784

www.flybar.com

**CONFORMS TO CPSC AND ASTM F963 SAFETY REQUIREMENTS.
COLORS AND CONTENTS MAY VARY FROM ILLUSTRATIONS**

**FLYBAR, INC.
PISCATAWAY, NJ 08854
MADE IN CHINA ©2023 FLYBAR, INC.**

LET'S CONNECT!



INSTAGRAM: @FLYBARINC

FACEBOOK: @FLYBAR

PINTEREST: @FLYBAR,INC

SHOP FLYBAR.COM

**Distributed by:
Costco Wholesale Corporation
P.O. Box 34535
Seattle, WA 98124-1535
USA
1-800-774-2678
www.costco.com**

