

# User Manual

ESW-00AA-US Smart Switch V1.0



## Features



WiFi Connection



Mechanical ON/OFF Switch

## Product Introduction

- Excellent design and high-quality materials to ensure long-term stable and reliable service to users
- WiFi connection has the most applicability and has access to multiple platforms
- Silent mechanical push button design provide the user's best feedback

## Specification

Input Power	100-240V AC 50-60Hz
Control	Relay
Communication	WiFi 802.11 b/g/n 2.4GHz
Control Channel	1 CH
Max Current	15 A
Standby Power	≤0.5W
Button Life	500K times
Dimension	105*45*50mm

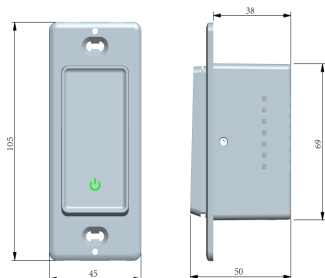

## Installation

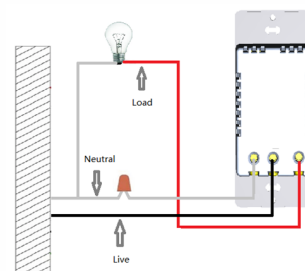

- Disconnect power by circuit breaker
- Check the Line with voltage tester pen, make sure the power is off to prevent electric shock
- Follow the wiring instructions, connect the dimmer wires to each other leads and check for short circuits
- Screw the dimmer into the backbox
- Mounting switch on the plate
- Connect circuit breaker to restore power

## Connection & Operation

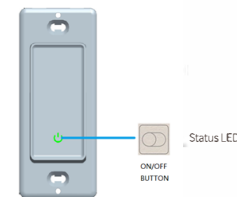

- Once connect power correctly, the Green led in the bottom of Switch will turn on, switch is ready to serve
- Push on/off button to turn on/off the light

Reset the product: Press and hold ON/OFF button for 5 seconds then release, Green power indicator will flash, Switch get into setup mode please follow setup instruction to complete setup to start smart function

## APP Operation

Scan QR code and download the App iOS Android version



- Register and login  
The user needs to register the user first and can use the mobile phone number to register  
Once you are done, you can use this username to log in to the APP and proceed to the next step  
\*Support some third party accounts are directly logged in

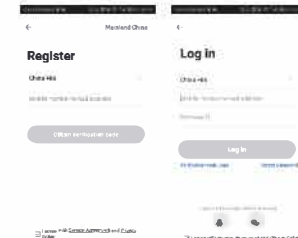

## APP Operation

- Add Devices  
After the user logs in, click the "+" icon in the upper right corner of the main page to enter the add device interface; select the "Switch" menu and click the switch device icon

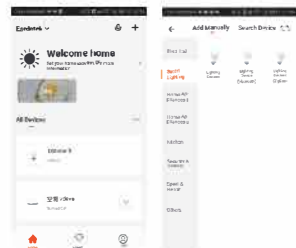

## APP Operation

- Add Devices  
To ensure that the new dimmer power LED is flashing, select the Wi-Fi and enter the password then click OK

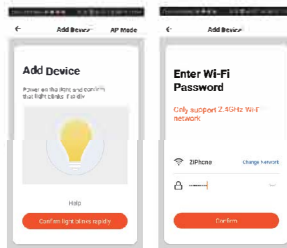

## APP Operation

- Add Devices  
Wait system to search the device, connect and configure the device will take up to 3min.  
Once the device configure successfully, please also input preferred name and select location

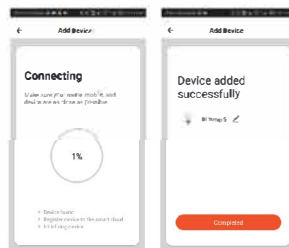

Remark:  
1. Smartphone add device must connect to same Wi-Fi during setup mode  
2. The device must be added to the account before it can be controlled remotely  
3. After the device is successfully accessed, other users can also control the product through the sharing function  
Troubleshooting:  
a) Can not connect to Wi-Fi router  
a) Also make sure you have good Wi-Fi signal strength (not too far from the router)  
b) Metal box and metal surface (wall board) may block Wi-Fi signal  
c) Make sure you connect to the correct Wi-Fi password  
d) The Dimmer only support 802.11 b/g/n 2.4GHz Wi-Fi signal; 5GHz NOT support

## APP Operation

- Control dimmer with APP

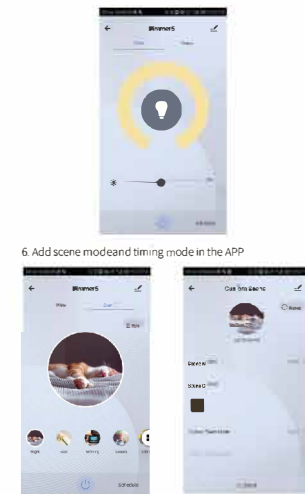

## APP Operation

- All added devices can be viewed in the main menu of the APP

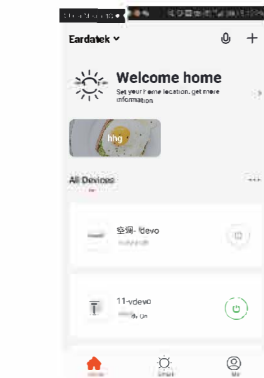

## FCC Caution

This device complies with part 15 of the FCC Rules. Operation is subject to the following two conditions: (1) This device may not cause harmful interference, and (2) this device must accept any interference received, including interference that may cause undesired operation.

5.15.21 Information to user:  
Any Changes or modifications not expressly approved by the party responsible for compliance could void the user's authority to operate the equipment.

5.15.105 Information to the user:  
Note: This equipment has been tested and found to comply with the limits for a Class B digital device, pursuant to part 15 of the FCC Rules. These limits are designed to provide reasonable protection against harmful interference in a residential installation. This equipment generates uses and can radiate radio frequency energy and, if not installed and used in accordance with the instructions, may cause harmful interference to radio or television reception. However, there is no guarantee that interference will not occur in a particular installation. If this equipment does cause harmful interference to radio or television reception, which can be determined by turning the equipment off and on, the user is encouraged to try to correct the interference by one or more of the following measures:  
Reorient or relocate the receiving antenna  
Increase the separation between the equipment and receiver  
Connect the equipment into an outlet on a circuit different from that to which the receiver is connected  
Consult the dealer or an experienced radio/TV technician for help.

FCC Warning:

This equipment has been tested and found to comply with the limits for a Class B digital device, Pursuant to part 15 of the FCC Rules. These limits are designed to provide reasonable protection against harmful interference in a residential installation. This equipment generates, uses and can radiate radio frequency energy and, if not installed and used in accordance with the instructions, may cause harmful interference to radio communications. However, there is no guarantee that interference will not occur in a particular installation. If this equipment does cause harmful interference to radio or television reception, which can be determined by turning the equipment off and on, the user is encouraged to try to correct the interference by one or more of the following measures:

- Reorient or relocate the receiving antenna.
- Increase the separation between the equipment and receiver.
- Connect the equipment into an outlet on a circuit different from that to which the receiver is connected.
- Consult the dealer or an experienced radio/TV technician for help.

Caution: Any changes or modifications to this device not explicitly approved by manufacturer could void your authority to operate this equipment.

This device complies with part 15 of the FCC Rules. Operation is subject to the following two conditions:

(1) This device may not cause harmful interference, and (2) this device must accept any interference received, including interference that may cause undesired operation.

This equipment complies with FCC radiation exposure limits set forth for an uncontrolled environment. This equipment should be installed and operated with minimum distance 20cm between the radiator and your body.

This transmitter must not be co-located or operating in conjunction with any other antenna or transmitter.