

User's Manual

P/N: 9172850
Ver. 1.0



BT

BTH-1XX

Bluetooth Headset



Table of Contents

Introduction.....	3
BTH-1XX series Overview.....	5
Basic Information To Know.....	6
Connecting Your BTH-1XX.....	9
Using Your BTH-1XX.....	12
Troubleshooting.....	17

First edition (December 2004)

Corrections, changes and improvements to this manual might be made at any time and without notice. Such update will, however, might be incorporated into new edition of this manual.

All rights reserved.

Bluetooth is trademark of the Bluetooth SIG, Inc. The trademark are owned by Bluetooth SIG, Inc. USA

FCC Statement

This device complies with Part 15 of the FCC Rules. Operation is subject to the following two conditions:

1. This device may not cause harmful interference, and
2. This device must accept any interference received, including interference that may cause undesired operation.

This equipment has been tested and found to comply with the limits for a Class B digital device, pursuant to Part 15 of the FCC Rules. These limits are designed to provide reasonable protection against harmful interference in a residential installation. This equipment generates uses and can radiate radio frequency energy and, if not installed and use in accordance with the instructions, may cause harmful interference to radio communications. However, there is no guarantee that interference will not occur in a particular installation.

If this equipment does cause harmful interference to radio or television reception, which can be determined by turning the equipment off and on, the user is encouraged to try to correct the interference by one or more of the following measures:

- Reorient or relocate the receiving antenna.
 - Increase the separation between the equipment and receiver.
 - Connect the equipment into an outlet on a circuit different from that to which the receiver is connected.
 - Consult the dealer or an experienced radio/TV technician for help.
3. This equipment complies with FCC radiation exposure limits set forth for an uncontrolled environment. End users must follow the specific operating instructions for satisfying RF exposure compliance. This transmitter must not be co-located or operating in conjunction with any other antenna or transmitter.

Notice: Any changes or modification not expressly approved by the party responsible could void the user's authority to operate the device."

A. Introduction

Thank you for purchasing the BTH-1XX Family Bluetooth headset. This BTH-1XX model enables convenient cordless communication with mobile phones and Bluetooth devices that are compliant with Bluetooth version 1.1 (or higher) and support the headset profile or hands free profile.

Bluetooth technology make wireless link between any compatible mobile and stationary communication devices. The technology adopts a global available RF frequency range to establish RF link that offer secure, fast and reliable transmission of voice and data.

To learn how to use BTH-1XX, please take a few minutes to read the manual thoroughly and retain it for future reference. For your safety, please ensure that you are fully accustomed with BTH-1XX before using it while driving. Thank you again for choosing our product. We believe that BTH-1XX will become a valuable part of your mobile communications.

What is inside the Box?

BTH-1XX headset * 1

Charging Jack adapter *1 (This jack adapter provides interoperability with AC adapter Models from Nokia listed on your gift box)

Flannelette Bag * 1

User's Manual * 1

Quick Start Guide * 1

Switching AC Power Adapter * 1 (Optional)



BTH-1XX Headset



Flannelette Bag



Charging Jack Adapter

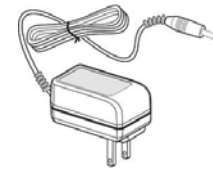

**AC Power Adapter
(optional)**

B. BTH-1XX Overview

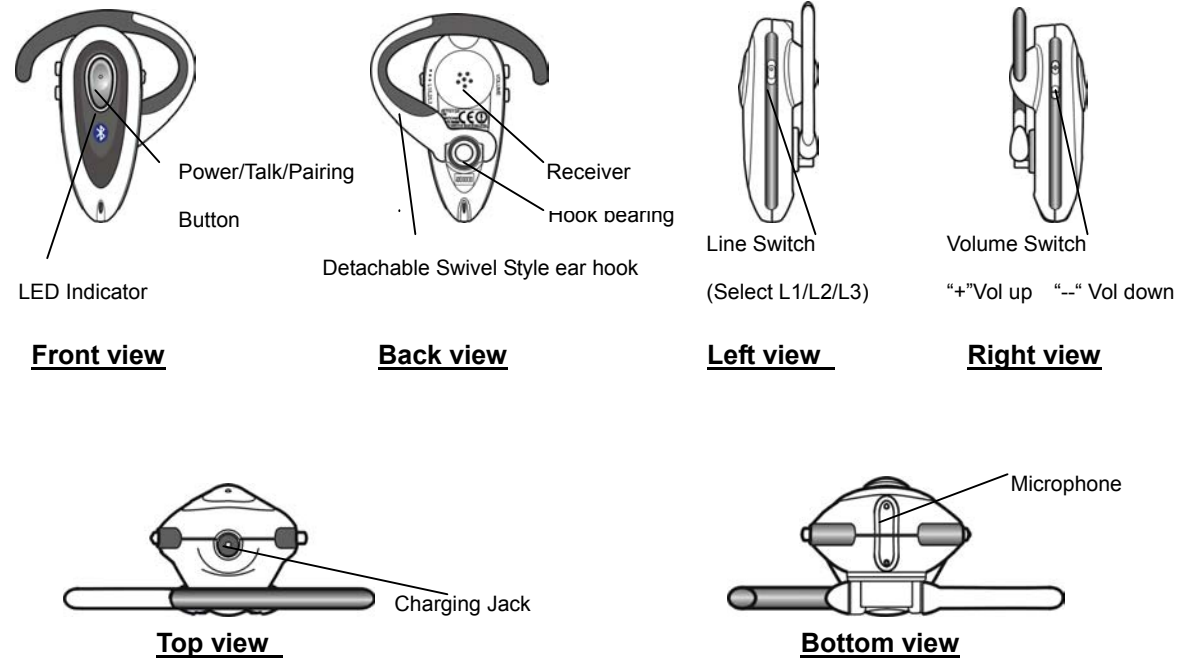

C. Basic information to know

C.1 Specifications of your BTH-1XX Bluetooth Headset

• Bluetooth : Bluetooth V1.1 compliance, Class II	• RF Frequency: ISM Band 2.40G~2.4835GHz
• Profile : Headset Profile 1.1; Hands free profile	• Weight : 15.5 grams
• Operation Range : Up to 10 meters	• Volume Level : 8(BTH-10)
• Talk Time : Up to 8 Hrs (varies with phone engaged)	• Standby Time : Up to 80Hrs
• Charging Time : Up to 3.5 Hrs	• Battery : 160mAH 3.6V rechargeable Li Polymer
• Operating Humidity : 5 to 85%	• Operating Temperature : -20°C ~ 55°C
• Storage Temperature : -20°C ~ 85°C	• Compliances : BQB/FCC/CE

C.2 Fully charge your BTH-1XX

Before using BTH-1XX series headset you will need to charge it fully before first time use.

B.2.1 Plug the Optional AC power adapter into the Charging jack (DC jack) or connect to list Nokia mobile Phone AC power adapter through charging jack adapter.

B.2.2 Plug the AC power adapter's plug into an electrical wall outlet.

B.2.3 While charging, the LED indicator shows a steady red light.

B.2.4 Charge the unit for approximately 3 hours before first time use

B.2.5 When the battery is fully charged, the LED indicator turns off.

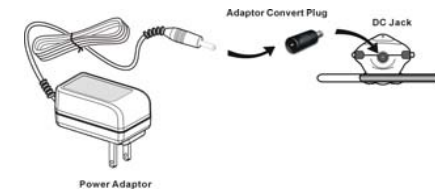
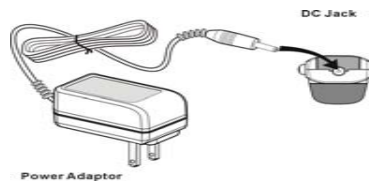

C.4 Signals of your BTH-1XX

Headset Status	LED Indicator	Headset Status	Signal Tones
Power Off	OFF	Power ON/OFF	2 short beep
Battery Low	Flashes red every 3 seconds	Battery Low	1 short beep tone every 5 min.
Standby Mode	Flashes blue every 3 seconds	Incoming Call	Musical ring tone
Talk Mode	Steady blue light	Volume UP/DOWN	1 short beep tone
Charging Mode In Process	Steady red light		
Charging Complete	Turn off		
Pairing Mode	Flashes blue and red alternatively	Into Pairing Mode	3 short beep tone
Pairing Successful	Blue LED Flashes every 3 seconds	Pairing Successful	1 short beep tone
Mute Microphone	Steady lilac light	Mute Microphone	1 short beep tone

C.5 Getting a Prefect Fit

C.6.1 Swivel the ear hook to change for wearing on left or right ear

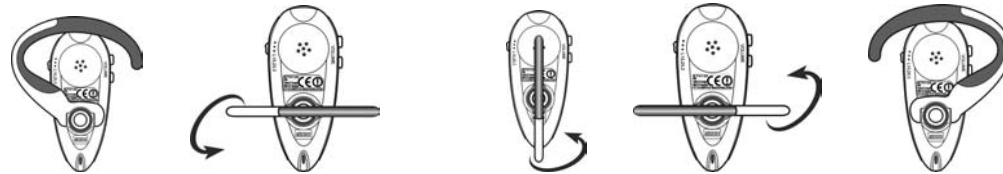

Right ear wearing → Open the ear hook 90 degree → Swivel ear hook 180 degree → Close the ear hook
to the headset body by rounding hook bearing toward to the body

Left ear wearing

C.6.2 Put on the headset

Step 1 Choose which site of ear to wear the headset on (take a right ear wearing as example here)

Step 2 Open the ear hook 45 to 90 degree from the headset body

Step 3 Loop the ear hook over the ear and adjust to have headset body fitted to ear shape

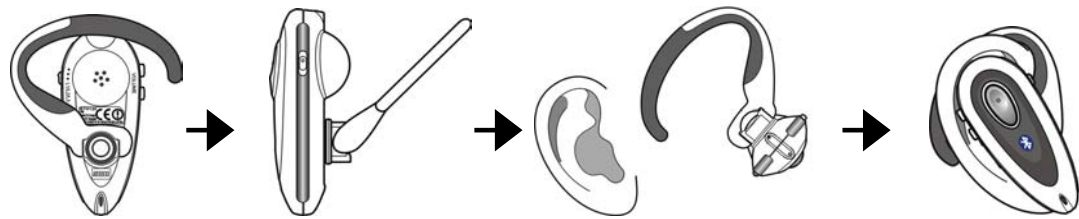

D. Connecting your BTH-1XX

D.1 Turning your headset ON and OFF

D.1.1 To turn your BTH-1XX on:

1. Ensure that the AC Adapter is not plugged in.
2. Press the "Talk" button firmly,
3. The LED indicator will flash blue every 3 seconds while the headset is turned on. And if you place the headset near ear, two short beep tones can be heard when headset is on. The headset is now in 'standby' mode and ready for use.

D.1.2 To turn your BTH-1XX off

1. Press and hold the “Talk” button firmly for at least 3 seconds until the LED indicator light emits a very short burst of flashes. In the meantime, two short beep tones would be heard if headset is placed near ear.
2. Without delay, release the button.

The headset is now turned off and no indication light activity in this mode. You will need to wait for 5 seconds before turning it on again. As long as you are recharging your headset regularly, you do not need to turn your headset off after using it – you only need to ‘end the call’ (see *Ending a call*)

D.2 Pairing the headset

‘Pairing’ creates a wireless link between two Bluetooth devices such as headset and mobile phone.

1. Prepare your other to-be-paired device (e.g. your mobile phone) enter searching Bluetooth device mode according to its user documentation on pairing.
2. Ensure that the headset is off and no AC power adapter plugged in..
3. Put the Line switch to the assigned line.
4. Press and hold the “Talk” button about 3 seconds. When the LED indicator flashes red and blue each time after

another, it means that you are in pairing mode. Then you can release the button. If you wear the headset, you will hear 3 short beep tones when enter pairing mode

5. After searching for a while, your other under pairing mode device (e.g. mobile phone) should list model name of this headset, e.g. BTH-1XX, Please confirm it following your device user documentation. Then, when pin code or passkey of headset is asked, please enter 0000, which is default pin code pre-stored in the headset. Then, pairing procedure starts and taking a few seconds, it will show pairing successful. In the meantime, you might now replace the given headset model name with your favorite name tag. The pairing process is then completed. A beep tone will be heard on BTH-1XX when pairs successfully
6. The LED indicator will resume to the standby mode (flashing blue every 3 seconds) after a short while.
Now that the devices are paired, you will not need to repeat the pairing process in future use as long as you are using the same headset.
7. To pair BTH-1XX with more than one device, please repeat above 1 to 6 steps by selecting Line switch to different line number.

Remark : 1. For BTH-1XX, if you slide Line switch during pairing mode, headset will go to deep sleep mode and LED indicator will be turned off. If there is incoming call to previous paired phone of other line, you have to press

talk button of headset to initialize the link again.

2. If pairing idles a period of time, approximately 120 seconds, headset will go to deep sleep mode. And all previous pairing(if any) in the set Line will be vanished.

E. Using your BTH-1XX

E.1 Making a call

While you are wearing BTH-1XX, there are different ways to make a call. Please make sure the headset and the to be connected Bluetooth device are both power on and within radius of each other.

E.1.1 Calling from the phone keypads

1. Ensure that your headset is in standby mode
2. Briefly press on the talk button to “activate” the headset. Now the LED indicator light s steady blue.
3. Use the phone keypads to dial the numbers.
4. Press the ‘Send’ key on the phone.
5. Or you can proceed 3 first and then 2 when ring tone heard to place call with your mobile phone and headset.

6. For BTH-1XX, as long as your mobile phone Bluetooth is on and has been stored ID in one of the line of the headset, the phone link of dialing mobile phone and headset will be established no matter which Line switch are selected in the BTH-1XX

* If your call is not answered, you must end the call as described in *Ending a call* *.

E.1.2 Calling from the headset with voice commands

If your mobile phone supports voice dialing, you can use this feature with the headset.

1. Ensure that your headset is in standby mode and slide the Line switch to the right line while use BTH-1XX.
2. Ensure that the voice dialing on your mobile phone is enabled.
3. Briefly press on the talk button to “activate” the headset. Now the LED indicator is lit still and you can also hear a faint background noise as well. It might take a while to establish link. Then, a tone might be heard in the headset. After beep tone, speak out the voice tag as you normally would.
4. The phone will automatically dial your voice tag.
5. When connected you are free to talk normally.

* If your call is not answered, you must end the call as described in *Ending a call*.

Remark: We recommend that you record all the voice tags through the headset to “train” your phone for the voice

recognition with BTH headset.

E.2 Ending a call

To end a call:

1. Use the key(s) as specified by your phone manufacturer.
2. Or you can press the “talk” button on the headset. The LED indicator light on the headset should now resume to the standby mode. Even none of key(s) pressed, as long as your mobile phone disconnects the line. Headset will resume to standby mode after call ends up.

Important: *It is strongly suggested that you always remember to end calls as above described to save battery power.*

E.3 Answering a call

Either by pressing the phone keypad or talk button on the headset can answer an incoming call. While talking the LED indicator will lights steady blue showing that the headset is in use.

E.3.1 From Headset (recommended method)

Briefly press the talk button then talk.

E.3.2 From Keypad

Answer the call by pressing your phone keypad. The according keypads vary by different answering mode and phone model. After your call, end it as described in ending a call.

E3.3 First come, first serve

If BTH-1XX has been paired with different device in different Line, it will serve the first incoming call while more than one call received on paired device at about same time.

Remark *While working with some phones, headset will not ring when phone receive call owing to phone's auto-disconnect behavior. In this case, press talk button to activate link to mobile phone for an incoming call.*

E.4 Call-waiting

Some phones allow you to accept another incoming call while you are using BTH-1XX. This feature varies by mobile service provider and phone model. If you normally hear a beep, you will still hear this beep with your headset. In general, the second call could be picked up with such mobile phone's keypad. If your phone service supports call-waiting, you can switch between calls by using the standard method specified by your phone manufacturer's user documentation.

E.5 Transferring sound from phone to headset

When place a call with your mobile phone, the call can be transferred to headset by pressing the talk button of headset if headset is on, paired with phone and within radius of each other. Please refer your phone manufacturer's user documentation for details

E.6 Adjust speaker volume and Mute microphone

E 6.1 Adjust speaker volume

During a call, press "+" key to increase headset speaker volume and press "--" key to decrease it.

E 6.2 Mute microphone

Press both "+" and "--" key at the same time then release while you are engaged in a call. It will mute the microphone of headset. Press and release both keys again will resume the talk with microphone. For BTH-1XX, a short beep tone can be heard when activate mute function and LED indicator lights steady lilac while microphone is mute in a call.

E.7 Deep sleep mode

To extend battery life, BTH-1XX headset will go to deep sleep mode after idles in standby mode for 2 hours. While in deep sleep mode, you have to press talk button on headset to activate link with phone when receive call.

F. Troubleshooting

Learning how to use a Bluetooth headset takes more time than a regular headset, but it offers considerable benefits once you've mastered it. Here are some common symptoms and solutions that will help to get you going quickly.

Symptom	Solution
Headset battery discharged quickly	After placing a call, you might have left headset in active mode, instead of returning them to standby mode (see E.2 Ending a call).
LED indicator flashes red	It indicated the battery is running to low capacity. Please charge it for 1 hour at least.
No sound contact between headset and other Bluetooth enabled device	*Make sure that the two devices has been paired and the headset is still in the paired device list of the phone. *Make sure that the two devices are power on and within working radius

	<p>of each other without solid objects, such as walls of furniture, in between.</p> <p>*Some mobile phone can support only one Bluetooth headset.</p> <p>Disconnection might happen when there is more than one headset paired with such phone.</p> <p>*Your phone might only look up the last paired headset for phone link.</p>
After idle for some time, my BTH-1XX does not respond while phone receive a call.	<p>BTH-1XX will go to deep sleep mode after idle in standby mode for 2 hours. You have to press talk button to resume the standby mode for call operation.</p>
Headset switch off automatically	<p>There a few reasons why the headset might be switched off automatically.</p> <p>*The battery is very low. The LED indicator flashed red and you hear1 short beep tone every 5 seconds. Charge the headset battery for approximately 1 to 1.5 hours.</p> <p>*Headset has been in pairing mode for more than 120 seconds.</p>

	*Line switch is re-selected during pairing mode.
Voice command not working properly	* Record all the voice tags through the headset instead of through your phone, to "train" your phone for the voice recognition with the headset.
Cracking noise	There is an interfering signal nearby. Or you have exceeded the 10 m (30 ft.) wireless range.
LED Indicator on headset does not turn on when charging	<p>*Ensure that the AC power adapter is plugged firmly into an electrical wall outlet.</p> <p>*Ensure that the cable coming from the AC power adapter is firmly plugged all the way into the Charging Jack or to the Charging Jack Adapter.</p> <p>* If the battery is almost empty or has not been used for a long period of time, it may take up to 30 minutes charging to have LED indicator flashed steady red.</p>

Additional safety information

Guidelines for safe and efficient use

Note: Read this information before using your Bluetooth headset

Please check for any exceptions, due to national requirements or limitations, in usage of Bluetooth equipment before using this product.

Product care

-Do not expose your product to liquid or moisture or to humidity.

-Do not expose your product to extreme high or low temperatures.

-Do not expose your product to lit candles, cigarettes, or cigars, or to flames, etc.

-Do not drop, throw or try to bend the product as rough treatment could damage it

-Do not use any other accessories than originals intended for use with this product. -Use of non-original accessories may result in loss of performance, damage to the product, fire, electric shock or injury. The warranty does not cover product failures resulted from the use of non- original accessories.

-Do not attempt to disassemble your product. The product does not contain consumer serviceable or replaceable components. Unauthorized disassembly may damage the headset and warranty will be void.

-Do not keep the product in an area prone to dust and dirt. Only use a soft damp cloth to clean your product.

-If you will not be using the product for a while, store it in a place that is dry, free from damp, dust and extreme temperatures.

Radio frequency exposure

Your Bluetooth headset is a radio transmitter and receiver. When in operation, it communicates with a Bluetooth equipped device by receiving and transmitting radio frequency (RF) electromagnetic fields (microwaves) in the frequency range 2400 to 2500 MHz. The output power of the radio transmitter is low, 0.001 watt. This Bluetooth headset is designed to operate in compliance with the RF exposure guidelines and limits set by international authorities and agencies.

Driving

Check the law and regulations on the use of mobile phones and hands free equipment in the areas where you drive.

RF energy may affect some electronic systems in motor vehicles such as car stereo, safety equipment etc. check with your vehicle manufacturer's documentation to be sure that Bluetooth technology will not affect the electronic systems in your vehicle.

Electronic equipment

Most modern electronic equipment is shielded from RF energy. However, certain electronic equipment is not, therefore:

Do not use your Bluetooth headset near medical equipment without requesting permission. If you are using any personal medical devices, e.g. a pacemaker or a hearing aid, please read in your mobile phone's User's Guide for further information.

Aircraft

Turn your headset OFF before boarding any aircraft. To prevent interference with communication systems, you must not use your Bluetooth while the plane is in the air.

Blasting areas

Turn off all your electronic devices when in a blasting area or in areas posted **turn off two-way radio** to avoid interfering with blasting operations. Construction crews often use remote control RF devices to set off explosives.

Potentially explosive atmospheres

Turn off your electronic device when in any area with a potentially explosive atmosphere. It is rare, but your electronic device could generate sparks, sparks in such areas could cause an explosion or fire resulting in bodily injury or even death. Areas with a potentially explosive atmosphere are often, but not always, clearly marked.

Power supply

- Connect the AC power adapter only to designated power sources as marked on the product.
- Always remove power cord from the outlet by holding onto the AC adapter rather than the cord to avoid damage to the cord
- Make sure the cord is positioned so that it will not be stepped on, tripped over or otherwise subjected to damage or stress.
- Always unplug the unit from any power source before attempting to clean it to reduce risk of electric shock,.
- The AC power adapter can only be used indoors. Never use it in outdoors or in damp areas.
- DANGER- Never alter the AC cord or plug. If the plug does not fit into the outlet, have a proper plug adapter installed.
- Improper connection can result in risk of electric shock.

Battery Information

- A rechargeable battery has a long service life if treated properly.

- The battery can only be charged in a temperature between -10°C(14° F) to 45°C(113° F)

- For maximum battery capacity, use the battery in room temperature. The capacity of battery might be reduced if the battery is used in a low temperature environment.

- A new battery or battery not been used for a long period of time could have a reduced capacity in the first few times it is used. It is recommended to charge the battery every other month when it is not in use for a long period of time.

Place

- It is recommended that the Bluetooth headset is worn in positions where it will not be subject to pressure since such pressure may result in bodily injury or damage to the product.

Children

- Do not allow children to play with your Bluetooth headset since it contains small parts that could be detached and cause a choking hazard.