

Safety Instructions

Read and follow all the safety instructions:

- The lamp is not waterproof. Avoid exposing it to splashing or dripping water.
- The operating temperature should be within -10° to 40°C (14° to 104°F).
- The lamp's internal light source cannot be replaced. If it breaks, you must replace the lamp.
- Do not allow children to install the lamp alone.
- Avoid placing the lamp near heat sources.
- Do not install the lamp with a dimming driver
- Avoid placing the lamp near potentially dangerous sources (e.g., candles, liquid-filled objects).
- Do not charge other devices with the Type-C cable in control box.
- Do not attempt to detach the light from the base, as it might affect the product's lifespan.

Introduction

Thanks for choosing the Govee Glow. The Govee Glow helps you create a warm ambiance and supports smart voice control. Choose from 16 million colors, turn up the music, and immerse yourself in a party of dancing lights!

01

What You Get

Table Lamp	1
Control Box	1
Adapter	1
User Manual	1
Service Card	1

At a Glance

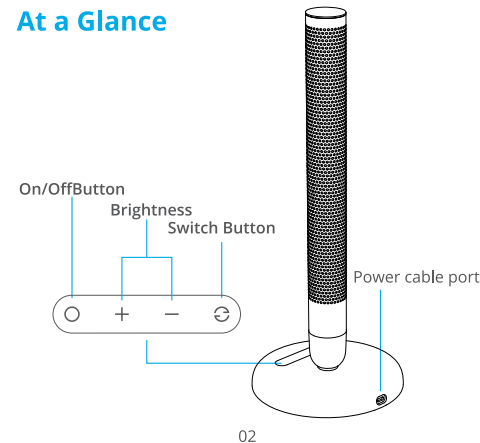

On/Off Button	Press to power the lamp On/Off.
Brightness+	Press to increase the brightness
Brightness-	Press to decrease the brightness.
Switch Button	Press to change light colors. Long press to change color modes.

Installing Your Device

- 1 Connect the adapter to the control box with the DC charging port.

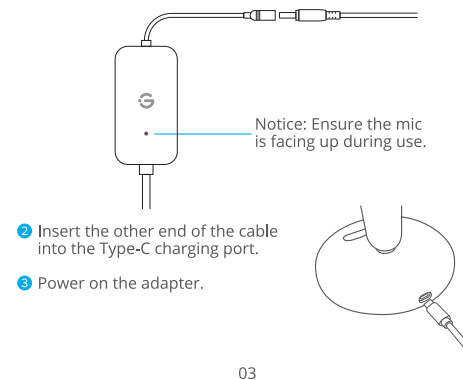

Pairing Your Device with the Govee Home App

What You Need:

- A Wi-Fi router supporting the 2.4GHz and 802.11 b/g/n bands. 5GHz is not supported.
 - A smartphone or tablet running iOS 8.0 (or above) or Android 4.3 (or above).
- 1 Download the Govee Home app from the App Store (iOS devices) or Google Play (Android devices).
 - 2 Open the app, tap the “+” icon in the top right corner and search for “H6050”.
 - 3 Tap the device icon and follow the onscreen instructions to complete pairing.



04



For FAQs and more information,
please visit: www.govee.com

Specifications

Adapter input	AC 100 - 240V
Lamp input	12V/1A
Lumen	100lm
Color	RGBWW
Color Temperature	1800K-3000K
Control Method	Touch button,APP, voice control
Working Temperature	-10°C-40°C / 4°F - 104°F

Troubleshooting

❶ Cannot connect to Wi-Fi.

- Check if the lamp is powered on.
- Check if Bluetooth on the smartphone is enabled, or try connecting with another smartphone.
- When connecting for the first time, ensure the smartphone is near the lamp.
- If the connection error still exists, please delete the connected lamp from "My Device" on the app. Reconnect to the Govee Home app by following the instructions provided previously.

05

❷ Wi-Fi disconnected or failed to connect.

- Check if the lamp is powered on.
- Do not skip the Wi-Fi connection steps during the lamp pairing process.
- Ensure your Wi-Fi router is 2.4GHz (5GHz is not supported).
- Ensure you entered the correct Wi-Fi password during the Wi-Fi set up process.
- Try connecting the lamp with a smartphone hotspot to check if your home network is working properly.
- Shorten the distance between the lamp and the Wi-Fi router to less than 50 inches, then reconnect.

❸ Cannot connect to Alexa or Google Assistant.

- Ensure the Wi-Fi connection is stable and working properly.
- Go to "User Guide" on the app Settings page to pair the lamp again.

❹ The lamp is not working properly.

- Only use the provided Type-C cable with the control box included with the product. The lamp does not support any other charging cables;

❺ Can multiple users control one lamp?

- Each lamp can only be controlled by one account.
- If multiple users want to manage the same lamp, ensure they all use the same account.

06

Customer Service

🔧 Warranty: 12-Month Limited Warranty

🔧 Support: Lifetime Technical Support

✉ Email: support@govee.com

🌐 Official Website: www.govee.com

📺 @Govee 📷 @govee_official 📺 @govee.official

🐦 @Goveeofficial 📘 @Govee.smarthome

Govee is a trademark of Shenzhen Intellirocks Tech Co.Ltd.
Copyright ©2021 Shenzhen Intellirocks Tech Co.Ltd. All Rights Reserved.

- English:"
This device complies with Industry Canada licence-exempt R55 standard(s). Operation is subject to the following two conditions:
(1)this device may not cause interference, and
(2)this device must accept any interference, including interference that may cause undesired operation of the device."

- French:"
Le pr é sent appareil est conforme aux CNR d'Industrie Canada applicables
aux appareils radio exempts de licence. L'exploitation est autoris é e aux deux conditions suivantes :
(1)l'appareil nedoit pas produire de brouillage, et
(2)l'utilisateur de l'appareil doit accepter tout brouillage radio é lectrique subi, m ê me si le brouillage est susceptible d'en compromettre le fonctionnement."

07

FCC Statement

This device complies with Part 15 of the FCC Rules . Operation is subject to the following two conditions:

(1) This device may not cause harmful interference, and (2) This device must accept any interference received, including interference that may cause undesired operation.
Warning: Changes or modifications not expressly approved by the party responsible for compliance could void the user's authority to operate the equipment.

NOTE: This equipment has been tested and found to comply with the limits for a Class B digital device, pursuant to Part 15 of the FCC Rules.

These limits are designed to provide reasonable protection against harmful interference in a residential installation. This equipment generates uses and can radiate radio frequency energy and, if not installed and used in accordance with the instructions, may cause harmful interference to radio communications. However, there is no guarantee that interference will not occur in a particular installation. If this equipment does cause harmful interference to radio or television reception, which can be determined by turning the equipment off and on, the user is encouraged to try to correct the interference by one or more of the following measures:

1. Reorient or relocate the receiving antenna.
2. Increase the separation between the equipment and receiver.
3. Connect the equipment into an outlet on a circuit different from that to which the receiver is connected.
4. Consult the dealer or an experienced radio/TV technician for help.

FCC Radiation Exposure Statement

This equipment complies with FCC radiation exposure limits set forth for an uncontrolled environment. This equipment should be installed and operated with minimum distance 20cm between the radiator & your body.



User Manual

Govee Glow
Table Lamp
Model: H6050