

*Thank you for purchasing this Autel tool. This tool is manufactured to a high standard and will provide years of trouble-free performance when used in accordance with these instructions and properly maintained.*

**! IMPORTANT:** Before operating or maintaining this unit, please read these instructions carefully. Use this unit correctly and with care as failure to do so may cause damage and/or personal injury and will void the product warranty.

## Parts List

### Calibration Frame

AUTEL-CSC1000

1 PC

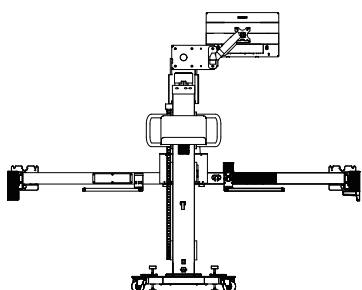

### Packaging Box

3 PCS

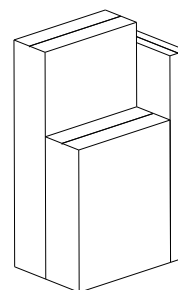

## Move out the Calibration Frame

1

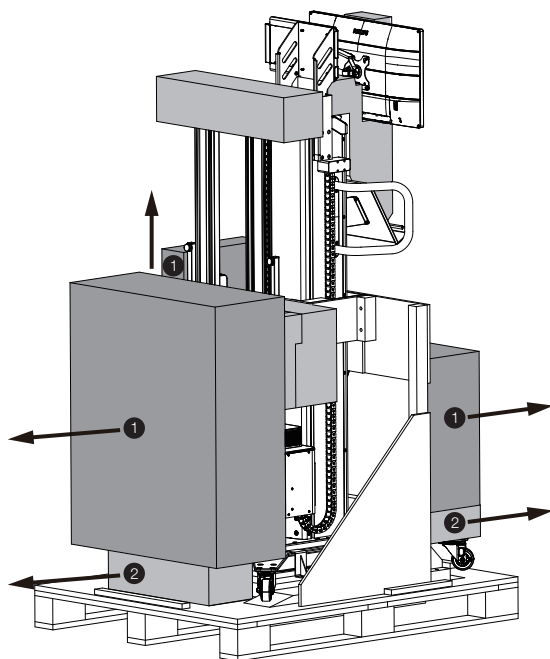

Remove the dust cover and protective film from the calibration frame. Set aside the three boxes (1) for later use, then remove the foam padding (2) around the calibration frame.

2

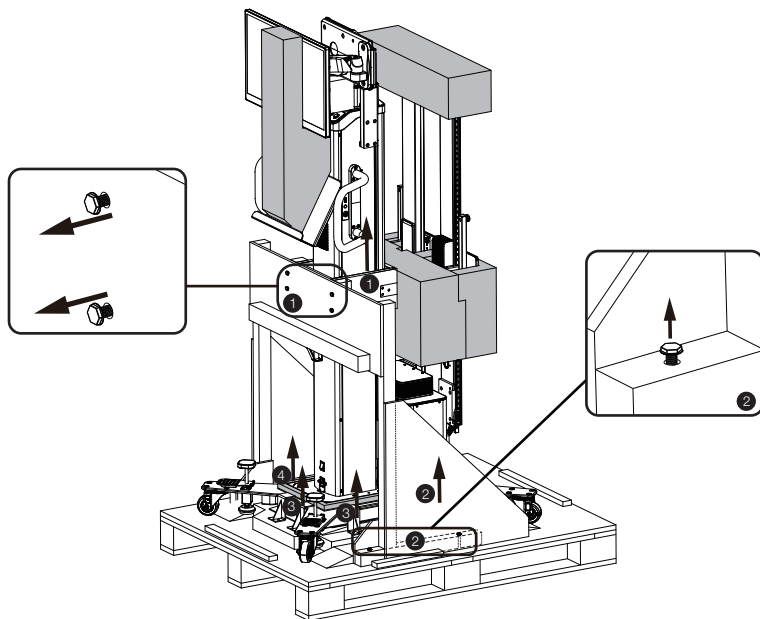

Unscrew the four screws on the back of the wooden shipping bar to remove the U-shaped bar (1). Unscrew the four screws at the bottom to remove the stand bar (2). Unscrew all screws on the eight Z-shaped corner brackets (3) to remove the brackets and the two U-shaped bar (4) under the brackets.

3

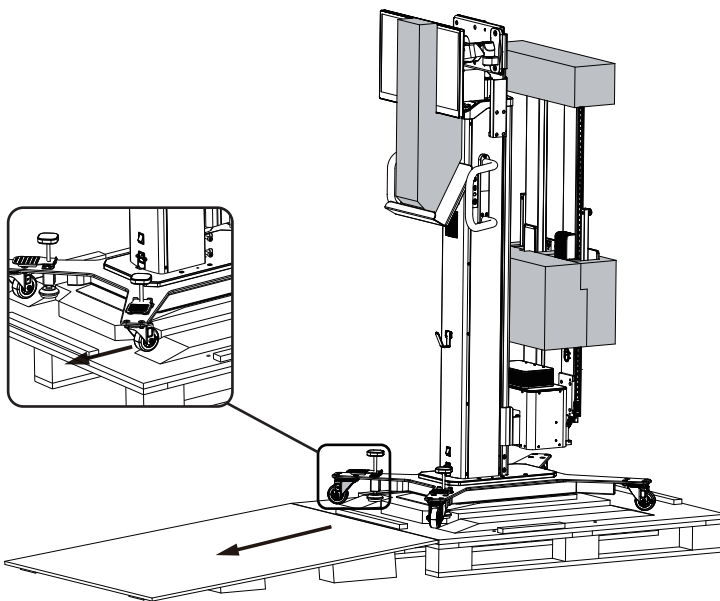

Attach the plywood cover to the wooden pallet at the rear side of the calibration frame to serve as a ramp. Roll the calibration frame down the ramp to the workspace floor.

**NOTE:** Adjust the position and direction of the two rear wheels to align with the slopes of the wooden pallet. This will enable the calibration frame to slide smoothly from the wooden pallet onto the workspace floor.

4

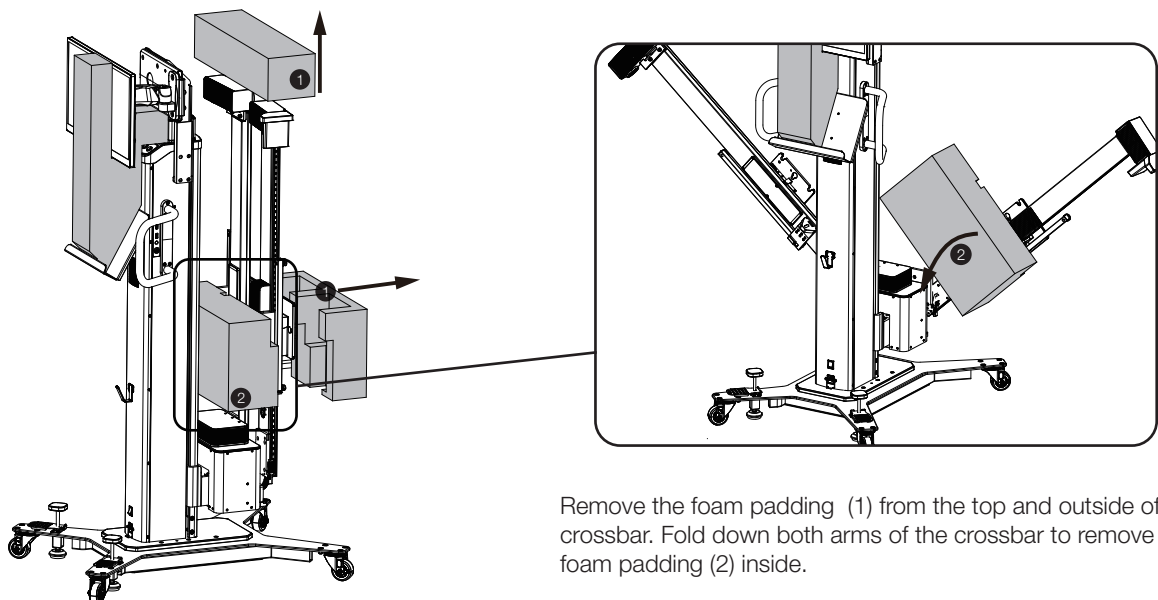

Remove the foam padding (1) from the top and outside of the crossbar. Fold down both arms of the crossbar to remove the foam padding (2) inside.

## Uncover the Touchscreen Monitor

1

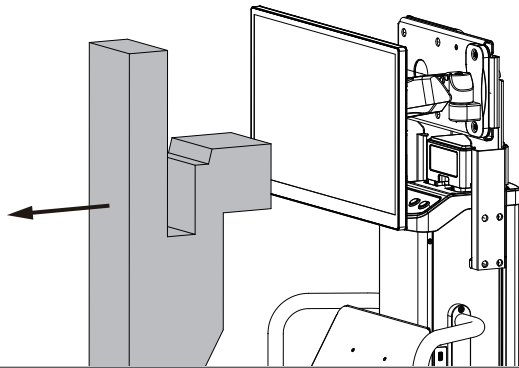

Remove the protective film and foam padding around the touchscreen monitor. Adjust the monitor to an appropriate position for viewing.

2

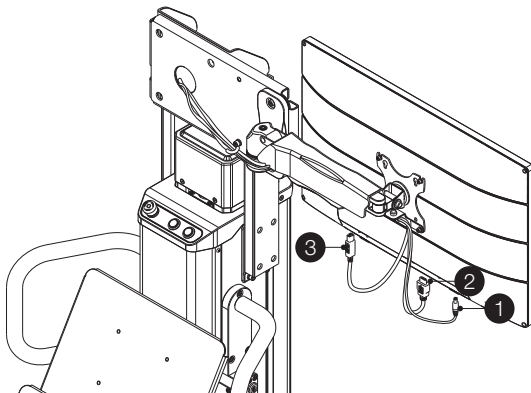

Remove the protective film from the cables. Check that the power cable, HDMI cable, and USB cable are firmly connected to their respective input ports on the touchscreen monitor.

Power Cable (1)

HDMI Cable (2)

USB Cable (3)

## Power up the IA1000WA

1

Plug the power cord at the bottom of the column into a power socket. Press the clip above the power cord on the column to secure it and prevent slipping. Turn on the power switch. The power switch will light up red, the cameras will flash red in a circle, and the touchscreen monitor will light up.

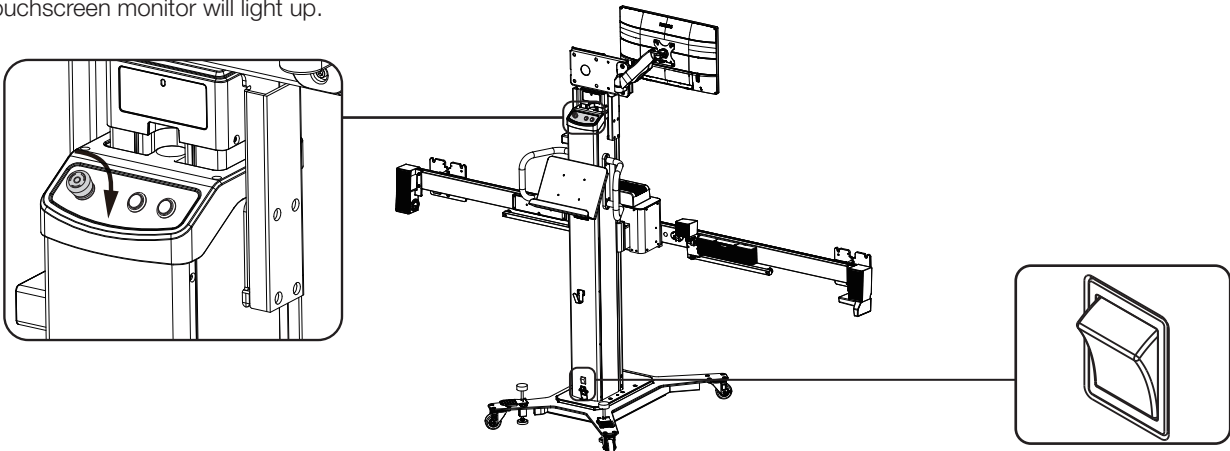

**NOTE:** Check whether the Emergency Stop button is pressed down inadvertently. If so, rotate the button clockwise to release it.

**NOTE:** System power requirements: 100–264 volts AC, < 5 amps, and 50–60 Hz (must be grounded).

# Assemble the Pattern Board

1

Raise the crossbar to the desired position by holding the UP button at the top of the column.

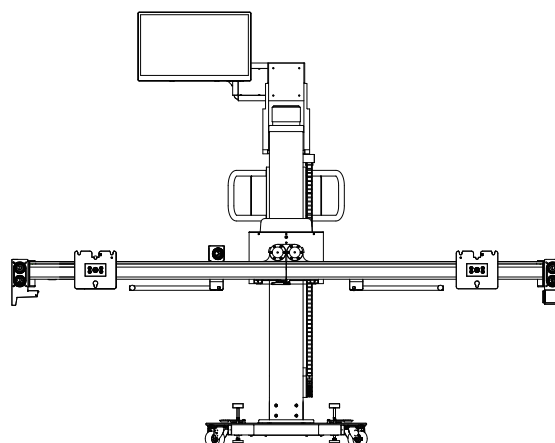
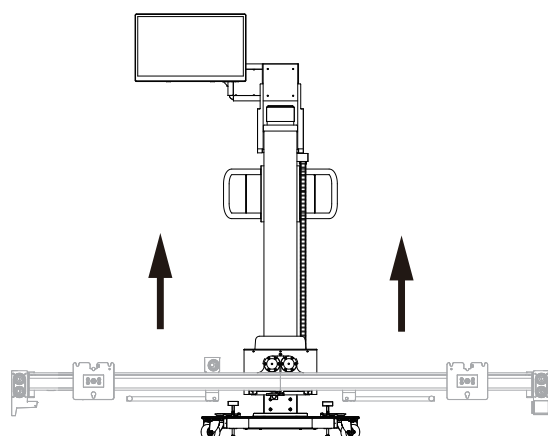

2

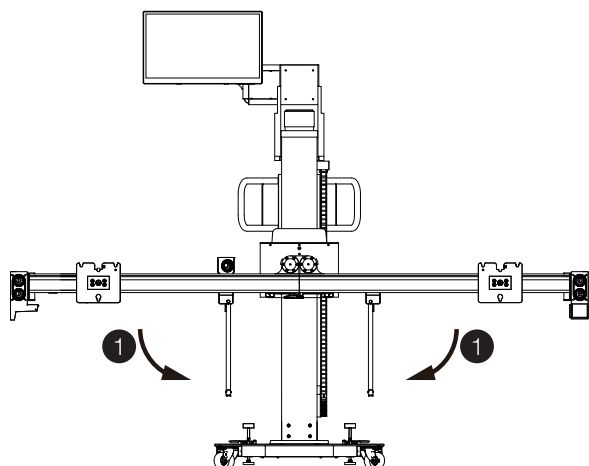

Unfold and straighten the left and right pattern board holders (1) from the crossbar.

3

Align the grooves on the lower edge of the pattern board with the positioning spaces (2) on the pattern board holder ledges. Move the sliding plates towards the pattern board to secure the pattern board in the slots on the sliding plates.

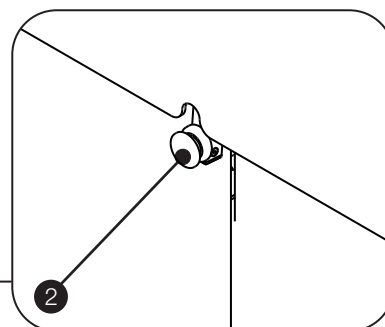
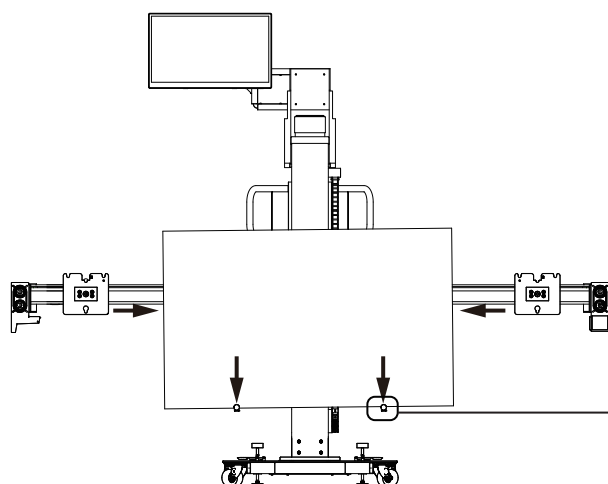

4

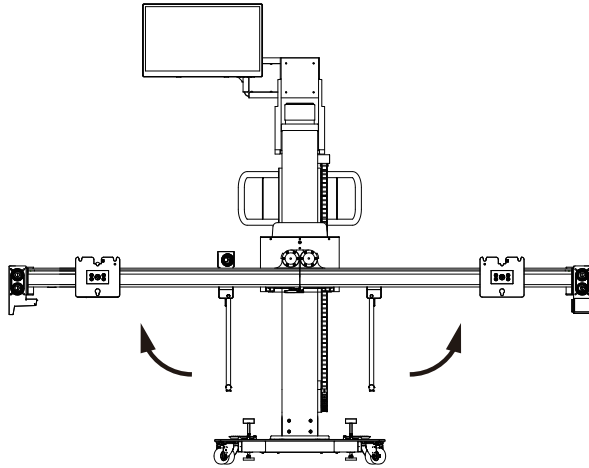

Remove the pattern boards after calibration. Fold the left and right pattern board holders until they lock into the crossbar.

## Fold the Crossbar for Storage

1

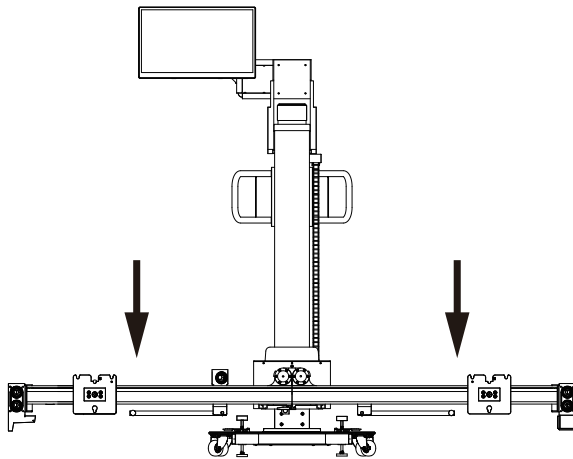

Lower the crossbar to its lowest position by holding the DOWN button at the top of the column.

2

Release the crossbar lock by pressing the release mechanism. Fold both arms of the crossbar 90° upwards.

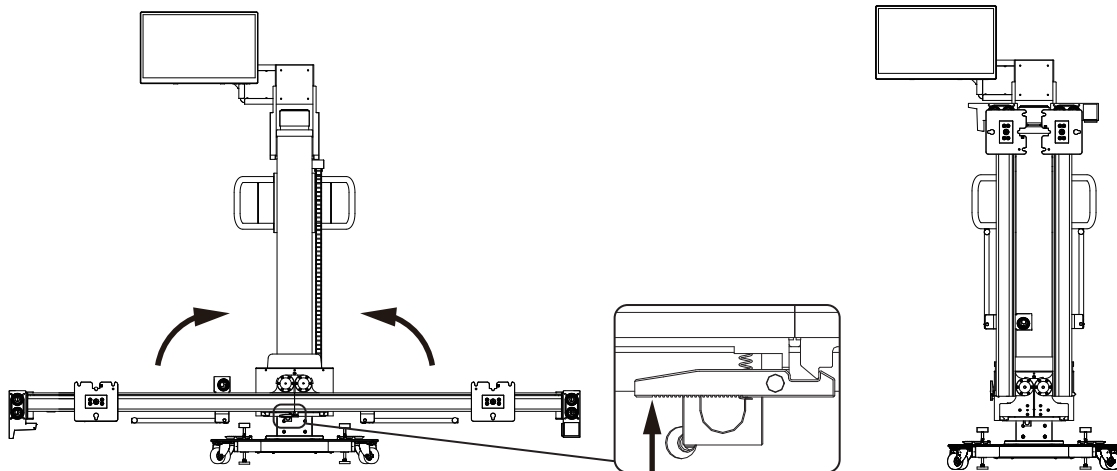

**NOTE:** When folding the crossbar arms, make sure that the sliding plates are not near the folding joint to prevent damage or accidental drops.

**NOTE:** The illustrations in this Quick Reference Guide are for reference only. The actual product may differ.

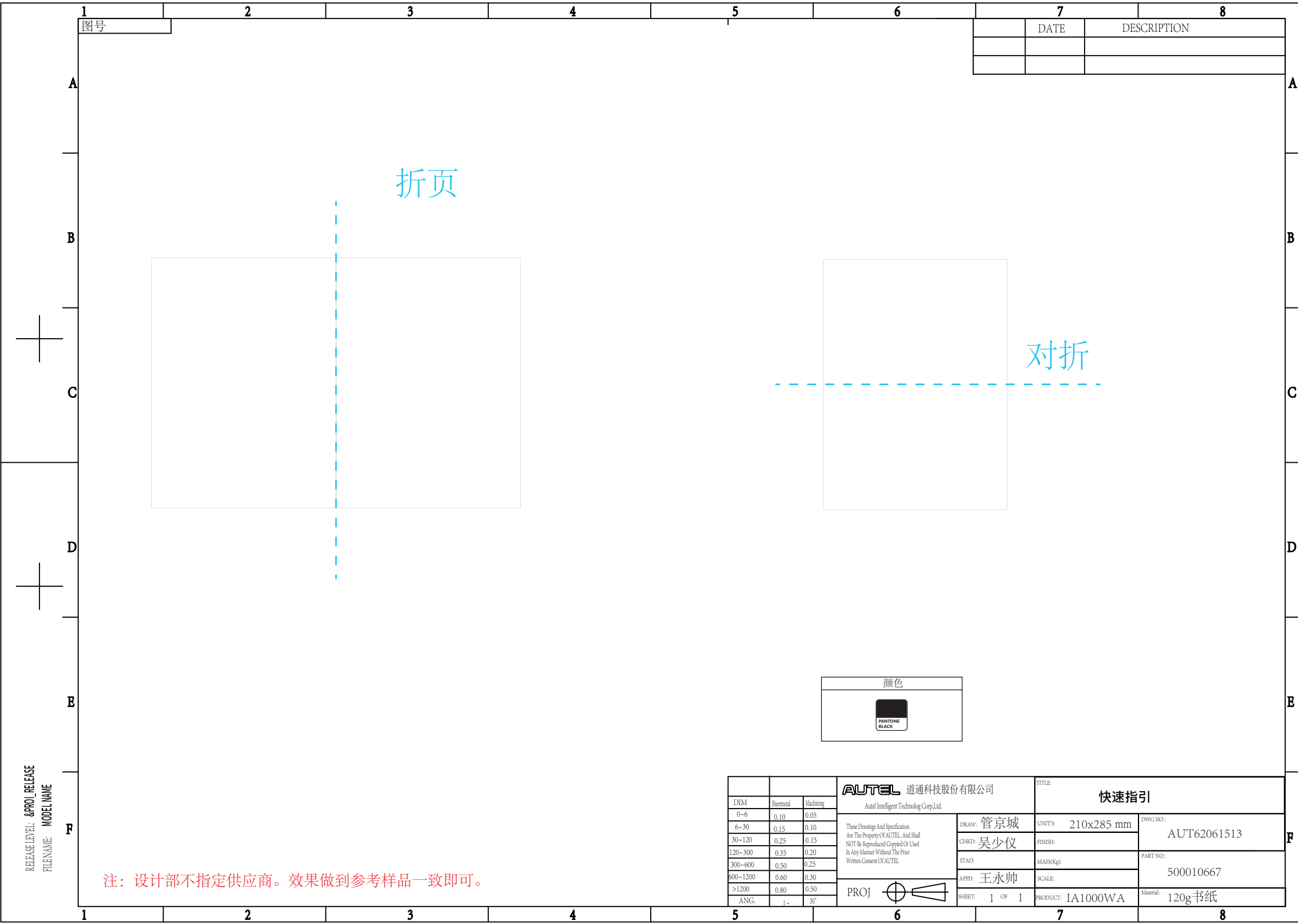

图号

DATE

DESCRIPTION

折页

对折

颜色



			<b>AUTEL</b> 道通科技股份有限公司		TITLE: 快速指引		
			Autel Intelligent Technology Corp.Ltd.				
DIM	Sheetmetal	Machining	These Drawings And Specifications Are The Property Of AUTEL And Shall NOT Be Reproduced Copied Or Used In Any Manner Without The Prior Written Consent Of AUTEL.		DRAW: 管京城	UNIT'S: 210x285 mm	DWG NO.: AUT62061513
0~6	0.10	0.05			CHKD: 吴少仪	FINISH:	
6~30	0.15	0.10			STAD:	MASS(Kg):	
30~120	0.25	0.15			APPD: 王永帅	SCALE:	500010667
120~300	0.35	0.20			SHEET: 1 OF 1	PRODUCT: IA1000WA	Material: 120g书纸
300~600	0.50	0.25					
600~1200	0.60	0.30					
>1200	0.80	0.50	PROJ				
ANG.	1~	30°					

注：设计部不指定供应商。效果做到参考样品一致即可。

FCC Warning:

This equipment has been tested and found to comply with the limits for a Class B digital device, pursuant to part 15 of the FCC Rules. These limits are designed to provide reasonable protection against harmful interference in a residential installation. This equipment generates, uses and can radiate radio frequency energy and, if not installed and used in accordance with the instructions, may cause harmful interference to radio communications. However, there is no guarantee that interference will not occur in a particular installation. If this equipment does cause harmful interference to radio or television reception, which can be determined by turning the equipment off and on, the user is encouraged to try to correct the interference by one or more of the following measures:

- Reorient or relocate the receiving antenna.
- Increase the separation between the equipment and receiver.
- Connect the equipment into an outlet on a circuit different from that to which the receiver is connected.
- Consult the dealer or an experienced radio/TV technician for help.

Caution: Any changes or modifications to this device not explicitly approved by manufacturer could void your authority to operate this equipment.

This device complies with part 15 of the FCC Rules. Operation is subject to the following two conditions:

(1) This device may not cause harmful interference, and (2) this device must accept any interference received, including interference that may cause undesired operation.

This equipment complies with FCC radiation exposure limits set forth for an uncontrolled environment. This equipment should be installed and operated with minimum distance 20cm between the radiator and your body.

## ISED Statement

English: This device contains licence-exempt transmitter(s)/receiver(s) that comply with Innovation, Science and Economic Development Canada's licence-exempt RSS(s). Operation is subject to the following two conditions:

- (1) This device may not cause interference.
- (2) This device must accept any interference, including interference that may cause undesired operation of the device.

The digital apparatus complies with Canadian CAN ICES-3 (B)/NMB-3(B).

French: Cet appareil contient des émetteurs/récepteurs exempts de licence qui sont conformes aux RSS exemptés de licence d'Innovation, Sciences et Développement économique Canada.

L'exploitation est soumise aux deux conditions suivantes :

- (1) Cet appareil ne doit pas provoquer d'interférences.
- (2) Cet appareil doit accepter toute interférence, y compris les interférences susceptibles de provoquer un fonctionnement indésirable de l'appareil.

L'appareil numérique du ciem conforme canadien peut - 3 (b) / nmb - 3 (b).

This device meets the exemption from the routine evaluation limits in section 6.3 of RSS 102 and compliance with RSS 102 RF exposure, users can obtain Canadian Information on RF exposure and compliance.

cet appareil est conforme à l'exemption des limites d'évaluation courante dans la section 6.3 du cnr - 102 et conformité avec rss 102 de l'exposition aux rf, les utilisateurs peuvent obtenir des données canadiennes sur l'exposition aux champs rf et la conformité.

This equipment complies with Canada radiation exposure limits set forth for an uncontrolled environment.

Cet équipement est conforme aux limites d'exposition aux rayonnements du Canada établies pour un environnement non contrôlé.

This equipment should be installed and operated with minimum distance 20cm between the radiator & your body.

Cet équipement doit être installé et utilisé à une distance minimale de 20 cm entre le radiateur et votre corps.

The device for operation in the band 5150–5250 MHz is only for indoor use to reduce the potential for harmful interference to co-channel mobile satellite systems.

L'appareil destiné à fonctionner dans la bande 5150-5250 MHz est uniquement destiné à une utilisation en intérieur afin de réduire le potentiel d'interférences nuisibles aux systèmes mobiles par satellite cocanaux.

This radio transmitter (ISED certification number: 10826A-DA2411) has been approved by Industry Canada to operate with the antenna types listed with the maximum permissible gain indicated. Antenna types not included in this list, having a gain greater than the maximum gain indicated for that type, are strictly prohibited for use with this device. Le présent émetteur radio (ISED certification number: 10826A-DA2411) a été approuvé par Industrie Canada pour fonctionner avec les types d'antenne énumérés ci-dessous et ayant un gain admissible maximal. Les types d'antenne non inclus dans cette liste, et dont le gain est supérieur au gain maximal indiqué, sont strictement interdits pour l'exploitation de l'émetteur.