



PT-50DC

User's Guide

Read this manual carefully before starting and keep the manual in a handy place for future reference.

Confirm the Packing List

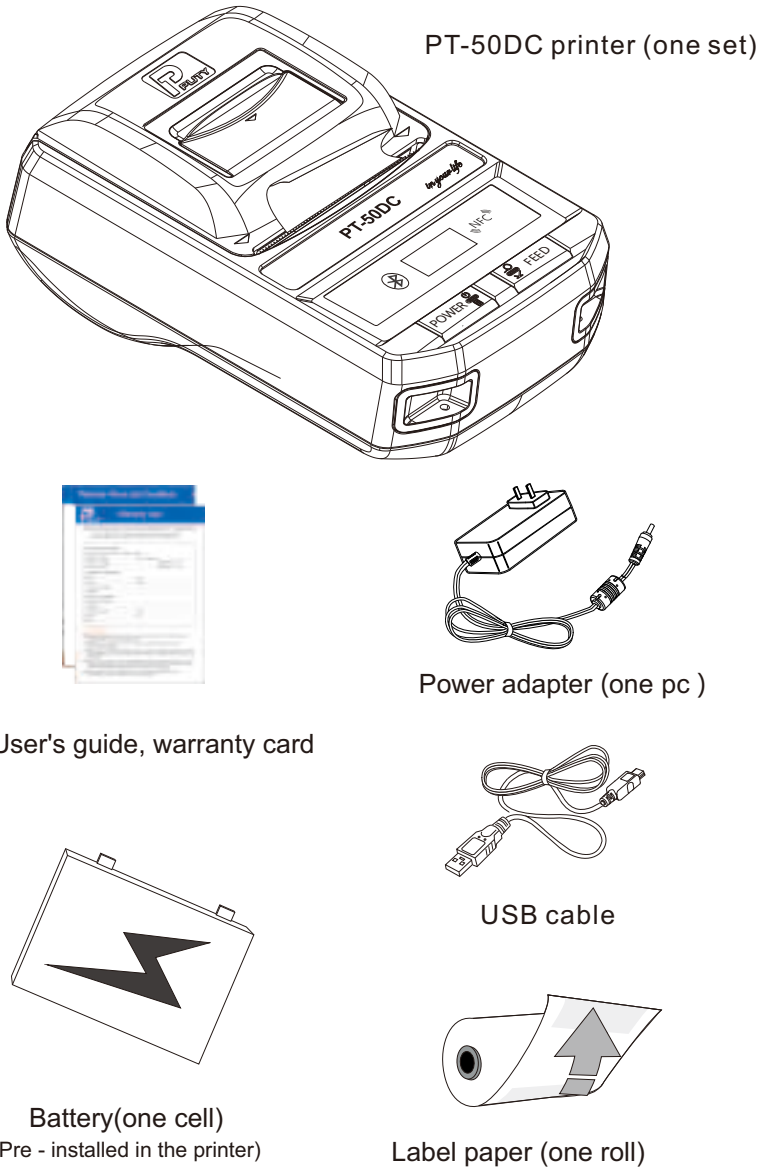

Before Using

Note
Make sure you fully charge the battery before you first using PT-50DC. In order to ensure the best effect of the battery, please charge it fully when it is not in use for long.

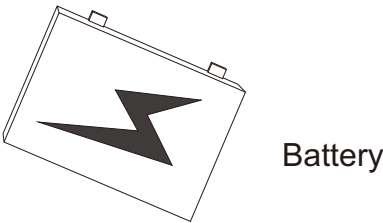

Steps before using, including ribbon loading, battery charging and paper placing.

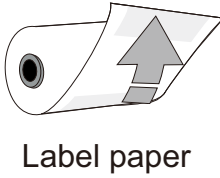

Battery Charging
Insert the AC adapter plug into the electrical outlet, while inserting the DC adapter plug into the DC connector of the printer.

AC:100V~240V(50-60HZ)

Warning
Please use the original adapter only, otherwise it may damage the printer.

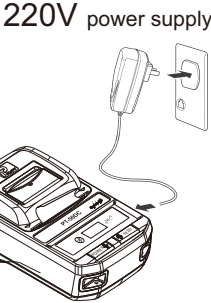

Attention
The printer still works during charging. Don't remove the battery during charging.

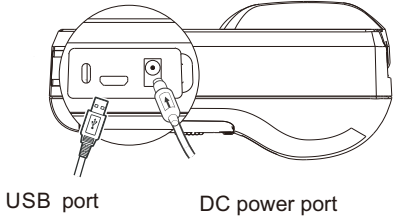

Charging: The power indicator icon flashes
End of charge: The power indicator icon is full and stops flashing.

Label Roll Loading



PT-50DC label printer material:
width:12-52mm
the maximum diameter:50mm

Note
1.Use only PUTY tapes with this machine. Don't use tapes without PUTY mark.

2.Adjust the catch according to the label width and push the ribbon lock to the locked position.
3.Please close the cassette cover after installing the label.

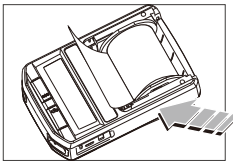

■ Insert the label roll as shown (with the side to be printed on facing down)

Printer Parts

Front

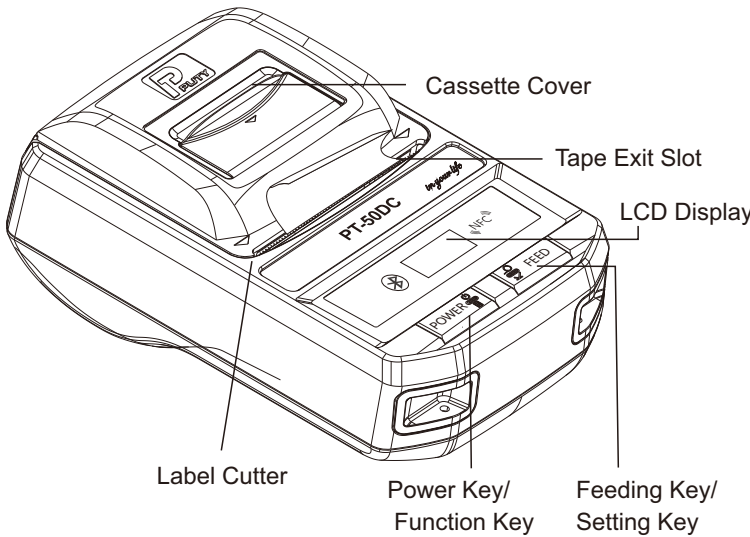

Profile

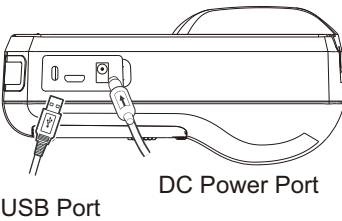

Rear

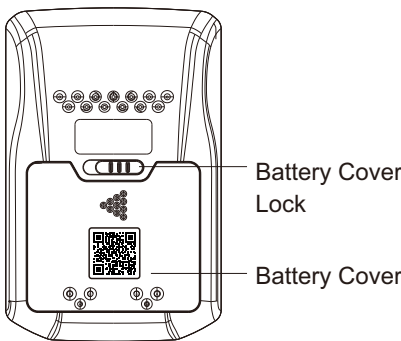

Display Status

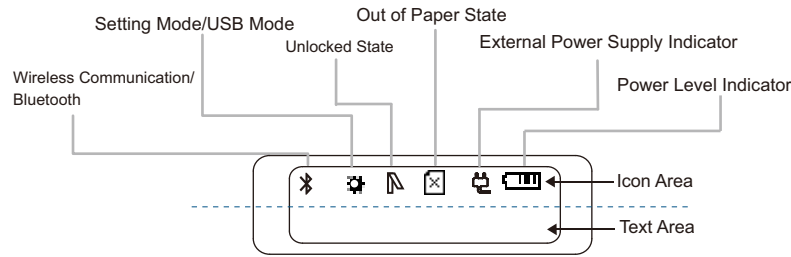

Wireless Communication/Bluetooth
Sign of connected through bluetooth.

USB Mode
Sign of connected through USB.

Setting Mode
Indicates the printer is in setting mode.

Unlock State
Indicates the print head is unlocked.

Out of Paper State
Out of Paper Error. When paper is run out or loaded incorrectly, this sign will be indicated.

External Power Supply Indicator
Indicates an external power supply is connected. when inserting the external power supply, it appears. By taking out the external power supply, it disappears.

Battery Level
While charging this sign flashes. Please charge up at low battery.

Text Area
The area shows some text information.

Basic Functions

Turn On
Press and hold POWER button for 2 seconds to turn on the printer

Power Off
Press the POWER button for 2 seconds, to turn off the printer

Feed Paper
Press the FEED button, take a piece of paper.

Auto Power Off
The printer will turn off automatically after a standby period.

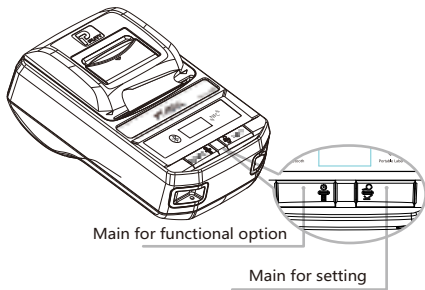

Setting

Initial Settings
You will enter the user's setting interface when the printer turns on.

POWER button:

Toggle Option Language		Language: English/中文	Press the FEED button to set the language of the operation interface
Toggle Option Shutdown Mode		Shutdown Mode Never	Press the FEED button to adjust the mode of shutdown: 10 minutes/20 minutes/30 minutes/never
Toggle Option Paper Type		Paper Type Label paper	Press the FEED button to adjust paper type. Black Mark and Label with re-calibration function

Toggle Option
Automatic Calibration
Auto Calibration Gap
Automatic calibration
Press the FEED button to automatically calibrate Black Mark and Label only

Toggle Option
MAC Address
MAC Address
MAC address
Press the POWER button to show the MAC address of this printer

Toggle Option
Print SelfTest
Print SelfTest
Print SelfTest
Press the FEED button to show the printer's information and the print test

Toggle Option
Factory Settings
Restore to Factory Settings
Restore factory settings
Press the FEED button to restore factory settings

Attention:

You can adjust the printer when you see this icon on the upper left screen.



- 1 POWER button: Short press to enter the setting interface after turning on.
- 2 FEED button: Press it to check that paper can be printed correctly by the printer. If not, make sure that it snaps into place.

Connecting Method

PT-50DC Bluetooth Connecting

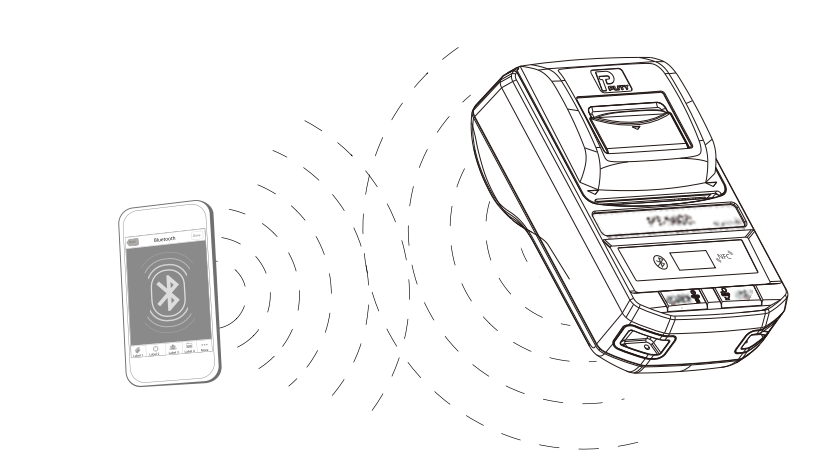

NPC Transmission Connecting

(Non-touch identification and interlinked technology)

If you use a smart phone equipped with NFC function, it will pair, match and connect automatically when approaching to the printer. The phone will load its special label APP automatically to prepare all the work before printing (it will pop up the app for downloading at the first time).

PC Connecting

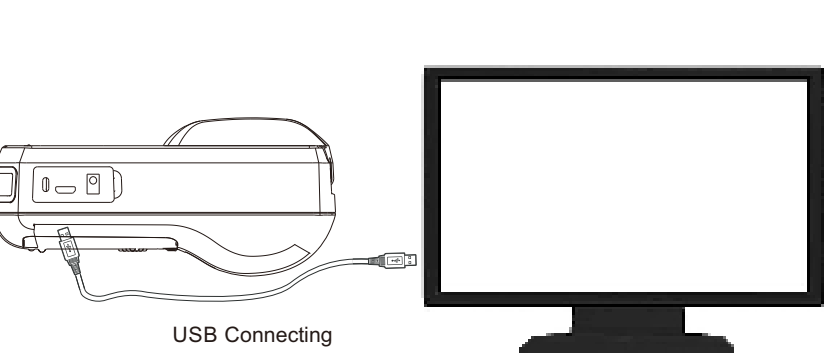

Specification

Printing	
Print method	Thermal printing
output mode	Black and white
Print resolution	203dpi
Dots per line	384dot/line
Print speed	40mm/s
Standby time	500h
Connection mode	USB/Bluetooth/NFC
Positioning mode	Penetration
Printing instruction	LPAPI/Label
Printing contents	Text/Image/Line(JPG, BMP, TIF, JPEG and other types are available)
Barcode printing	1D/2D Barcode
Connection mode	Standard USB, Bluetooth (Android, IOS) , NFC
Printer	
Weight	300g(with battery)
Dimension	130 × 84 × 61(mm)
Temperature	-10 °C ~ 50 °C
Battery	
Type	Li-polymer
Voltage	7.4V
Electricity	1350mAh
Charger	
Input	AC 100-240V 50/60Hz 0.35A
Output	DC 9V/1A
Charge mode	Charging via USB to computer system or power adapter
Consumables	
Type	Continuous length/Die-cut length
Form	Roll
Specification	Max 52mm×50mm(width × diameter)
Thickness	0.05mm ~ 0.25mm

APP Printing

1. Download the APP: Scan the QR code to download the APP. Or use the smart phone equipped with NFC function to open its APP automatically when approaching to the NFC area of the printer



2.The Smart phone equipped with NFC function will open its APP automatically when approaching to the NFC area of the printer

3. When you open this APP and enter the user's interface, the Bluetooth will be connected automatically (you can also pair it manually)

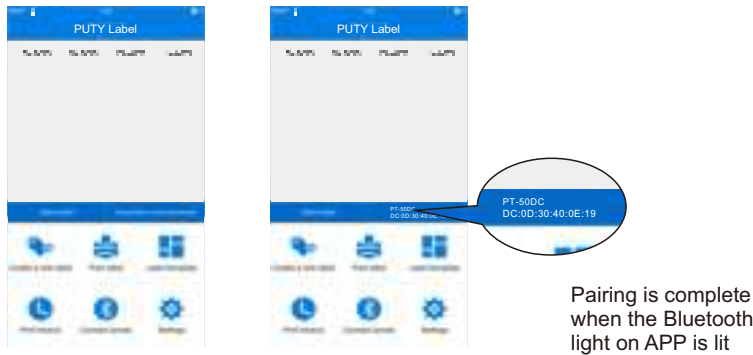

4.Create a new label or load a template

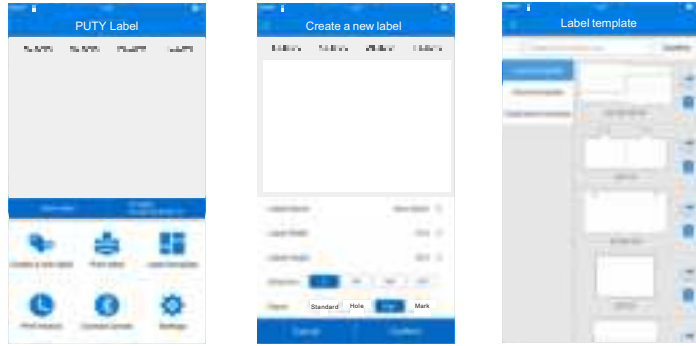

5.Editing



6.Setting



Safety Precautions

Be sure to comply with the following items to avoid damage or loss of property. The following marks used for convenience of reference.

	This symbol indicates danger. Improper use can result in death or serious personal injury or loss of property.
	This symbol indicates warning. Improper use can result in personal injury or material damage.
	This symbol indicates attention. The information listed help you use the product more easily or extend product's life.

Danger

Usage of Battery

- The battery has a circuit protection device. Please do not disassemble the battery, otherwise it will result in a short circuit or electrolyte leakage. Since loss of eyesight may result when leaked fluid from battery gets into your eyes. Please rinse your eyes immediately with a large amount of clean water, and then seek medical attention.
- In case of a short circuit, do not throw the battery into water or fire which will cause heating, smoking, deforming or burning, even explosion.
- Please charge the battery in a cool and dry place. If the battery is exposed to extremely high temperature during charging, it will cause heating, smoking, deforming or burning, even explosion.
- Please do not use the printer near flammable and explosive materials such as gas stations, fuel warehouses, etc.

Warning

Usage of AC Adapter

- Original adapters only, otherwise it may lead to malfunction, such as heating and smoking or further damages like fire or electronic shock.
- No disassembling or modifying the adapter. Do not use the adapter with a damaged power cord, otherwise it may result in electronic shock or further damages like fire or adapter damage.
- Do not pull the wires of AC adapter or put heavy thing on it. Otherwise it may cause a fire or electric shock.
- Do not use the AC adapter in an extremely high temperature.
- Do not connect the AC power adapter in paralle.
- Use only with the specified voltage, otherwise it may cause damage.

Warning

Usage of Battery

- Do not squeeze, mechanically vibrate or shake the battery, otherwise it may result in a short circuit.
- Please do not place the battery in direct sunlight or in dusty and foggy locations.
- Original battery only. Do not replace the battery without any instructions, otherwise it may cause explosion.

Usage of the Printer

- Disconnect the adapter immediately and stop using the printer/adapter if you notice abnormal odor or anything unusual which will prevent being burned.

Caution

Usage of Battery

- Replace the battery when it cannot meet the performance requirements.
- Please store it out of the reach of children.
- Stop using it if you notice discoloration or deformation or anything unusual.

Usage of the Printer

- Please use PUTY original consumables only, otherwise it may cause poor quality printing and damage to core of the printer.
- Do not disassemble the printer without any instructions. Please contact your dealer when in need of maintenance, adjustment and repair (Maintenance will be charged when user dispatch or disassemble the product without any instructions and cause damage even under warranty).
- Do not touch the print head when it is in a high temperature after printing, otherwise it may cause scalding.
- Remove the battery and store it separately if you do not intend to use the printer for a long time, otherwise it may result in battery failure or even fluid leakage which will damage the printer.
- Be sure to turn off the printer before replacing battery. Unplug the power cord if you use the adapter before replacing battery.
- Do not subject the product to any strong force or shock such as dropping, hitting, or standing on the product. Otherwise, damage or injury may occur.
- Do not spill liquid or insecticides on the product. Otherwise damage or injury may occur.
- To avoid injury, do not place or store the product on an unstable place.

Maintenance and Repair

Maintenance Instruction

1. While dusting the outside and paper compartment of the printer:
Please wring out the wet cloth and wipe them gently.
2. While cleaning the print head:
Please clean it occasionally which will help keep foreign matter from getting inside the printer.
You can easily clean it using the following methods:

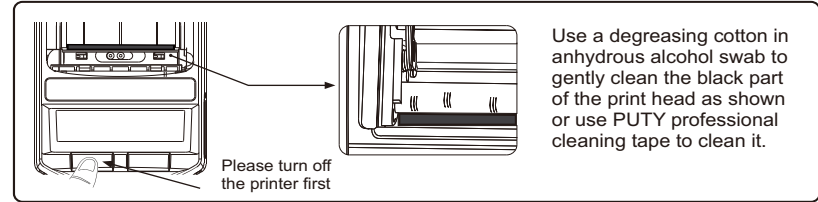

3. If the printer gets soaked in water, please turn it off and remove the battery soon, leaving it in open air.
4. If the printer won't be used for a long time, please remove the battery and store it separately.

Usage and Storage of Printer Consumables

1. The unopened products should be stored in room temperature.
2. Please clean the surface of posted item, when sticking the printer consumables.

Problem	Possible causes	Remedy
When you hear the sound "DI" two times during a short break.	The battery may be weak.	Please charge it in time.
When the printer prints without data.	Install the wrong side.	Please insert it correctly.
The print quality is faint.	The printer has not been cleaned for a long time that the print head was polluted.	Please clean the print head.
	Poor printer consumables.	Please try to adjust the print density and the print quality. Please use PUTY original consumables.
When you hear the sound DING three times.	The print head is not locked tightly when printing.	Please lock the print head tightly.
The labels become faint even for few weeks.	Poor quality consumables.	Please use the original high quality labels and ribbons.
The power turns off when you try to print.	The battery has run out.	Please charge it soon.

Note: Do not use poor quality labels, otherwise it may cause damages to the print head.

Other Precautions

Installation and Handling of the Label Printer

- Avoid pressing backwards when the paper cover is opened to the maximum position.
- Insert the label roll under instructions and pass through the paper guide slot.
- Make sure the print head is in locked status before feeding and printing.
- The print head is a precise and vulnerable part. Please do not touch it with hands or sharp objects directly.
- Please use original power adapter only.

Cautions of the Print Head

- Be sure to disconnect the power of the printer before cleaning it.
- Please disconnect the power of the printer and wait for about 2 to 3 minutes before cleaning the print head.
- Do not touch the heating section of the print head while cleaning it, otherwise static electricity may damage it.
- Attention: Protect your print head from scratches and other damages.

3C Certification Standards

- The 3C Certificate, is China's mandatory product certification system. "CCC" is the abbreviation of "China Compulsory Certification", which is in PRC more commonly known as "3C Certification". In view of protecting the consumers and country and strengthening product's quality, the government of PRC applies this product quality standardization.
- This label printer and power adapter has been certified by PRC of China CCC.
- The User's Guide aims to help the user to use and maintain PT-50DC Label Printer. Some other products or company titles mentioned may be trademarks or registered trademarks of other companies, which we have applied here only for explanation, not involved in tort. All information in this Guide are prohibited to be used, copied or transferred by any company or individual without the formal written authorization of PUTY Technology.

Battery Recycling:

- This product uses rechargeable lithium battery. In order to protect the environment, please do not arbitrarily deal with used batteries.
- Be sure to dispose of used battery in accordance with the relevant regulations.



FCC Statement

This device complies with part 15 of the FCC rules. Operation is subject to the following two conditions: (1) this device may not cause harmful interference, and (2) this device must accept any interference received, including interference that may cause undesired operation.

Changes or modifications not expressly approved by the party responsible for compliance could void the user's authority to operate the equipment.

NOTE: This equipment has been tested and found to comply with the limits for a Class B digital device, pursuant to part 15 of the FCC Rules. These limits are designed to provide reasonable protection against harmful interference in a residential installation. This equipment generates uses and can radiate radio frequency energy and, if not installed and used in accordance with the instructions, may cause harmful interference to radio communications. However, there is no guarantee that interference will not occur in a particular installation. If this equipment does cause harmful interference to radio or television reception, which can be determined by turning the equipment off and on, the user is encouraged to try to correct the interference by one or more of the following measures:

- Reorient or relocate the receiving antenna.
- Increase the separation between the equipment and receiver.
- Connect the equipment into an outlet on a circuit different from that to which the receiver is connected.
- Consult the dealer or an experienced radio/TV technician for help.

The device has been evaluated to meet general RF exposure requirement. The device can be used in portable exposure condition without restriction.