

285.00 mm

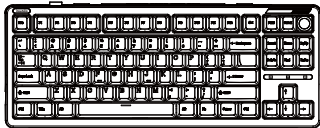

PRODUCT BASIC



Model: 771	Switch and Keycaps: PBT	Keyboard: Mechanical	Type: Cable	Receiver: 2.4G
Material: ABS+PC	Backlight: RGB	Connection: USB-C, 2.4G BT	Adjustment: 8000Hz	Switch: Mechanical switches

WIRED MODE

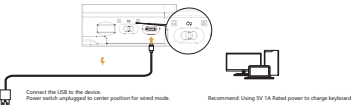

BT CONNECTIVITY

BT Connection Method: As shown in the picture below, the keyboard switch is set to B state.

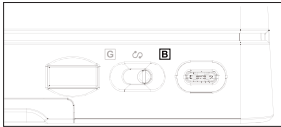

- Place the switch to **B** side.
- To pair the keyboard, press and hold any of the key combinations of **FN+Q/W/E** for 3 seconds. Take **FN+Q** for example, the **Q** key will quickly flash to indicate pairing mode, while a slow flash indicates reconnection mode.
- Turn on the BT of computer/phone/other devices.
- Find and link to the keyboard whose name on the list shows **iloubee BT**.
- Similarly, Repeat the previous steps to connect and pair each desired BT device using the **FN+Q/W/E** key combinations. Short press **FN+Q/W/E** to switch between the stored devices.

(Border reminder: Please pair the 3 BT devices before switching between them.)

BATTERY REMINDER

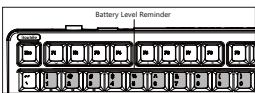

Check battery level in wireless mode **FN+Enter**

For Example:

- The backlight is bright, indicating that the keyboard is 75% of the power at this time.
- The backlight is on at the same time, indicating that the keyboard is 20% of the power at this time.

Similarly

- The backlight is on at the same time, indicating that the keyboard power is 100% at this time.

INDICATOR LIGHTS/KNOB FUNCTION

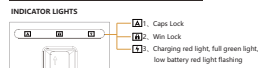

KNOB FUNCTION

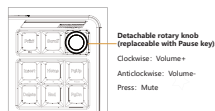

2.4G CONNECTIVITY

2.4G Connection: As shown in the figure below, the keyboard switch is set to G state.

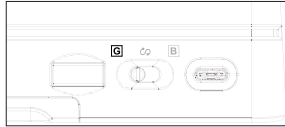

- Place the switch to **G** side.
- Long press **FN+P** to pair insert the receiver when the **P** key rapidly flashes, and successful pairing is indicated when the **P** key stops flashing.
- Slow flashing **P** key indicates keyboard in reconnection mode.

(Note: 2.4G receiver comes pre-paired. This method is only for troubleshooting 2.4G connection issues. Set it up once and no further setup is required.)

DFU MODE

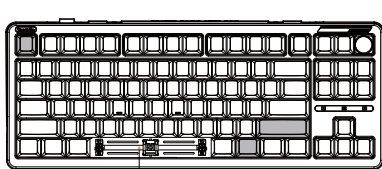

THERE ARE TWO METHODS TO ENTER DFU MODE (DEVELOPMENT/FIRMWARE UPDATES) ON THE KEYBOARD.
Method 1: Press and hold the switch located under the space bar, and then connect the keyboard to the computer.
Method 2: Connect the keyboard to the computer first, and then simultaneously short press the **FN+Q/W/E** key.
These methods allow you to activate the DFU mode on the keyboard, enabling firmware updates and development functionalities.

BACKLIGHT BRIGHTNESS/SPEED SETTING

Fn + I Backlight Brightness +	Fn + Tab New And Hold For Three Seconds To Restore Factory Settings
Fn + ↓ Backlight Brightness -	Fn + B Switch between auto-recovery and full-key rollover
Fn + ← Backlight Speed -	Fn + A Switch to windows system
Fn + → Backlight Speed +	Fn + M Switch to mac system
Fn + Home Home	Fn + Single Single color backlight switching
Fn + Window Lock Window Lock	Fn + Turn Off Turn off the backlight and side lights
Fn + Side Light Side light color switching	Fn + Multiple Multiple dynamic backlight mode switching

Backlight brightness defaults to brightest in USB mode

Backlight brightness defaults to slightly darker in wireless mode

CUSTOM BACKLIGHT SET

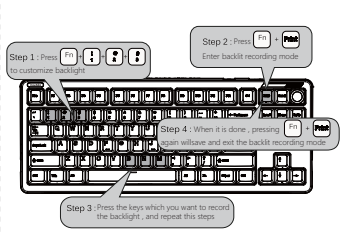

MULTIMEDIA KEY FOR WINDOWS

Windows system(Fn + A: switch to Windows system)

Fn + F1 Computer	Fn + F7 Last Song
Fn + F2 Browser	Fn + F8 Play / Pause
Fn + F3 Mailbox	Fn + F9 Next Song
Fn + F4 Calculator	Fn + F10 Mute
Fn + F5 Player	Fn + F11 Volume-
Fn + F6 Stop	Fn + F12 Volume+

MULTIMEDIA KEY FOR MAC

MAC system(Fn + S: switch to Mac system)

Fn + F1 Screen Brightness -	Fn + F8 Play / Pause
Fn + F2 Screen Brightness +	Fn + F9 Next Song
Fn + F5 Keyboard Backlight Brightness-	Fn + F10 Mute
Fn + F6 Keyboard Backlight Brightness+	Fn + F11 Volume-
Fn + F7 Last Song	Fn + F12 Volume+

FCC COMPLIANCE STATEMENT (USA only)

This device complies with part 15 of the FCC Rules. Operation is subject to the following two conditions:
(1) This device may not cause harmful interference.
(2) This device must accept any interference received, including interference that may cause undesired operation of the device. This digital apparatus complies with Canadian ICES-3 (99MAG-388).
Note: This equipment has been tested and found to comply with the limits for a Class B digital device, pursuant to Part 15 of the FCC Rules. These limits are designed to provide reasonable protection against harmful interference in a residential installation. This equipment generates, uses and can radiate radio frequency energy and, if not installed and used in accordance with the instructions, may cause harmful interference to radio communications.
However, there is no guarantee that interference will not occur in a particular installation.
If this equipment does cause harmful interference to radio or television reception, which can be determined by turning the equipment off and on, the user is encouraged to try to correct the interference by one or more of the following measures:
Reorient or relocate the receiving antenna.
Increase the separation between the equipment and receiver.
Connect the equipment into an outlet on a circuit different from that to which the receiver is connected.
Consult the dealer or an experienced radio/TV technician for help.
Warning: Changes or modifications to this unit not expressly approved by the party responsible for compliance could void the user's authority to operate the equipment.
FCC Radiation Exposure Statement
The device has been evaluated to meet general RF exposure requirements.
The device can be used in portable operation condition without restriction.

ISED STATEMENT

English: This device contains licence-exempt transmitter(s)/transceiver(s) that comply with Innovation, Science and Economic Development Canada's licence-exempt RSS(s). Operation is subject to the following two conditions:
(1) This device may not cause interference.
(2) This device must accept any interference, including interference that may cause undesired operation of the device. This digital apparatus complies with Canadian ICES-3 (99MAG-388).
French: Cet appareil contient des émetteurs/récepteurs exempts de licence qui sont conformes aux RSS exemptes de licence d'Innovation, Sciences et Développement économique Canada.
L'exploitation est soumise aux deux conditions suivantes:
(1) Cet appareil ne doit pas provoquer d'interférences.
(2) Cet appareil doit accepter toute interférence, y compris les interférences susceptibles de provoquer un fonctionnement indésirable de l'appareil.
Répondant aux exigences de la norme canadienne part 3 - 388 / norme - 388
This device meets the exemption from the routine evaluation limits in section 2.5 of RSS 102 and complies with RSS 102 RF exposure, users can obtain Canadian information on RF exposure and compliance and equipment set conforming to the limits of evaluation current data in section 2.5 of the or - 102 in accordance with the 102 of the exposure and if, les utilisateurs peuvent obtenir des données conformes aux l'exposition aux champs et si elle est conforme.
This equipment complies with Canada radiation exposure limits and tests for an uncontrolled environment. Cet équipement est conforme aux limites d'exposition aux rayonnements du Canada établies pour un environnement non contrôlé.

BATTERIES:

- A warning that batteries (battery pack or batteries installed) shall not be exposed to excessive heat such as sunlight, fire or the light.
- 1) Replacement of a battery with an incorrect type that can default a safeguard.
- 2) Disposal of a battery into fire or a hot oven, or mechanically crushing or cutting of a battery, that can result in an explosion.
- 3) Leaving a battery in an extremely high temperature surrounding environment that can result in an explosion or the leakage of flammable liquid or gas.
- 4) A battery subjected to extremely low air pressure that may result in an explosion or the leakage of flammable liquid or gas.

iloubee

The keyboard can support VIA drivers: <https://usevia.app/>
Executive standard GB/T 14081-2010
Made in China