



# QUICK START GUIDE

eufyCam Solo E30



©Anker Innovations Limited. All rights reserved, registered in the United States and other countries.

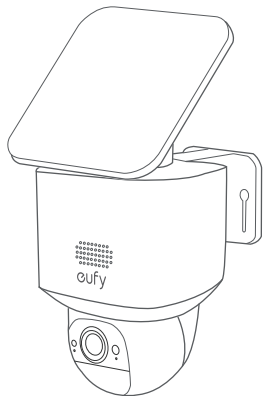

# What's in the Box



eufyCam Solo E30  
(T8171)

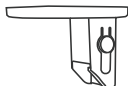

Camera Mounting  
Bracket



Solar Panel



Mounting Bracket of  
the Solar Panel



USB-C Cable  
10 ft (3 m)



USB-C Cable



Screw Pack × 2



Quick Start Guide

# AT A GLANCE

eufyCam Solo E30 Model: T8171

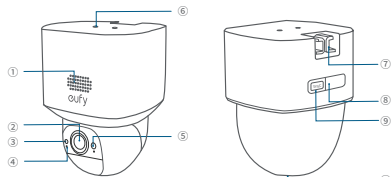

- |                         |                             |
|-------------------------|-----------------------------|
| ① Speaker               | ⑥ Solar Panel Mounting Hole |
| ② Lens                  | ⑦ Mounting Hook             |
| ③ Photosensitive Sensor | ⑧ USB-C Charging Port       |
| ④ Microphone            | ⑨ SYNC Button               |
| ⑤ LED Indicator         | ⑩ SD Card Slot              |

## Solar Panel

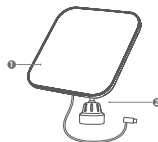

- ① Solar panel    ② Mounting bracket

# CHARGING YOUR CAMERA

Fully charge before first use.

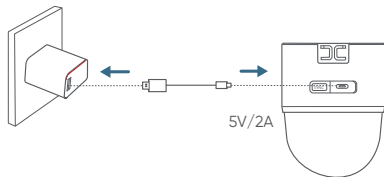

Solid Blue	Charging
Light Off	Fully Charged
Charging Time	8 Hours

# SETTING UP THE SYSTEM

1. Download and install the eufy Security app, then sign in or create an account.



2. Follow the in-app instructions to add the camera to the device list.

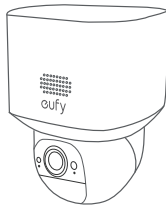
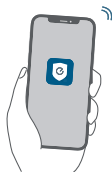

# MOUNTING YOUR CAMERA

## Select a Location and a Height

Select a location where you can get the desired view. We recommend hanging the camera 7-10 ft (2-3 m) above the ground.

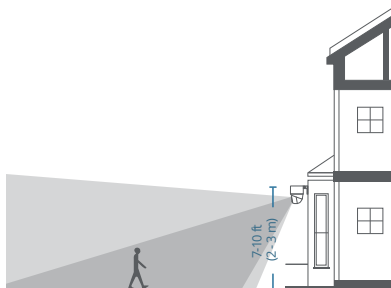

Up to 32 ft (10m)

To ensure that no detection is missed, do not install the camera directly facing the monitoring area. Instead, maintain an angle to avoid any potential blind spots.

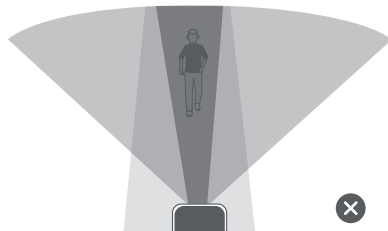
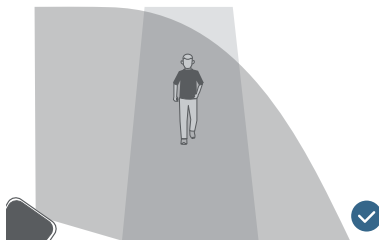

## Select a Solar Panel Location

There are two ways to install the solar panel:

Option 1 - if the camera is blocked, install the solar panel in a different position to maximize the solar panel efficiency.

Option 2 - if the camera is not blocked, install the solar panel directly on the top of the camera.

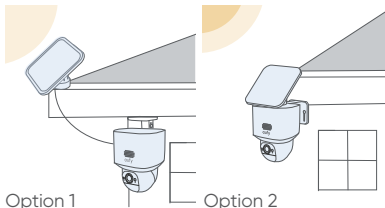

### Option 1: Mount the Camera and the Solar Panel Separately (Best for Strong Solar Power)

The camera can be mounted on a wall or under the eave.

Camera mounted on the wall

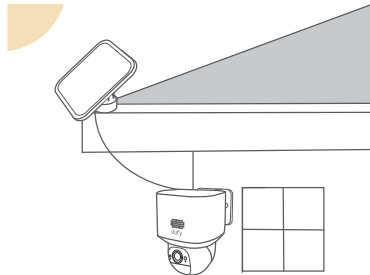

Camera mounted under the eave

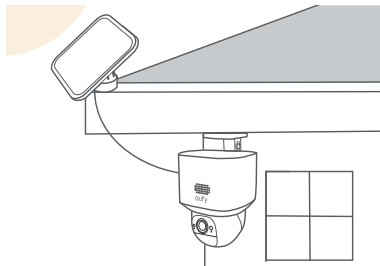

1. Drill holes with a 15/64 inch (5.95 mm) drill bit with the provided positioning card, then insert the anchors into the holes.

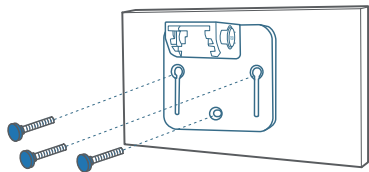
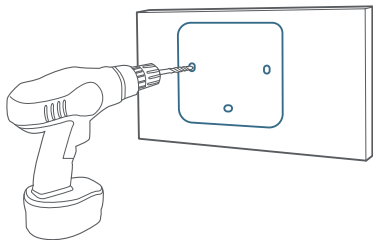

2. Connect the solar panel to the camera using the provided USB-C extension cable.

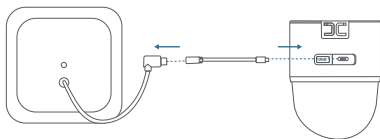

3. Firmly secure the camera onto the mounting bracket.

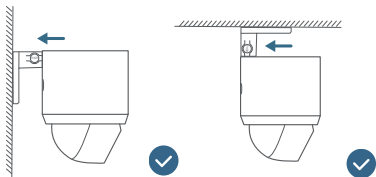



Be careful not to install by mistake.

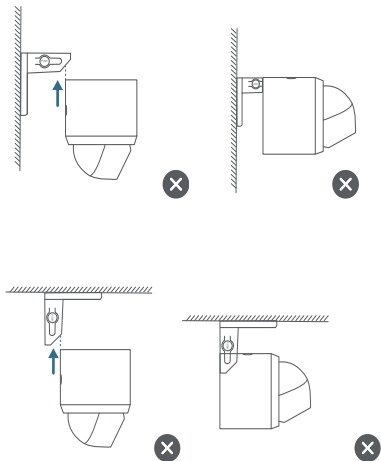

4. Install the mounting bracket of the solar panel in a suitable position.

a. Unscrew the knob of the mounting bracket of the solar panel (1), and remove the supporting piece (2).

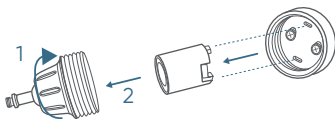

b. Reinstall the supporting piece into the base, and screw the mounting bracket tightly.

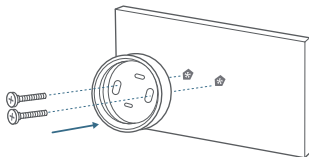

c. Secure the base of the mounting bracket to your desired position with 2 screws.

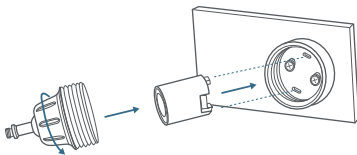

5. Install the solar panel onto its mounting bracket by turning it, then adjust the angle (20°~30° recommended).

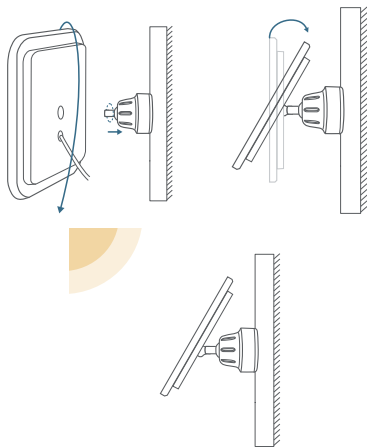

## Option 2: Mount the Camera with the Solar Panel Attached (Less Drilling)

If the camera is not blocked, install the solar panel directly on the top of the camera.

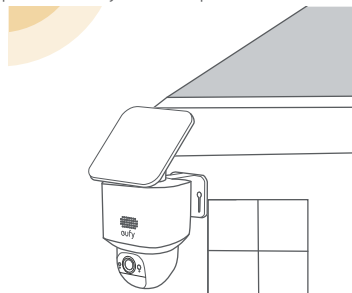

1. Use two 5mm screws to attach the solar panel bracket to the top of the camera.

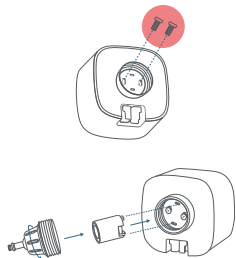



2. Install the solar panel onto the solar panel's mounting bracket by turning it.

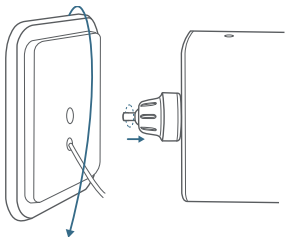

3. Connect the USB-C connector to the USB-C port of the solar panel.

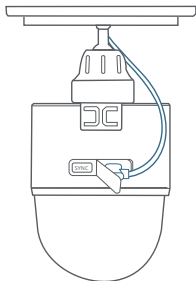

4. Drill holes with a 15/64 inch (5.95 mm) drill bit with the included positioning card, then insert the anchors into the holes.

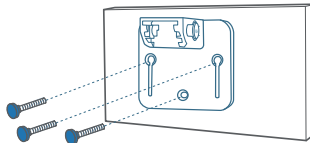
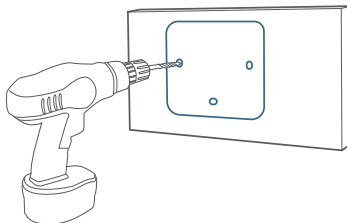

5. Firmly secure the camera onto the mounting bracket and adjust the angle (20°~30° recommended).

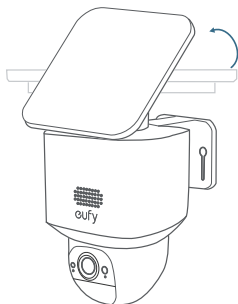

## SAFETY

- The suitable temperature for this device and accessories is -20°C to 50°C (Charging temperature is 0°C to 40°C).
- Unless specifically indicated that it is safe to do so in the user guide or instruction manual, do not use this device in an environment that exceeds the recommended low or high temperature.
- Unless specifically indicated that it is safe to do so in the user guide or instruction manual, avoid exposing your device to direct sunshine or excessively wet environments.
- It is recommended to supply the device in an environment with a temperature that ranges from 5°C to 25°C.
- When supplying power, place the device in an environment that has a normal room temperature and good ventilation.

### Warning:

- Replacing a battery with an incorrect type may bypass safeguards and create danger;
- Disposal of a battery in a fire or other source of significant heat, or by crushing, or cutting, may result in an explosion as well as leakage of flammable liquids and gases;
- Leaving a battery in an extremely hot environment may result in an explosion as well as leakage of flammable liquids and gases;
- A battery subjected to extremely low air pressure may result in an explosion as well as leakage of flammable liquids and gases.

# NOTICE

## FCC Statement

This device complies with Part 15 of the FCC Rules. Operation is subject to the following two conditions: (1) this device may not cause harmful interference, and (2) this device must accept any interference received, including interference that may cause undesired operation.

Warning: Changes or modifications not expressly approved by the party responsible for compliance could void the user's authority to operate the equipment.

Note: This equipment has been tested and found to comply with the limits for a Class B digital device, pursuant to Part 15 of the FCC Rules. These limits are designed to provide reasonable protection against harmful interference in a residential installation.

This equipment generates, uses and can radiate radio frequency energy and, if not installed and used in accordance with the instructions, may cause harmful interference to radio communications.

However, there is no guarantee that interference will not occur in a particular installation. If this equipment does cause harmful interference to radio or television reception, which can be determined by turning the equipment off and on, the user is encouraged to try to correct the interference by one or more of the following measures: (1) Reorient or relocate the receiving antenna. (2) Increase the separation between the equipment and receiver. (3) Connect the equipment into an outlet on a circuit different from that to which the receiver is connected. (4) Consult the dealer or an experienced

radio/TV technician for help. FCC Radio Frequency Exposure Statement

The device has been evaluated to meet general RF exposure requirements. The device can be used in fixed/mobile exposure condition. The min separation distance is 20 cm.

Notice: Shielded cables

All connections to other computing devices must be made using shielded cables to maintain compliance with FCC regulations.

The following importer is the responsible party.

Company Name: POWER MOBILE LIFE, LLC

Address: 10800 NE 8th St #900, Bellevue, WA, 98004, United States

Telephone: 1-800-988-7973

## IC Statement

This device complies with Industry Canada licence-exempt RSS standard(s). Operation is subject to the following two conditions:

(1) this device may not cause interference, and  
(2) this device must accept any interference, including interference that may cause undesired operation of the device.

This Class B digital apparatus complies with Canadian ICES-003.

## IC RF Statement

When using the product, maintain a distance of 20cm from the body to ensure compliance with RF exposure requirements.



Your product is designed and manufactured with high quality materials and components, which can be recycled and reused.



This symbol means the product must not be discarded as household waste, and should be delivered to an appropriate collection facility for recycling. Proper disposal and recycling helps protect natural resources, human health and the environment. For more information on disposal and recycling of this product, contact your local municipality, disposal service, or the shop where you bought this product.

## CUSTOMER SERVICE



12-month limited warranty



(US/CA) +1 (800) 988 7973  
(UK) +44 (0) 1604 936200  
(DE) +49 (0) 69 9579 7960  
( 中国 ) +86 400 0550 036  
( 日本 ) 03 4455 7823  
(AU) +61 3 8331 4800  
(Egypt) +20 8000000826  
(UAE) +971 8000320817  
(Kuwait) +965 22069086  
(KSA) +966 8008500030



[support@eufy.com](mailto:support@eufy.com)

Anker Innovations Limited

Unit 56, 8th Floor, Tower 2, Admiralty Centre,  
18 Harcourt Road, Hong Kong



@EufyOfficial



@EufyOfficial



@EufyOfficial