

When testing the Shock for the first time, place the Test Bulb on the Metal Prongs. The Test Bulb lights up to indicate that the Shock is working, and it will become brighter at higher shock levels.

4.Light Mode

Press and hold the Light Button, the Illuminating Light on the Receiver will be on, while the "L1" icon is shown on the Remote Transmitter. Once release the Light Button, the Illuminating Light on the Receiver will be off.

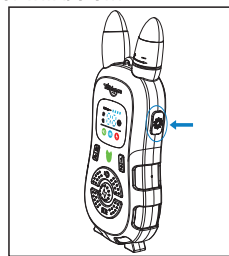

Press
and hold

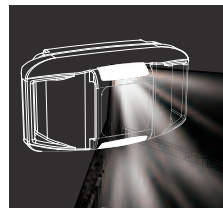

5.Switching Channels

Press the Channel Button twice consecutively to choose the Receiver you want to control if you have paired up two Receivers.

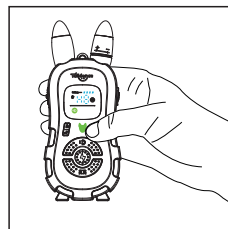

Press 2 times



Reminder:
Press 2 times to
switch the
channels



Note:

The Remote Transmitter will go into the sleep mode if no operation in 20 seconds to saving battery power.

VII. Fitting the Receiver

IMPORTANT:

The proper fit and placement of your Receiver are important for effective training. The Metal Prongs with Silicone Caps must have direct contact with your dog's skin on the underside of his neck. To assure a proper fit, please follow these steps:

1. Make sure that the Receiver is turned off.
2. Let your dog stand on four feet or lay down fully (A).
3. Place the Receiver on your dog's neck close to the ears. Center the Metal Prongs underneath your dog's neck, touching the skin (B).
Note: It is sometimes necessary to trim the hair around the Metal Prongs to make sure that contact is consistent.
4. The Receiver should fit snugly, yet loose enough to allow one finger to fit between the strap and your dog's neck (C).
5. Allow your dog to wear the Receiver for several minutes then recheck the fit. Check the fit again as your dog becomes more comfortable with the Receiver.

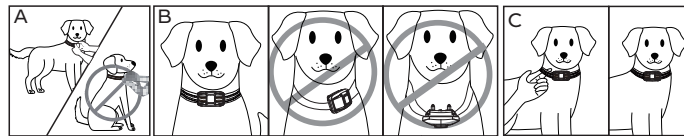

6. Trim the collar as follows (3D):
 - a. Mark the desired length of the collar with a pen. Allow for growth if your pet is young or grows a thick winter coat.
 - b. Remove the Receiver Collar from your pet and cut off the excess.
 - c. Before placing the Receiver Collar back onto your pet, seal the edge of the cut collar by applying a flame along the frayed edge.

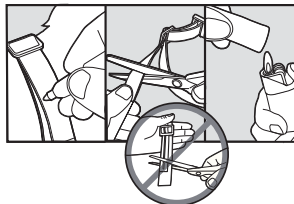

7. To attach the collar to the Receiver, please follow the following steps as instructed to thread the strap.

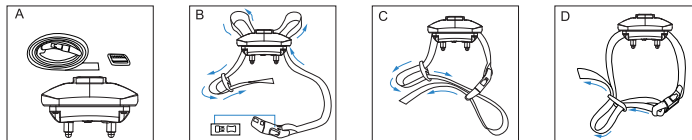

CAUTION:

Risk of Skin Damage. Wearing the collar too long or fitting the collar too tight may cause pressure necroses, which are often misidentified as burns. Please follow the below instructions to avoid pressure necroses:

- **DO NOT** shave the dog's neck as this may increase the risk of skin irritation.
- **DO NOT** leave the Receiver on your dog's neck for continuous 12 hours.
- **NEVER** attach an extra leash to the collar.
- **NEVER** fit the Receiver too tight to your dog's neck.

VIII. Pairing Up

In case of the Receiver is not responding to the Remote Transmitter, follow these steps to pair them up:

1. Press and hold the Power Button on the Receiver for 2 seconds to turn it on. Turn on the Remote Transmitter by turning the On/Off Button to the "ON" side.

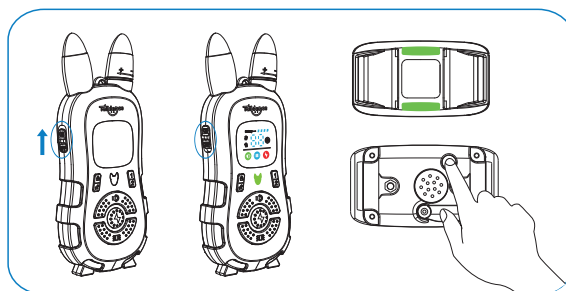

2. Press the Power Button on the Receiver 3 times to enter the Pairing Mode. You will hear a Beeping tone and the LED Indicator light becomes solid green. You will now have 10 seconds to finish the pairing.

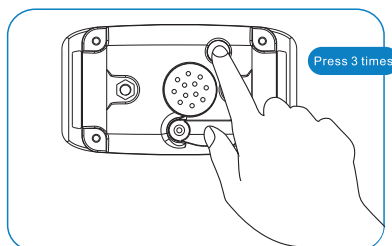

3. Press the Warning Tone Button, Vibration Button or Shock Button on the Remote Transmitter, and the Receiver will respond respectively indicating that the pairing process is completed.

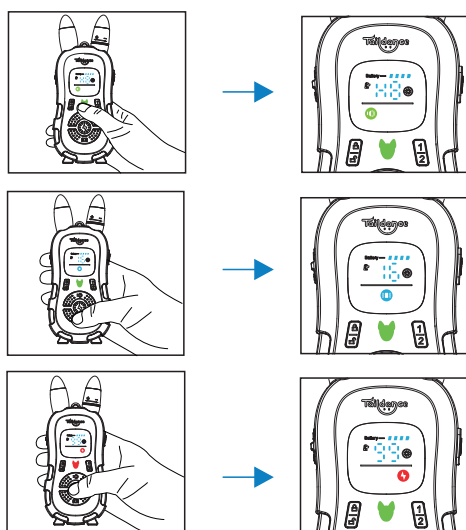



Tips:

The Receiver is paired up to the Remote Transmitter in Channel 1 by factory default setting. If you buy a new Receiver, you can follow the above instruction to pair it up to Channel 2. The system can pair up to 2 Receivers in 2 different channels. If you cannot pair your device successfully, it may be due to signal interference. Please try pairing again in a different location or contact our service center via email: help@pawproshop.com.

IX. Indicator Definitions

Remote Transmitter Indicator :

| | |
|---|---|
| Charging | The Green Indicator light blinks slowly |
| Fully Charged | The Green Indicator light becomes solid |
| Press  | A Green Indicator light comes up |
| Press  | A Green Indicator light comes up |
| Press  | A Red Indicator light comes up |

Receiver Indicator:

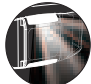
| | |
|---|---|
|  | Slowly blinking indicates the Receiver is on |
| | Fast blinking indicates the Receiver is on charge |
| | Faster blinking indicates the Receiver battery is low |
|  | Light Mode is on |

X. Training Tip

Important: Always start at the lowest level and work your way up. The Remote Training Collar has 8 types of Warning Tones, 16 levels of Vibration, and 99 levels of Shock. For Warning Tones, there are 8 types of Tones, with only frequency differences between the different types. For Vibration and Shock, level 1 is the lowest; the highest level for Vibration is level 16, and level 99 for Shock.

This allows you to choose the Stimulation level that is best for your dog. Once you have placed the Receiver on your dog, it is time to find the Stimulation Level that is best for him. This is called the Recognition Level.

A slight change in your dog's behavior, such as looking around in curiosity, scratching at his collar, or flicking his ears, indicates the Recognition Level that is best for your dog.

Follow the steps below to find your dog's Recognition Level:

1. Starting at Level 1, press the Warning Tone/Vibration/Shock Button continuously for 1 to 2 seconds. Note: When the Warning Tone/Vibration/Shock Button is held down for 10 consecutive seconds, the Remote Transmitter will "time out", and you must release and press the button again before additional stimulation can be delivered.

2. If your dog shows no reaction, repeat the Stimulation Level several times before moving up to the next level.

3. YOUR DOG SHOULD NOT VOCALIZE OR PANIC WHEN RECEIVING STIMULATION. IF THIS HAPPENS, THE STIMULATION LEVEL IS TOO HIGH AND YOU NEED TO GO BACK TO THE PREVIOUS LEVEL AND REPEAT THE PROCESS.

4. Move up through the Stimulation Levels until your dog reliably responds to the stimulation.

5. If your dog continues to show no response at the highest level of Vibration or Static Shock, check the fit of the Receiver. If your dog has long or thick hair, contact our Customer Care Center to obtain a longer set of Metal Prongs. Then go back to Level 1 and repeat the process. If this still does not yield any results, your dog's hair will need to be trimmed around the Metal Prongs.

If after completing all of these steps, your dog still does not indicate he is feeling the stimulation, please contact our customer service.

- Make sure the Receiver has been turned on.
- If your range has reduced from the first time you used the Remote Training Collar, the battery(-ies) may be low in either the Remote Transmitter or Receiver.
- Many factors can impact the amount of range. For a list of these factors, see "How to Maximize the Distance" on page 17.
- Test the Receiver with the Test Bulb.
NOTE: If the Test Bulb does not flash, recharge the Receiver and re-test. If the Test Bulb still does not flash, please contact our customer service.
- Increase the Stimulation Level. Refer to "Find the best stimulation for your dog" on page 17 for more information.
- Make sure the Receiver's Metal Prongs are placed snugly against your dog's skin. Refer to "Fitting the Receiver" on page 14 for more information.

2.The Receiver will not turn on.

- Make sure the Receiver has been charged. For the initial charge, be sure to charge it for 4 hours. Subsequent charges only take 2-3 hours.

3.The Receiver is not responding to the Remote Transmitter.

- Verify the Receiver is on.
- If the indicator is blinking rapidly, fully charge the Receiver.
- If the first two solutions did not resolve your problems, please check the "How to pair the Remote Transmitter & Receiver" section.

XIII. FCC Statement

USA

This device complies with part 15 of the FCC Rules. Operation is subject to the following two conditions: (1) This device may not cause harmful interference, and (2) this device must accept any interference received, including interference that may cause undesired operation.

Any Changes or modifications not expressly approved by the party responsible for compliance could void the user's authority to operate the equipment.

NOTE:

This equipment has been tested and found to comply with the limits for a Class B digital device, pursuant to part 15 of the FCC Rules. These limits are designed to provide reasonable protection against harmful interference in a residential installation. This equipment generates, uses, and can radiate radio frequency energy and, if not installed and used in accordance with the instructions, may cause harmful interference to radio communications.

However, there is no guarantee that interference will not occur in a specific installation. If interference does occur to radio or television reception, which can be determined by turning the equipment off and on, the user is encouraged to try to correct the interference by one or more of the following measures:

- Reorient or relocate the receiving antenna.
- Increase the separation between the equipment and the receiver
- Connect the equipment to an outlet on a circuit different from that to which the receiver is connected.
- Consult customer care, the dealer, or an experienced radio/TV technician for help.

How to Maximize the distance?

Terrain, weather, vegetation, transmission from other radio devices, and other factors will affect the maximum range. Hold the Remote Transmitter in a horizontal position away from your body to achieve optimum range. For maximum signal strength, keep the device properly charged.

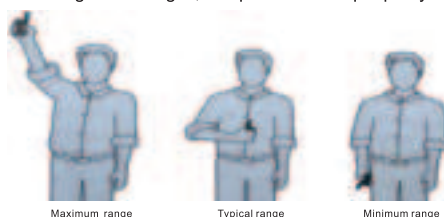

*Avoid touching the antenna or the range may decrease substantially.

XI. Frequently Asked Questions

Q: Is the Stimulation safe for my dog?

A: While the Stimulation is unpleasant, it is harmless to your dog. Electronic training devices require interaction and training from the owner to achieve desired results.

Q: How old does my dog have to be before using the Remote Training Collar?

A: Your dog should be able to recognize basic obedience commands such as "Sit" or "Stay". Dogs should be at least 6 months old before using the Remote Training Collar.

Q: Once my dog is trained and has been obeying my commands, will he have to continue to wear the Receiver?

A: Probably not. You may need to reinforce training with the Receiver from time to time.

Q: Is the Receiver waterproof?

A: Yes. The Receiver meets the IP67 waterproof rating, but make sure to keep the area dry when charging.

Note: Remote Transmitter is not waterproof.

Q: Will I get a maximum range with the Remote Training Collar?

A: The range of the Remote Training Collar will vary according to terrain, weather, vegetation, as well as transmission from other radio devices. See "How to Maximize the Distance" on page 17 for tips on maximizing your range.

Q: How long can I continuously deliver stimulation to my dog?

A: The maximum amount of time you can press the Warning Tone/Vibration/ Shock button and deliver stimulation to your dog continuously is 10 seconds. After this, the Remote Transmitter will time out, and these stimulation buttons must be released and pressed again.

XII. Trouble Shooting

1. My dog does not respond when I press a button.