



SKU Listing Info:	93128850 NPI C by GE WIFI Camera 6083627 Q2
Version# (date) PA:	5 (09-21-20) CN
Bar Code Spec:	<input type="checkbox"/> 100% No BWR <input type="checkbox"/> 80% No BWR <input checked="" type="checkbox"/> N/A
Insert (if shared):	None
Supplier Project#:	N/A
Print Method:	<input type="checkbox"/> Offset/Litho <input type="checkbox"/> Flexo (direct)
GE DIE#:	NOT CONTROLLED
PK#:	PK-00105711-1

 Lighting Graphics Approval Approvals designate all items on checklist have been reviewed & are correct in addition to other organizational responsibilities.		
REVIEWED DATE	SIGNATURE	PACKAGING GRAPHICS
<hr/>		
<input type="checkbox"/> Proof Reading – Spelling	<input type="checkbox"/> Website	
<input type="checkbox"/> Proof against TDS request	<input type="checkbox"/> Graphics Printability	

PC93128850 QSG

This art is supplied at 100% size. Do not resize, reshape or alter in any way.

BACK COVER

FRONT COVER

9"

INSIDE page 1

INSIDE page 2

9"

Controls & Connections

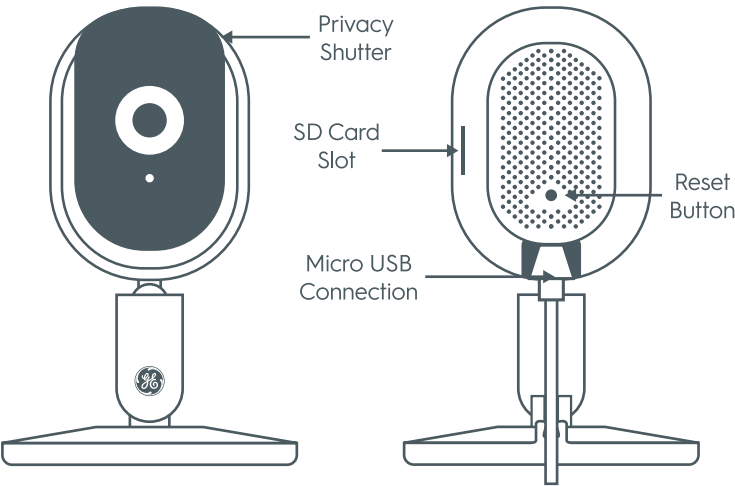

PK-00105711-1



Indoor Smart Camera Quick Start Guide

Let's see what your Smart Camera can do:

①

Enable Privacy Mode.

To enable privacy mode, manually slide privacy shutter **up**. This disables audio and video functionality.

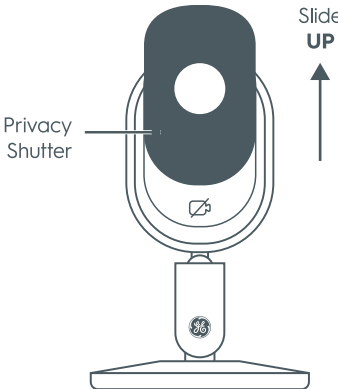

②

Disable Privacy Mode.

To disable privacy mode, manually slide privacy shutter **down**. This restores audio and video functionality.

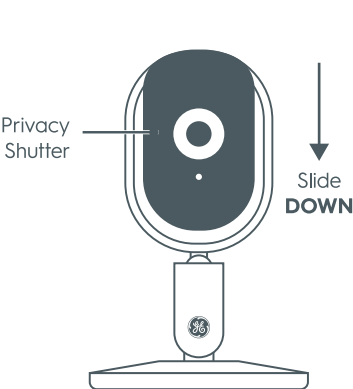

Video Storage & Resetting

Choose Your Storage Option:

Cloud Storage

Your camera comes with a free trial of our premium Cloud video storage solution.

Your video will be stored in our secure Cloud accessed by two factor authentication.

SD Drive

Store all of your content locally on an SD card (sold separately) using the camera's built in SD drive.

How to Factory Reset Your Camera:

- Locate the pin hole on your camera.
- Press and hold the button for 3+ seconds.
- You can let go when the LED light turns red.

