



# INMOTION



## User's Manual

# 使用手册

## 1. Introduction

INMOTION V3 is a self-balancing unicycle type SCV (Sensor Controlled Vehicle). It is stylish, fun and practical, integrated with a unique hidden draw-bar, auto-switch lights, a touch screen, a slide-to-open charging port and built-in high quality Bluetooth speakers. INMOTION V3 is easy to learn, safe to ride, practical to commute.

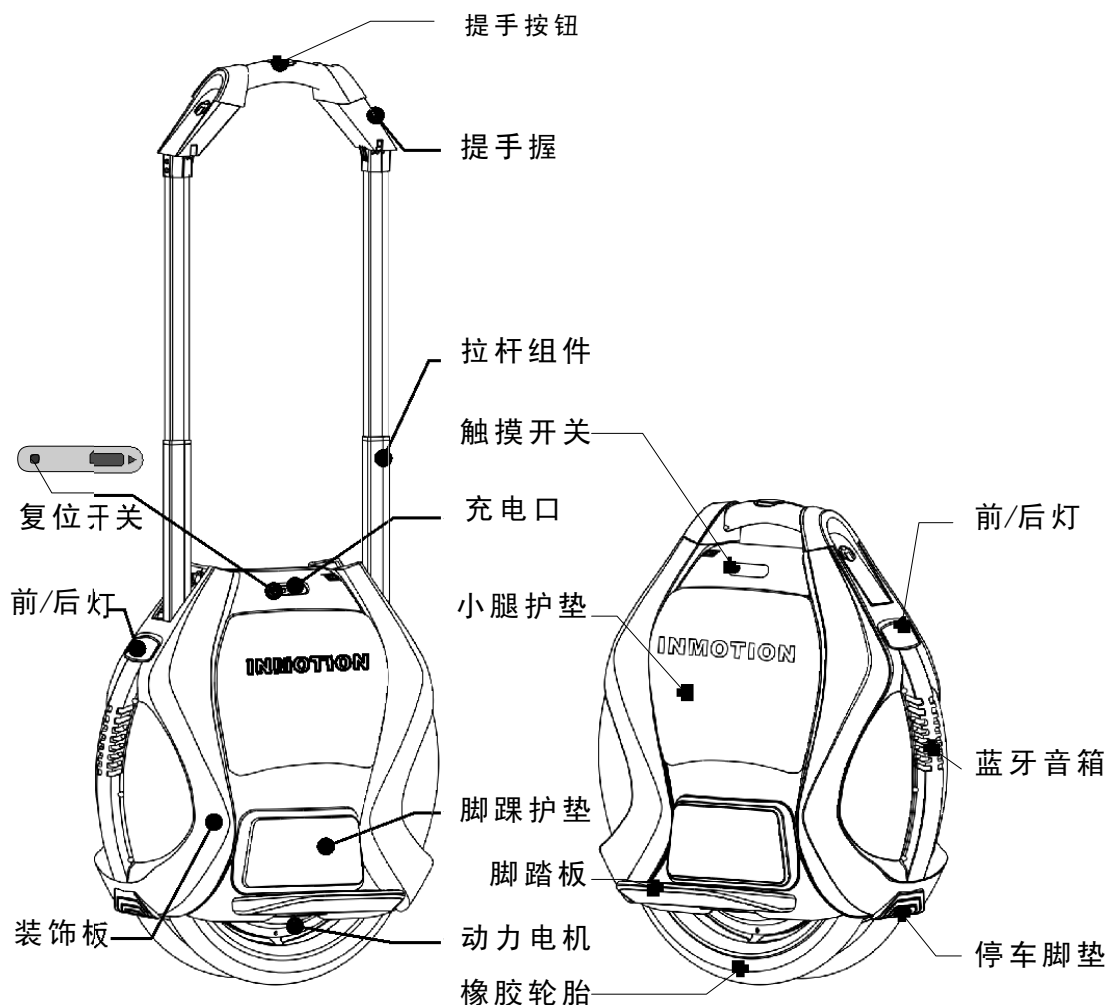

提手按钮 Draw-bar Button

提手握 Handlebar

拉杆组件 Draw-bar Assembly

复位开关 Reset Button

充电口 Charging Port

前/后 灯 Lights

装饰板 decorating plate

脚踝护垫 Ankle Pad

动力电机 Motor

触摸开关 Touch Screen

小腿护垫 Calf Pad

蓝牙音箱 Bluetooth Speaker

脚踏板 Footboard

停车脚垫 Stop-stand Rubber

橡胶轮胎 Tire

## 2. Packaging

INMOTION V3 package includes the following parts when leaves the factory. Please check carefully before using the product, any missing or visible damaged parts should be reported to your dealer immediately.

1	INMOTOIN V3	2	User's manual
3	Charger Adaptor	4	Warranty card, Product Certificate

## 3. Safety Alert

INMOTION V3 balances front and back, and stands by itself with its two tires. INMOTION V3 is a reliable product and it has gone through many rigid tests. Due to its new idea of driving, we still ask you to follow all the instructions in this manual and be careful with all the warnings and cautions.

You may risk falling off/over, crashing, losing control of the vehicle and so on if you do not follow the instructions to ride INMOTION V3. Again please carefully and thoroughly read this manual and watch related safety videos.

### 3.1 Warning

- Wear a helmet, elbow and knee protection when riding the INMOTION V3.
- Do not ride on steep slopes that are over 20 degrees.
- Do not accelerate and decelerate hardly or abruptly on the slopes.
- Pay attention to obstacles and be careful of skid when riding the INMOTION V3.
- Do not ride on grass.
- Do not ride on pebble roads or any other unsmooth surfaces.
- Do not drive into water that is over 170 mm.

### 3.2 Prohibition

- Do not go up and down stairs or spring off the ground with the INMOTION V3.
- Do not ride the INMOTION V3 on motor roads. Some local authorities forbid the use of Sensor Controlled Vehicles on public roads and sidewalks. Please consult local authorities to become familiar with applicable laws and regulations before riding.
- Do not dip the INMOTION V3 into water.
- Do not drive the INMOTION V3 over 20 km/h (12 mph).
- Do not accelerate hardly when the INMOTION V3 is not totally balanced.
- Do not sit on the draw-bar or any other parts when riding.

## 4. General Information

### 4.1 Dimensions

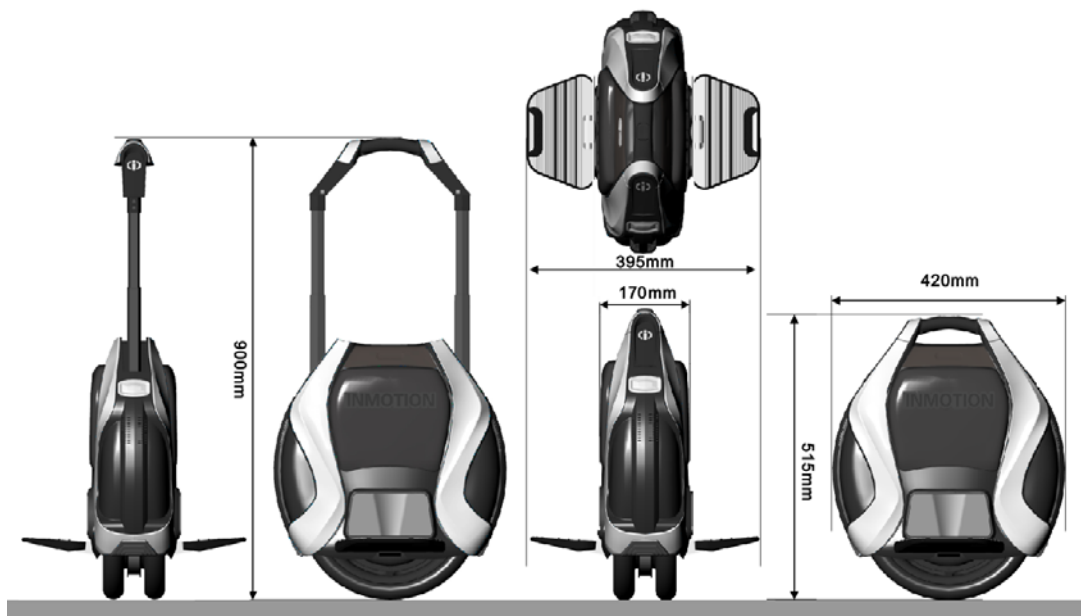

Figure 2.1 INMOTION V3 Dimensions

## 4.2 Display Panel

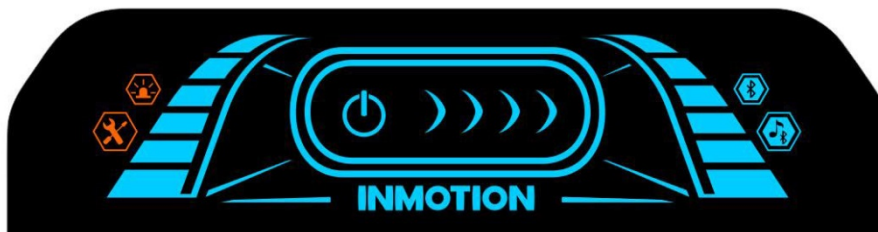

Figure 2.2 Display Panel

Light

Power

Slide Direction

## 5. How to Use

### 5.1 Power On

Touch the Power icon and gently slide towards the arrow direction (Figure 3.1).

### 5.2 Hibernation and Shutdown

- Touch the Power icon and slide towards the arrow direction to hibernate the system. In between you may also hear a sound prompt. In hibernation mode, if the system is left unoperated for 2 hours, the system will automatically shut down.
- You can directly shut down the system in hibernation mode by pressing the end of the scrolling bar for about 5 seconds.
- If the remain power is less than 10%, the hibernation action will also directly shut the system down.

**Tip:** if the touch panel is not responding, or the system cannot be shut down in an emergent situation, please lay flat the INMOTINO V3 for 2 times in 3 seconds and you will hear “Please be careful”, then you can possibly shut down the system.

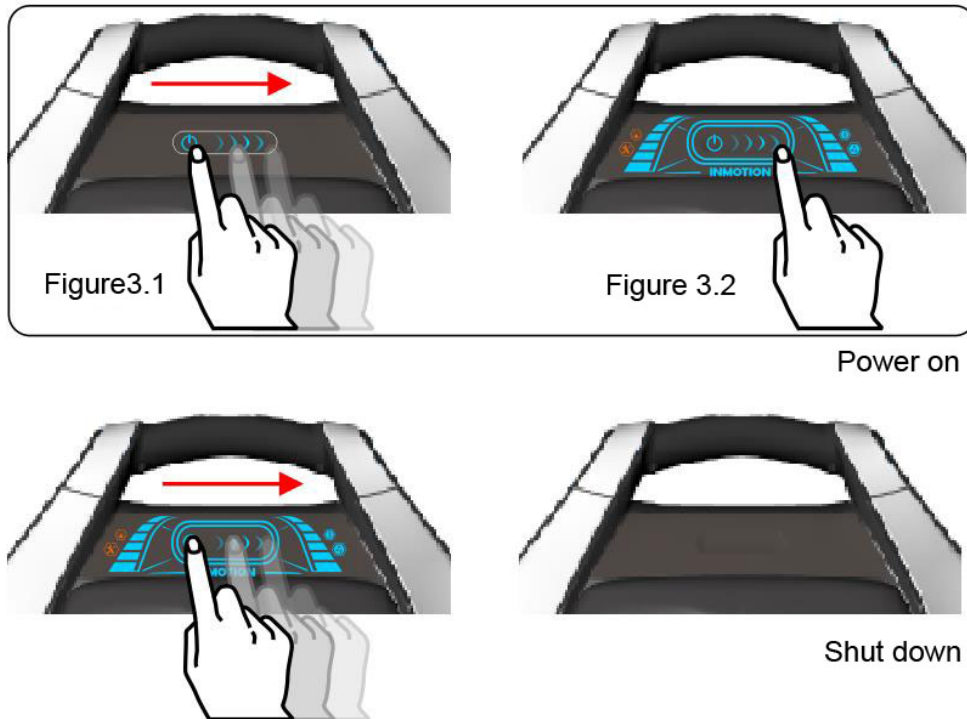

### 5.3 Light

Power on the system and slide your finger from right end to left end (towards the opposite arrow direction), the lights on both sides will be illuminated in white. Roll the INMOTION V3 in a direction, the front light will illuminate in white with full brightness and the back light will turn into red. The lights will automatically change in white and red according to the riding direction of INMOTION V3.

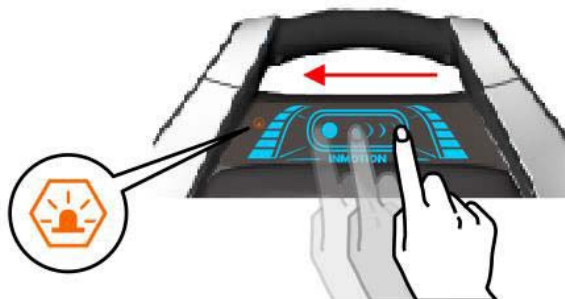

Figure 3.3

### 5.4 Bluetooth Speaker

The built-in Bluetooth module is automatically activated when the INMOTION V3 is

6<sup>TH</sup> FLOOR, BUILDING 8, TONGFUYU INDUSTRY CITY, XILI, NAN SHAN, SHEN ZHEN, CHINA 518055  
Tel: 0755-25722469 Fax: 0755-25727563

powered on.

Turn on Bluetooth on your cellphone, search and pair the Bluetooth signal of the INMOTION V3 (Figure 3.4). If the signals are successfully paired, you may play music through the INMOTION V3's Hi-Fi loud speakers.

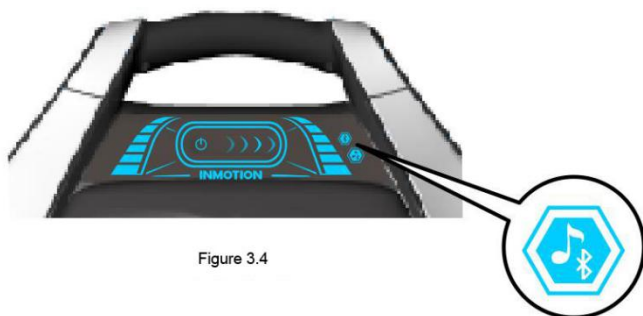

Figure 3.4

## 5.5 Assist Mode

Press down the draw-bar button, pull up the handle till the highest and then release the button. Now you can trolley the INMOTION V3 like a suitcase.

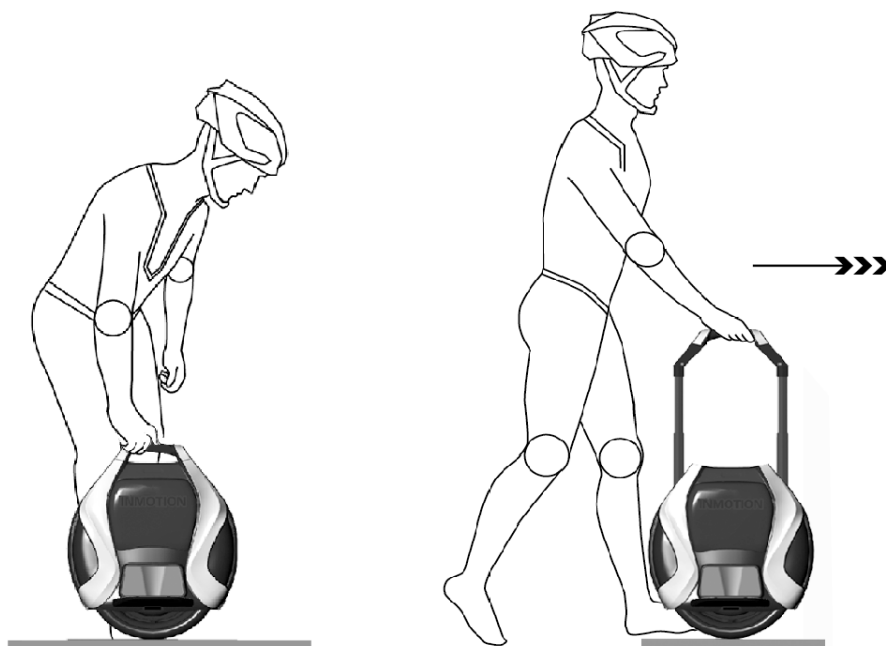

Figure 3.5

## 5.6 Power Indicator

There are two battery indicators along the two sides of the touch panel. Each has 6 bars, if the power is over 90%, all 6 bars are illuminated, and if the power is less than 20%, only 1 bar

will be illuminated.

## 5.7 Charge INMOTION V3

Slide to open the charging port to charge. If the INMOTION V3 is charging, the charging indicator on the Charger Adapter illuminates in red and the Battery Indicator Bars are rolling up and down. If the INMOTION V3 is fully charged, the charging indicator is in blue.



Figure 3.6

## 5.8 Voice Prompt

The system's default prompt language is Chinese or English, you can change to other languages IF available through INMOTION APP. Here below are some basic voice prompts:

1	Welcome	2	Hibernation
3	Lock	4	Unlock
5	Low Battery	6	Charging
7	Power full	8	Overload, please get off
9	Light is on	10	Light is off
11	Please slow Down	12	Power off
13	Please Repair	14	Please don't move the device
15	Data Bluetooth connected	16	Data Bluetooth disconnected
17	Music Bluetooth connected	18	Music Bluetooth disconnected
19	Please be careful	20	



## 5.9 Reset

When unknown errors or abnormal situations occurred, you can press the Reset button to turn off the INMOTION V3 completely.

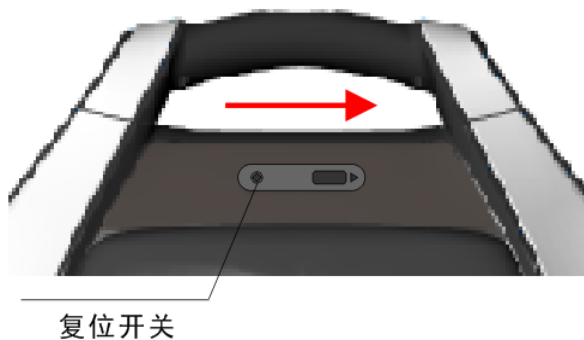

The Reset button can be seen after sliding the charging port cover to the right and it is on the left side of the charging port.

## 5.10 Water and Dust Proof

V3 is rated IP55 for water and dust proof. It can maximally pass through 170 mm deep water.

## 5.11 Over Speed Protection

When the speed is over 18 km/h (11 mph), the footboard will lean back at about 3~4°. The rider can continuously drive at the current speed. If the speed over 20 km/h (12 mph), the footboard will lean back to protect the rider's safety.

## 5.12 Side-tipping Protection

When the INMOTION V3 is side tipping over 45°, it will regard it as an abnormal situation and will exit balance mode, while there will be a voice prompt "Please be careful". Place the INMOTION V3 to stand and then it will automatically balances itself again.

## 5.13 Over Discharge Protection

The system of INMOTION V3 will automatically cut off the entire power when the battery is

low under hibernation or power off mode. Low battery will make INMOTION V3 to lean back to warn the rider, there will also be a voice prompt.

The system will protect the battery from over discharging when it is powered off. You may wake the V3 by charging the battery, if the INMOTION V3 is still not awaken please contact your dealer for a diagnosis.

## 5.14 Smart Phone Application

The Application for INMOTION V3 works via Bluetooth 3.0 to connect the vehicle, it is suitable for Android 4.3 and above, iOS 7.0 and above (iPhone 4s and later models only). Some functions are listed as below:

1	My SCV	2	Parameter settings
3	My Profile	4	My Route
5	Firmware Update	6	Sound Customization
7	Social	8	Diagnosis
9	Log	10	Service

For more information about the INMOTION APP, please visit [www.imscv.com](http://www.imscv.com)

## 6. Maintenance

### 6.1 Deposit

Inappropriate store the INMOTION V3 may cause damage to the battery, please pay special attention to below warnings.

- The best storage temperature is about 20 °C (68 °F). Too high or too low temperature should be avoided.
- Please avoid strong humidity.
- Please charge the INMOTION V3 at least one time a month event it is powered off.

### 6.2 Inflation

6<sup>TH</sup> FLOOR, BUILDING 8, TONGFUYU INDUSTRY CITY, XILI, NAN SHAN, SEN ZHEN, CHINA 518055  
Tel: 0755-25722469 Fax: 0755-25727563

Please inflate tires in time to make sure the pressure of the two tires are the same. The default tire pressure is 3.5 Bar.

### **6.3 Change Tire**

If you need to change the tires, please contact an authorized INMOTION service center or your dealer.

### **6.4 Adjust Footboard**

Please use a M8 screwdriver to adjust the tightness of the footboards if needed.

### **6.5 Cleaning**

Please gently clean the INMOTION V3 cases with a piece of soft cloth with clear water or soap water.

### **6.6 Warranty**

INMOTION provides below warranties for non-human made malfunctions and damages for INMOTION V3.

One year warranty for the entire vehicle (Battery and Tires excluded)

6 months for the Battery

3 months for both inner/outer tires

## Appendix: parameters

No.	Item	Value	Note
1	Max. Speed	18 km/h (11 mph)	This speed is tested with a 75 kg (165 lbs) payload.
2	Distance per charge	20~25km (12.5~15.5 miles)	The distance per charge is obtained under the following test conditions: room temperature, 75 kg (165 lbs) payload and smooth terrain.
3	Climbing Angle	18°	
4	Recommended best operating temperature	-10~40°C (14~104°F)	
5	Max load	120 kg (265 lbs)	
6	Charge time	1.5 H	
7	Power requirements	AC 100-230 V 50~60 Hz	
8	Dimensions	420 x 515 x 178 mm	
9	Tire size	14 inches	
10	Weight	13.5 kg (30 lbs)	

## 7. Operation and Learning

### 7.1 Preparation

When you attempt the first use, please wear comfortable clothes and shoes. We strongly suggest the beginners to wear a helmet and other protections to avoid serious injuries.

Please take the INMOTION V3 onto smooth roads in an open space and then start to learn.

### 7.2 8 Steps

- Hold the INMOTION V3 still and power it on.
- Unfold the footboards and stand one foot on one footboard with force.
- Press your calf against the calf pad and push inward to another leg.
- Now practice sliding the vehicle forward with only one foot on, while another foot

pushing off the ground.

- Make sure that the INMOTION V3 would always be right in the middle of your legs and not go other directions.
- Keep your body straight up and get relaxed, look forward and naturally get on another foot. When you lift another foot off the ground, your body weight is slightly shifting to the foot standing on the footboard.
- It is better that someone can hold your arms to help you get balanced or you can learn to get on the vehicle by pushing your hands against a wall.
- Try to find your balance standing both feet on the INMOTION V3 and relax your calves.
- Someone can hold your arms and lead you drive forward and backward.
- When you get used to the feeling, now try to learn forward to go forward and lean backward to go backward.
- Learn how to turn is always hard, make sure you are able to drive forward and backward very smoothly.
- When you want to turn, twist your upper body towards the direction and push the INMOTION V3 inward. Your upper body will naturally move to the opposite direction to keep you balanced.
- Since INMOTION V3 actually has two tires, it is easier to turn with one tire touching the ground and another off the ground.

### 7.3 Cautions

- Beginners who are under 18 or over 45 need someone as an assistant to help learn.
- Please make sure the battery is fully charged before use and the tires are properly inflated.
- Please do not drive fast before you are familiar with riding it. Please accelerate slowly.

For more information, please visit our official website [www.imscv.com](http://www.imscv.com).



**INMOTION**

— Life In Motion —

INMOTION Customer Care Center: 4000-1000-12

+86 (0)755-8209-1768

## 8. Warranty Card

### Customer purchase information registration

Customer name		Serial Number	
Purchasing date			
Telephone			
E-mail			
Customer's address			
Dealer's Name		Dealer's telephone	
Dealer's address			

## 9. Maintenance record

Date	Description of malfunction	Solution	Authorized Signature	Remark

### Limitation for warranty

The obligations and responsibilities of warranty of INMOTION for the products and accessories, are restricted to free maintenance of reparation and replacement of defective parts within warranty periods. INMOTION assumes no responsibility (also does not authorize any third party to assume the responsibility) for service beyond this scope. Liability exemption is including but not limited to labor force losses, property losses, and other losses caused during the maintenance period. This limited warranty term is the only applicable guarantee clause for the maintenance towards the INMOTION SCV and its spare parts. INMOTION does not endorse any other guarantee or implied guarantee beyond this limited warranty term. INMOTION assumes no responsibility for other commitments that you make with the third party. This regulation comes into force from the day of its promulgation. The PICC (People's Insurance Company of China) insures the INMOTION SCV series products. INMOTION Technologies Co., Ltd. Reserves the right of final explanation, reproduction, and revision for the contents in this warranty card.



**FCC Caution:** Any changes or modifications not expressly approved by the party responsible for compliance could void the user's authority to operate this equipment.

This device complies with Part 15 of the FCC Rules. Operation is subject to the following two conditions:

(1) This device may not cause harmful interference, and (2) this device must accept any interference received, including interference that may cause undesired operation.

NOTE: This equipment has been tested and found to comply with the limits for a Class B digital device, pursuant to Part 15 of the FCC Rules.

These limits are designed to provide reasonable protection against harmful interference in a residential installation. This equipment generates, uses and can radiate radio frequency energy and, if not installed and used in accordance with the instructions, may cause harmful interference to radio communications.

However, there is no guarantee that interference will not occur in a particular installation.

If this equipment does cause harmful interference to radio or television reception, which can be determined by turning the equipment off and on, the user is encouraged to try to correct the interference by one or more of the following measures:

- Reorient or relocate the receiving antenna.
- Increase the separation between the equipment and receiver.
- Connect the equipment into an outlet on a circuit different from that to which the receiver is connected.
- Consult the dealer or an experienced radio/TV technician for help.